

RECEIVED

JUN 16 2015

WATER RESOURCES DEPT
SALEM, OREGON

TEMPORARY TRANSFER APPLICATION MAP
Certificates 23793 & 31596
Section 4, T18S, R3W
Sections 6, 7 & 18, T17S, R3W
Sections 1, 12 & 13, T17S, R4W, W.M., Lane County
Delta Sand and Gravel Company

FROM MAP
Section 4, T18S, R2W, W.M.

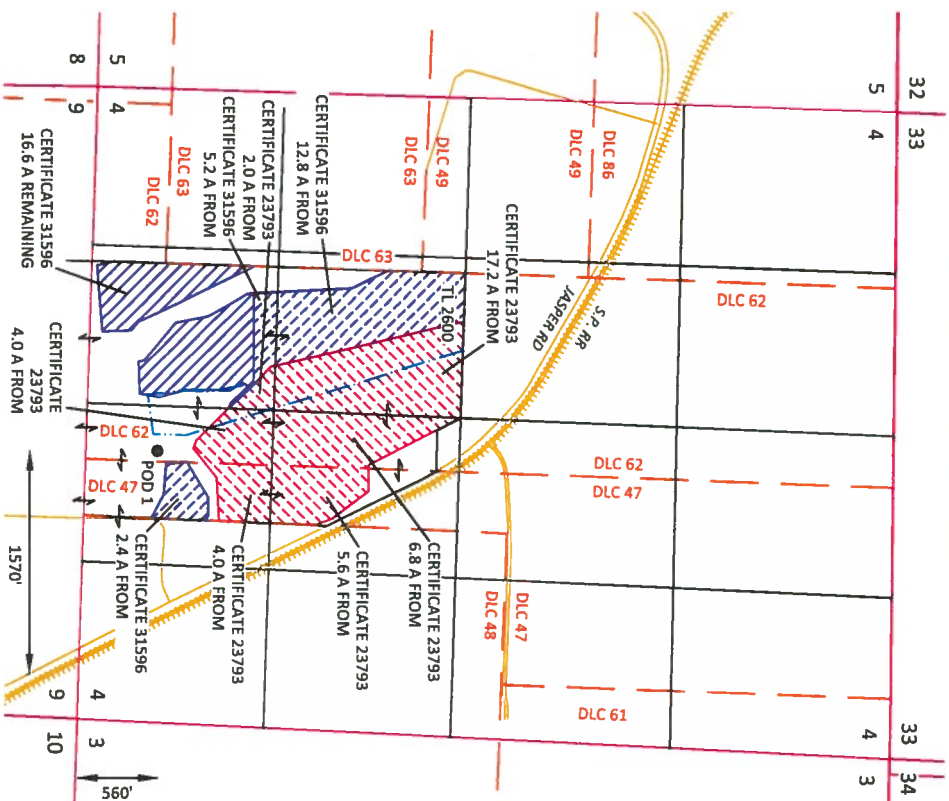

EXPLANATION

FROM LANDS	TO LANDS	REMAINING RIGHTS
CERTIFICATE 23793 (39.6 A) IRRIGATION PRIORITY: 8/7/1953	CERTIFICATE 23793 INDUSTRIAL/COMMERCIAL PRIORITY: 8/7/1953	CERTIFICATE 31596 (16.6 A) IRRIGATION PRIORITY: 3/7/1958
CERTIFICATE 31596 (20.4 A) IRRIGATION PRIORITY: 3/7/1958	CERTIFICATE 31596 INDUSTRIAL/COMMERCIAL PRIORITY: 3/7/1958	
POINT OF DIVERSION (POD)		
PIPELINE (APPROX.)		

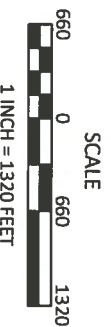

June 15, 2015

This map is not intended to provide legal dimensions or locations of property ownership lines

FIGURE 1

TO MAP

Sections 6, 7 & 18, T17S, R3W, W.M. and
Sections 1, 12 & 13, T17S, R4W, W.M.

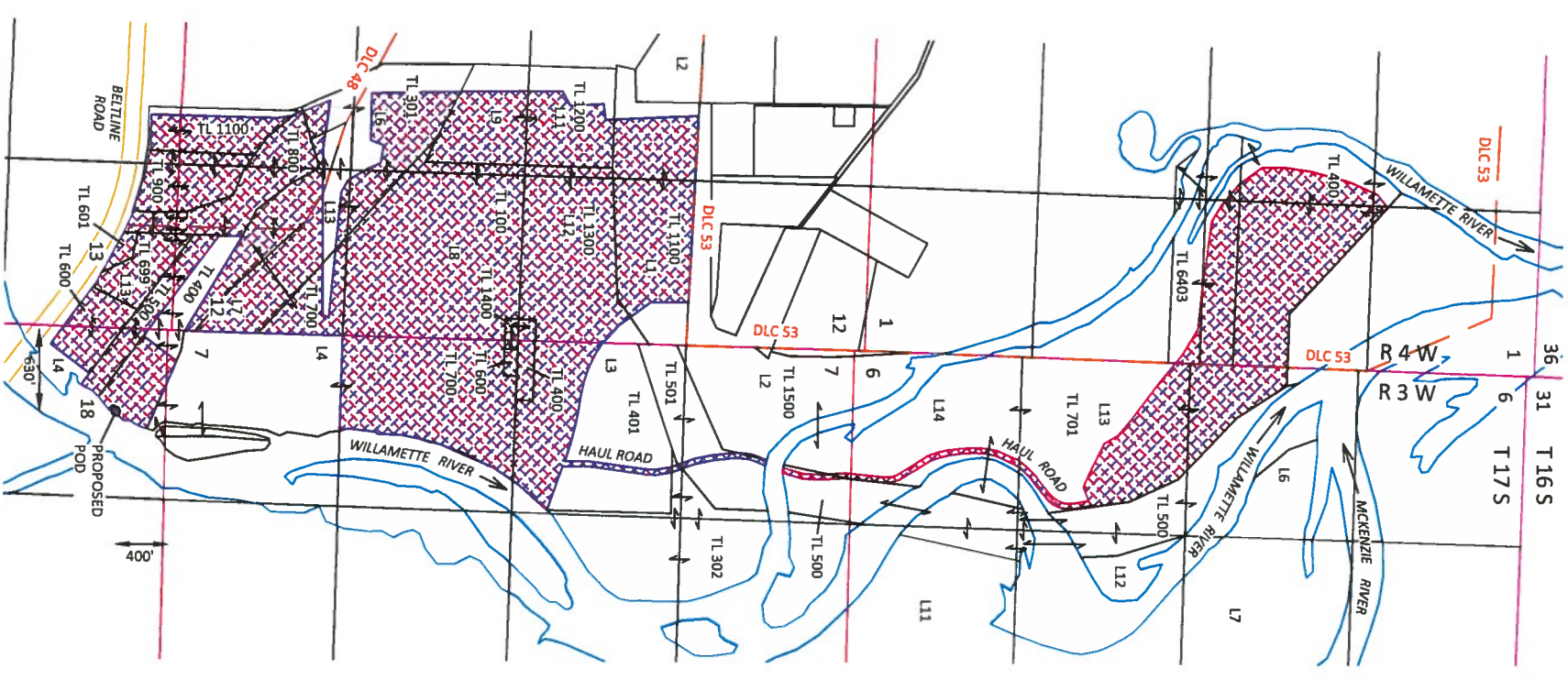

12084



P.O. BOX 80174
PORTLAND, OR 97280
(503) 319-8926