

T.1N., R.13E., W.M.

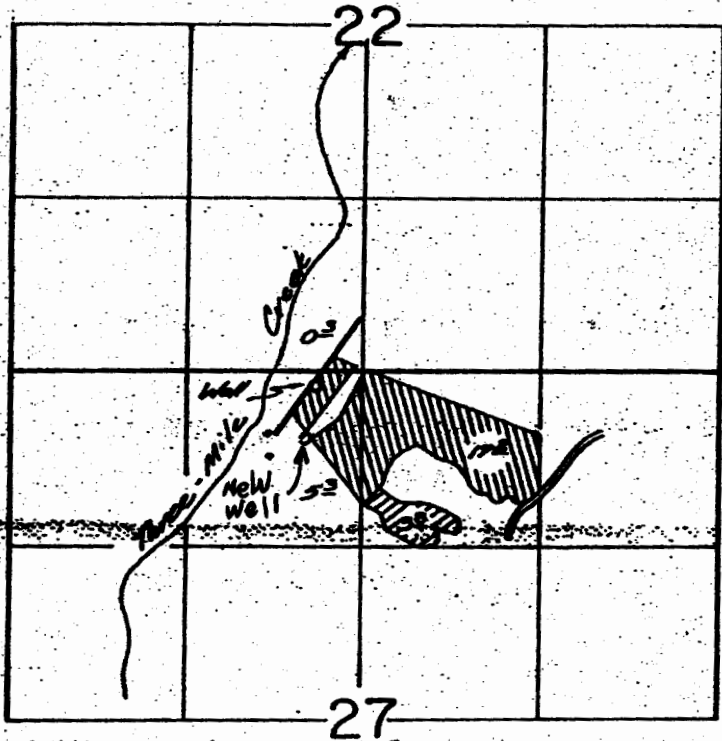

Well Loc. 110' N.S. & 370' W. from N 1/4 Cor SW 27
 New Well Loc. 1000' S.S. & 370' W. from N 1/4 Cor SW 27.

FINAL PROOF SURVEY
 UNDER

RECEIVED BY OWRD

JUL 27 2015

SALEM, OR

Application No. E-7186 Permit No. E-6618
 IN NAME OF

Betty L. Fortin, John L. & Karen Carter

Surveyed July 24, 1979 by Alban

41065-572-184