

**TRANSFER APPLICATION MAP FOR
LEE PADBERG
CHANGING P.O.D. CERT 53120 AND PERMIT 48116
CERT 67270 AND CHANGING THE P.O.A. PERMIT
G-6828 CERT 54550
T1S, R25E WM**

RECEIVED

MAY 31 2005

**WATER RESOURCES DEPT
SALEM, OREGON**

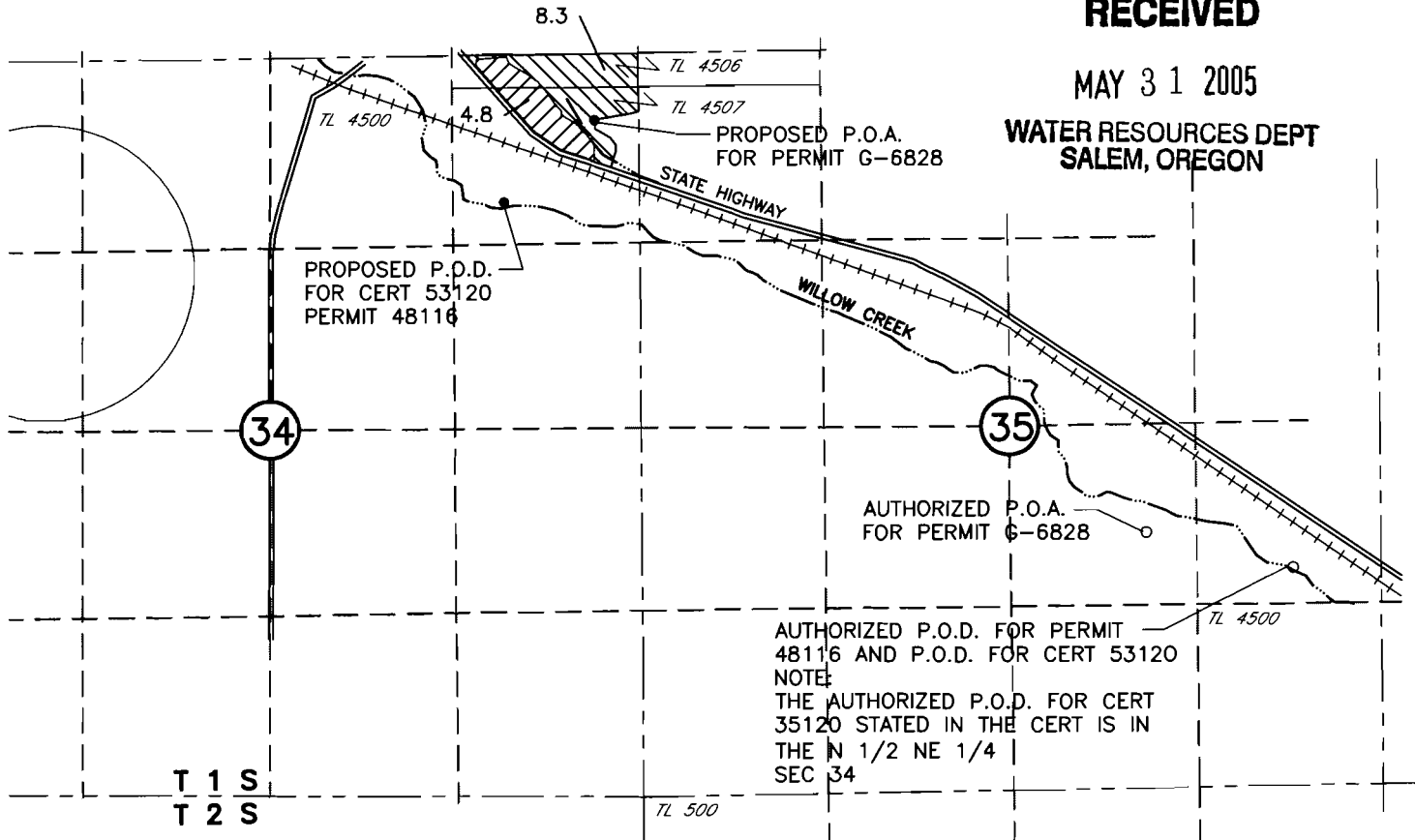

 4.8 AC PRIMARY CERT 53120
SUPPLEMENTAL PERMIT G-6828 CERT
54550 *

 8.3 AC PRIMARY PERMIT G-6828 CERT 54550
SUPPLEMENTAL PERMIT 48116 CERT
67270

AUTHORIZED P.O.D. CERT 53120 AND
PERMIT 48116 (SEE NOTE ABOVE)
LOCATED 1550'N AND 640'W FROM
THE SE CORNER SEC 35

PROPOSED P.O.D. CERT 53120 AND
PERMIT 48116
LOCATED 1050'S AND 950'W FROM
THE NE CORNER SEC 34

AUTHORIZED P.O.A. PERMIT G-6828
WELL #1
LOCATED 1810'N AND 1680'W FROM
THE SE CORNER SEC 35

PROPOSED P.O.A. PERMIT G-6828
LOCATED 470'S AND 310'W FROM THE
NE CORNER SEC 34

* PERMIT G-6828 CHANGE FROM
PRIMARY TO SUPPLEMENTAL IN THIS
AREA

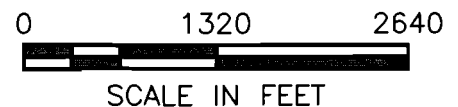
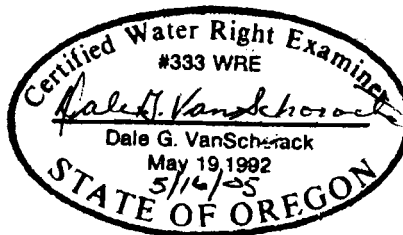

NOTE:
THE PURPOSE OF THIS MAP IS TO IDENTIFY THE APPROXIMATE LOCATION
OF THE WATER RIGHT. IT IS NOT INTENDED TO PROVIDE INFORMATION
RELATIVE TO THE LOCATION OF PROPERTY OWNERSHIP BOUNDARY LINES.

T.9942

SCM Consultants, Inc.
A Tetra Tech Company
DRAWING: H:\CAD\AG\3522\161\3522161trlee.dwg
PRINTED BY: RogerW on 05/16/05 07:23 AM

LEE PADBERG DELIVERY SYSTEM T1S, R25E WM

RECEIVED

MAY 31 2005

WATER RESOURCES DEPT
SALEM, OREGON

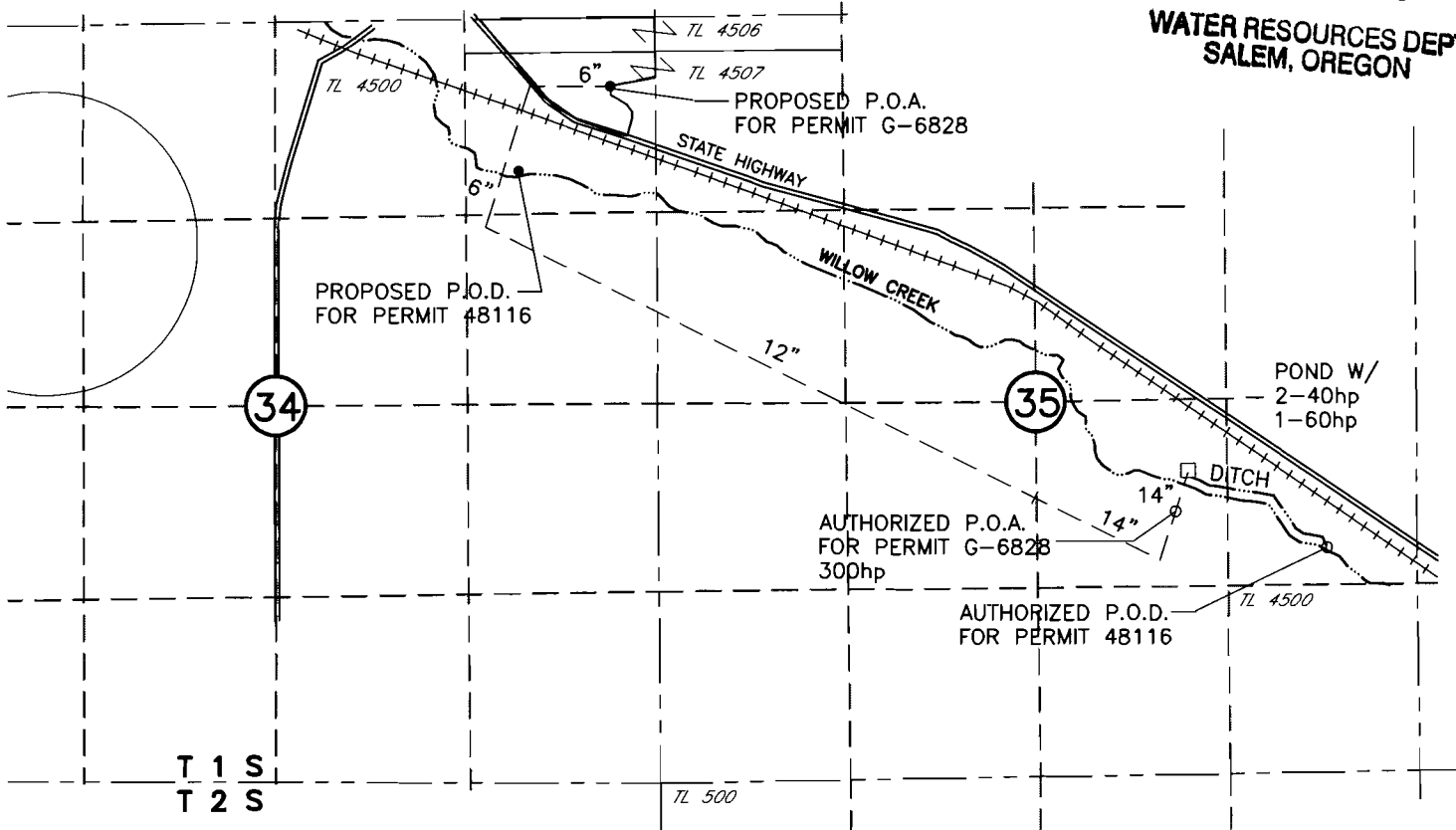

AUTHORIZED P.O.D. PERMIT 48116
LOCATED 1550'N AND 640'W FROM
THE SE CORNER SEC 35

PROPOSED P.O.D. PERMIT 48116
LOCATED 1050'S AND 950'W FROM
THE NE CORNER SEC 34

AUTHORIZED P.O.A. PERMIT G-6828
WELL #1
LOCATED 1810'N AND 1680'W FROM
THE SE CORNER SEC 35

PROPOSED P.O.A. PERMIT G-6828
LOCATED 470'S AND 310'W FROM THE
NE CORNER SEC 34

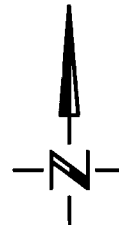

SCALE IN FEET

T-9942

SCM Consultants, Inc.
A Tetra Tech Company

DRAWING: H:\CAD\AG\3522\161\3522161sys.dwg
PRINTED BY: RogerW on 04/13/05 03:10 PM

NOTE:
THE PURPOSE OF THIS MAP IS TO IDENTIFY THE APPROXIMATE LOCATION
OF THE WATER RIGHT. IT IS NOT INTENDED TO PROVIDE INFORMATION
RELATIVE TO THE LOCATION OF PROPERTY OWNERSHIP BOUNDARY LINES.