

T.13S., R.33E., W.M.

T.13S., R.34E.

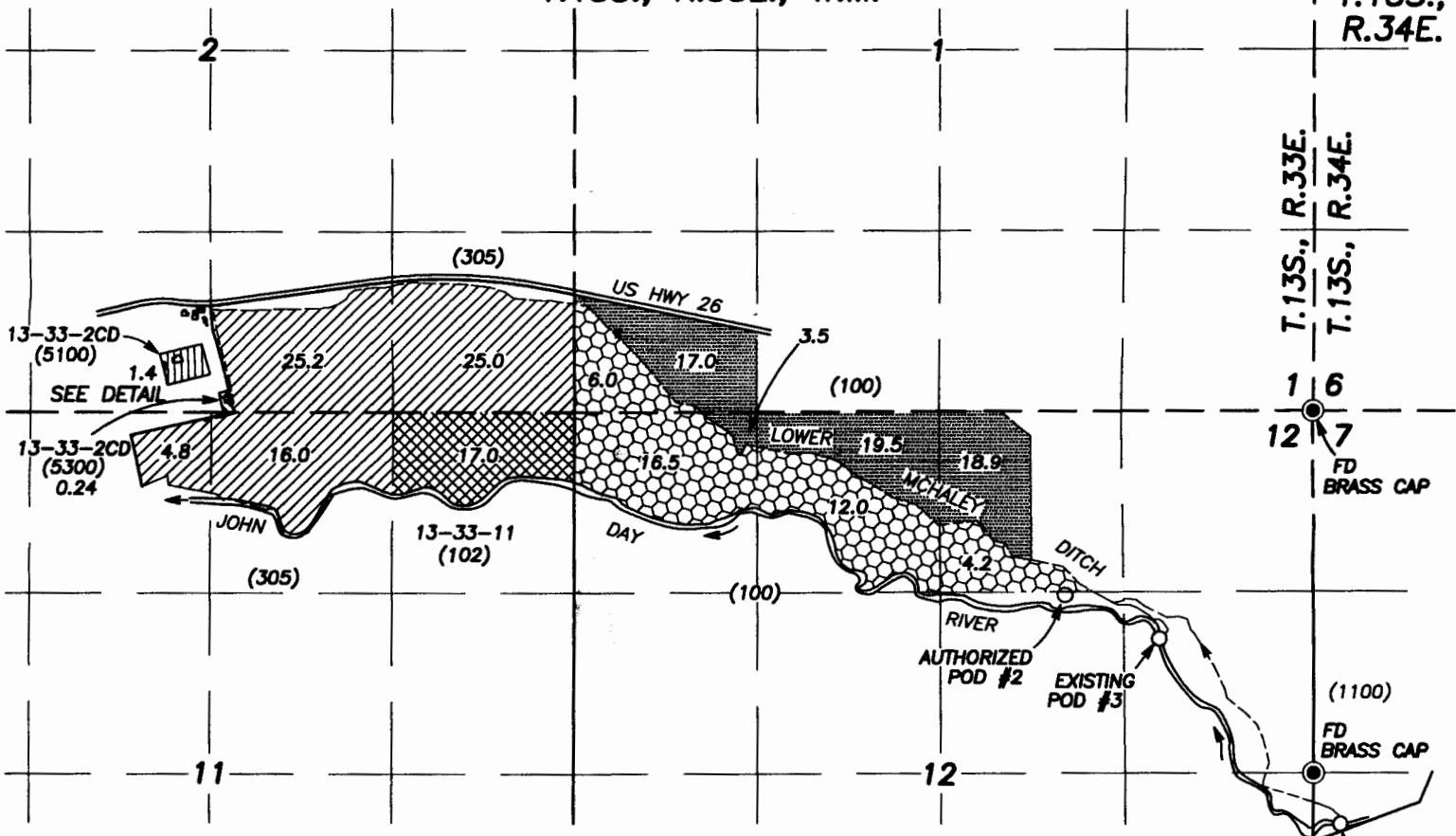









POD #1 - PROPOSED: 370' SOUTH AND 200' EAST OF FROM THE W1/4 COR. SEC. 7, T.13S., R.34E.

POD #2 - AUTHORIZED: 1350' SOUTH & 1800' WEST FROM THE NE COR. SEC. 12, T.13S., R.33E.

POD #3 - C-82305 - AUTHORIZED: 1660' SOUTH & 980' WEST FROM THE NE COR. SEC. 12, T.13S., R.33E.  
EXISTING: 1670' SOUTH & 1120' WEST FROM THE NE COR SEC. 12, T.13S., R.33E.,

**CURRENT PLACES OF USE:**

-  C-24909 - THE CONFEDERATED TRIBES OF THE WARM SPRINGS RESERVATION OF OREGON P.D. 1869
-  C-82305 - THE CONFEDERATED TRIBES OF THE WARM SPRINGS RESERVATION OF OREGON P.D. 1875
-  C-25097 - BOBBY JACK HARRIS, ET. AL P.D. 1867
-  C-25097 - PHILLIP E. & JOANN T. PHIPPEN P.D. 1867
-  C-25097 - DELBERT & BONNIE LAKE P.D. 1867
-  C-25097 - BENJAMIN H. RICHARDSON P.D. 1867
-  C-25525 - BONNIE M. NANCE, TRUSTEE OF THE NANCE FAMILY TRUST P.D. 1869
-  C-25885 - BONNIE M. NANCE, TRUSTEE OF THE NANCE FAMILY TRUST P.D. 1877
-  PORTION OF C-24909 NOT INVOLVED IN THIS TRANSFER
- ( ) TAX LOT
- P.D. PRIORITY DATE

**TRANSFER APPLICATION MAP FOR CHANGE IN POINT OF DIVERSION**

IN NAMES OF THE CONFEDERATED TRIBES OF THE WARM SPRINGS RESERVATION OF OREGON, BOBBY JACK HARRIS, ET AL, PHILLIP E. & JOANN T. PHIPPEN, DELBERT & BONNIE LAKE, BENJAMIN H. RICHARDSON, BONNIE M. NANCE TRUSTEE OF THE NANCE FAMILY TRUST.

SCALE: 1" = 1320'

RECEIVED BY OWRD

AUG 14 2015

SALEM, OR

DETAIL (13-33-11CD) SCALE: 1"=200'

PREPARED BY:

ROBERT D. BAGETT, PLS, CWRE  
217 N. CANYON BLVD.  
JOHN DAY, OREGON  
(541) 575-1251

JUNE 26, 2015



1 12132

RENEWS: 12/31/2015

DISCLAIMER: THIS MAP IS NOT INTENDED TO PROVIDE LEGAL DIMENSIONS OR LOCATIONS OF PROPERTY BOUNDARY LINES.

