

Certificate 26711

Temporary Drought Transfer

Place of Use & Additional POD

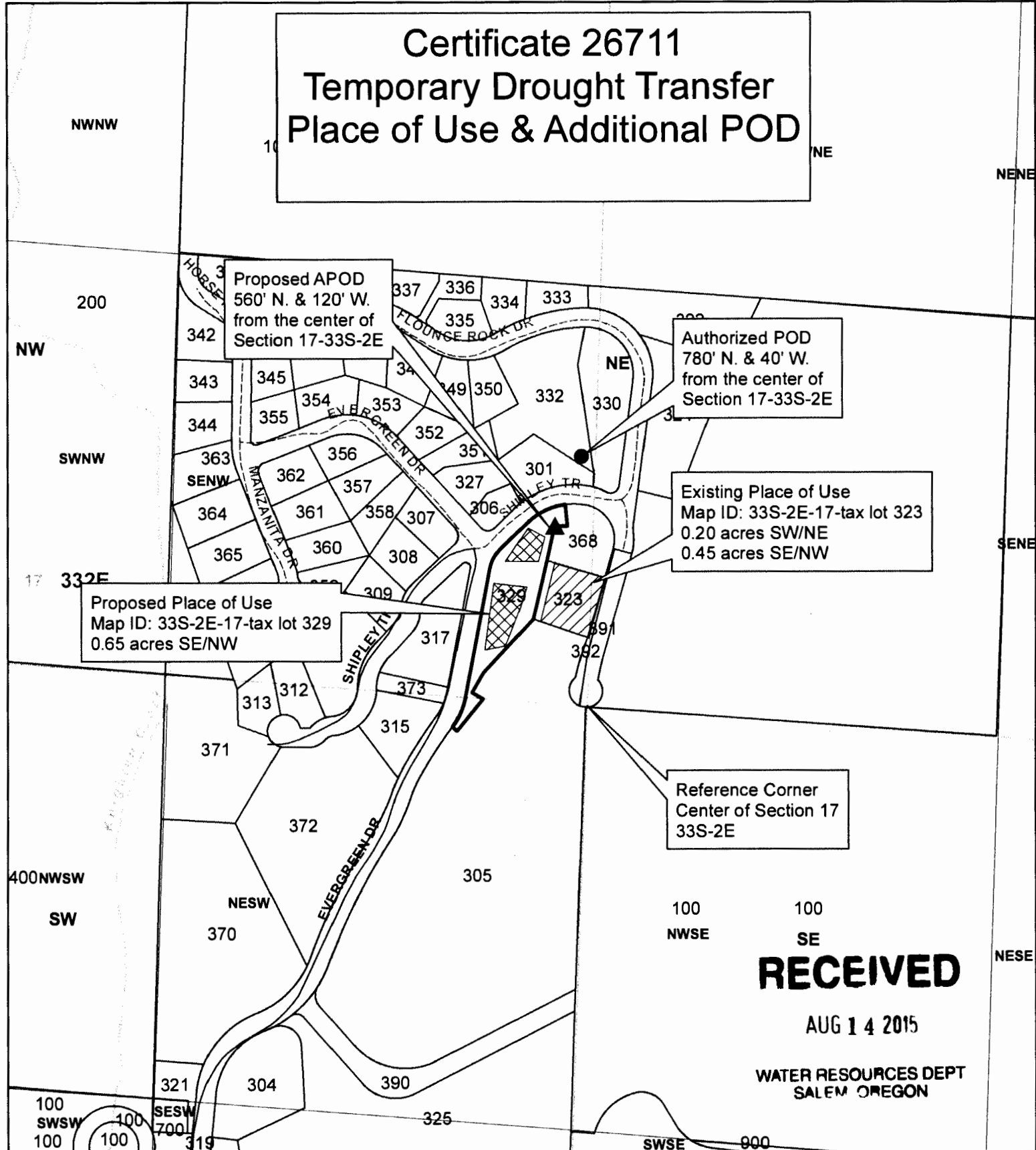

Legend

- ▲ Proposed APOD
- ▨ Proposed POU
- Authorized POD
- ▧ Existing POU Cert. 26711
- Taxlot 329
- Taxlots
- ▭ Townships
- ▭ Sections
- ▭ Quarter Sections
- ▭ Quarter Quarter Sections

1 inch = 400 feet

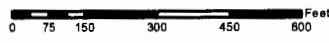

JACKSON COUNTY
WATERMASTER

Prepared by Travis Kelly

This map is based on a digital database compiled by Jackson County from a variety of sources. Jackson County cannot accept responsibility for errors, omissions, or positional accuracy. There are no warranties, expressed or implied.

Certificate 26711

Temporary Drought Transfer Place of Use & Additional POD

Superseded

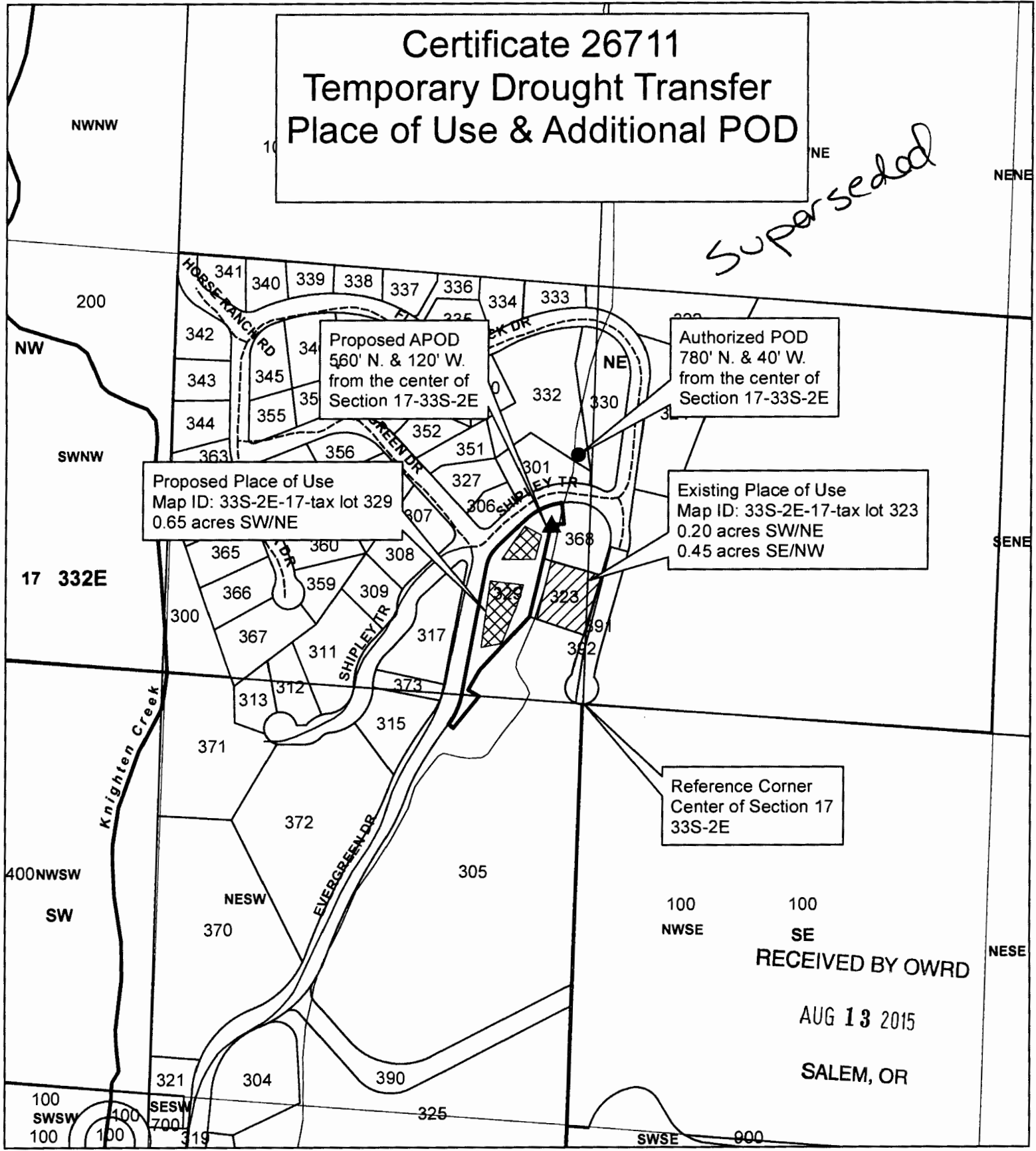

100 NWSE 100 SE
RECEIVED BY OWRD
AUG 13 2015
SALEM, OR

Legend

- | | |
|--------------------------|--------------------------|
| Proposed APOD | Taxlots |
| Proposed POU | Townships |
| Authorized POD | Sections |
| Existing POU Cert. 26711 | Quarter Sections |
| Taxlot 329 | Quarter Quarter Sections |

1 inch = 400 feet

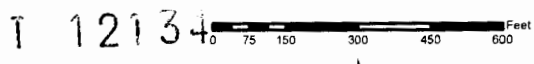

**JACKSON COUNTY
WATERMASTER**

Prepared by Travis Kelly

This map is based on a digital database compiled by Jackson County from a variety of sources. Jackson County cannot accept responsibility for errors, omissions, or positional accuracy. There are no warranties, expressed or implied.