

# T9S & T10S, R5W, WM

POLK COUNTY

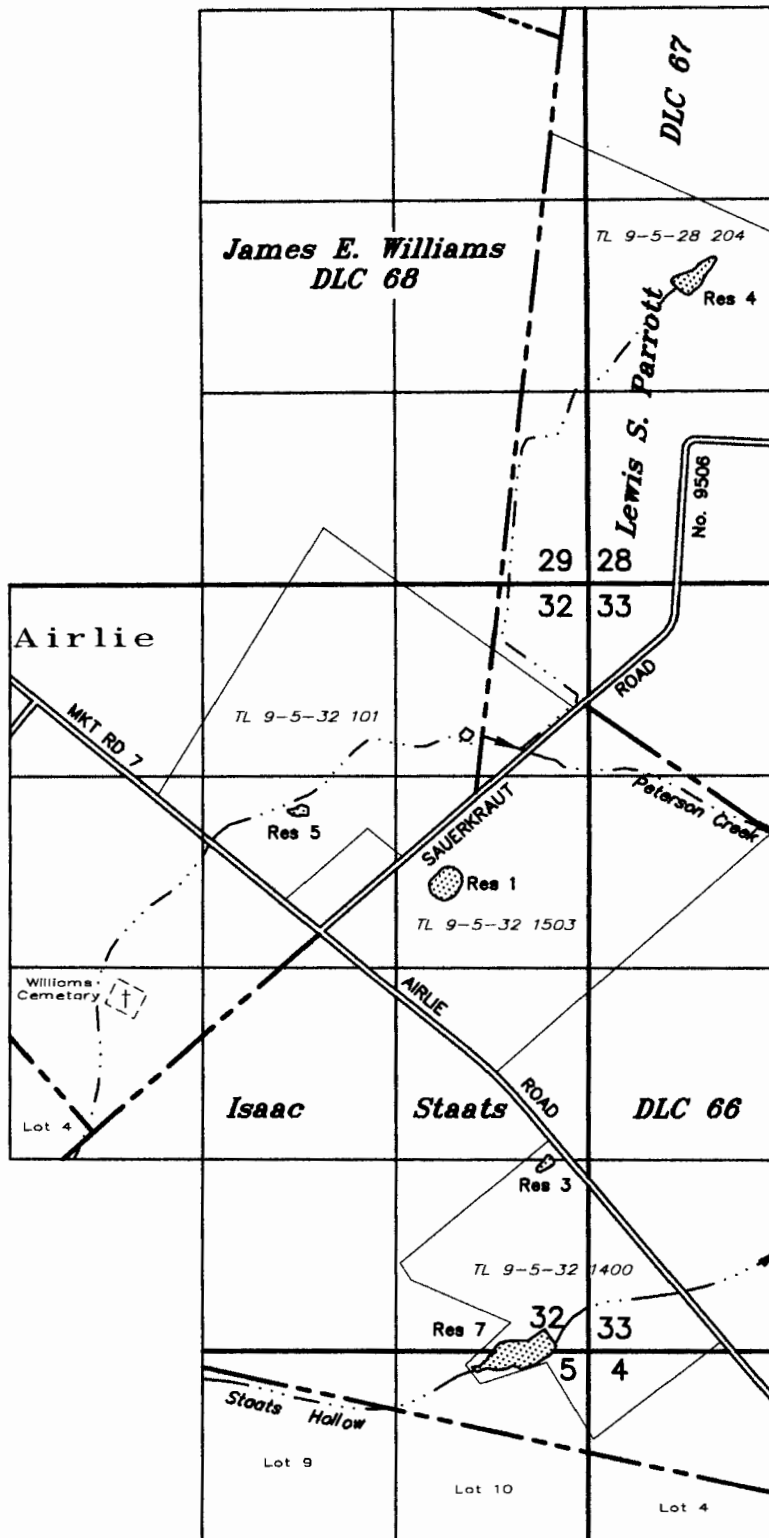

**POD's**

RES 1:  
1145' S & 855' W  
N'y COR STAATS DLC 66

RES 3:  
1320' N & 240' W  
SE COR SEC 32

RES 4:  
2860' N & 660' E  
N'y COR STAATS DLC 66

RES 5:  
735' S & 1880' W  
N'y COR STAATS DLC 66

RES 7:  
90' N & 255' W  
SE COR SEC 32

CERTIFICATES DO NOT  
LIST POD'S, ONLY  
RESERVOIR LOCATIONS

## APPLICATION TO TRANSFER WATER RIGHT

CHARACTER OF USE

IN THE NAME OF

**RECEIVED** Hamilton Farms, LLC

AUG 31 2015

WATER RESOURCES DEPT  
SALEM, OREGON

Certificate No. 41746  
41747  
81452 Transfer No. T-

August 8, 2015

SCALE: 1" = 1320'



NOTE: This map is not intended to  
provide legal dimensions or locations  
of property ownership lines.

T 12149

EXPIRES 12-31-15



Google earth



**RECEIVED**

AUG 31 2015

WATER RESOURCES DEPT  
SALEM, OREGON

Date of Photograph: 7-14-2014

T 12149



Google earth

feet  
meters



T 12149

**RECEIVED**

AUG 31 2015

Date of Photograph 7-14-2014

WATER RESOURCES DEPT  
SALEM, OREGON



Google earth

feet  
meters



Date of Photograph: 7-14-2014

T 12149

**RECEIVED**

AUG 31 2015

WATER RESOURCES DEPT  
SALEM, OREGON