

RECEIVED

AUG 31 2015

WATER RESOURCES DEPT
SALEM, OREGON

T.3S. R.3W. Sec. 27 & 34, W.M.

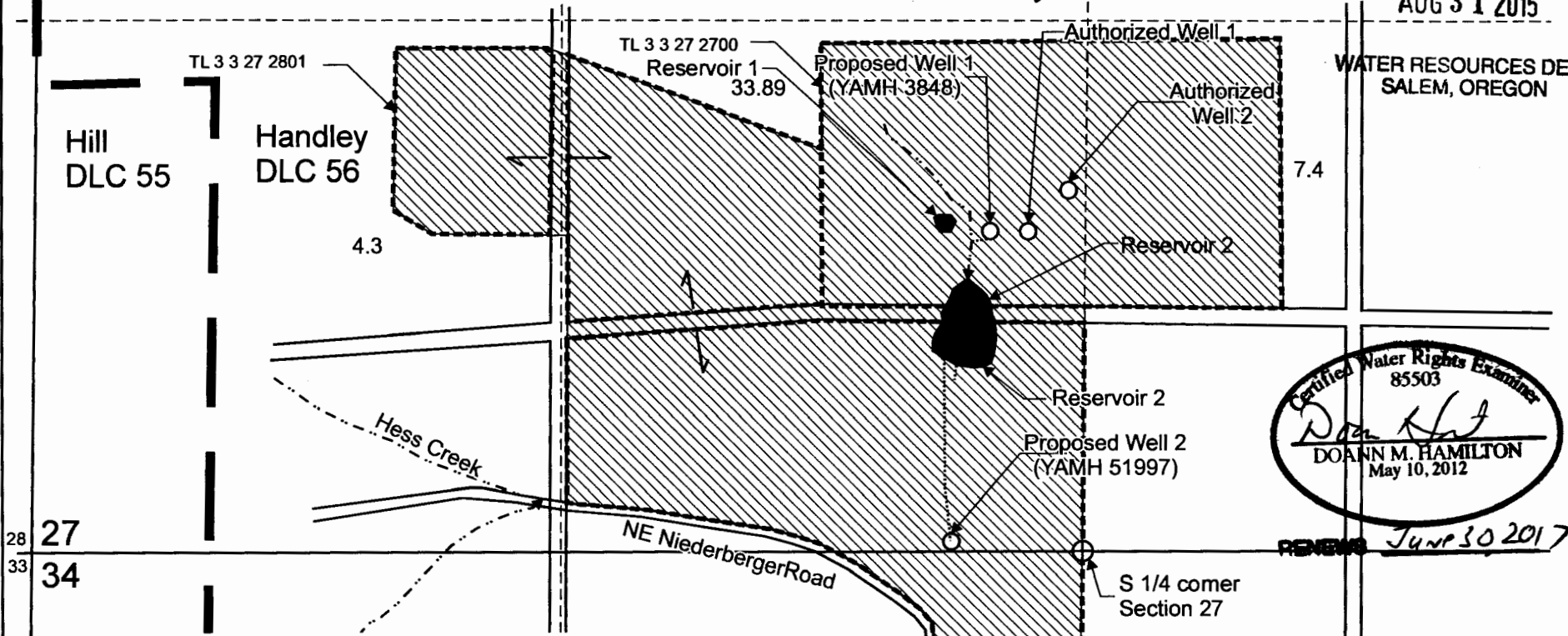

Certified Water Rights Examiner
85503
Doann M. Hamilton
DOANN M. HAMILTON
May 10, 2012

RECEIVED June 30 2017

Authorized Well 1 is located 800 feet north and 2,500 feet east from the SW corner, Section 27.
 Proposed Well 1 (YAMH 3848) is located 800 feet north and 2,405 feet east from the SW corner, Section 27.
 Authorized Well 2 (YAMH 51997) is located 900 feet north and 2,600 feet east from the SW corner, Section 27.
 Proposed Well 2 (YAMH 51997) is located 25 feet north and 2,310 feet east from the SW corner, Section 27.

 Area (51.49 Acres) to be irrigated supplementally under Application G-14634, Permit G-13429.

- Tax lot boundary
- ===== Donation Land Claim boundary
- Irrigation main line

This map was prepared for the purpose of identifying the location of a water right only and is not intended to provide legal dimensions or location of property ownership lines.

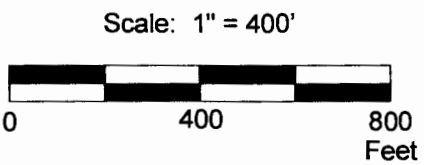

T 12147

Pacific Hydro-Geology Inc.

08/2015

Permit Amendment Map
 Application G-14634, Permit G-13429
 Archery Summit Winery
 T.3S. R.3W. Sec. 27 & 34, W.M.