



T-8634

RECEIVED

NOV 22 2001

WATER RESOURCES DEPT
SALEM, OREGON

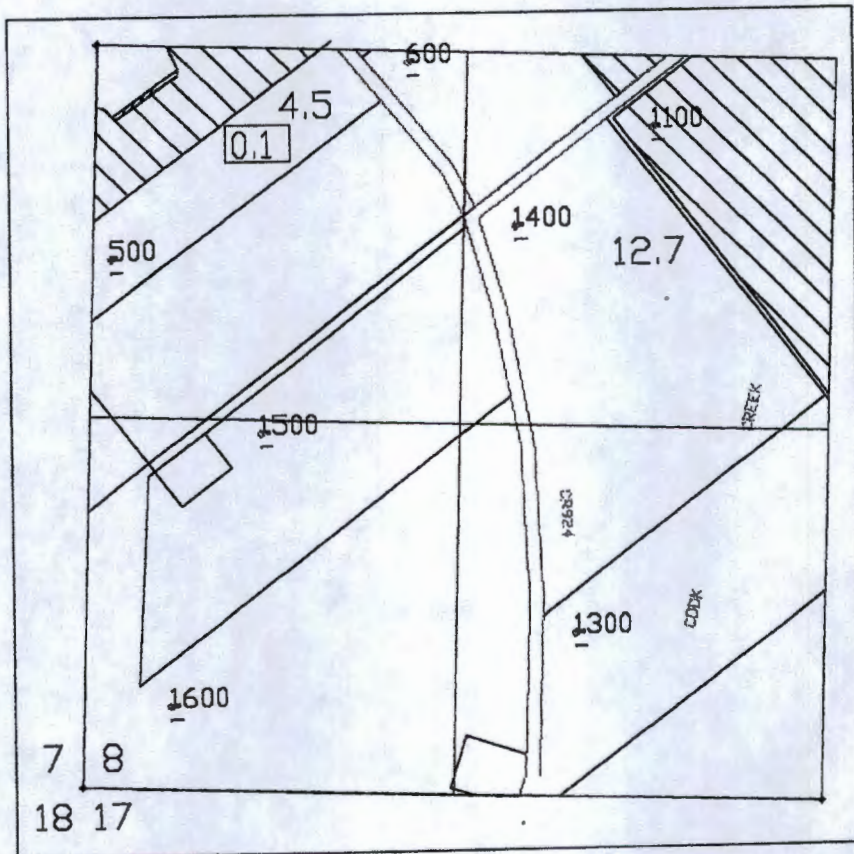

TRANSFER APPLICATION MAP FOR S.W.C.D.
09S, 2W, SECTION 8 SW QTR.

SCALE: 1" = 660'

RECEIVED

AUG 31 2015

WATER RESOURCES DEPT
SALEM, OREGON

LEGEND

6.2 = E-82 WATER RIGHT (1909) ACREAGE		= E-82 WATER RIGHT (1909)
= E-82 W.R. TRANSFER FROM ACREAGE		= E-82 W.R. TRANSFER FROM CERTIFICATE # 52798
= E-82 WR TRANSFER TO ACREAGE		

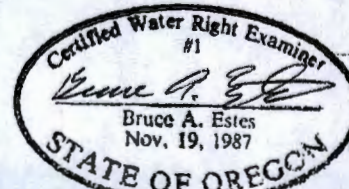

Renewal Dec 31, 2001 Sheet 1 of 2

T 12154

This map is for the purpose of locating a water right only and has no intent to provide legal dimensions or the location of property lines.

ESTES SURVEYS

PO Box 17519
Salem, OR 97305-7519
(503) 585-7593

60382 Arnold Rd
Bend, OR 97702
(541) 382-7391



T-8634

RECEIVED

NOV 2 2000

WATER RESOURCES DEPT
SALEM, OREGON

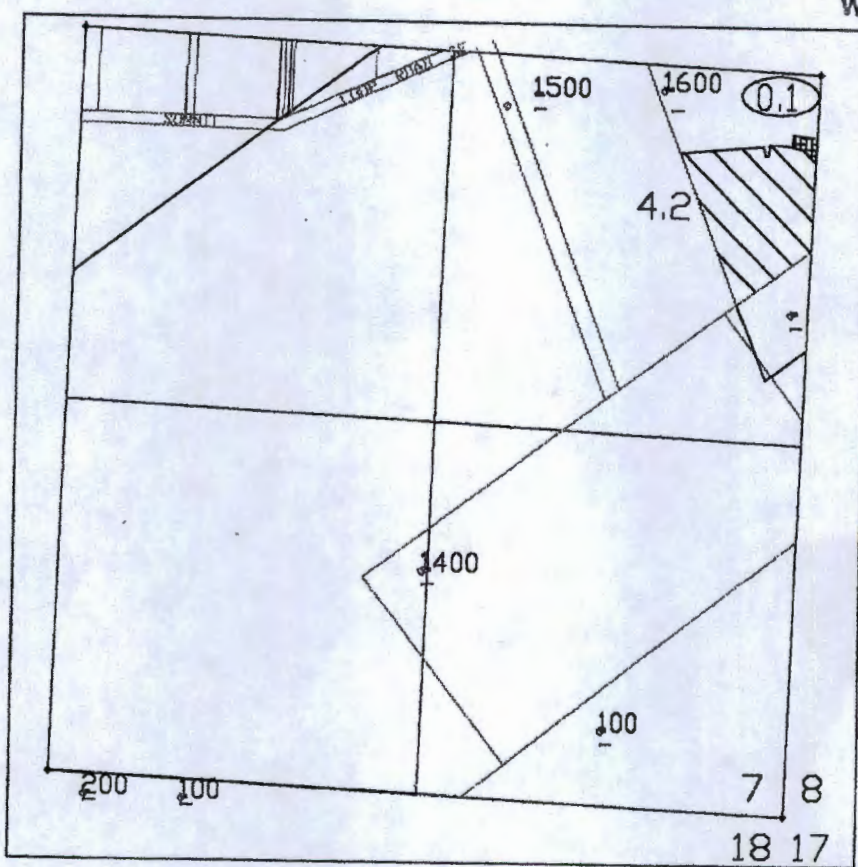

TRANSFER APPLICATION MAP FOR S.W.C.D.

09S, 2W, SECTION 7 SE QTR.

SCALE: 1" = 660'

RECEIVED

AUG 31 2015

WATER RESOURCES DEPT
SALEM, OREGON

LEGEND

6.2 = E-82 WATER RIGHT (1909) ACREAGE		= E-82 WATER RIGHT (1909)
= E-82 W.R. TRANSFER FROM ACREAGE		
= E-82 WR TRANSFER TO ACREAGE		= E-82 WR TRANSFER TO

This map is for the purpose of locating a water right only and has no intent to provide legal dimensions or the location of property lines.

T 12154

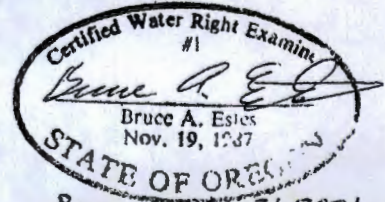

Renewal Dec 31, 2001
Sheet 2 of 2

ESTES SURVEYS

PO Box 17519	60382 Arnold Rd
Salem, OR 97305-7519	Bend, OR 97702
(503) 585-7593	(541) 382-7391

54286 OFF
1.0 SW/SE
.5 SE/SE

N ↑
T 8635 part 1

RECEIVED

NOV 27 2000

WATER RESOURCES DEPT.
SALEM, OREGON

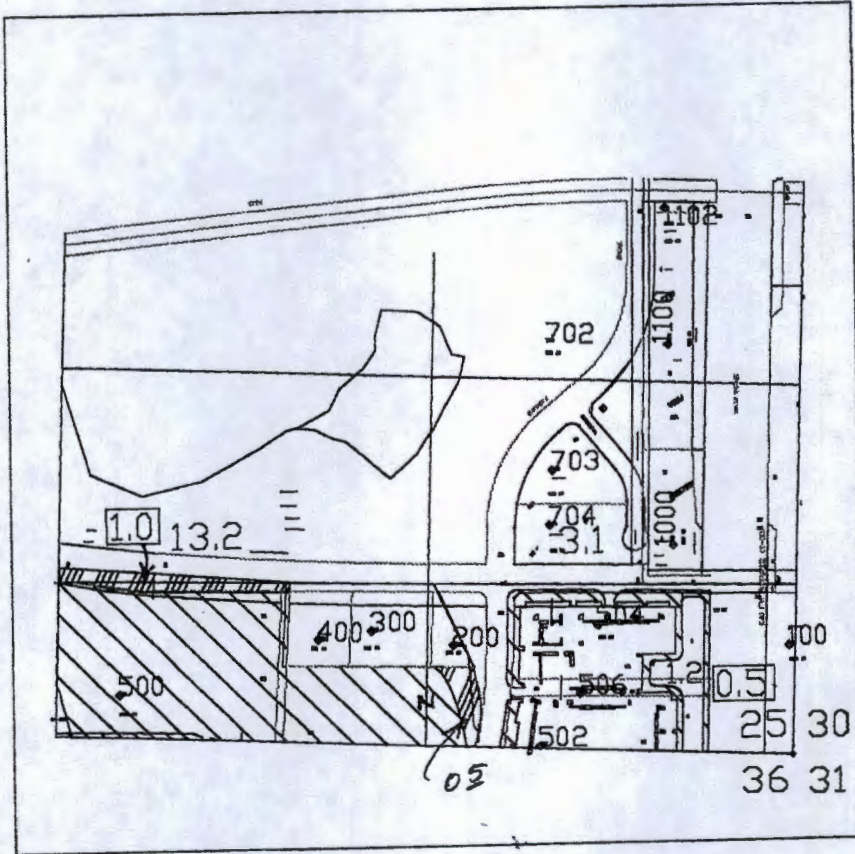

TRANSFER APPLICATION MAP FOR S.W.C.D.
07S, 3W, SECTION 25 SE QTR.

RECEIVED

AUG 31 2015

SCALE: 1" = 660'

WATER RESOURCES DEPT
SALEM, OREGON

LEGEND

6.2 = E-82 WATER RIGHT (1909) ACREAGE	= E-82 WATER RIGHT (1909)
= E-82 W.R. TRANSFER FROM ACREAGE	
= E-82 WR TRANSFER TO ACREAGE	= E-82 W.R. TRANSFER FROM CERTIFICATE # 54286

Certified Water Right Examiner
#1
Bruce A. Estes
Bruce A. Estes
Nov. 19, 1987
STATE OF OREGON
Renewal Dec 31, 2001

Sheet 1 of 6

ESTES SURVEYS

PO Box 17519
Salem, OR 97305-7519
(503) 585-7593

60382 Arnold Rd
Bend, OR 97702
(541) 382-7391

T 12154

This map is for the purpose of locating a water right only and has no intent to provide legal dimensions or the location of property lines.

54286 OFF

54286 OFF 1.3 DINN 2-152

1.1 NW/NE
1.2 NE/NE

N T 8635 part 1

RECEIVED

NOV 27 2000

WATER RESOURCES DEPT.
SALEM, OREGON

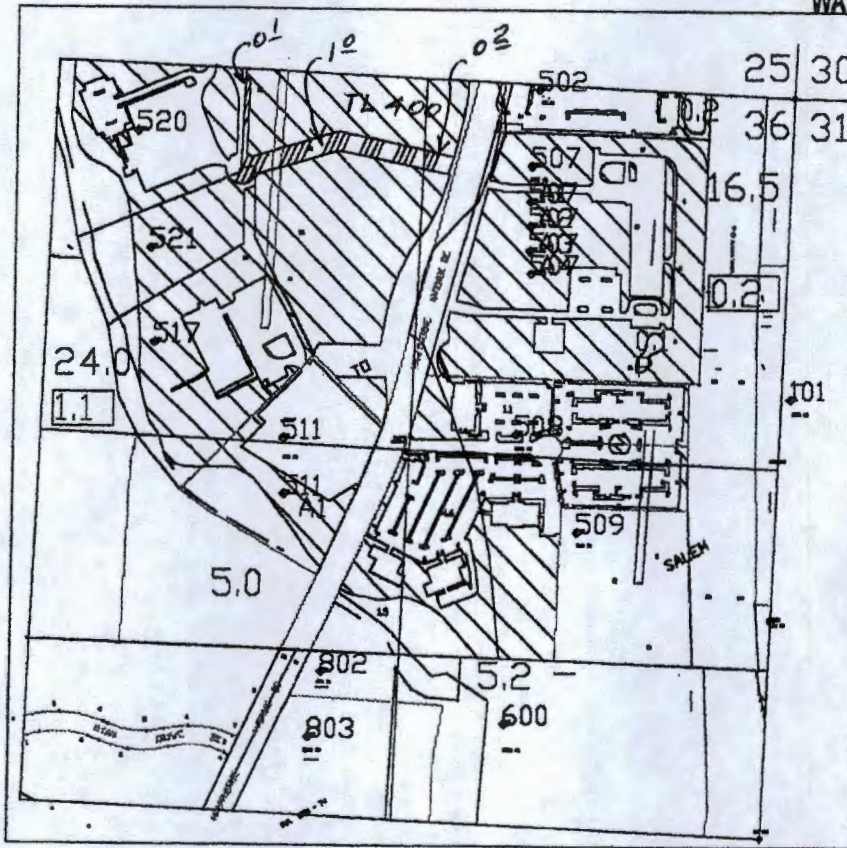

TRANSFER APPLICATION MAP FOR S.W.C.D.
07S, 3W, SECTION 36 NE QTR.

SCALE: 1" = 660'

RECEIVED

AUG 31 2015

WATER RESOURCES DEPT.
SALEM, OREGON

LEGEND

6.2 = E-82 WATER RIGHT (1909) ACREAGE		= E-82 WATER RIGHT (1909)
= E-82 W.R. TRANSFER FROM ACREAGE		= E-82 W.R. TRANSFER FROM CERTIFICATE # 54286
= E-82 WR TRANSFER TO ACREAGE		

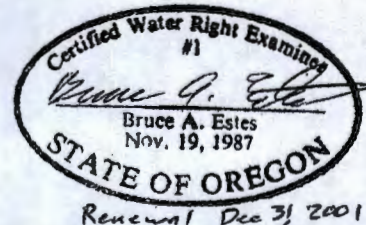

Sheet 2 of 6

ESTES SURVEYS

PO Box 17519 60382 Arnold Rd
 Salem, OR 97305-7519 Bend, OR 97702
 (503) 585-7593 (541) 382-7391

T 12154

This map is for the purpose of locating a water right only and has no intent to provide legal dimensions or the location of property lines.

54286 OFF
.7 SW/NE
4.8 SE/NE
4.7 NE/NE



T 8635
part 2

RECEIVED

NOV 27 2000

WATER RESOURCES DEPT
SALEM, OREGON

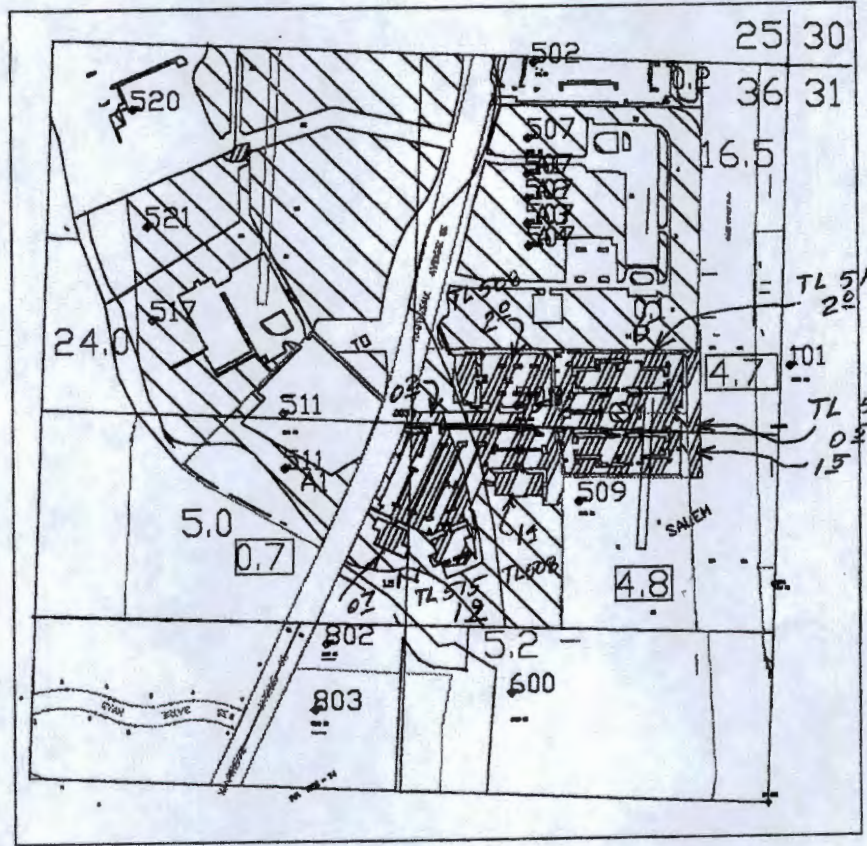

TRANSFER APPLICATION MAP FOR S.W.C.D.

07S, 3W, SECTION 36 NE QTR





SCALE: 1" = 660'

RECEIVED

AUG 31 2015

WATER RESOURCES DEPT
SALEM, OREGON

LEGEND

6.2 = E-82 WATER RIGHT (1909) ACREAGE		= E-82 WATER RIGHT (1909)
 = E-82 W.R. TRANSFER FROM ACREAGE		= E-82 W.R. TRANSFER FROM CERTIFICATE # 54286
 = E-82 WR TRANSFER TO ACREAGE		

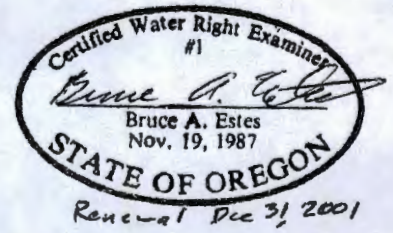

Sheet 1 of 3

ESTES SURVEYS

PO Box 17519 60382 Arnold Rd
Salem, OR 97305-7519 Bend, OR 97702
(503) 585-7593 (541) 382-7391

This map is for the purpose of locating a water right only and has no intent to provide legal dimensions or the location of property lines.

T 12154

54286 OFF
.7 SEISE

T 8635
Part 3
N

RECEIVED

NOV 27 2000

WATER RESOURCES DEPT.
SALEM, OREGON

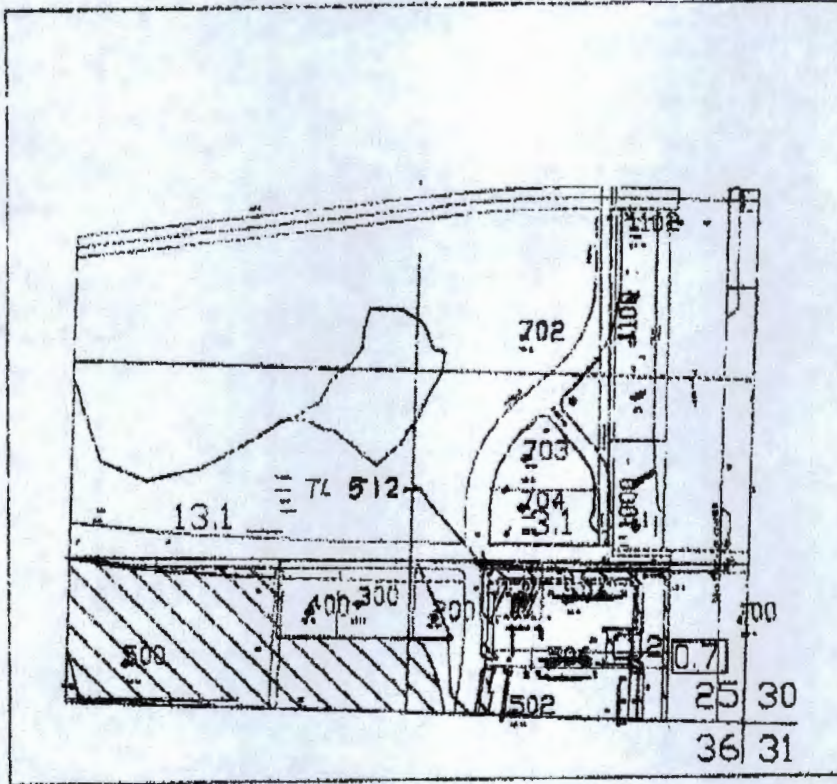

TRANSFER APPLICATION MAP FOR S.W.C.D.
07S, 3W, SECTION 25 SE QTR.

SCALE: 1" = 660'

RECEIVED

AUG 31 2015

WATER RESOURCES DEPT
SALEM, OREGON

LEGEND

- 6.2 * E-82 WATER RIGHT (1909) ACREAGE
- 6.2 * E-82 W.R. TRANSFER FROM ACREAGE
- 6.2 * E-82 WR TRANSFER TO ACREAGE
- [Hatched Box] = E-82 WATER RIGHT (1909)
- [Diagonal Lines Box] = E-82 WR TRANSFER FROM CERTIFICATE # 54286

This map is for the purpose of locating a water right only and has no intent to provide legal dimensions or the location of property lines.

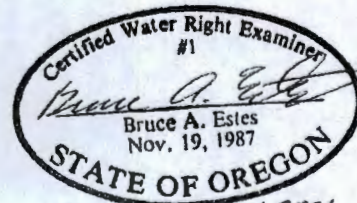

Renewal Dec 31, 2001

Sheet 2 of 2

ESTES SURVEYS

PO Box 17519 60382 Arnold Rd
Salem, OR 97305-7519 Bend, OR 97702
(503) 585-7593 (541) 382-7391

1.3 SWINE
7.6 NWINE

T 8635
N part 4

RECEIVED

NOV 27 2000

WATER RESOURCES DEPT.
SALEM, OREGON

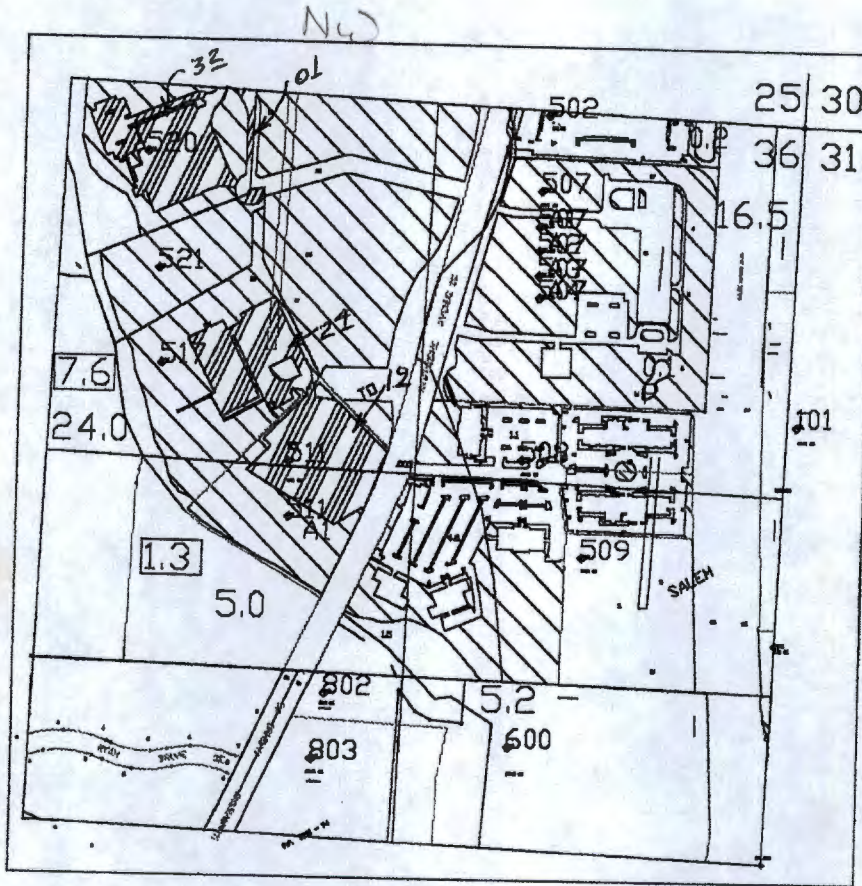

TRANSFER APPLICATION MAP FOR S.W.C.D.
07S, 3W, SECTION 36 NE QTR,

RECEIVED

AUG 31 2015

SCALE: 1" = 660'

WATER RESOURCES DEPT
SALEM, OREGON

LEGEND

6.2 = E-82 WATER RIGHT (1909) ACREAGE		= E-82 WATER RIGHT (1909)
= E-82 W.R. TRANSFER FROM ACREAGE		= E-82 W.R. TRANSFER FROM CERTIFICATE # 54286
= E-82 WR TRANSFER TO ACREAGE		

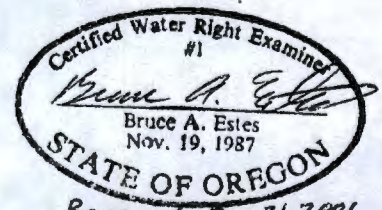

This map is for the purpose of locating a water right only and has no intent to provide legal dimensions or the location of property lines.

T 12154

ESTES SURVEYS

PO Box 17519	60382 Arnold Rd
Salem, OR 97305-7519	Bend, OR 97702
(503) 585-7593	(541) 382-7391

54286 ON .6

DINN 2-15

54286 ON
.6 SE/NE

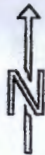

T 8635
part 1

RECEIVED

NOV 27 2000

WATER RESOURCES DEPT
SALEM, OREGON

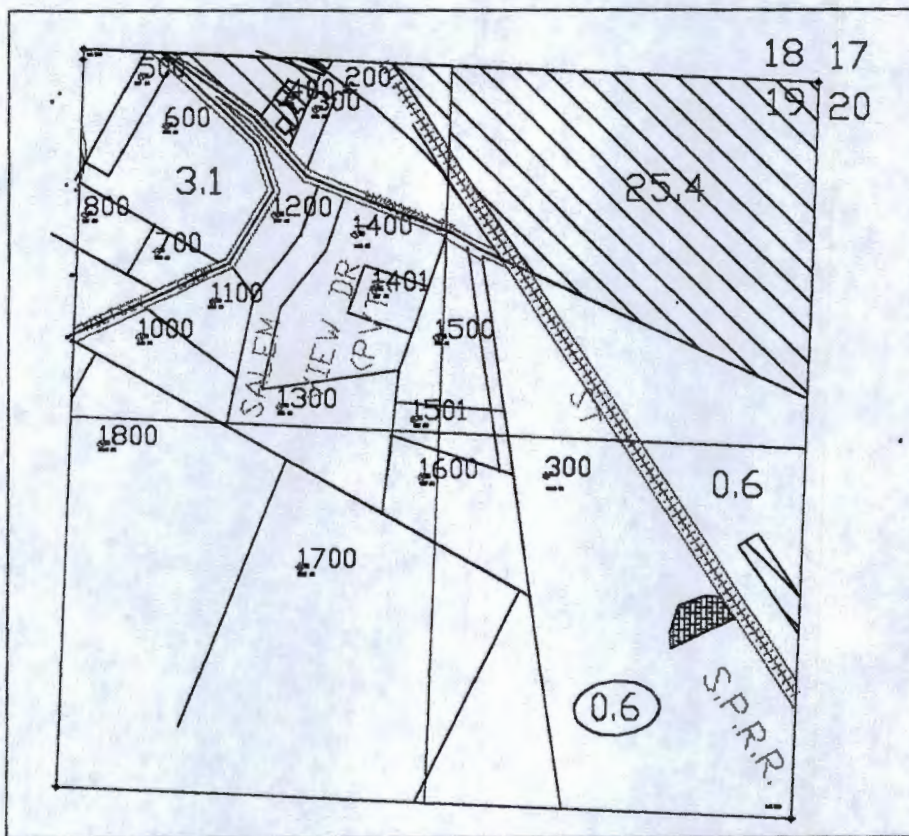

TRANSFER APPLICATION MAP FOR S.W.C.D.

08S, 2W, SECTION 19 NE QTR.





RECEIVED

AUG 31 2015

SCALE: 1" = 660'

WATER RESOURCES DEPT
SALEM, OREGON

LEGEND

6.2 = E-82 WATER RIGHT (1909) ACREAGE	 = E-82 WATER RIGHT (1909)
 = E-82 W.R. TRANSFER FROM ACREAGE	 = E-82 WR TRANSFER TO
 = E-82 WR TRANSFER TO ACREAGE	

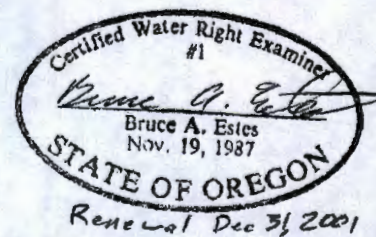

Sheet 5 of 6

T 12154

This map is for the purpose of
locating a water right only
and has no intent to provide
legal dimensions or the location
of property lines.

ESTES SURVEYS

PO Box 17519
Salem, OR 97305-7519
(503) 585-7593

60382 Arnold Rd
Bend, OR 97702
(541) 382-7391

T 8635

54286 ON
.2 NW/NE
.5 NW/NE

Part 3



RECEIVED

NOV 27 2000

WATER RESOURCES DEPT.
SALEM, OREGON

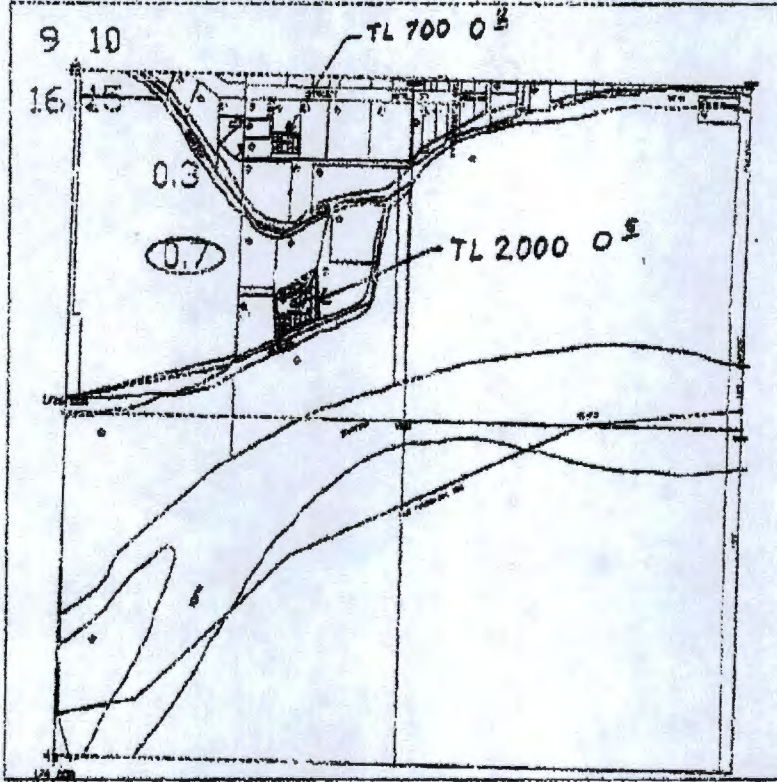





TRANSFER APPLICATION MAP FOR S.W.C.D.
09S, 1W, SECTION 15 NW QTR.
SCALE: 1" = 660'

RECEIVED

AUG 31 2015

WATER RESOURCES DEPT
SALEM, OREGON

LEGEND

6.2 = E-82 WATER RIGHT (1989) ACREAGE	 = 140L WATER RIGHT (1981)
 = W.R. TRANSFER FROM ACREAGE	 = E-82 WR TRANSFER TO
 = W.R. TRANSFER TO ACREAGE	

This map is for the purpose of locating a water right only and has no intent to provide legal dimensions or the location of property lines.

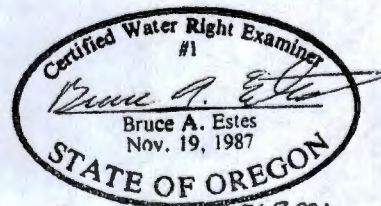

Renewal Dec 31, 2001

Sheet 1 of 2

ESTES SURVEYS

PO Box 17519 60382 Arnold Rd
Salem, OR 97305-7519 Bend, OR 97702
(503) 585-7593 (541) 382-7391

T 12154

54286 ON
1.9 SW/SE
1.7 SE/SE

N ↑
T 8635
Part 1

RECEIVED

NOV 27 2000

WATER RESOURCES DEPT.
SALEM, OREGON

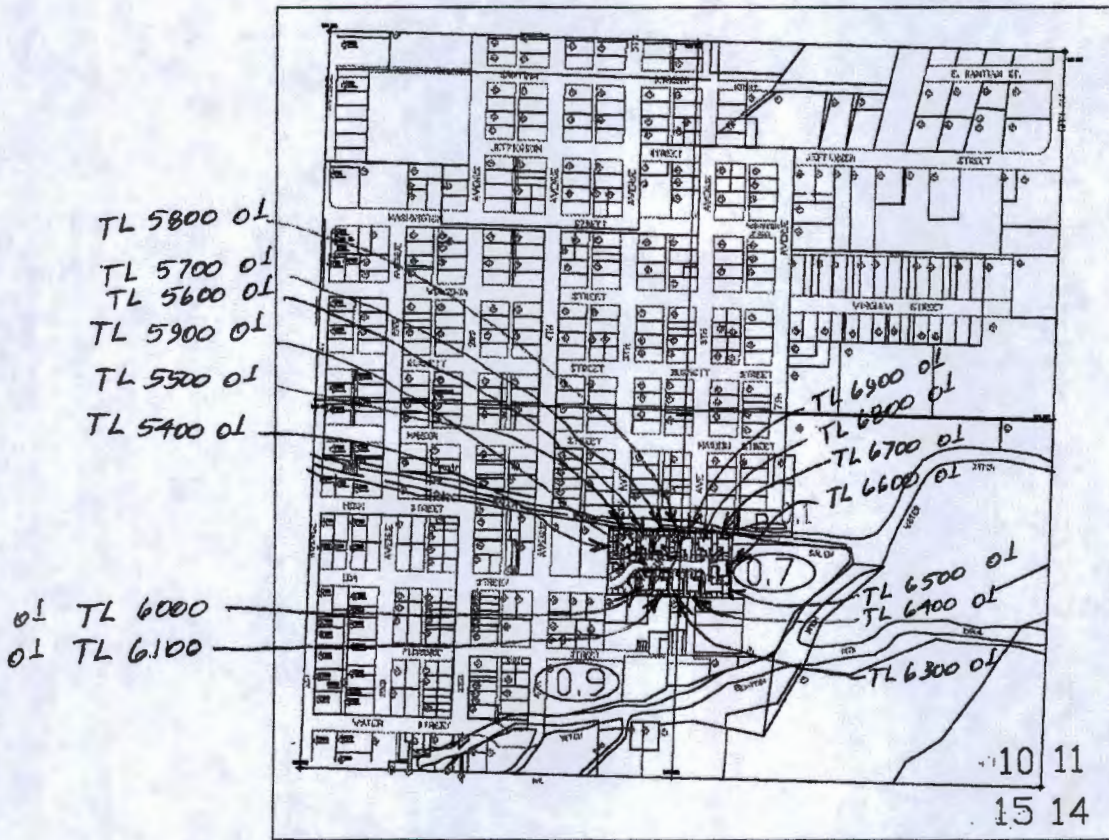

TRANSFER APPLICATION MAP FOR S.W.C.D.

09S, 1W, SECTION 10 ^{SE} NE QTR. **RECEIVED**

SCALE: 1" = 660'

AUG 31 2015

WATER RESOURCES DEPT.
SALEM, OREGON

LEGEND

6.2 = E-82 WATER RIGHT (1909) ACREAGE	= E-82 WATER RIGHT (1909)
= E-82 W.R. TRANSFER FROM ACREAGE	= E-82 WR TRANSFER TO
= E-82 WR TRANSFER TO ACREAGE	

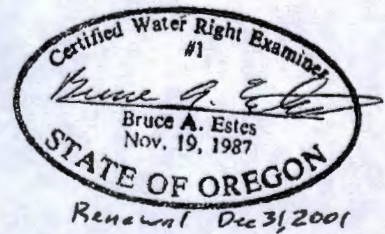

Sheet 3 of 6

T 12154

This map is for the purpose of locating a water right only and has no intent to provide legal dimensions or the location of property lines.

ESTES SURVEYS
 PO Box 17519 60382 Arnold Rd
 Salem, OR 97305-7519 Bend, OR 97702
 (503) 585-7593 (541) 382-7391

54286 ON
.5 NE/SE



T8635
part 1

RECEIVED

NOV 27 2000

WATER RESOURCES DEPT.
SALEM, OREGON



TRANSFER APPLICATION MAP FOR S.W.C.D.

08S, 2W, SECTION 29 SE QTR

RECEIVED

SCALE: 1" = 660'

AUG 31 2015

WATER RESOURCES DEPT
SALEM, OREGON

LEGEND

6.2 = E-82 WATER RIGHT (1909) ACREAGE		= E-82 WATER RIGHT (1909)
= E-82 W.R. TRANSFER FROM ACREAGE		
= E-82 WR TRANSFER TO ACREAGE		= E-82 WR TRANSFER TO

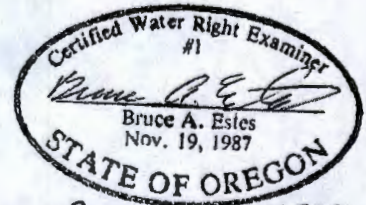

Renewal Dec 31, 2001

Sheet 6 of 6

This map is for the purpose of locating a water right only and has no intent to provide legal dimensions or the location of property lines.

T 12154

ESTES SURVEYS

PO Box 17519 Salem, OR 97305-7519 (503) 585-7593
60382 Arnold Rd Bend, OR 97702 (541) 382-7391

54286 ON
.1 NE 1 NW

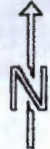

T 8635
Part 1

RECEIVED
NOV 27 2000

WATER RESOURCES DEPT.
SALEM, OREGON

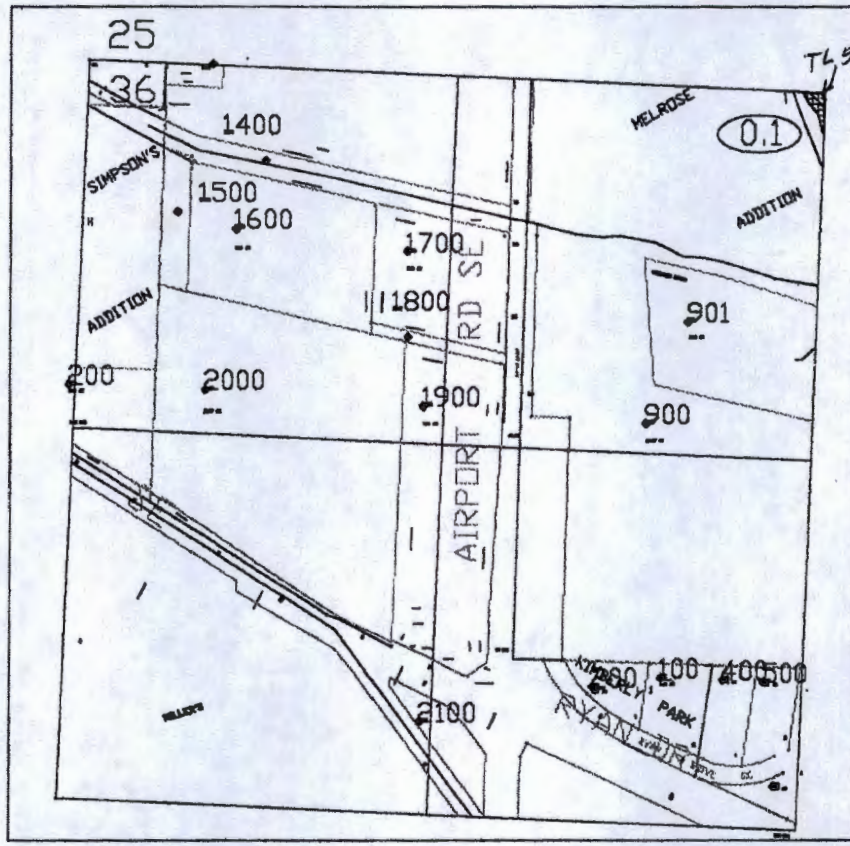

TRANSFER APPLICATION MAP FOR S.W.C.D.
07S, 3W, SECTION 36 NW QTR





SCALE: 1" = 660'

RECEIVED

AUG 31 2015

WATER RESOURCES DEPT
SALEM, OREGON

LEGEND

6.2 = E-82 WATER RIGHT (1909) ACREAGE		= E-82 WATER RIGHT (1909) CERTIFICATE # 54286
 = E-82 W.R. TRANSFER FROM ACREAGE		
 = E-82 WR TRANSFER TO ACREAGE		= E-82 WR TRANSFER TO

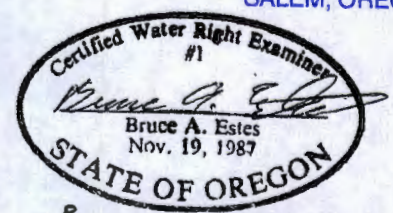

Renewal Dec 31, 2001

Sheet 4 of 6

ESTES SURVEYS

PO Box 17519 Salem, OR 97305-7519 (503) 585-7593
60382 Arnold Rd Bend, OR 97702 (541) 382-7391

T 12154

This map is for the purpose of locating a water right only and has no intent to provide legal dimensions or the location of property lines.

54286 ON

- .1 SW/NE ✓
- .1,4 SW/NE ✓
- .1,2 NW/NE ✓
- .1,9 NW/NE ✓
- .2 NW/NE ✓

T 8635
 ↑ N
 part 4

RECEIVED

NOV 27 2000

WATER RESOURCES DEPT.
SALEM, OREGON

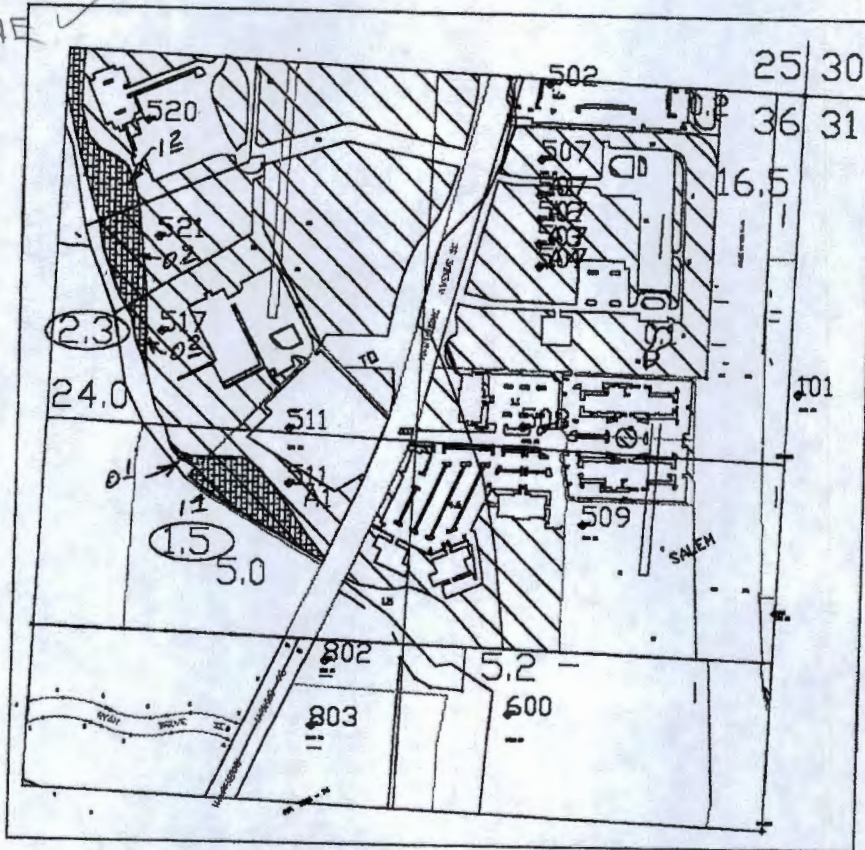

RECEIVED

AUG 31 2015

WATER RESOURCES DEPT.
SALEM, OREGON

TRANSFER APPLICATION MAP FOR S.W.C.D.

07S, 3W, SECTION 36 NE QTR.

SCALE: 1" = 660'

L100
cl Epping

LEGEND

6.2 = E-82 WATER RIGHT (1909) ACREAGE	= E-82 WATER RIGHT (1909)
= E-82 W.R. TRANSFER FROM ACREAGE	= E-82 WR TRANSFER TO
= E-82 WR TRANSFER TO ACREAGE	

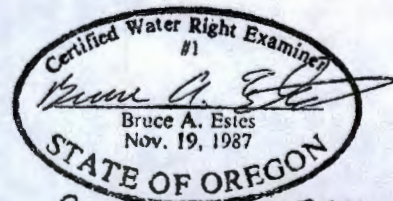

Renewal Dec 31, 2001
Sheet 3 of 5

T 12154

This map is for the purpose of locating a water right only and has no intent to provide legal dimensions or the location of property lines.

ESTES SURVEYS

PO Box 17519 60382 Arnold Rd
 Salem, OR 97305-7519 Bend, OR 97702
 (503) 585-7593 (541) 382-7391

54286 ON
.7 SWINE

T 8635
part 2

RECEIVED

NOV 27 2000

WATER RESOURCES DEPT.
SALEM, OREGON

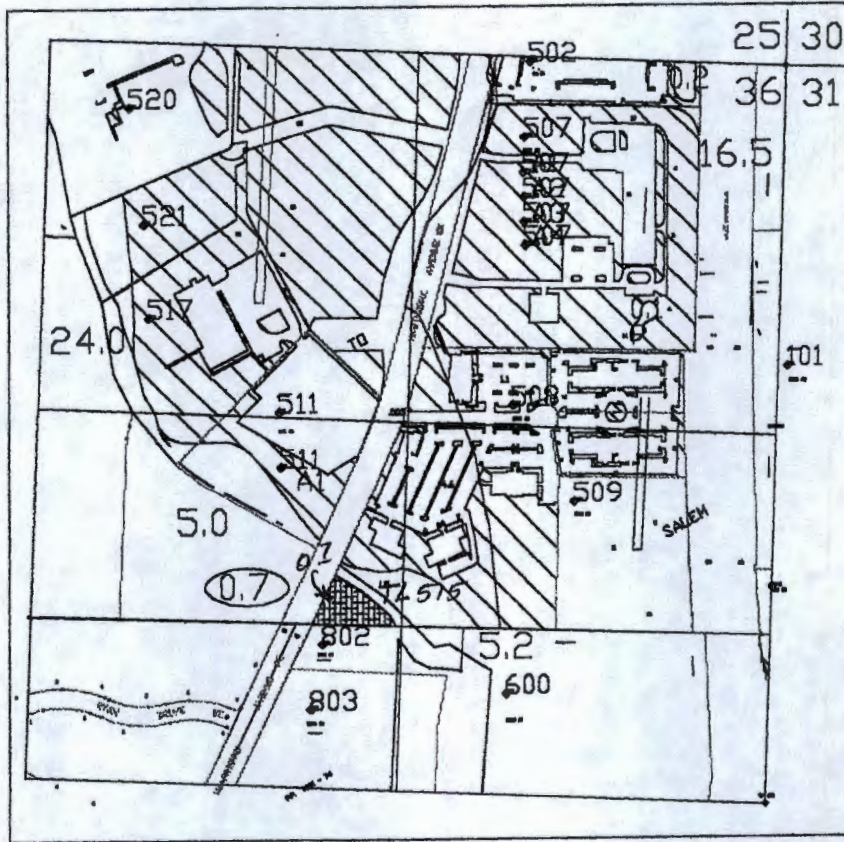

TRANSFER APPLICATION MAP FOR S.W.C.D.

07S, 3W, SECTION 36 NE QTR.

SCALE: 1" = 660'

RECEIVED

AUG 31 2015

WATER RESOURCES DEPT
SALEM, OREGON

LEGEND

- 6.2 = E-82 WATER RIGHT (1909) ACREAGE
- 6.2 (circled) = E-82 W.R. TRANSFER FROM ACREAGE
- 6.2 (circled with dot) = E-82 WR TRANSFER TO ACREAGE
- [Hatched Box] = E-82 WATER RIGHT (1909)
- [Grid Box] = E-82 WR TRANSFER TO

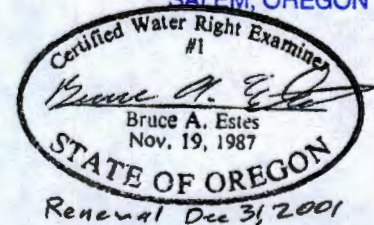

Sheet 2 of 3

ESTES SURVEYS

PO Box 17519
Salem, OR 97305-7519
(503) 585-7593

60382 Arnold Rd
Bend, OR 97702
(541) 382-7391

T 12154

This map is for the purpose of locating a water right only and has no intent to provide legal dimensions or the location of property lines.

54286 ON 1.9 DINN 2-1513

54286 ON
1.2 SEINE
1.7 SEINE

T 8635
part 4

RECEIVED

NOV 27 2000

WATER RESOURCES DEPT.
SALEM, OREGON

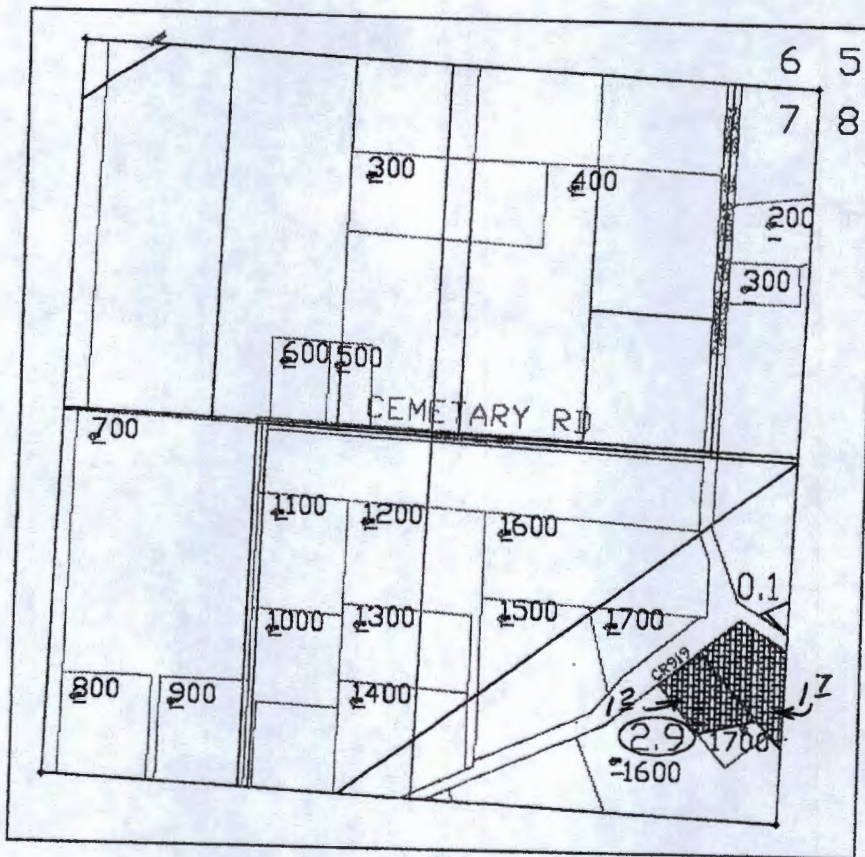

TRANSFER APPLICATION MAP FOR S.W.C.D.

09S, 2W, SECTION 7 NE QTR.

SCALE: 1" = 660'

RECEIVED

AUG 31 2015

WATER RESOURCES DEPT
SALEM, OREGON

LEGEND

6.2 = E-82 WATER RIGHT (1909) ACREAGE	= E-82 WATER RIGHT (1909)
= E-82 W.R. TRANSFER FROM ACREAGE	= E-82 WR TRANSFER TO
= E-82 WR TRANSFER TO ACREAGE	

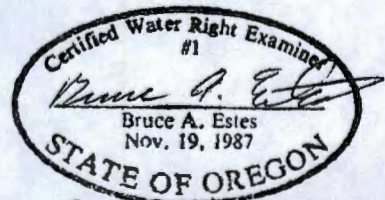

Renewal Dec 31, 2001
Sheet 2 of 5

T 12154

This map is for the purpose of locating a water right only and has no intent to provide legal dimensions or the location of property lines.

ESTES SURVEYS

PO Box 17519	60382 Arnold Rd
Salem, OR 97305-7519	Bend, OR 97702
(503) 585-7593	(541) 382-7391

54286 ON 1.4 DINN 2-1514

54286 ON
1.4 SW/NW



RECEIVED

NOV 27 2000

WATER RESOURCES DEPT.
SALEM, OREGON

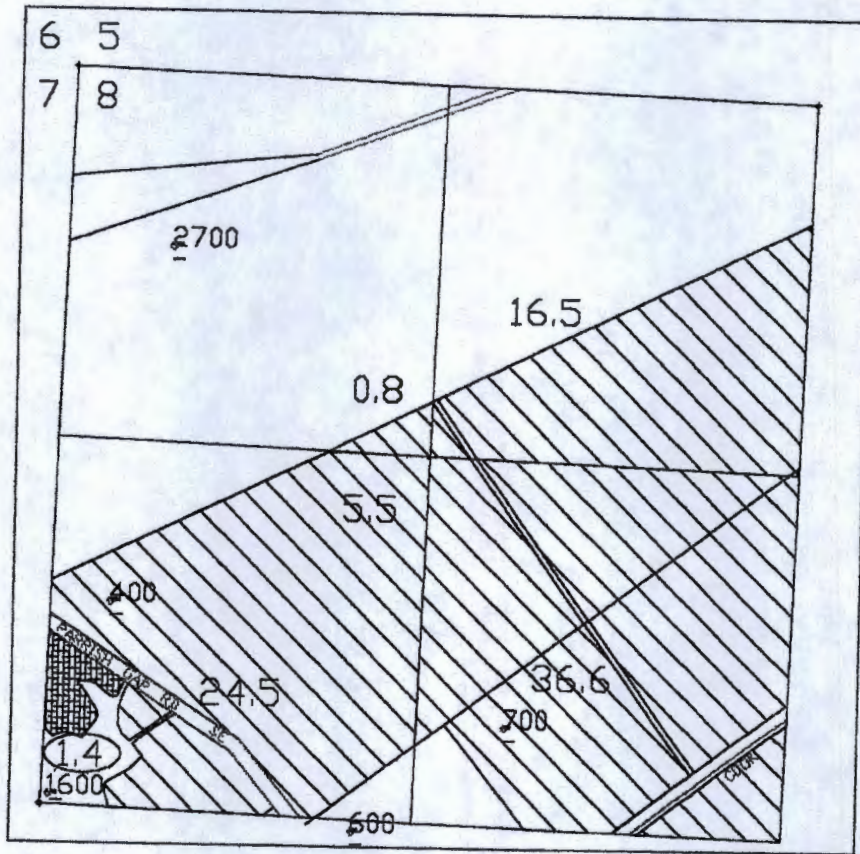

TRANSFER APPLICATION MAP FOR S.W.C.D.

09S, 2W, SECTION 8 NW QTR.



RECEIVED

SCALE: 1" = 660'

AUG 31 2015

WATER RESOURCES DEPT
SALEM, OREGON

LEGEND

- 6.2 = E-82 WATER RIGHT (1909) ACREAGE
- 6.2 = E-82 W.R. TRANSFER FROM ACREAGE
- 6.2 = E-82 WR TRANSFER TO ACREAGE
-  = E-82 WATER RIGHT (1909)
-  = E-82 WR TRANSFER TO

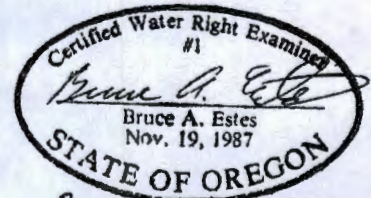

Renewal Dec 31, 2001
Sheet 5 of 5

T 12154

This map is for the purpose of locating a water right only and has no intent to provide legal dimensions or the location of property lines.

ESTES SURVEYS

PO Box 17519
Salem, OR 97305-7519
(503) 585-7593

60382 Arnold Rd
Bend, OR 97702
(541) 382-7391

54286 ON .8 DINN 2-1515

54286 ON
.8 NEISE

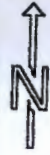

T 8635
part 4

RECEIVED

NOV 27 2000

WATER RESOURCES DEPT.
SALEM, OREGON

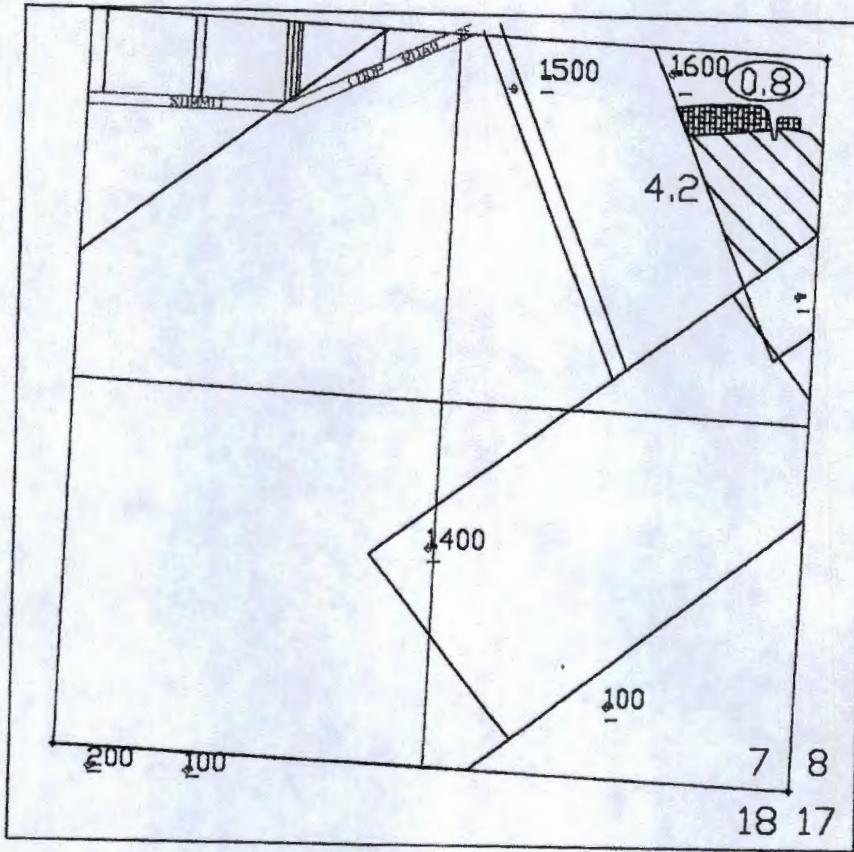

TRANSFER APPLICATION MAP FOR S.W.C.D.

09S, 2W, SECTION 7 SE QTR.

RECEIVED

SCALE: 1" = 660'

AUG 31 2015

WATER RESOURCES DEPT
SALEM, OREGON

LEGEND

- 6.2 = E-82 WATER RIGHT (1909) ACREAGE = E-82 WATER RIGHT (1909)
- = E-82 W.R. TRANSFER FROM ACREAGE
- = E-82 WR TRANSFER TO ACREAGE = E-82 WR TRANSFER TO

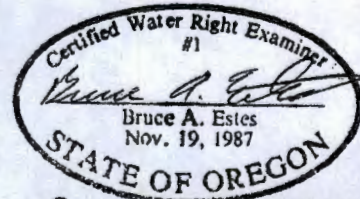

ESTES SURVEYS

PO Box 17519 60382 Arnold Rd
Salem, OR 97305-7519 Bend, OR 97702
(503) 585-7593 (541) 382-7391

This map is for the purpose of locating a water right only and has no intent to provide legal dimensions or the location of property lines.

T 12154

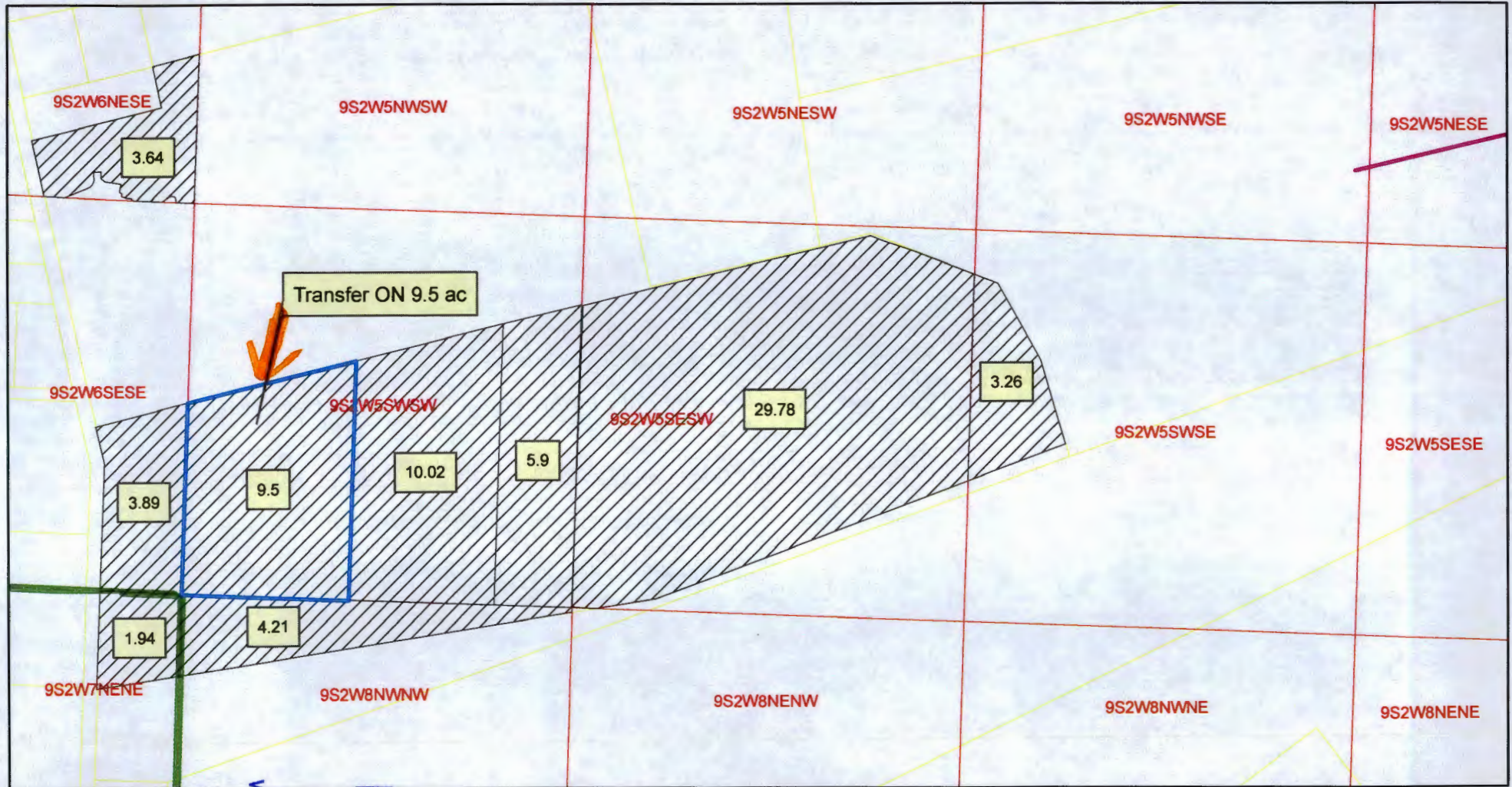

Smith
R35129
Cert 54286 transfer ON
9.5 SWSW

- Legend**
- Santiam Canals Name**
- Private Lateral
 - QtrQtr
 - taxlot

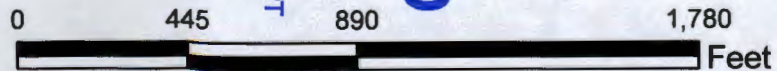

RECEIVED
 AUG 31 2015
 WATER RESOURCES DEPT
 SALEM, OREGON

T 12154

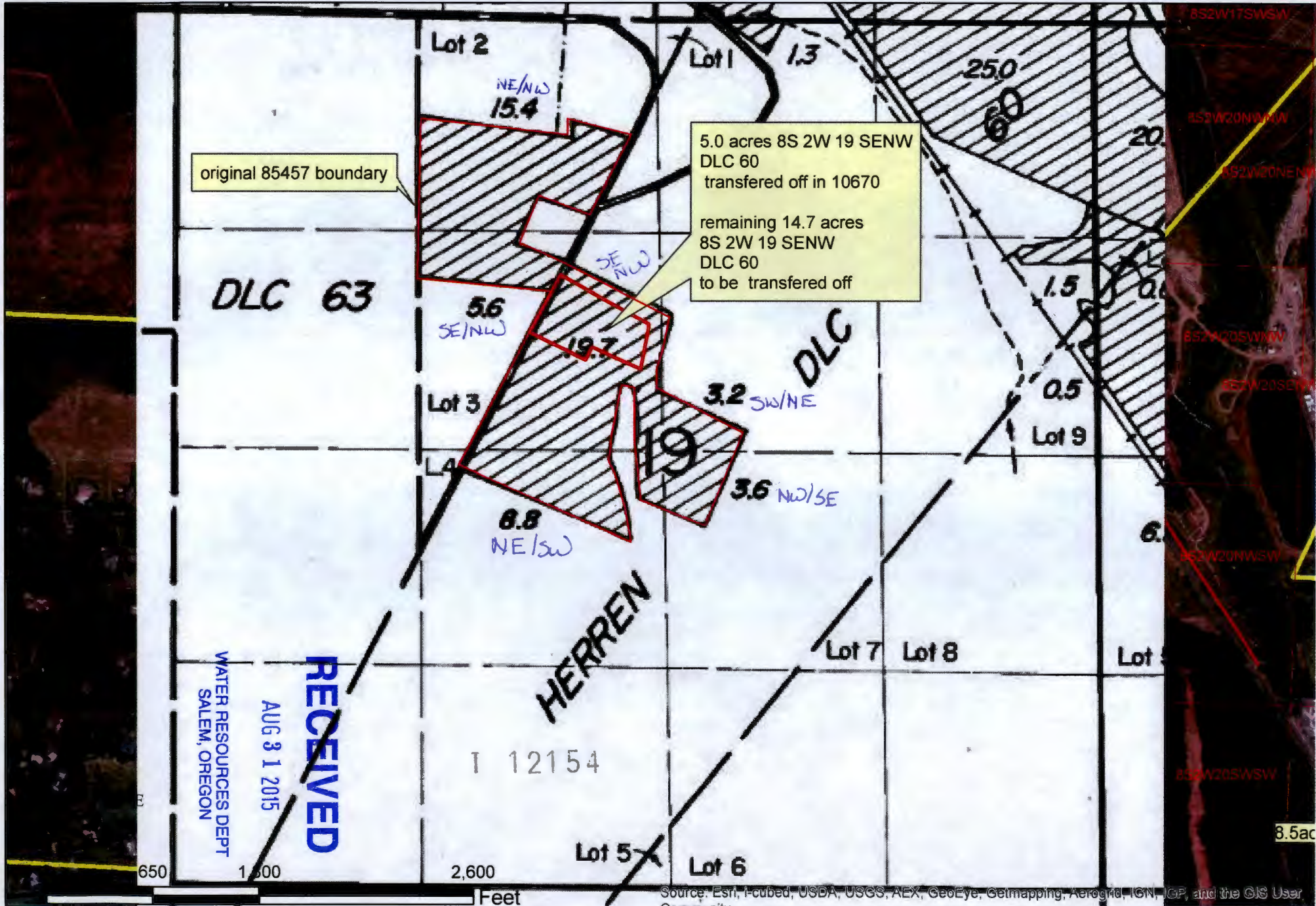

85457 ON 2.30 Acres DINN 3-152

RECEIVED

NOV 22 2000

WATER RESOURCES DEPT
SALEM, OREGON



T-8632

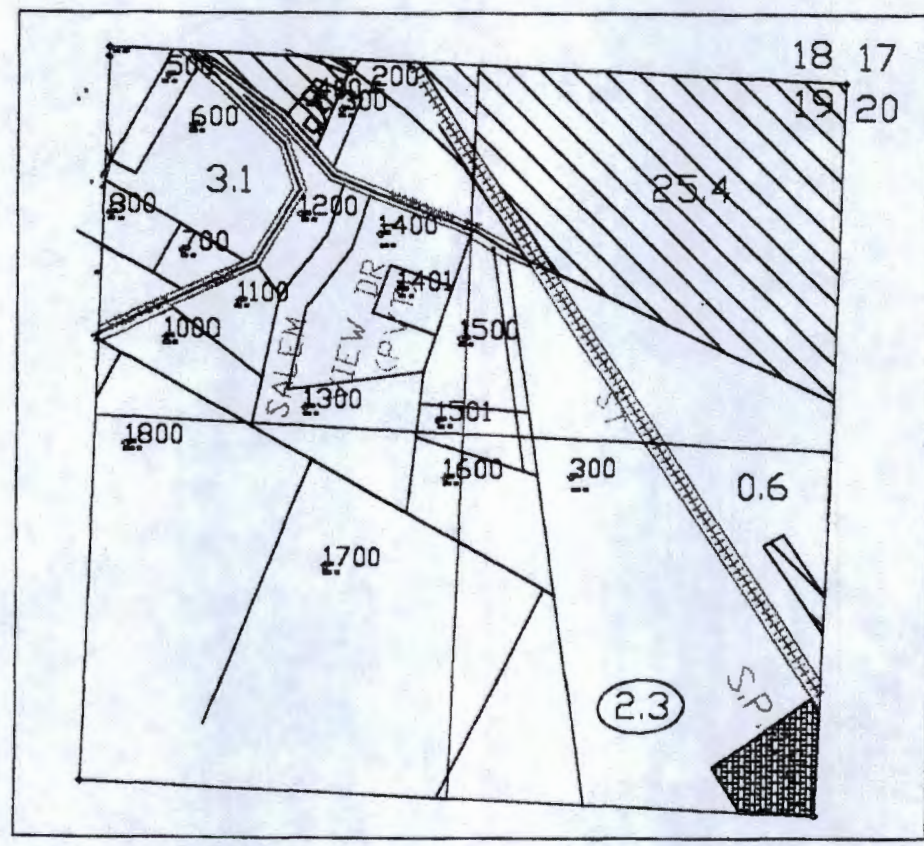

TRANSFER APPLICATION MAP FOR S.W.C.D.





08S, 2W, SECTION 19 NE QTR. RECEIVED

SCALE: 1" = 660'

AUG 31 2015

WATER RESOURCES DEPT
SALEM, OREGON

LEGEND

6.2 = E-82 WATER RIGHT (1909) ACREAGE	 = E-82 WATER RIGHT (1909)
 = E-82 VR. TRANSFER FROM ACREAGE	
 = E-82 VR TRANSFER TO ACREAGE	 = E-82 VR TRANSFER TO

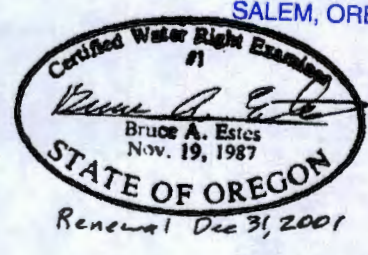

Sheet 5 of 15

T 12154

This map is for the purpose of locating a water right only and has no intent to provide legal dimensions or the location of property lines.

ESTES SURVEYS

PO Box 17519
Salem, OR 97305-7519
(503) 585-7593

60382 Arnold Rd
Bend, OR 97702
(541) 382-7391

OR 85457 3.0 Acres DINN 3-152



T-8632

RECEIVED

NOV 22 2000

WATER RESOURCES DEPT
SALEM, OREGON

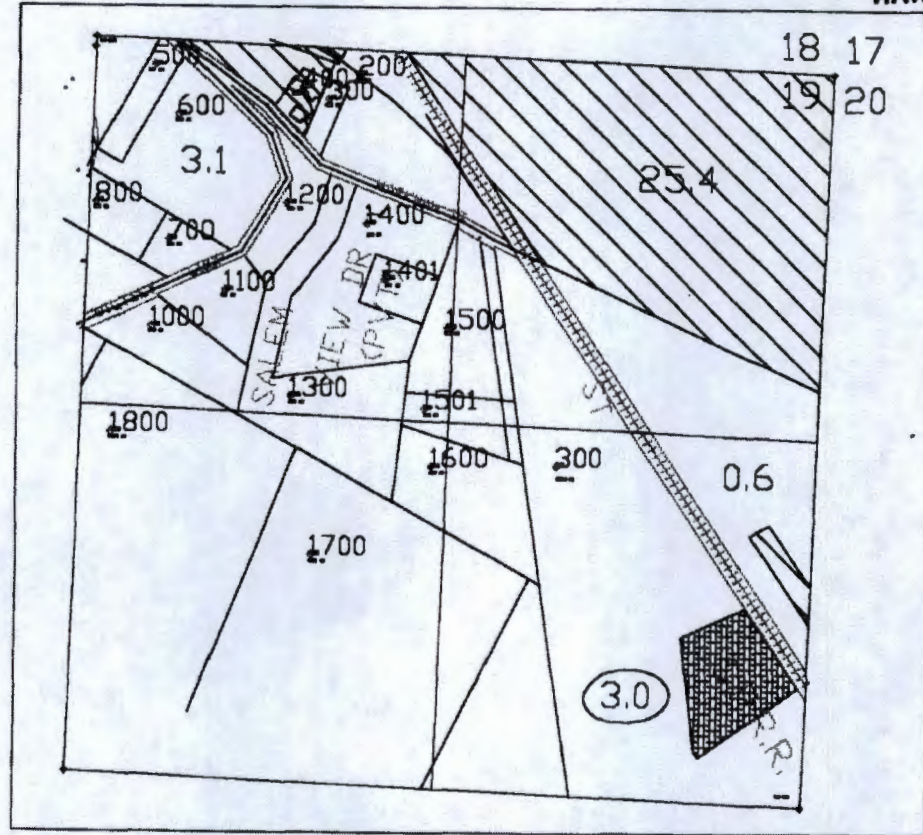

TRANSFER APPLICATION MAP FOR S.W.C.D.

08S, 2W, SECTION 19 NE QTR

RECEIVED

SCALE: 1" = 660'

AUG 31 2015

WATER RESOURCES DEPT
SALEM, OREGON

LEGEND

6.2 = E-82 WATER RIGHT (1909) ACREAGE	= E-82 WATER RIGHT (1909)
= E-82 W.R. TRANSFER FROM ACREAGE	= E-82 WR TRANSFER TO
= E-82 WR TRANSFER TO ACREAGE	



Renewal Dec 31, 2001

Sheet 12 of 15

ESTES SURVEYS

PO Box 17519 60382 Arnold Rd
 Salem, OR 97305-7519 Bend, OR 97702
 (503) 585-7593 (541) 382-7391

This map is for the purpose of locating a water right only and has no intent to provide legal dimensions or the location of property lines.

T 12154

85457 DN 1.0 Acres DINN 3-153

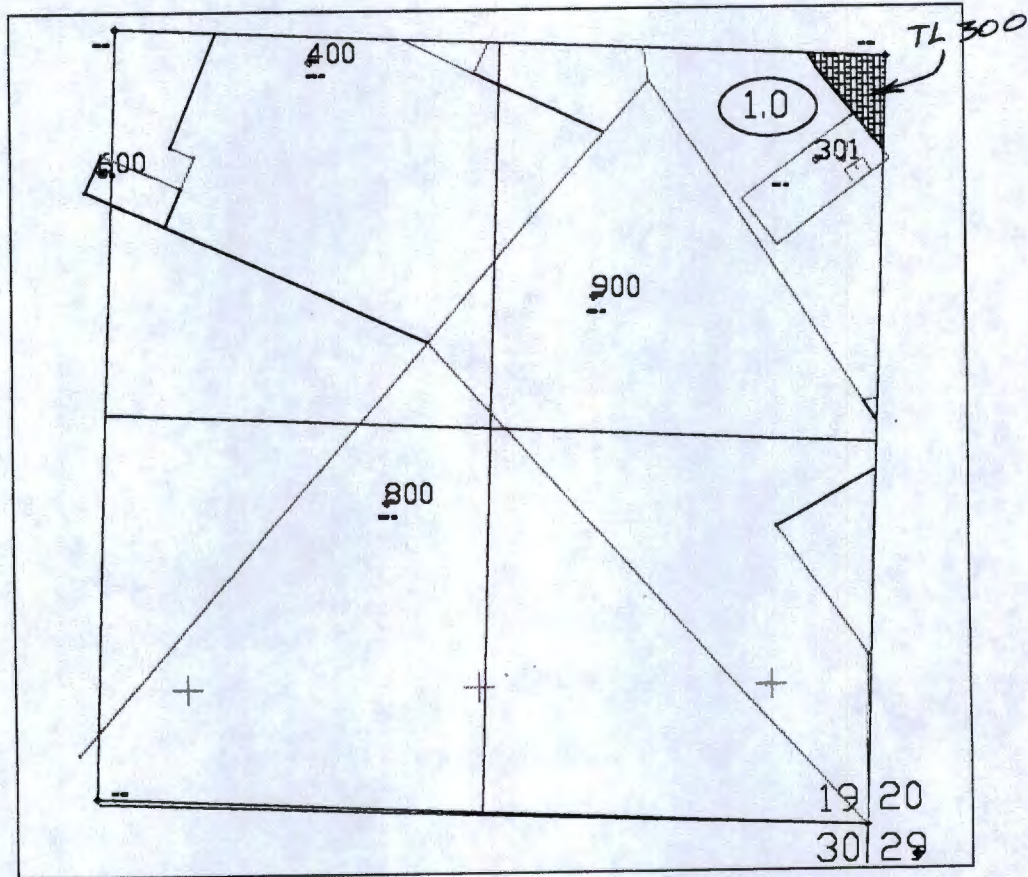
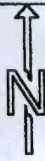





TRANSFER APPLICATION MAP FOR S.W.C.D.
 08S, 2W, SECTION 19 SE QTR
 SCALE: 1" = 660'

RECEIVED

AUG 31 2015

WATER RESOURCES DEPT
SALEM, OREGON

LEGEND

6.2 = E-82 WATER RIGHT (1909) ACREAGE	 = E-82 WATER RIGHT (1909)
 = E-82 W.R. TRANSFER FROM ACREAGE	
 = E-82 WR TRANSFER TO ACREAGE	 = E-82 WR TRANSFER TO

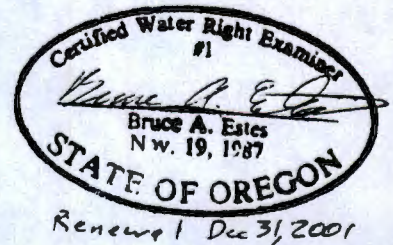

Sheet 6 of 15

T 12154

This map is for the purpose of
 locating a water right only
 and has no intent to provide
 legal dimensions or the location
 of property lines.

ESTES SURVEYS

PO Box 17519 60382 Arnold Rd
 Salem, OR 97305-7519 Bend, OR 97702
 (503) 585-7583 (541) 382-7391

85457 ON 1.2 Acres DINN 3-154

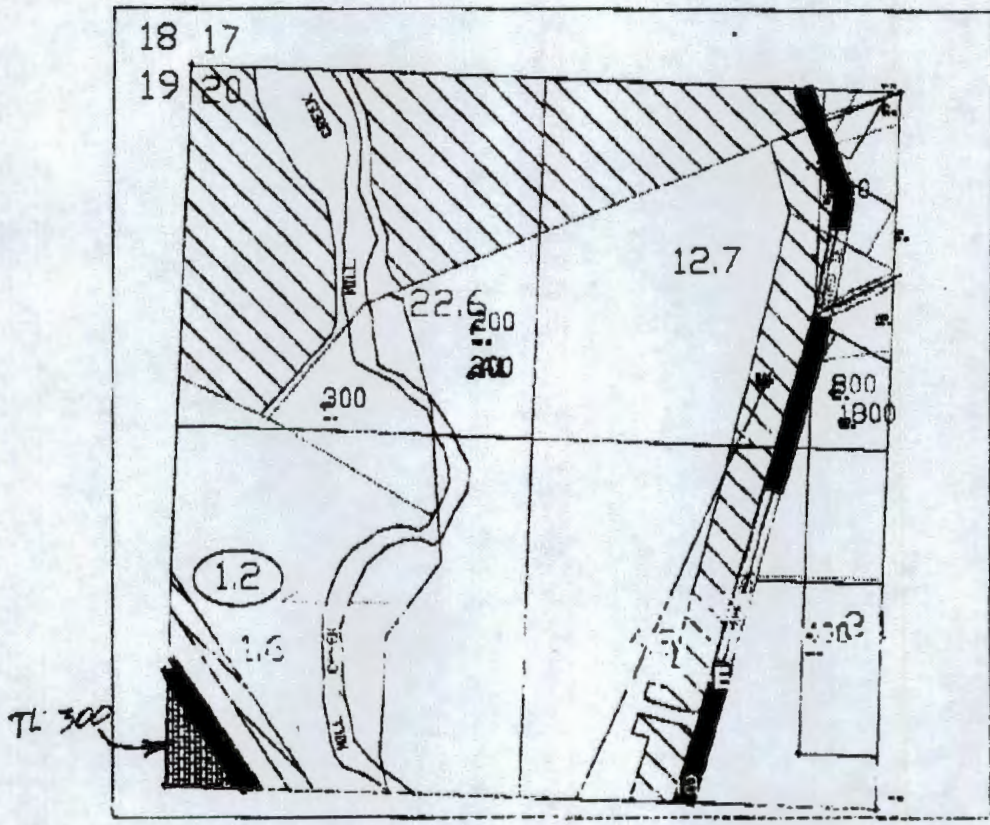

TRANSFER APPLICATION MAP FOR S.W.C.D.
 08S, 2W, SECTION 20 NW QTR.
 SCALE: 1" = 660'

RECEIVED

AUG 31 2015

WATER RESOURCES DEPT
SALEM, OREGON

LEGEND

6.2 = E-82 WATER RIGHT (1909) ACREAGE		= E-82 WATER RIGHT (1909)
= E-82 V.R. TRANSFER FROM ACREAGE		
= E-82 WR TRANSFER TO ACREAGE		= E-82 WR TRANSFER TO

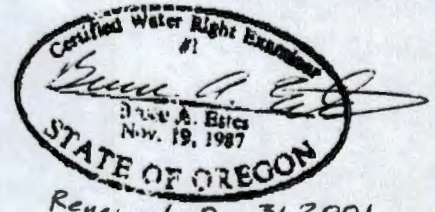

Sheet 7 of 15

This map is for the purpose of
 locating a water right only
 and has no intent to provide
 legal dimensions or the location
 of property lines.

ESTES SURVEYS
 PO Box 17518 60382 Arnold Rd
 Salem, OR 97305-7518 Bend, OR 97702
 (503) 586-7593 (541) 382-7391

85457 ON 9.6 Acres DINN 3-155

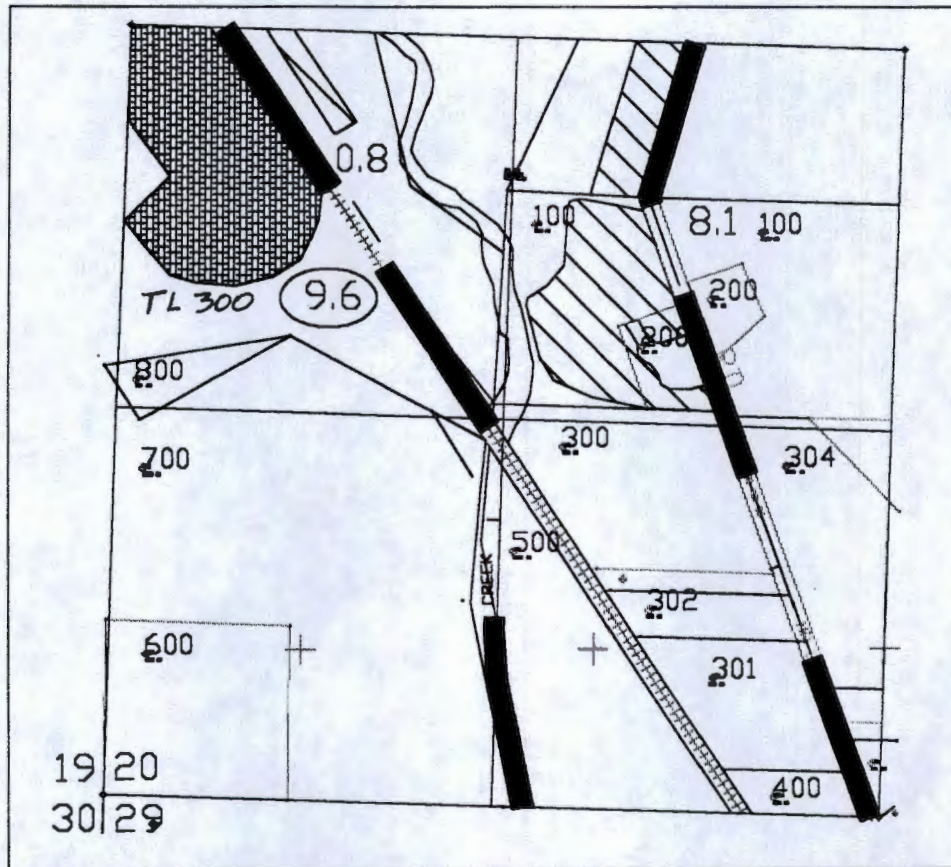
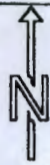

TRANSFER APPLICATION MAP FOR S.W.C.D.
08S, 2W, SECTION 20 SW QTR

SCALE: 1" = 660'

RECEIVED



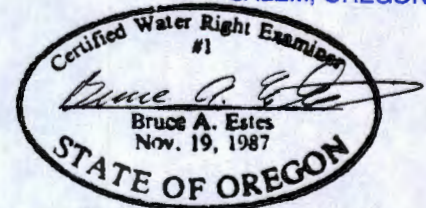

AUG 31 2015

WATER RESOURCES DEPT
SALEM, OREGON



Renewal Dec 31, 2001

LEGEND

- 6.2 = E-82 WATER RIGHT (1909) ACREAGE  = E-82 WATER RIGHT (1909)
-  = E-82 W.R. TRANSFER FROM ACREAGE
-  = E-82 WR TRANSFER TO
-  = E-82 WR TRANSFER TO ACREAGE

This map is for the purpose of locating a water right only and has no intent to provide legal dimensions or the location of property lines.

12154

Sheet 8 of 15

ESTES SURVEYS

PO Box 17519 60382 Arnold Rd
 Salem, OR 97305-7519 Bend, OR 97702
 (503) 585-7593 (541) 382-7391

85457 ON .8 Acres DINN 3-156

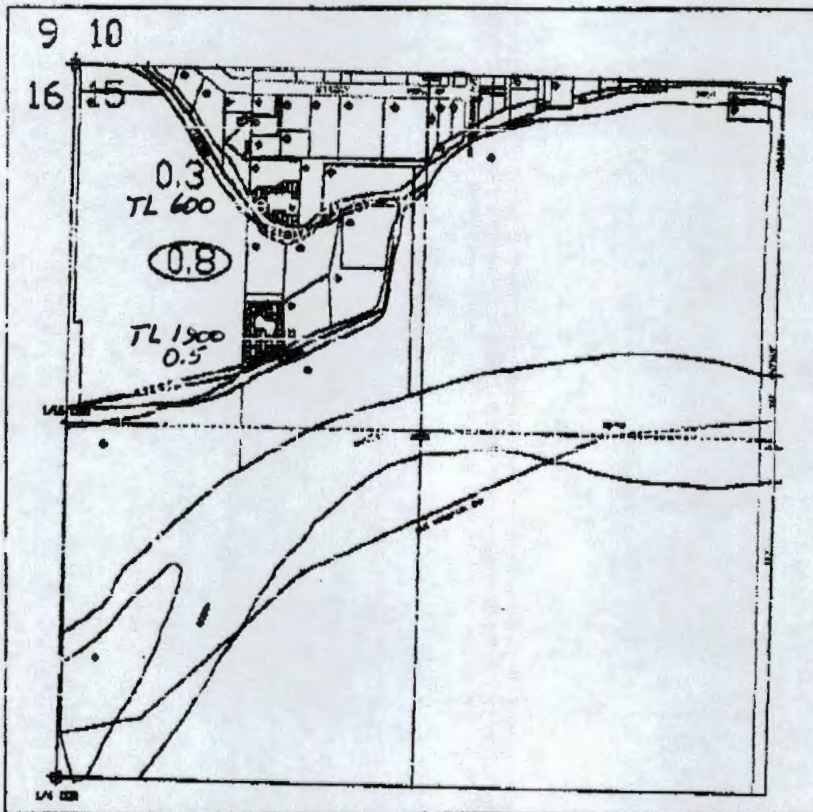
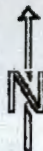

TRANSFER APPLICATION MAP FOR S.W.C.D.
09S, 1W, SECTION 15 NW QTR.





RECEIVED

AUG 31 2015

SCALE: 1" = 660'

WATER RESOURCES DEPT
SALEM, OREGON

LEGEND

- 6.2 = E-82 WATER RIGHT (1989) ACREAGE  = 1401 WATER RIGHT (1911)
-  = W.R. TRANSFER FROM ACREAGE
-  = W.R. TRANSFER TO ACREAGE  = E-82 WR TRANSFER TO

This map is for the purpose of locating a water right only and has no intent to provide legal dimensions or the location of property lines.

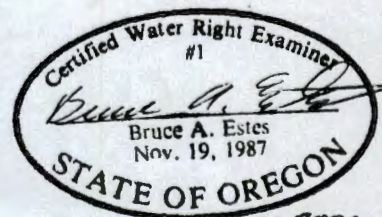

Renewal Dec 31, 2001

Sheet 14 of 15

ESTES SURVEYS

PO Box 17519 60382 Arnold Rd
Salem, OR 97305-7519 Bend, OR 97702
(503) 585-7593 (541) 382-7391

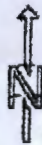

T-8633

RECEIVED

NOV 22 2000

WATER RESOURCES DEPT.
SALEM, OREGON

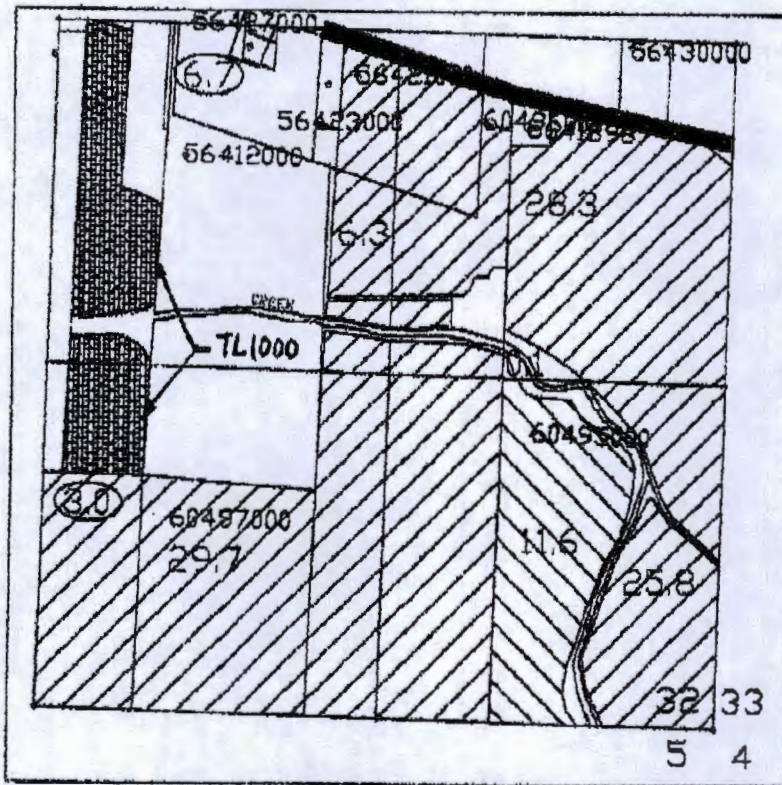

TRANSFER APPLICATION MAP FOR S.W.C.D.
08S, 1W, SECTION 32 SE QTR.

SCALE: 1" = 660'

RECEIVED

AUG 31 2015

WATER RESOURCES DEPT
SALEM, OREGON

LEGEND

6.2 = EXISTING WATER RIGHT ACREAGE	= E-92 WATER RIGHT (1909)
= WR. TRANSFER FROM ACREAGE	= 140L WATER RIGHT (1911)
= WR. TRANSFER TO ACREAGE	= PERMIT 43080 & 51318 WR TRANSFER TO

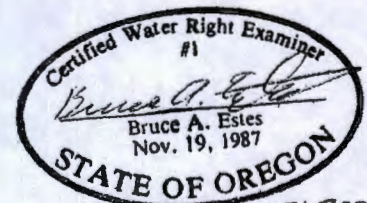

Renewal Dec 31, 2001

Sheet 3 of 3

ESTES SURVEYS

PO Box 17519
Salem, OR 97305-7519
(503) 585-7593

60382 Arnold Rd
Bend, OR 97702
(541) 382-7391

T 12154

This map is for the purpose of locating a water right only and has no intent to provide legal dimensions or the location of property lines.

ON 3.64, 3.89, 1.94, 4.21 + 10.02



District Permanent Transfer Exhibit map Dinn 3-158

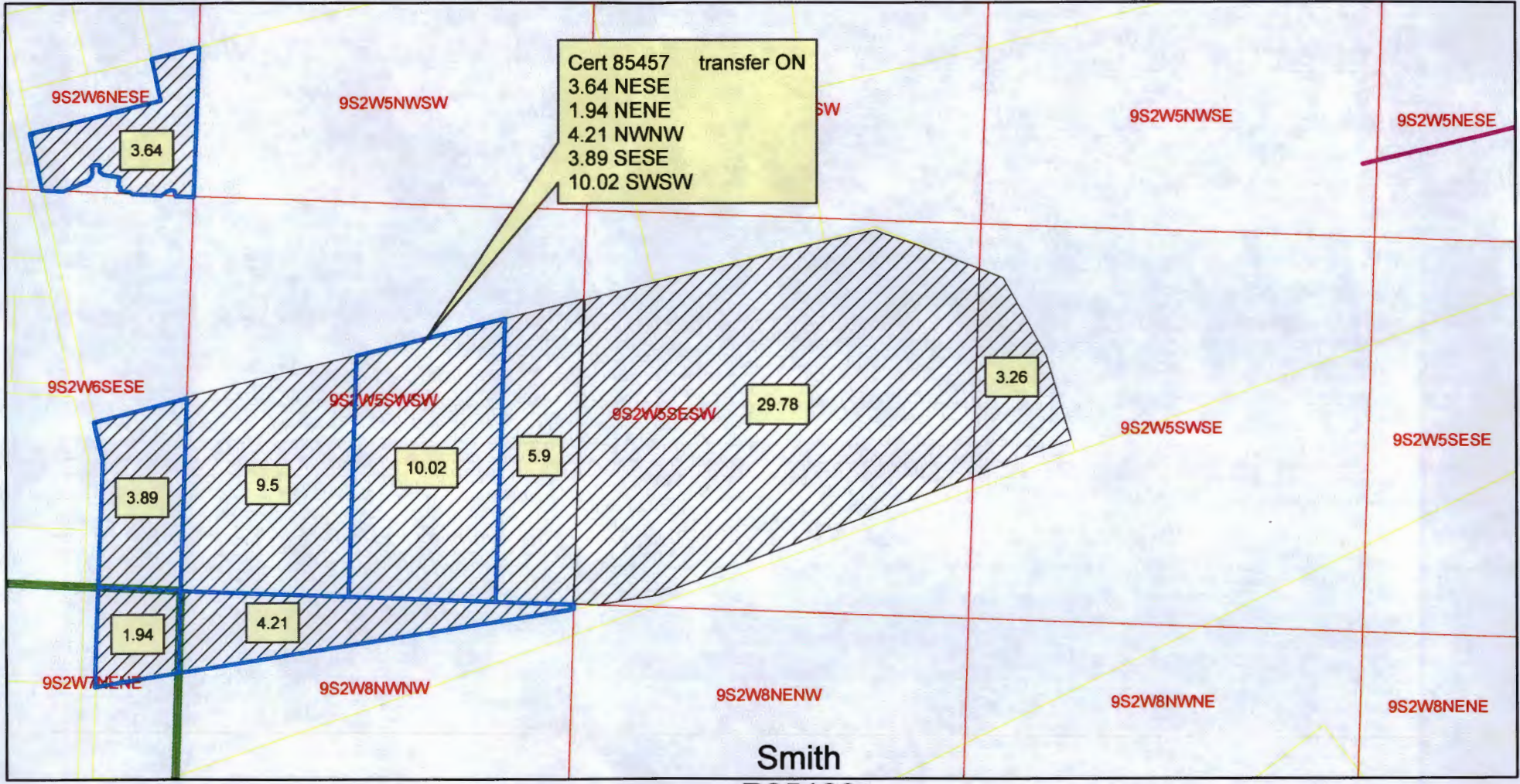

Smith

R35129

Cert 85457 transfer ON

- 3.64 NESE
- 1.94 NENE
- 4.21 NWNW
- 3.89 SESE
- 10.02 SWSW

T 12154

Legend

Santiam Canals Name

- Private Lateral
- QtrQtr
- taxlot

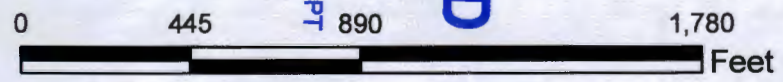

RECEIVED
 AUG 31 2015
 WATER RESOURCES DEPT
 SALEM, OREGON