

Application for a Permit Amendment in the Name of City of Prineville Proposed and Authorized Points of Appropriation

Permit G-17089, Application G-15974

Township 15 South, Range 15 East (W.M.)

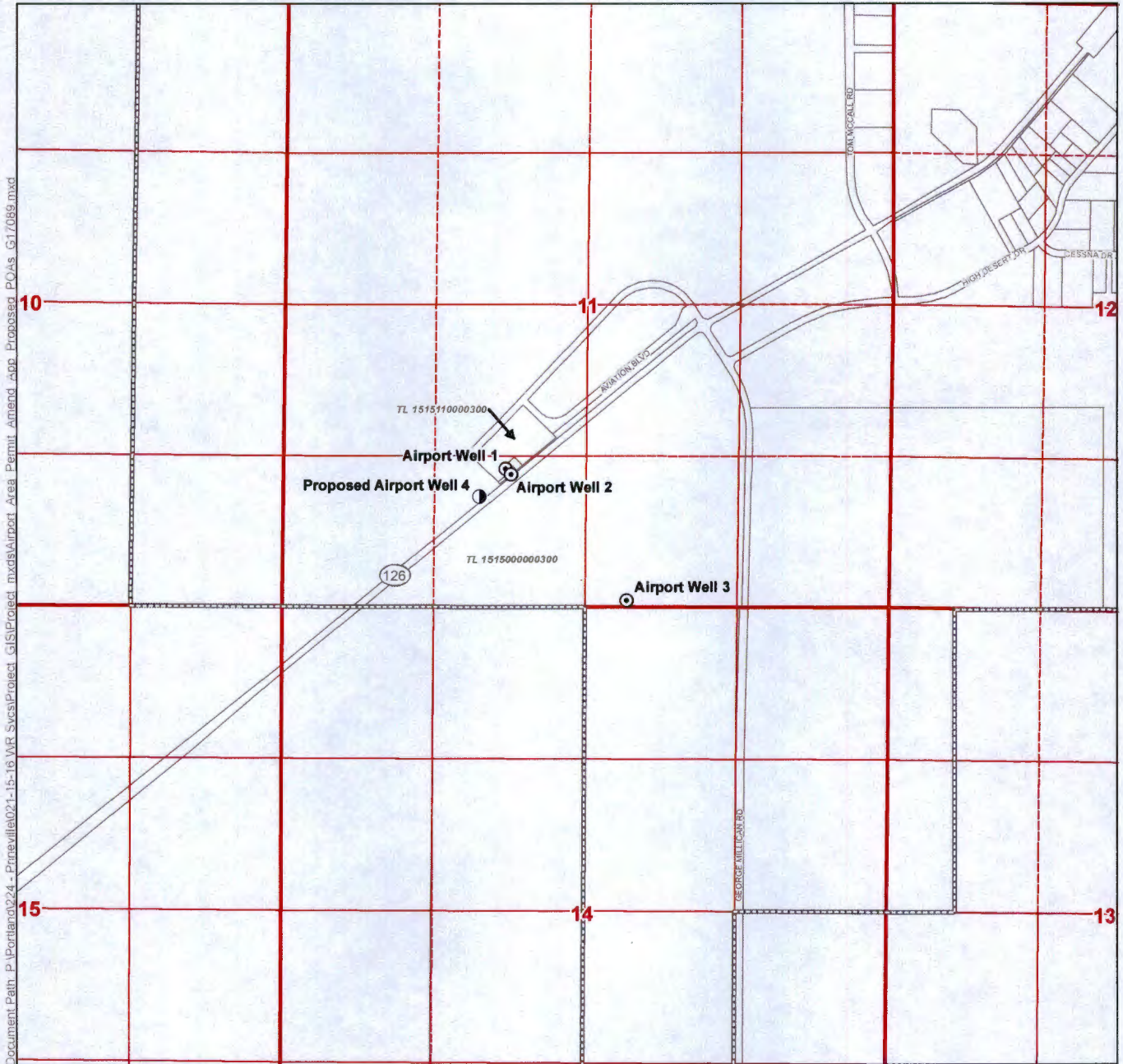

Document Path: P:\Portland\2014 - Prineville\021-15-16 WR Svcs\Project_GIS\Project_mxd\Airport Area Permit Amend App_Proposed POAs_G17089.mxd

LEGEND

- Proposed Point of Appropriation (POA)
- Authorized POA
- Prineville City Limits
- Tax Lots

POA LOCATION DESCRIPTIONS

- Airport Well 1**
1,210 feet North and 1,950 feet East from the SW corner of Section 11, Township 15 South, Range 15 East (W.M.)
- Airport Well 2**
1,165 feet North and 1,990 feet East from the SW corner of Section 11, Township 15 South, Range 15 East (W.M.)
- Airport Well 3**
55 feet North and 3,000 feet East from the SW corner of Section 11, Township 15 South, Range 15 East (W.M.)
- Proposed Airport Well 4**
1,070 feet North and 1,710 feet East from SW corner of Section 11, Township 15 South, Range 15 East (W.M.)

DISCLAIMER

This map was prepared for the purpose of identifying the location of a water right only and it is not intended to provide legal dimensions or location of property ownership lines.

MAP NOTES

Date: October 8, 2015
Data Sources: OWRD, Crook Co. GIS, OGIC
Prepared By: GSI Water Solutions, Inc.

RECEIVED BY OWRD

OCT. 30 2015

SALEM, OR

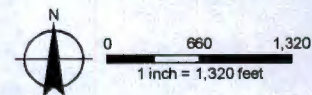

1 12192

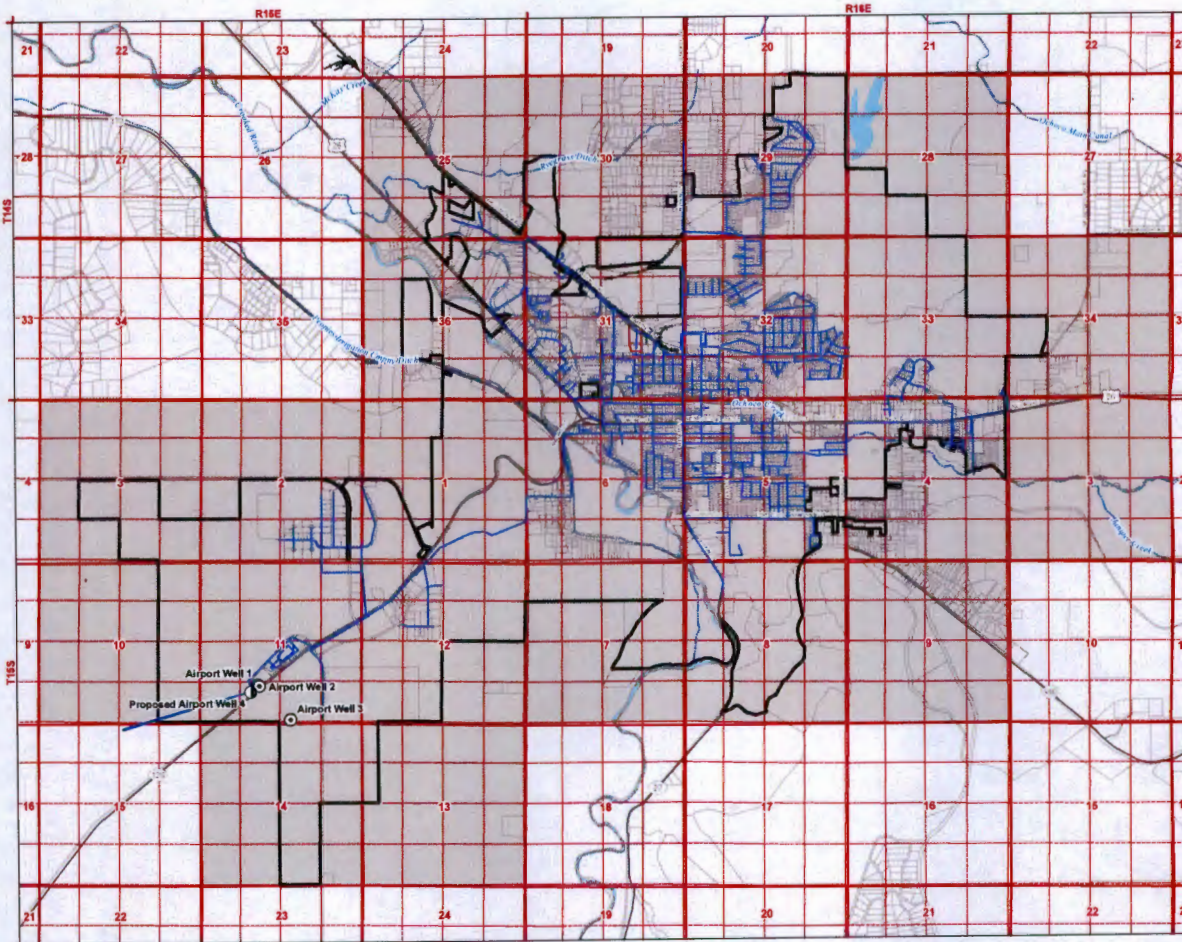

**Application for a Permit Amendment
in the Name of City of Prineville
Authorized Place of Use
Permit G-17089**

LEGEND

- Authorized Place of Use (POU)
- Proposed Point of Appropriation (POA)
- Authorized POA
- Existing Water Mainlines
- ▭ Prineville City Limits
- ▭ Tax Lots
- Major Roads
- Railroads
- Watercourses
- Waterbodies

DISCLAIMER

This map was prepared for the purpose of identifying the location of a water right only and it is not intended to provide legal dimensions or location of property ownership lines.

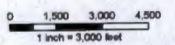

MAP NOTES:

Date: October 9, 2015
Data Sources: OWRD, Grant Co. GIS, OREGON EAPN, Water Utilities, Inc.



RECEIVED BY OWRD

OCT 30 2015

1 12192

SALEM, OR

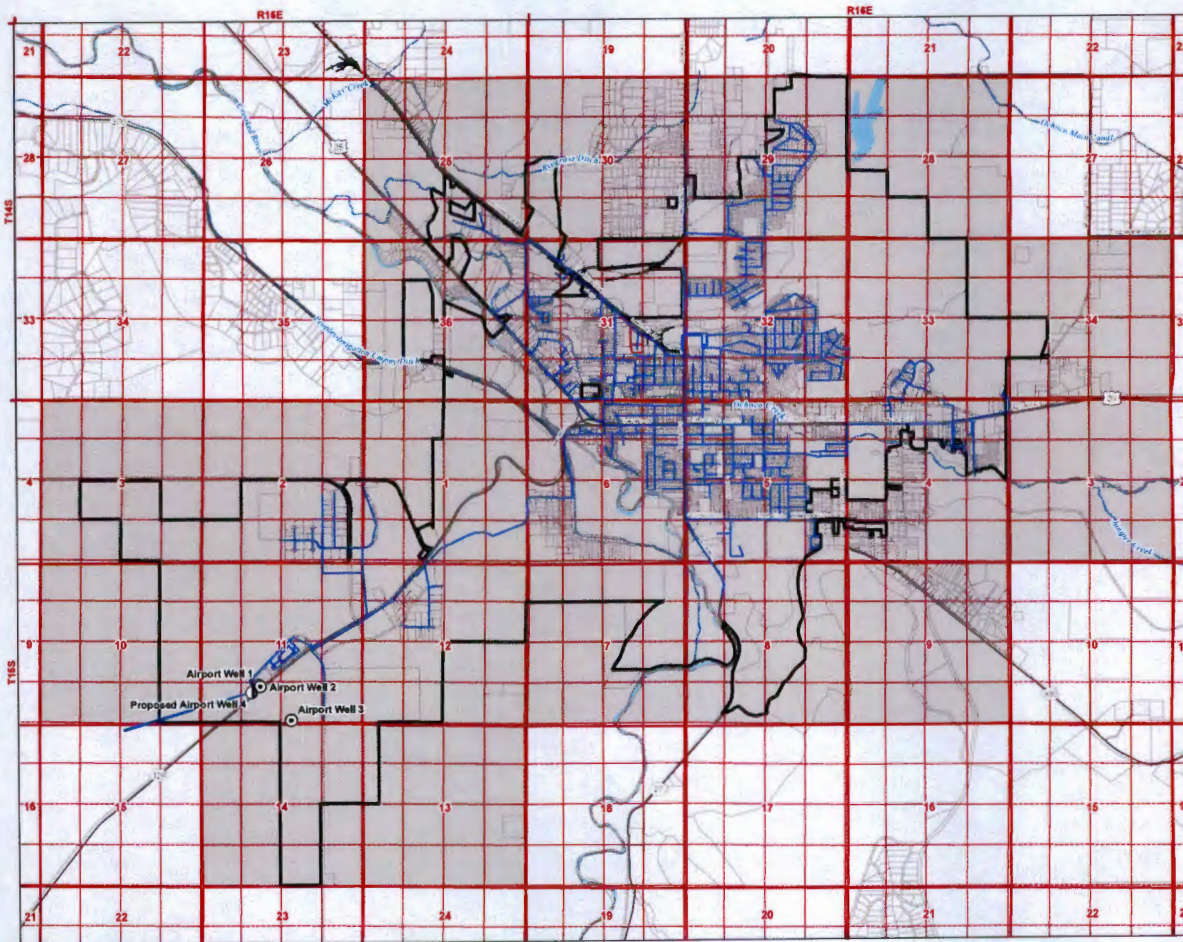

**Application for a Permit Amendment
In the Name of City of Prineville**
Authorized Place of Use
Permit G-17089

- LEGEND**
- Authorized Place of Use (POU)
 - Proposed Point of Appropriation (POA)
 - Authorized POA
 - Existing Water Mainline
 - ▭ Prineville City Limits
 - ▭ Tax Lots
 - Major Roads
 - Railroads
 - Watercourses
 - Waterbodies

DISCLAIMER
This map was prepared for the purpose of identifying the location of a water right only and it is not intended to provide legal dimensions or location of property ownership lines.

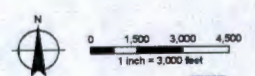

MAP NOTES:
Date: October 9, 2015
Data Sources: OWRD, Creek Co. GIS, OREGON, GSI Water Solutions, Inc.

RECEIVED BY OWRD

OCT 30 2015

SALEM, OR

T 12192