

TOWNSHIP 4 NORTH, RANGE 28 EAST, W.M.

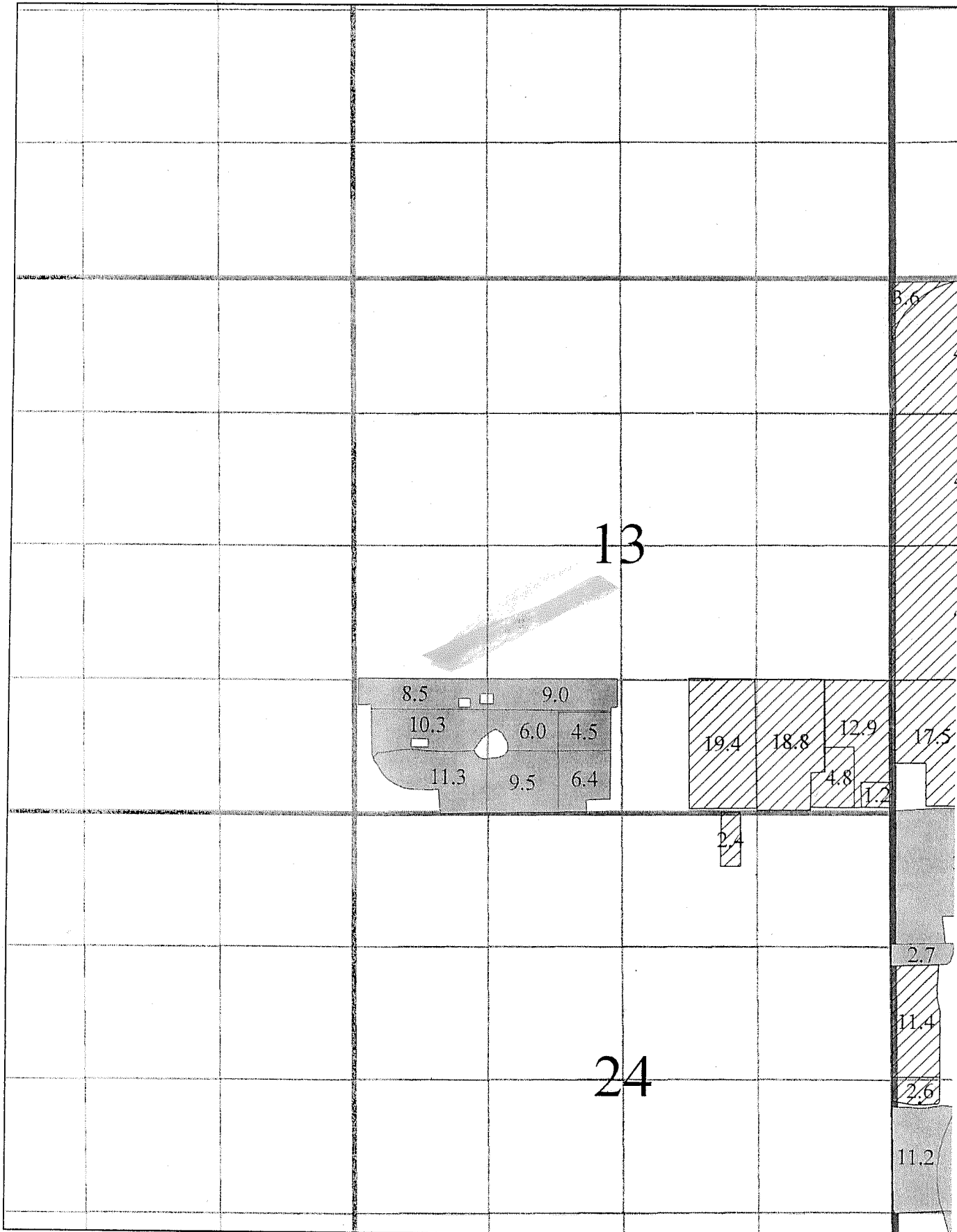

SECTIONS 13 and 24



Legend

stan428final

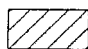
Priority

-  1905
-  1965

1 inch = 1320 feet

T10252
T10432



T 10432

TOWNSHIP 4 NORTH, RANGE 29 EAST, W.M.



SECTION 32



Legend

stan429final

Priority

-  1905
-  1965

cuts
Umatilla
 86202,
 86203,
McKay
 86204
 86205

1 inch = 660 feet



T 8397
 T 8398
 T 10432

TOWNSHIP 4 NORTH, RANGE 29 EAST, W.M.

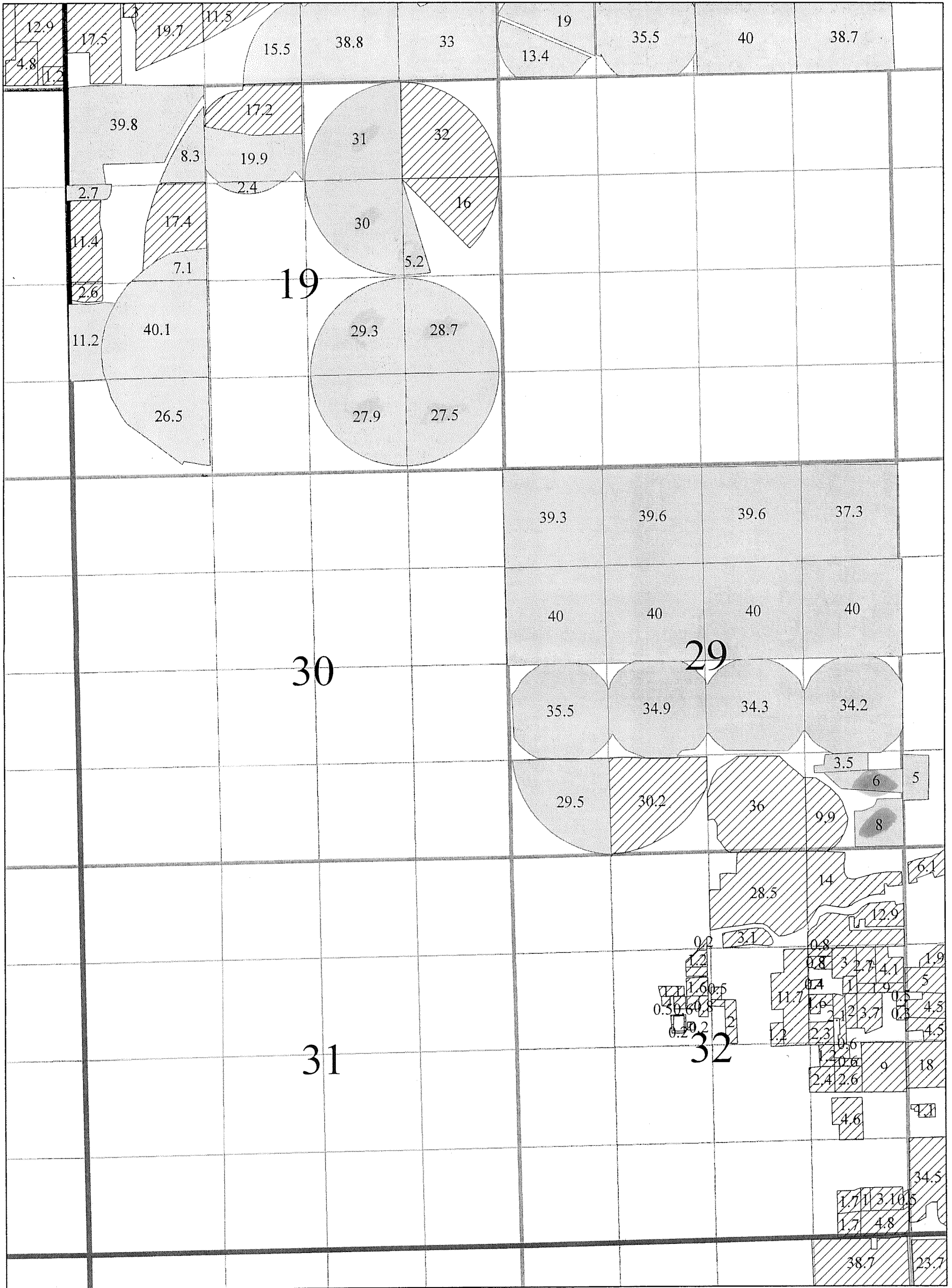

SECTIONS 19, 29, and 32



Legend

stan429final

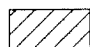
Priority

-  1905
-  1965

Certs
Umatilla 86202 86203
McKay 86204 86205

1 inch = 1320 feet

T 8560
 T 8397
 T 8398
 T 10432

TOWNSHIP 4 NORTH, RANGE 29 EAST, W.M.

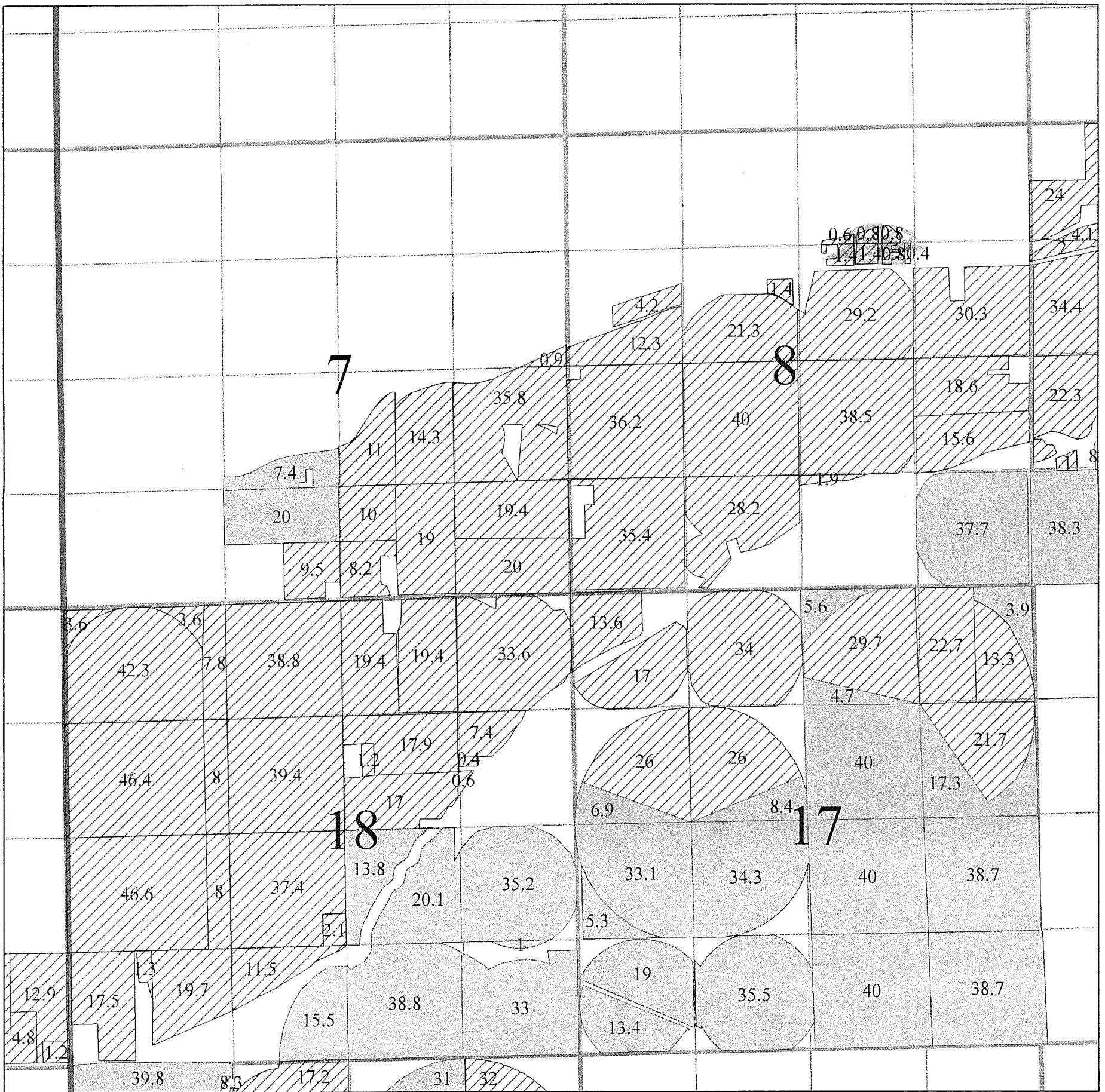

SECTIONS 7, 8, 17, and 18



Legend

stan429final

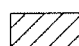
Priority

-  1905
-  1965

cents
Umatilla
86202
86203

McKay
86204
86205

1 inch = 1320 feet

T 10252
T 10432



TOWNSHIP 4 NORTH, RANGE 29 EAST, W.M.

SECTIONS 22, 27, 28, 33 and 34

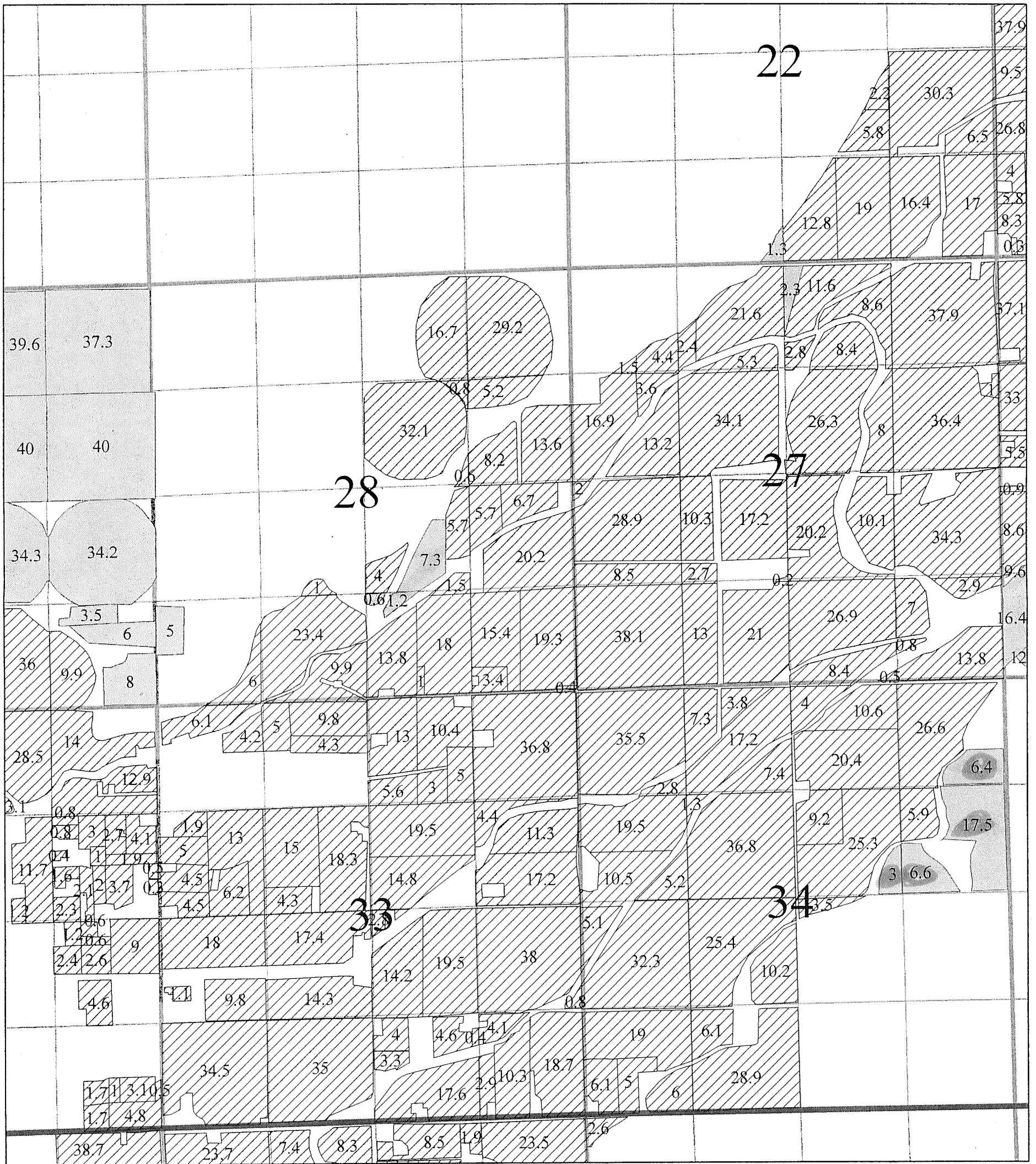

Legend

stan429final

Priority



1905



1965

cuts
Umatilla

86202

86203

McKay

86204

86205

1 inch = 1320 feet



T10432
T10690

TOWNSHIP 4 NORTH, RANGE 29 EAST, W.M.

SECTIONS 23, 24, 25, 26, and 36

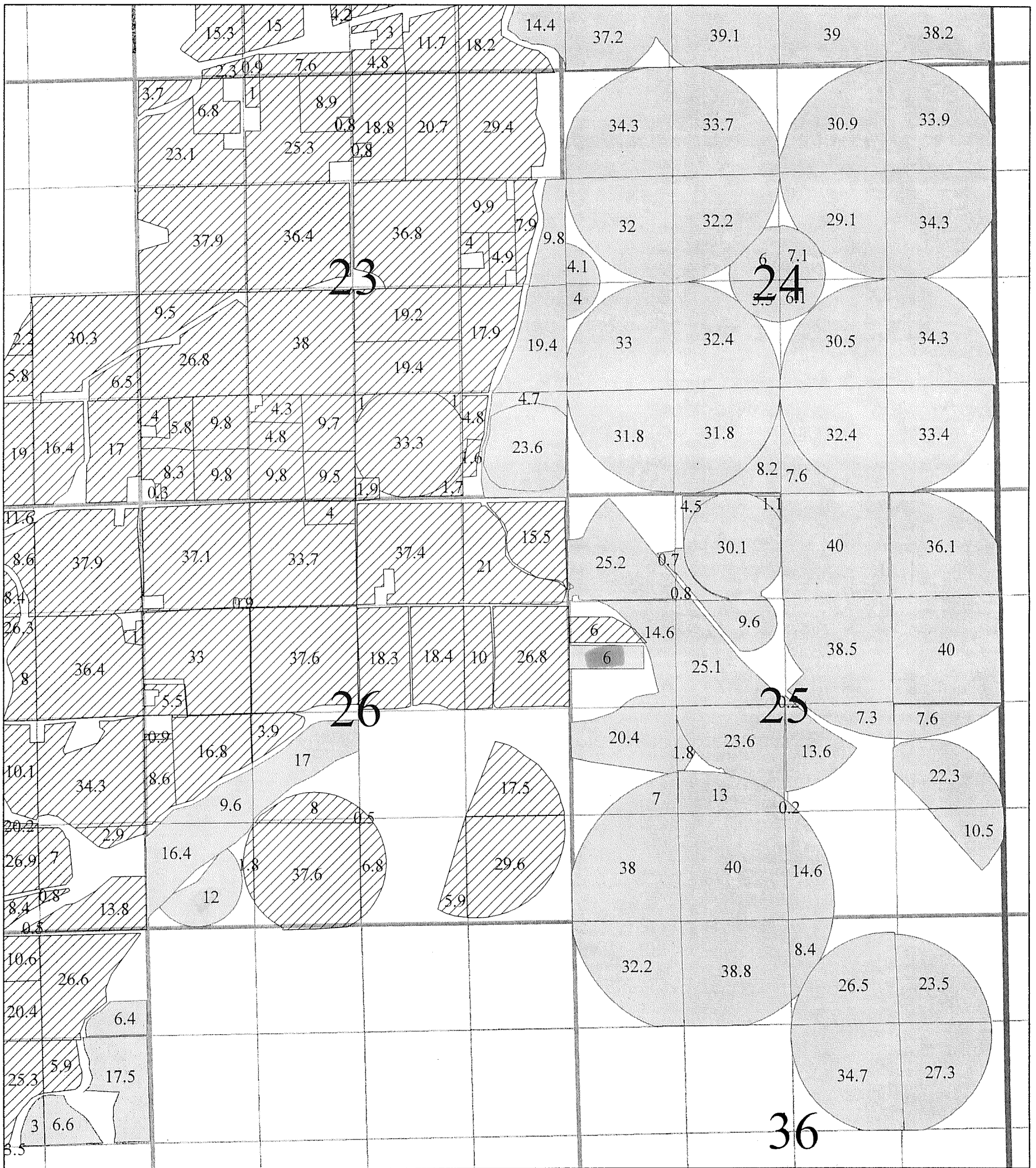

Legend

stan429final

Priority



1905



1965

Cuts
Winnerville
Ackay
86202, 86204
86203, 86205

1 inch = 1320 feet



T 8898
T 10252
T 10432
T 8429