

0 200 400 800 1,200 1,600 Feet  
1" = 400'

**T 17 S, R 13 E, WM**  
**NE 1/4 SECTION 16**  
**DESCHUTES COUNTY, OREGON**

All Group Domestic (0.06 cfs) OFF as follows:  
NWNE & NENE (0.029 cfs) to Oregrown, Inc.  
SWNE (0.013 cfs) to Elite Soil, LLC  
SENE (0.018 cfs) to JAAW, LLC

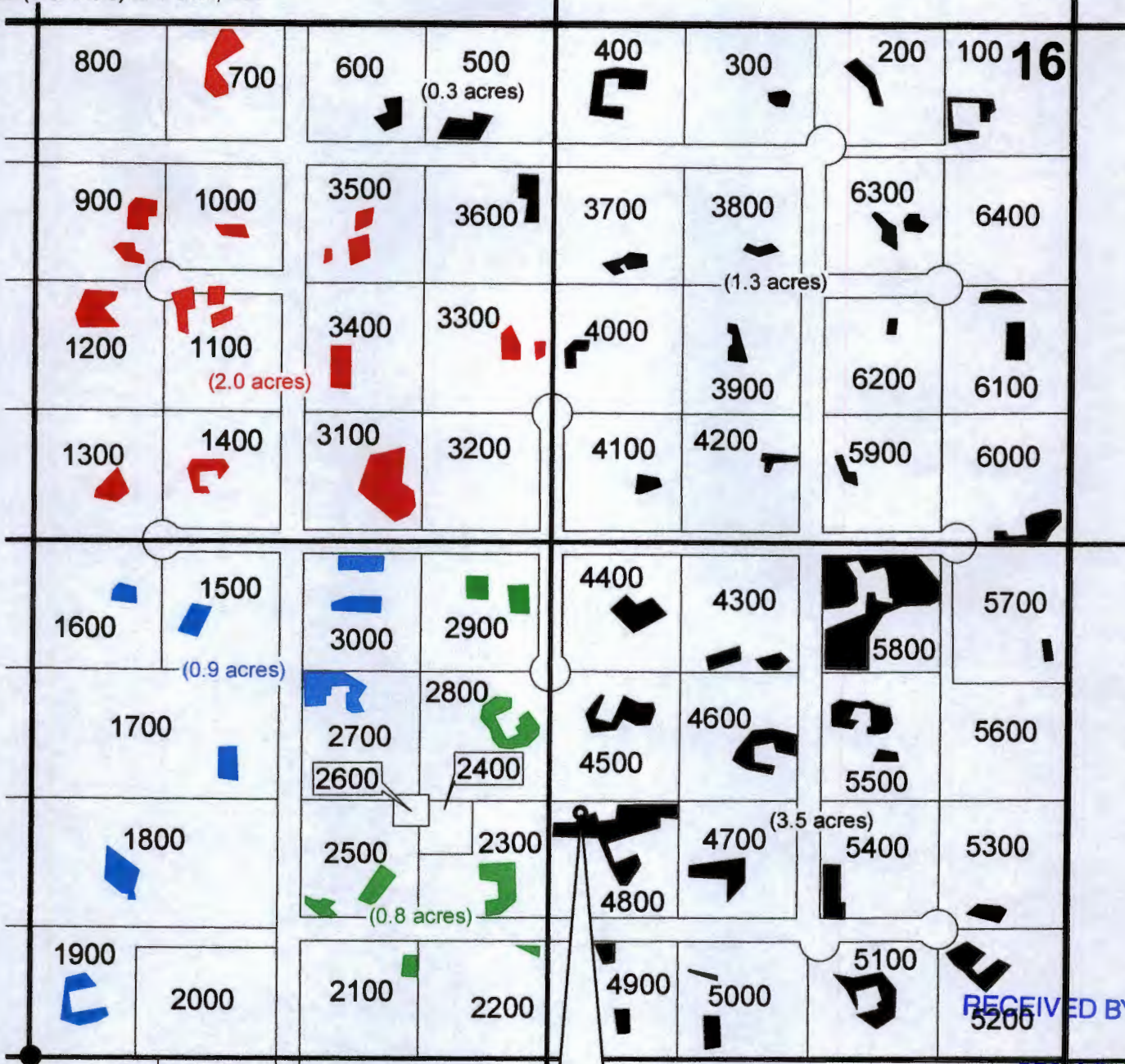

SECTION CENTER

WELL - 640' N  
1400' E FROM  
SECTION CENTER

- POU IR Remaining
- POU IR OFF to JAAW, LLC
- POU IR OFF to Elite Soil, LLC
- POU IR OFF to Oregrown, Inc.

RECEIVED BY OWRC  
DEC 10 2015  
SALEM, OR

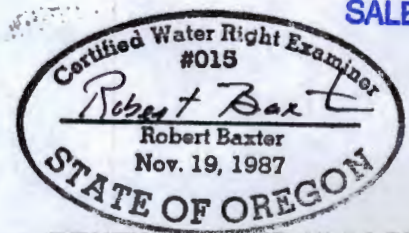

T 12215

RENEWAL DATE 12-31-2015

**Transfer OFF Map for  
Certificate 90952**

December 2, 2015





This map is not intended to provide legal dimensions or locations of property ownership lines.

**WATER RIGHT SERVICES, LLC**  
PO BOX 1830, BEND, OR 97709  
[WWW.OREGONWATER.US](http://WWW.OREGONWATER.US) 541-389-2837  
johnshort@usa.com CCB # 197121

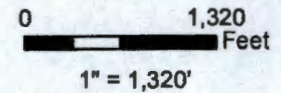
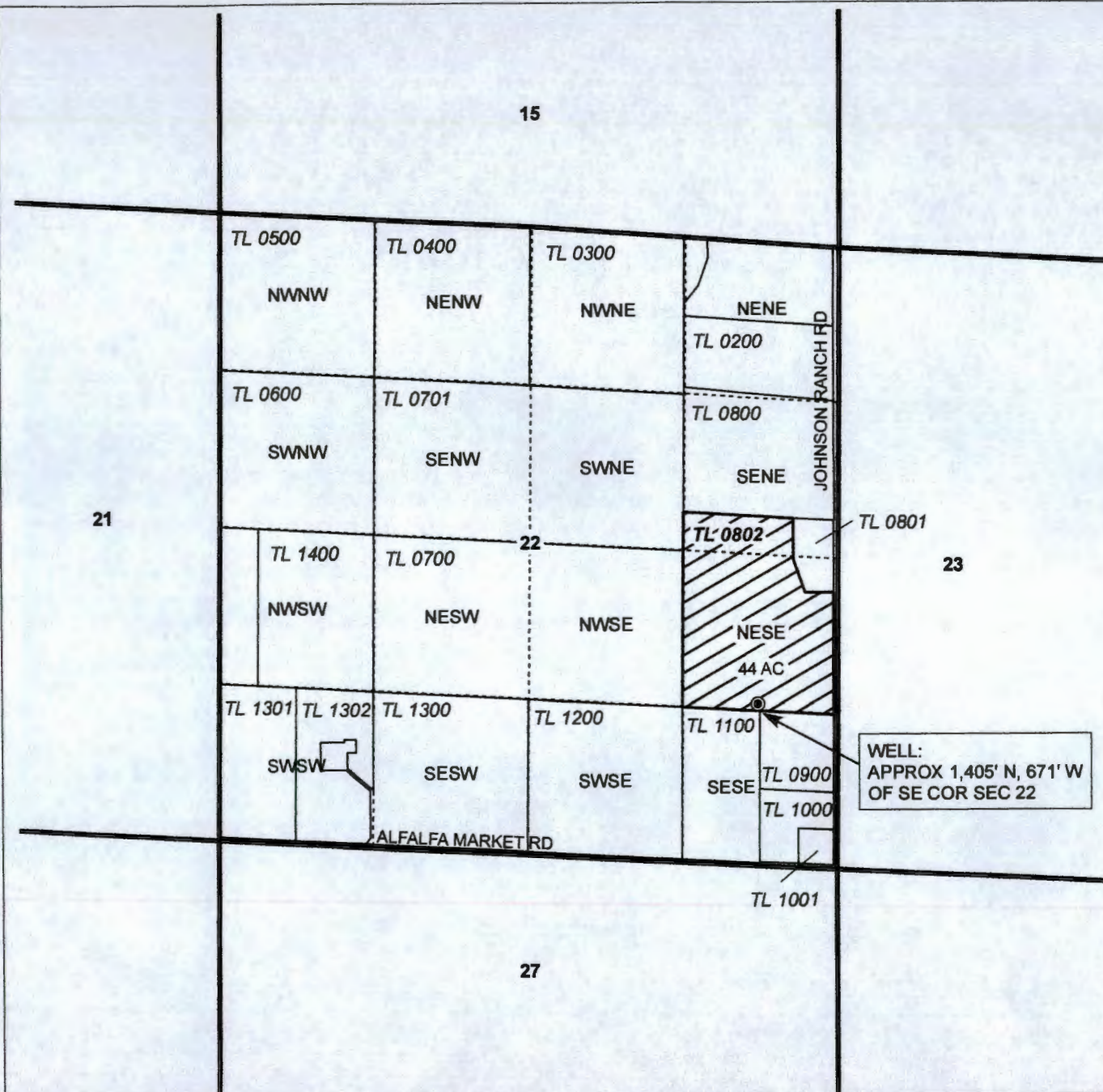
**T17S, R14E  
SECTION 22, WM**

DESCHUTES COUNTY, OREGON



-  POU Nursery
-  Section
-  Quarter Quarter
-  Tax Lot
-  Well

RECEIVED BY OWRD  
 DEC 10 2015  
 SALEM, OR

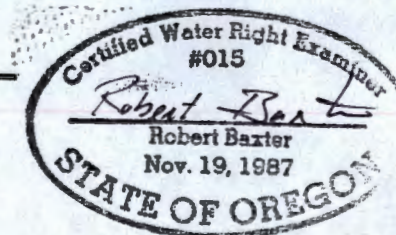

RENEWAL DATE 12/31/2015



**TRANSFER ON MAP  
JAAW, LLC**

T 12215

NOTE: THIS MAP IS NOT INTENDED TO  
PROVIDE LEGAL DIMENSIONS OR LOCATIONS  
OF PROPERTY OWNERSHIP LINES.

NOVEMBER 25, 2015

**WATER RIGHT SERVICES, LLC**  
 PO BOX 1830, BEND, OR 97709  
 CCB# 197121 [www.oregonwater.us](http://www.oregonwater.us)  
 541-389-2837 [JOHNSHORT@USA.COM](mailto:JOHNSHORT@USA.COM)





**T17S, R14E  
SECTION 22, WM**

DESCHUTES COUNTY, OREGON

15



0 1,320 Feet  
1" = 1,320'

-  POU NU
-  Section
-  Quarter Quarter
-  Tax Lot
-  Well

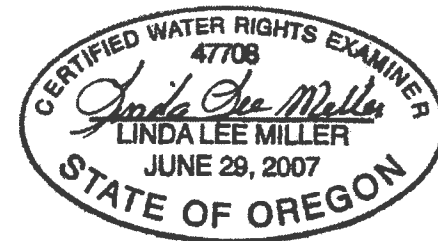

RENEWAL DATE 12/31/2018

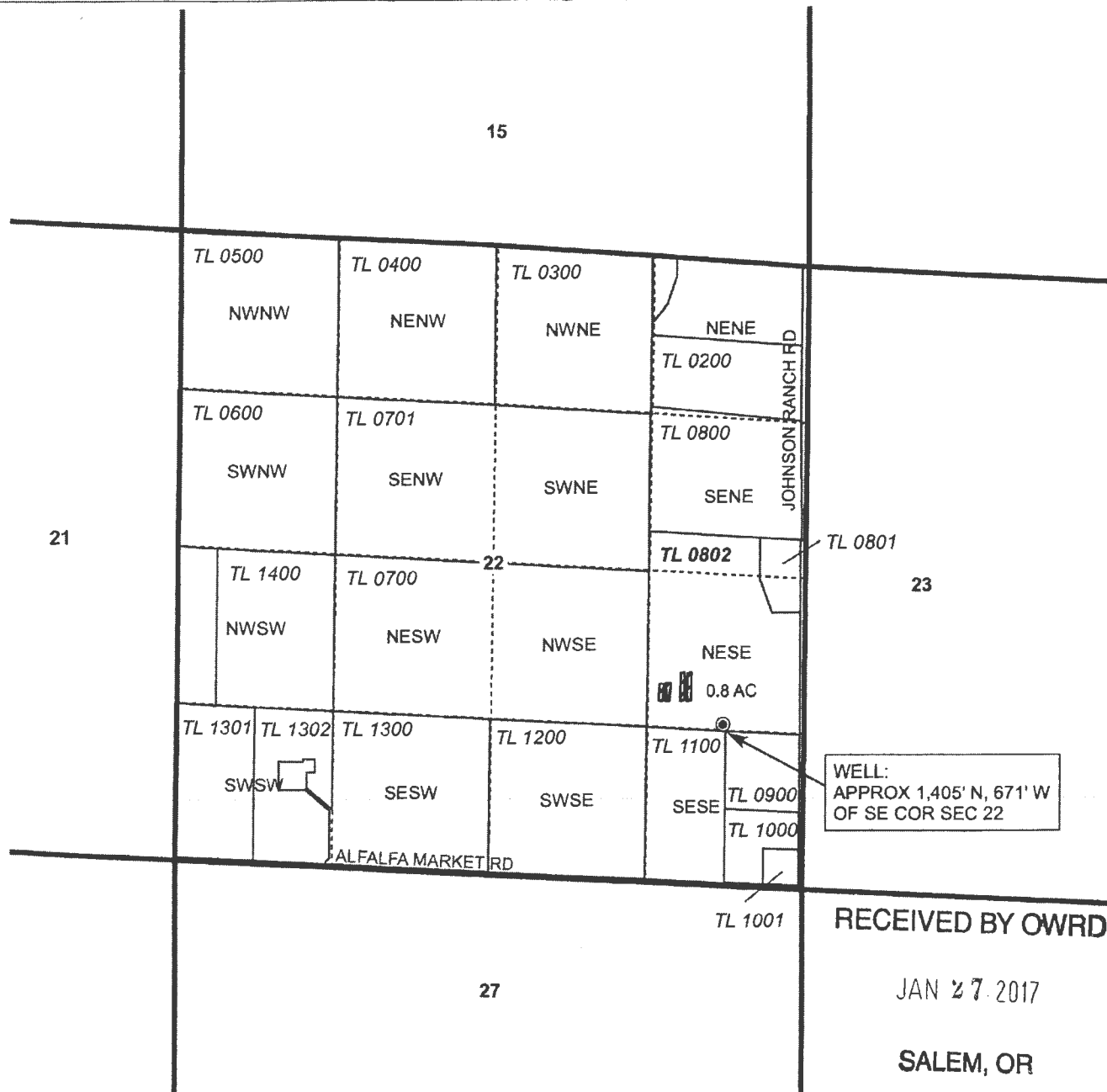

WELL:  
APPROX 1,405' N, 671' W  
OF SE COR SEC 22

RECEIVED BY OWRD

JAN 27 2017

SALEM, OR

**TRANSFER ON MAP  
JAAW, LLC**

T-12215

Amended 1/27/17

NOTE: THIS MAP IS NOT INTENDED TO  
PROVIDE LEGAL DIMENSIONS OR LOCATIONS  
OF PROPERTY OWNERSHIP LINES.

JANUARY 27, 2017

**WATER RIGHT SERVICES, LLC**

PO BOX 1830, BEND, OR 97709

CCB# 197121 www.oregonwater.us

541-389-2837 JOHNSHORT@USA.COM