

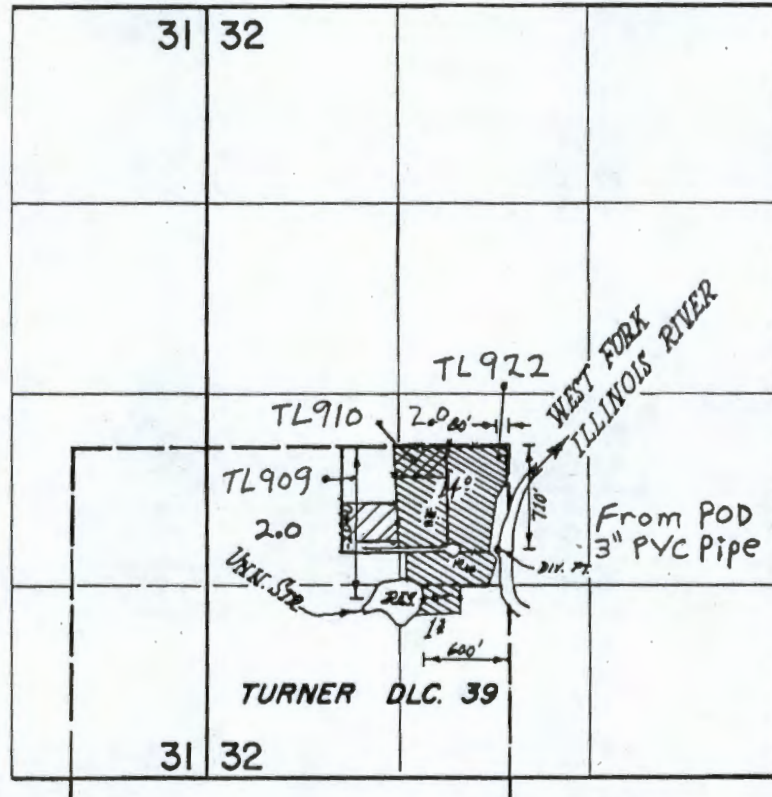



Temporary Transfer Map from C# 46404

T.39S.,R.8W.,WM.
Josephine County
February 6, 2016

N
↑
1" = 1320'



-  2.0 AC Existing POU
-  2.0 AC Proposed POU
-  13.2 AC Remaining Rights POU

Drawn by
Gordon R. Lyford
CWRE# 341

Priority = May 8, 1968
Rate = 0.02 cfs/AC

FINAL PROOF SURVEY
UNDER

R-44883 R-5301
Application No. 44884 Permit No. 33558
IN NAME OF

WM. H. HARTWIG & GEORGE T. DEDES

Surveyed JUNE 8, 1977, by L.M. TOLL

RECEIVED BY OWRD

MAR 03 2016

SALEM, OR

T 12294