

T.7S., R.2W., W.M.

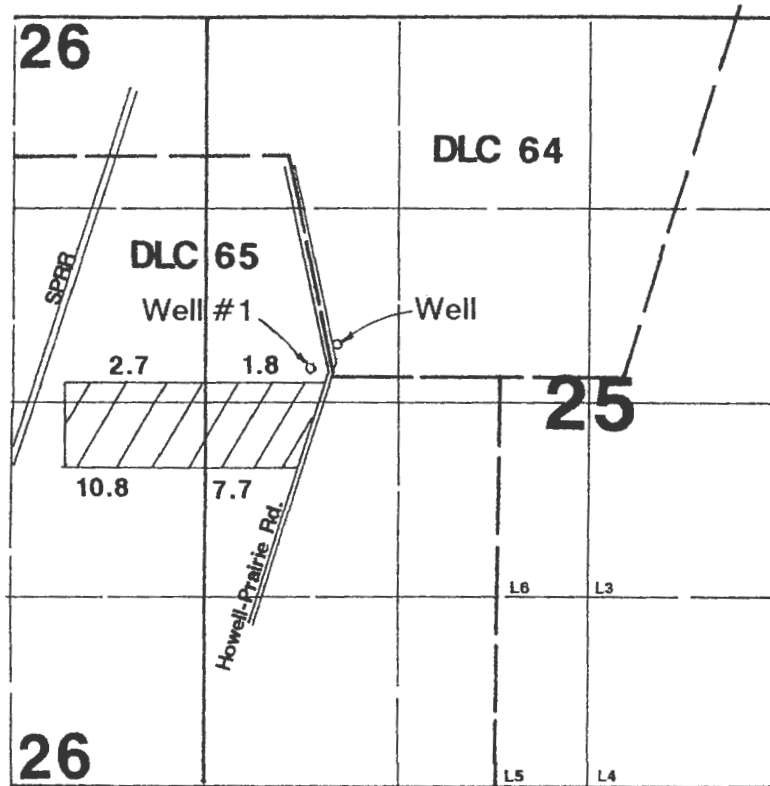

Well is located 400' N & 1740' W from the center of Section 25.
 Well #1 (new POA) is located 50' N & 100' W from the easterly interior corner of DLC 65.

RECEIVED
 MAR 16 2016
 WATER RESOURCES DEPT
 SALEM, OREGON

Application Map

Kyle Schurter

Application #: T-

This Map was Prepared for the Purpose of Identifying the Location of a Water Right Only and is Not Intended to Provide Legal Dimensions or Location of Property Ownership Lines.

CERTIFIED WATER RIGHT EXAMINER
 #117

 JAMES M. SCHUETTE
 STATE OF OREGON

T 12314

EXPIRES: 6/30/2016