

# Application for a Temporary Water Rights Transfer In the Name of John Eveland and Sally Brewer, Gathering Together Farr Certificate 26244 (Burnworth)



RECEIVED

APR 18 2016

WATER RESOURCES DEPT  
SALEM, OREGON

## Legend

- POD
- Burnworth Water Delivery System Buried Pipeline
- Cert 26244 (Burnworth) - To Lands
- Cert 26244 (Burnworth) - From Lands
- Cert 26244 (Burnworth) - Unchanged Lands
- Marys River
- Section Lines
- Donation Land Claims
- Quarter-Quarter section lines
- Benton County Taxlots

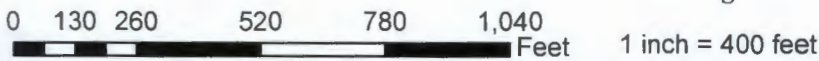

The point of diversion (ID 91816) is located  
1438.5 ft South and 3181.2 ft West  
of the NE corner of Elridge Hartless  
Donation Land Claim #51, Being located  
in the SE 1/4, NW 1/4 of Sec. 13  
T12S, R6W, WM.

T 12340

Application for a Temporary Water Rights Transfer  
 In the Name of John Eveland, Gathering Together Farm - Certificate 24183 (Bevens)

**RECEIVED**

APR 18 2016

WATER RESOURCES DEPT  
 SALEM, OREGON

126110000601

**Legend**

- POD
- Bevens Water Delivery System - Buried Pipeline
- ▨ Cert 24183 (Bevens) - To Lands
- ▧ Cert 24183 (Bevens) - From Lands
- ▩ Cert 24183 (Bevens) - Unchanged Lands
- ⋯ Marys River
- - - Donation Land Claims
- - - Quarter-Quarter section lines
- ▭ Benton County Taxlots

0 100 200 400 600 800 Feet

1 inch = 400 feet



The point of diversion is located  
 in the SE 1/4 SE 1/4 as projected  
 within D. Henderson DLC #46 Section  
 11 T 12S R 6W WM

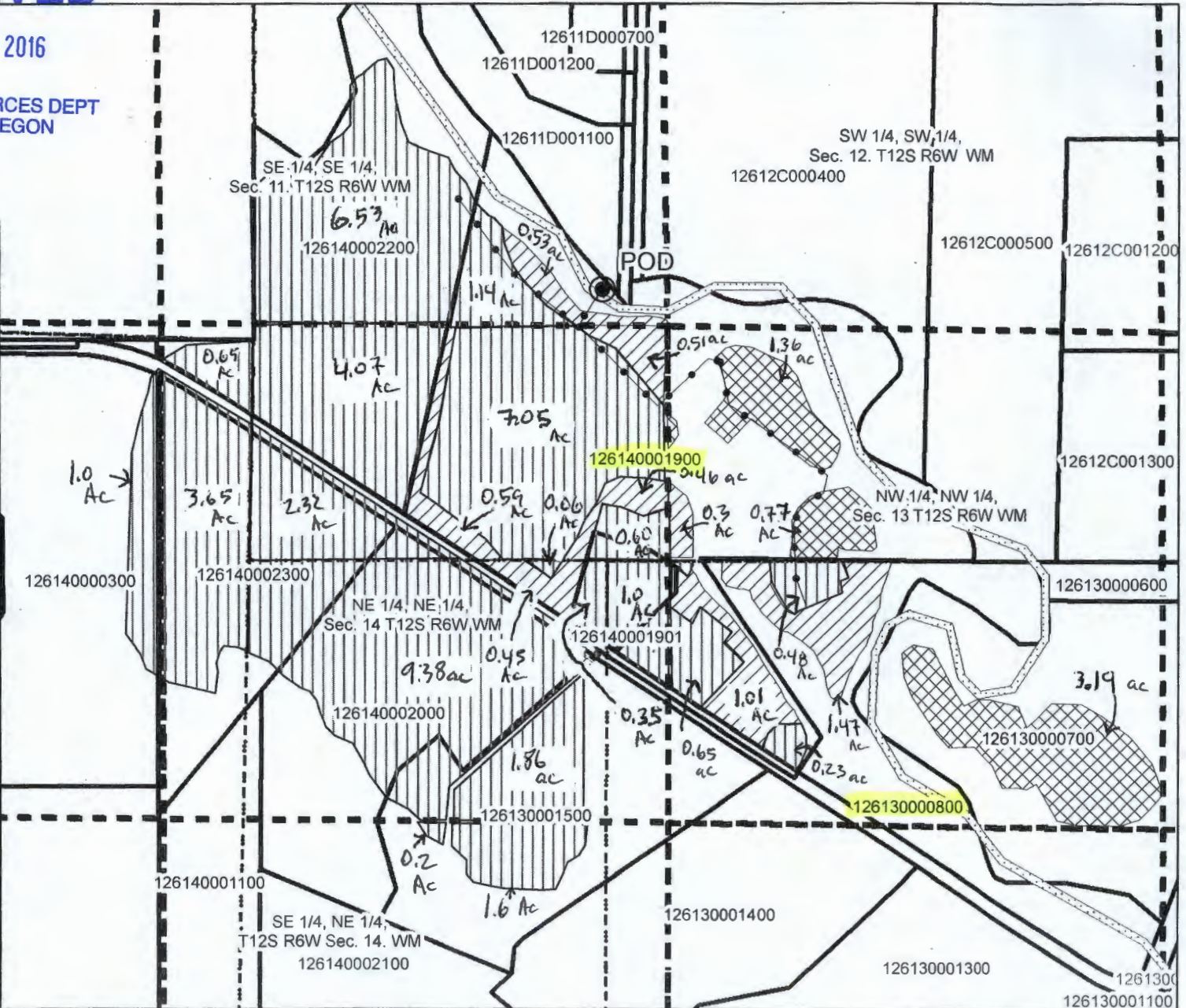

T 12340

T.12S.R.6W.W.M.

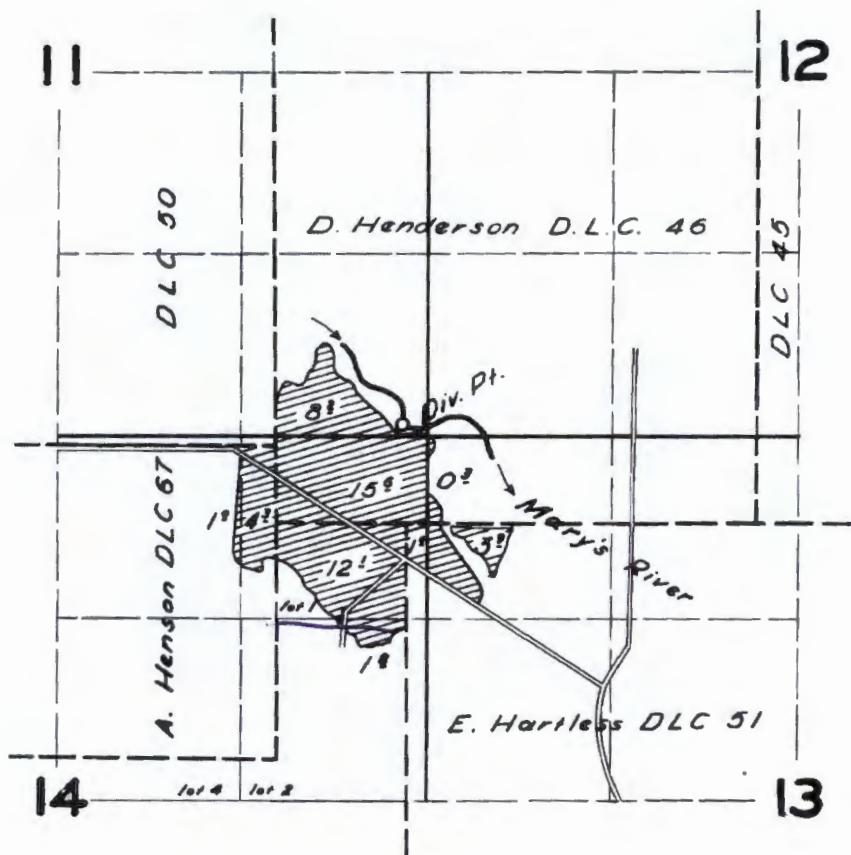

**FINAL PROOF SURVEY**  
UNDER

Application No. 20627 Permit No. 16137  
IN NAME OF

*Dorval & Arma Bevans*

Surveyed 20 Aug. 1957, by *[Signature]*

**RECEIVED**  
APR 18 2016  
WATER RESOURCES DEPT  
SALEM, OREGON

T.12S. R.6 W.W.M.

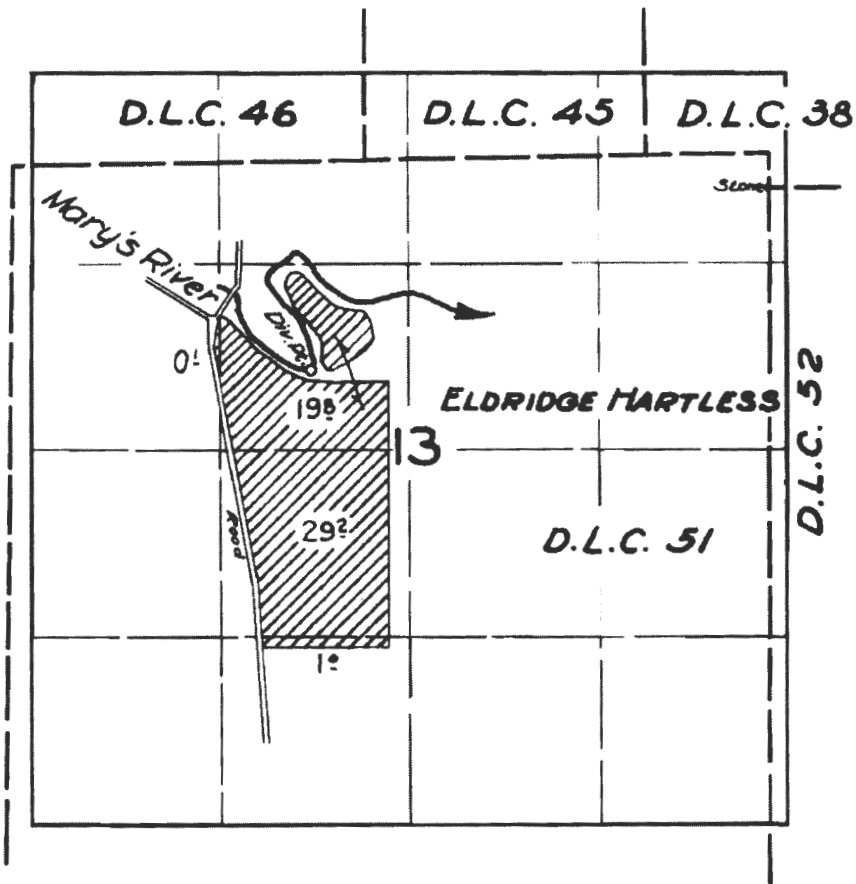

**FINAL PROOF SURVEY**  
UNDER

**RECEIVED**

APR 18 2016

Application No. 29850. Permit No. 23680  
IN NAME OF

WATER RESOURCES DEPT  
SALEM, OREGON

**ELMER J. BURNWORTH**

Surveyed 26 Sept. 1958. by M. Bish

Ry

DFJ-3P-121

T 12340