

POD Location Map for
POU Temporary Transfer



EXPIRES: 2/17/2031

COBU MAP # 155

Point of Diversion

NW 1/4 SW 1/4, SECTION 4, T6S, R3W, W.M.;
690 FEET SOUTH AND 110 FEET WEST FROM
THE NE CORNER OF DLC 58.

6
S

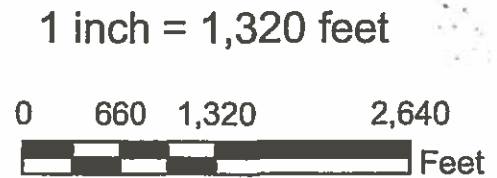

This map was prepared for the purpose of identifying the location of a water right only and is not intended to provide legal dimensions or location of property ownership lines.

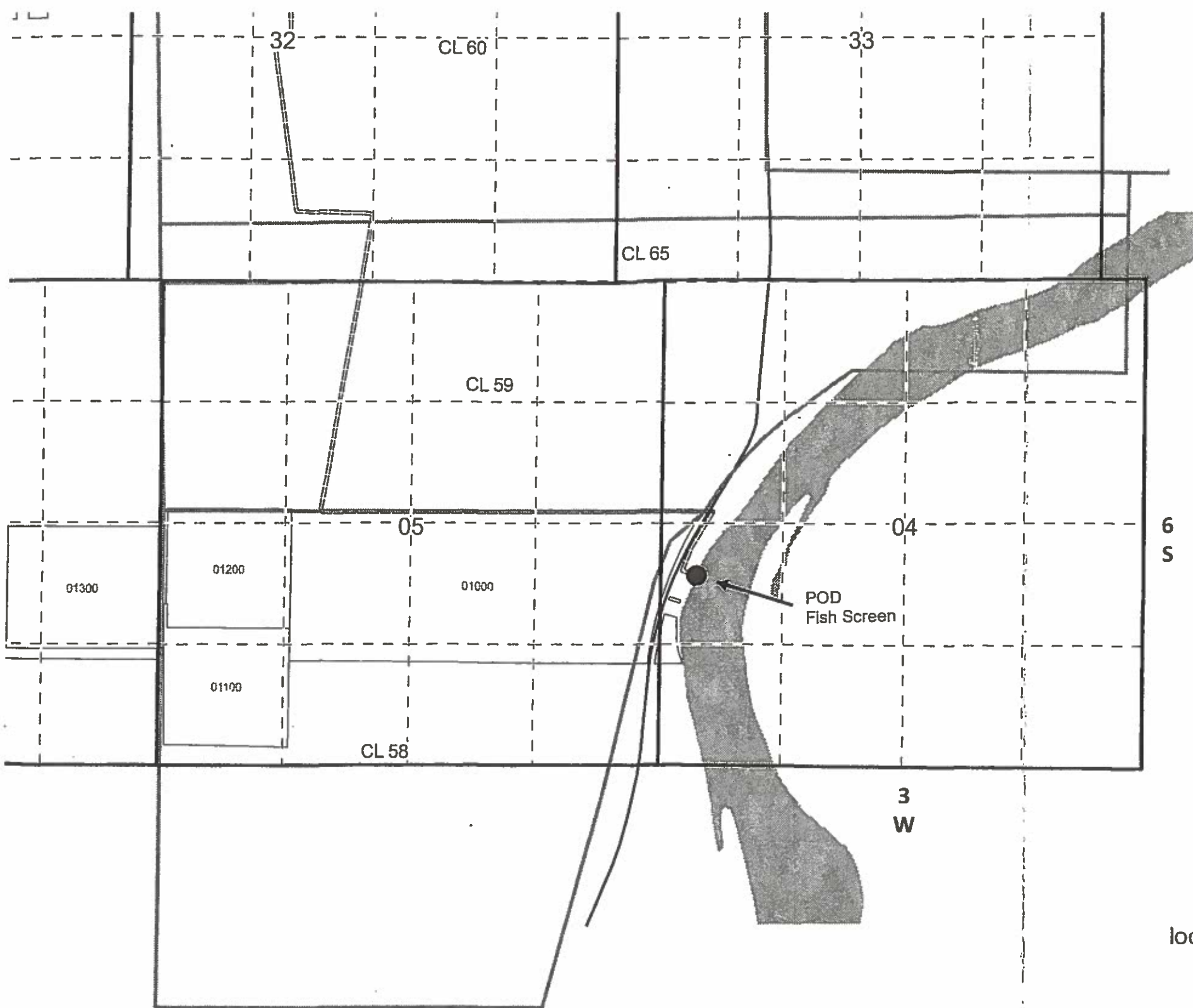

Water Rights Certification Map

Palmer Creek Water District Improvement Company
Claim of Beneficial Use Map

T.4S., R.3W., W.M

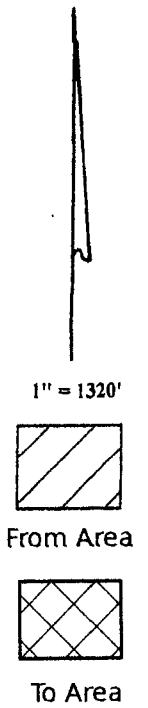
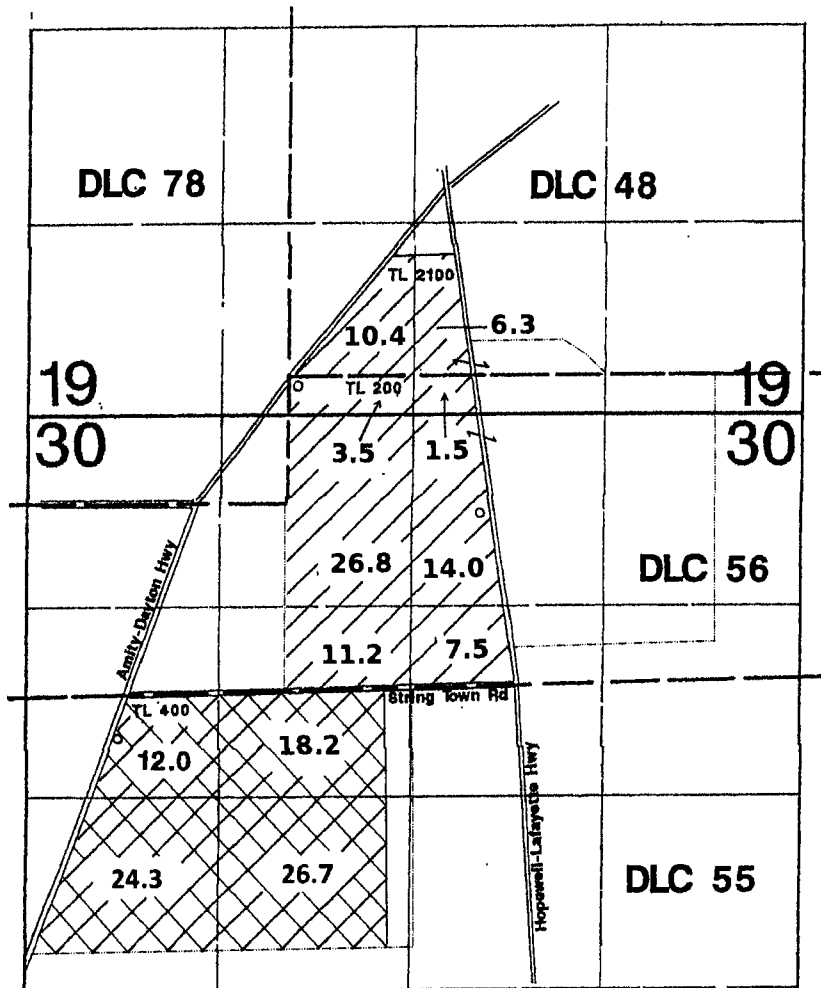

Transfer Map

POU Location Map for
Temporary POU Transfer
in the name of Lynell Braat

This Map Was Prepared For The Purpose Of Identifying The Location Of A Water Right Only And Is Not Intended To Provide Legal Dimensions Or Location Of Property Ownership Lines.

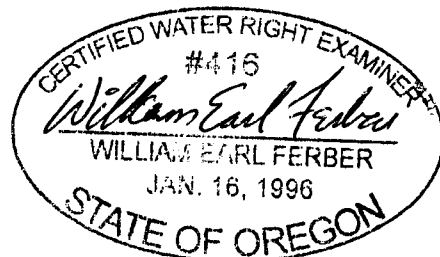

T. 12395

EXPIRES: 2/17/23