

# Application for a Water Right Instream Transfer in the Name of Wanek Ranch, LLC

Point of Diversion - Certificate 90239  
Klamath County, Oregon  
Township 23 South, Range 9 East (W.M.)

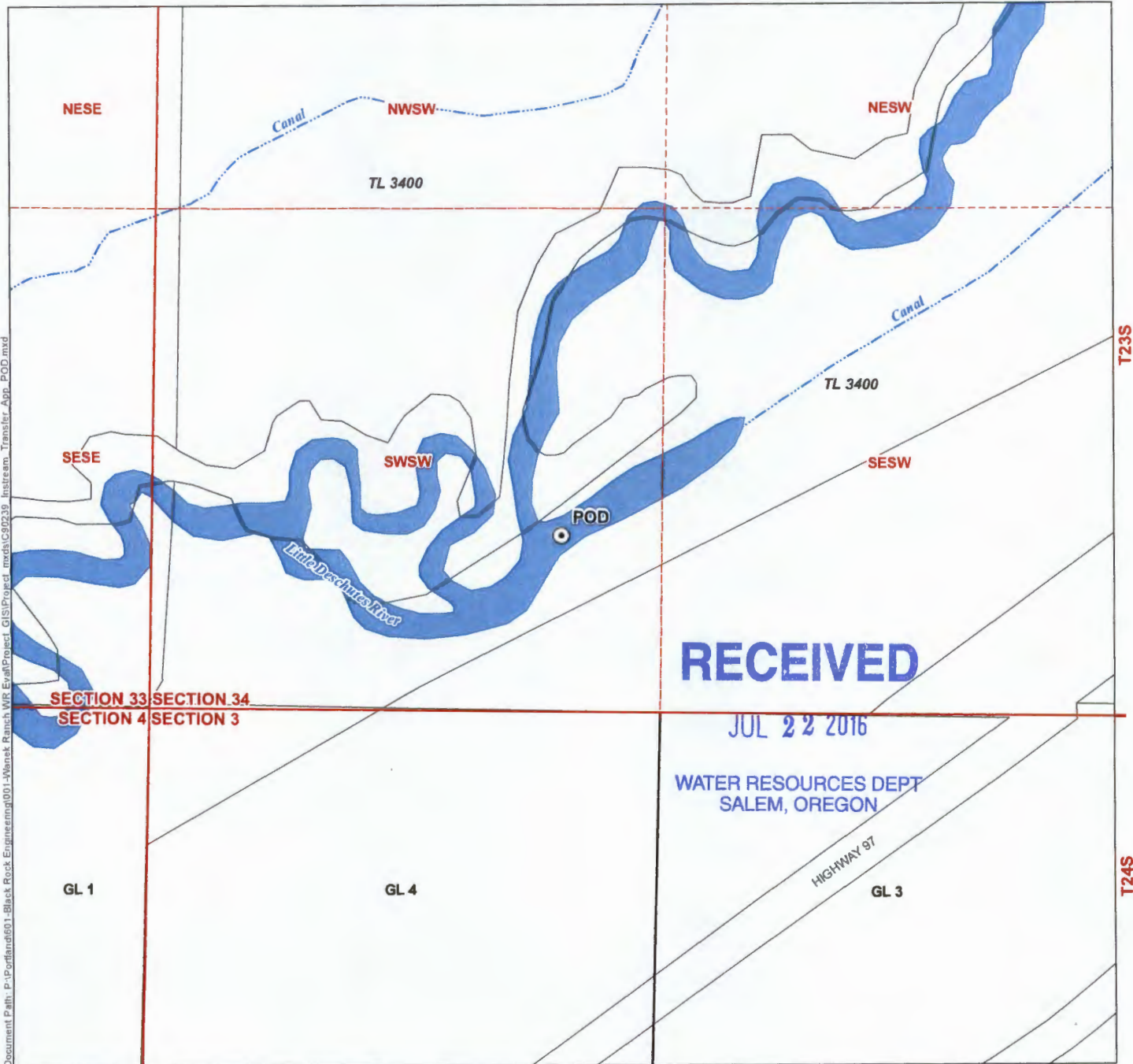

Document Path: P:\Portland\601-Blast Rock Engineering\001-Wanek Ranch W.R. Eval\Project GIS\Project\_mxd\90239\_Instream\_Transfer\_App\_POD.mxd

### LEGEND

- Point of Diversion (POD)
- Tax Lot (TL)
- Government Lot (GL)
- Waterbodies
- Watercourses

**POD LOCATION DESCRIPTION**  
POD  
Located 550 feet North and 1,150 feet East from the SW corner of Section 34, Township 23 South, Range 9 East (W.M.)

**Certified Water Rights Examiner Stamp**

Certified Water Rights Examiner  
#78208WRE  
*Bruce Brody-Heine*  
Bruce Brody-Heine  
June 29, 2007  
STATE OF OREGON

**EXPIRES: 12-31-17**

**DISCLAIMER**  
This map was prepared for the purpose of identifying the location of a water right only and it is not intended to provide legal dimensions or location of property ownership lines.

**MAP NOTES**  
Date: June 10, 2016  
Data Sources: Klamath Co GIS, US BLM, USGS

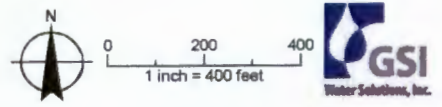

T 12439

# Application for a Water Right Instream Transfer in the Name of Wanek Ranch, LLC

FROM Lands - Certificate 90239  
Deschutes County, Oregon  
Township 22 South, Range 10 East (W.M.)

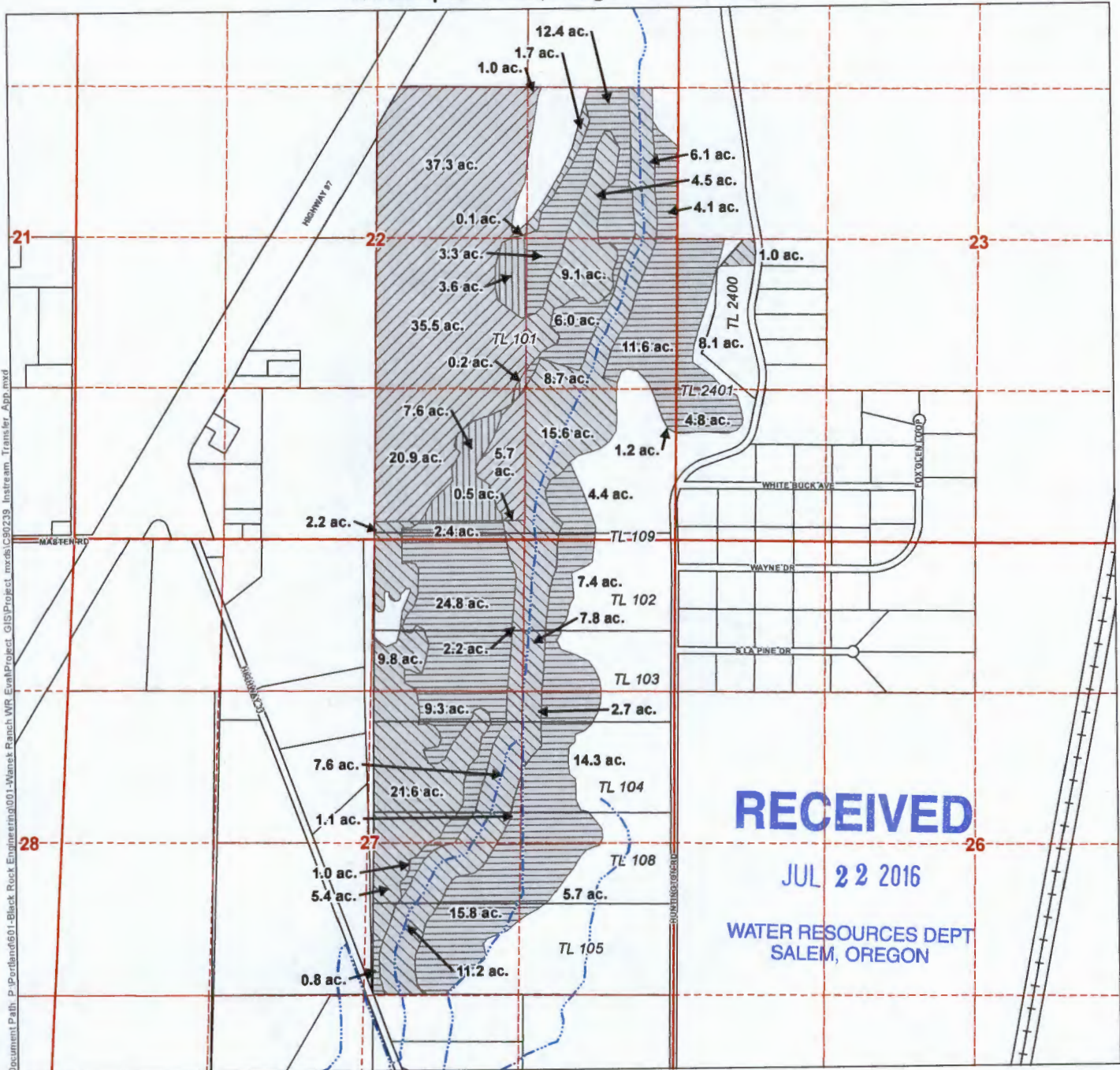

Document Path: P:\Portland\601-Black Rock Engineering\001-Wanek Ranch WIR Eval\Project GIS\Project.mxd; 030239 Instream Transfer App.mxd

### LEGEND

#### Place of Use (POU)

- Lands to Remain - 1902 Priority
- Lands to Remain - 1897 Priority
- From Lands - 1902 Priority
- From Lands - 1897 Priority

#### All Other Features

- Tax Lots
- Railroad
- Watercourses

### Certified Water Rights Examiner Stamp

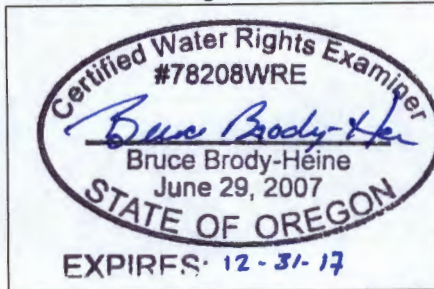

### DISCLAIMER

This map was prepared for the purpose of identifying the location of a water right only and it is not intended to provide legal dimensions or location of property ownership lines.

### MAP NOTES

Date: June 2, 2016  
Data Sources: Deschutes Co GIS, DRC, OGIC

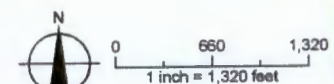

f 12439

# DESCHUTES COUNTY T22S R10E Sections 22, 23, 27

SCALE: 1" = 1,320'

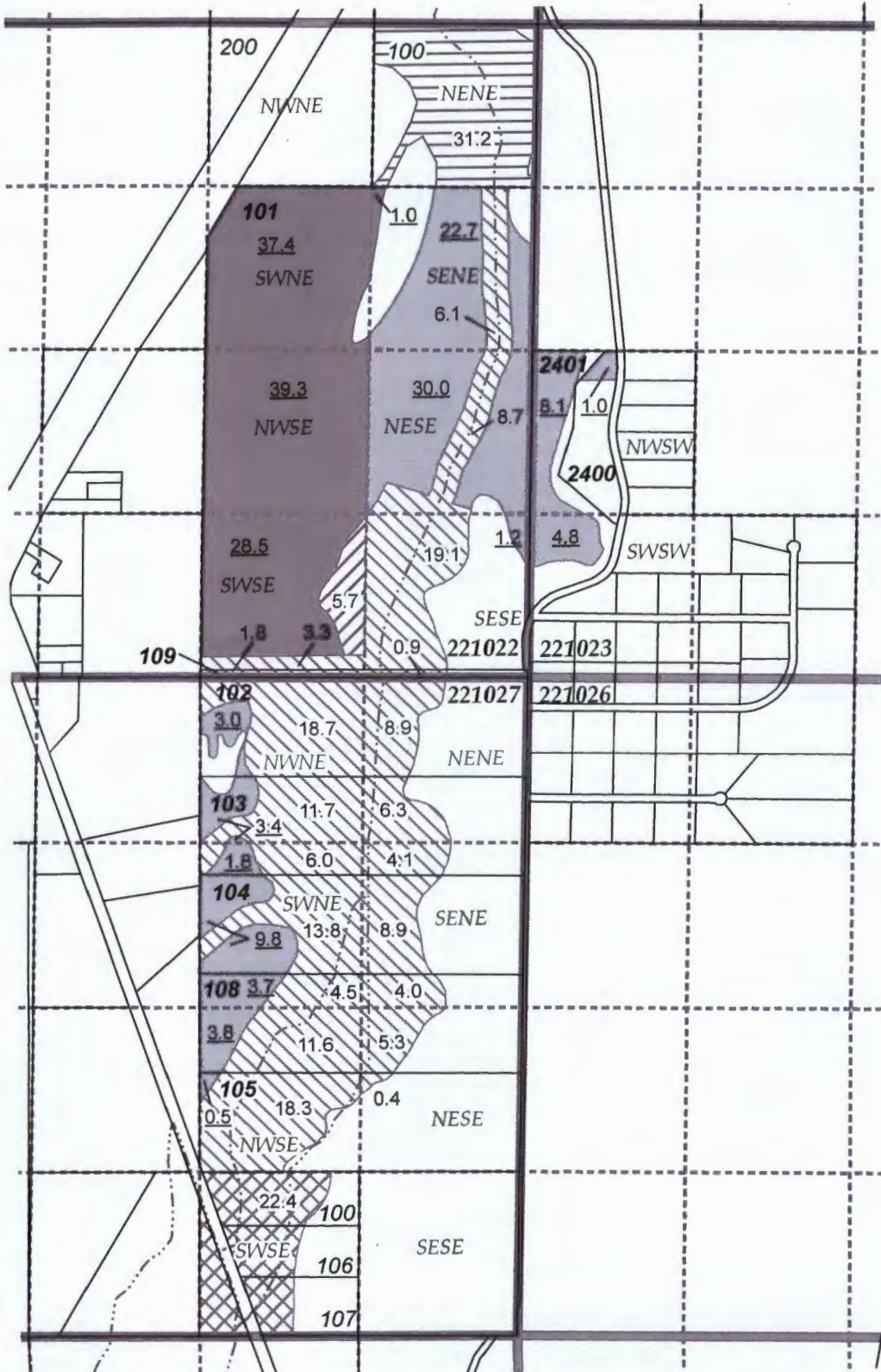

**RECEIVED**

JUL 22 2016

WATER RESOURCES DEPT  
SALEM, OREGON

**Certificate 87048 (priority date)**

- Leased Acres (1897), 93.8 ac
- Leased Acres (1902), 106.2 ac
- Acres to Remain On (1897), 162.4 ac
- Acres to Remain On (1902), 5.7 ac
- Subject to Transfer T-11163
- Subject to Transfer T-11365
- Taxlot
- PLSS Section
- PLSS 1/4 1/4 Section
- Canal

Source:  
2005/06 Deschutes County GIS data  
OWRD Water Rights Information System

**INSTREAM LEASE MAP FOR WANEK RANCHES, LLC**

Deschutes River Conservancy

Taxlot #: 101,102,103,104,105,108,109,2400,2401

Date: 03/25/15

T 12439

**200 acres Instream  
168.1 acres remain**

