



RECEIVED

DEC 12 2001

WATER RESOURCES DEPT.  
SALEM, OREGON

LEGEND

- ⊙ Wells
- ~ Streams
- Place of Use
- City Limits

SCALE ADJUSTED  
TO BE APPROX.

1" = 1320'

12/17/01

SALEM, OR

SEP 06 2016

RECEIVED BY OWRD

Figure 1  
Well location map  
Saint Paul, OR

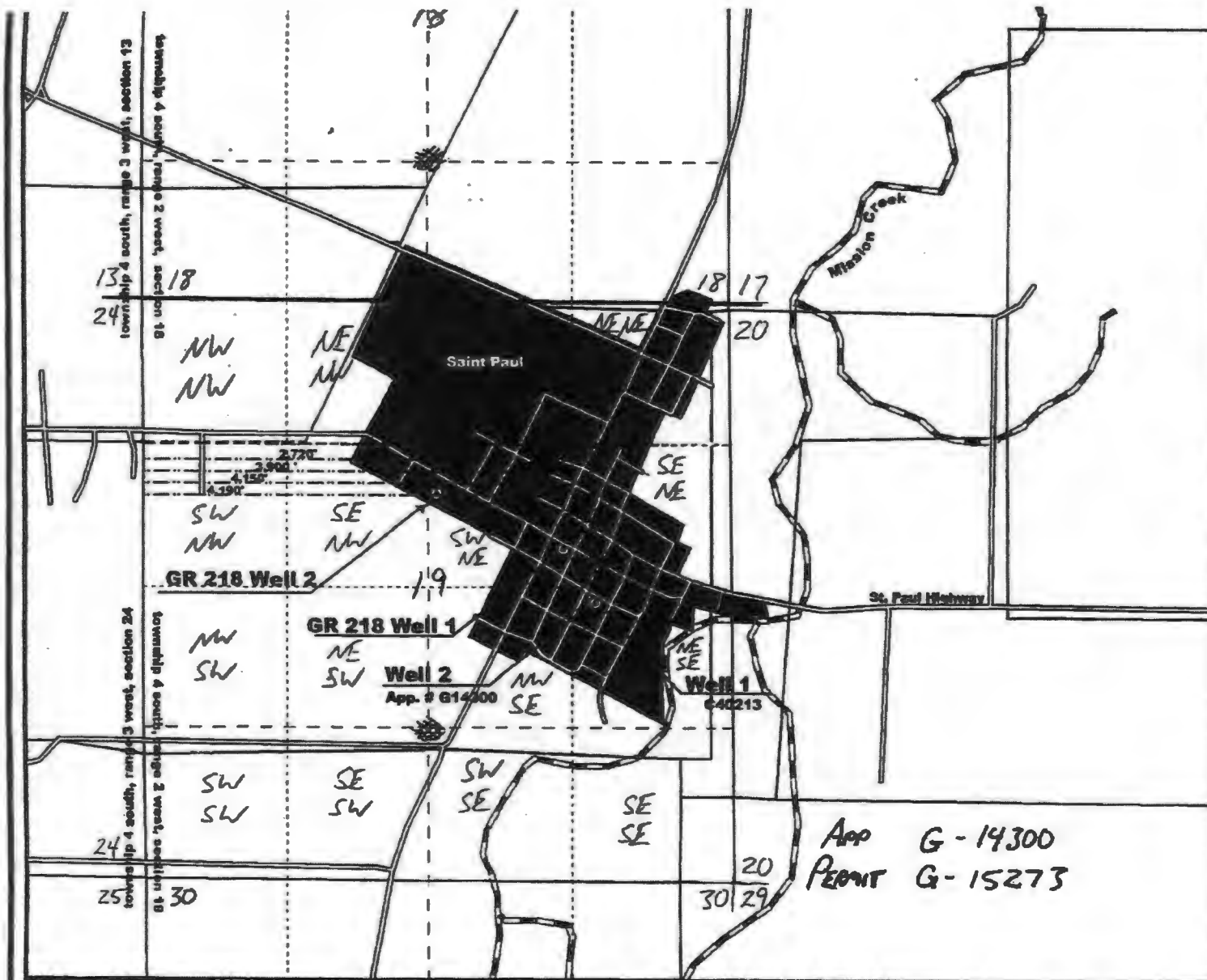

SCALE

1" = 1320'



Well 2 (App. # G14300) Location:  
4,150 feet East and 1,400 feet South  
from the NW corner of Section 19,  
Township 4 South, Range 2 West

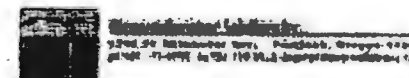

T 12471

# Permit Amendment Application Additional Point of Appropriation

Application G-14300, Permit G-15273  
City of St. Paul, Oregon

Township 4 South, Range 2 West (W.M.)

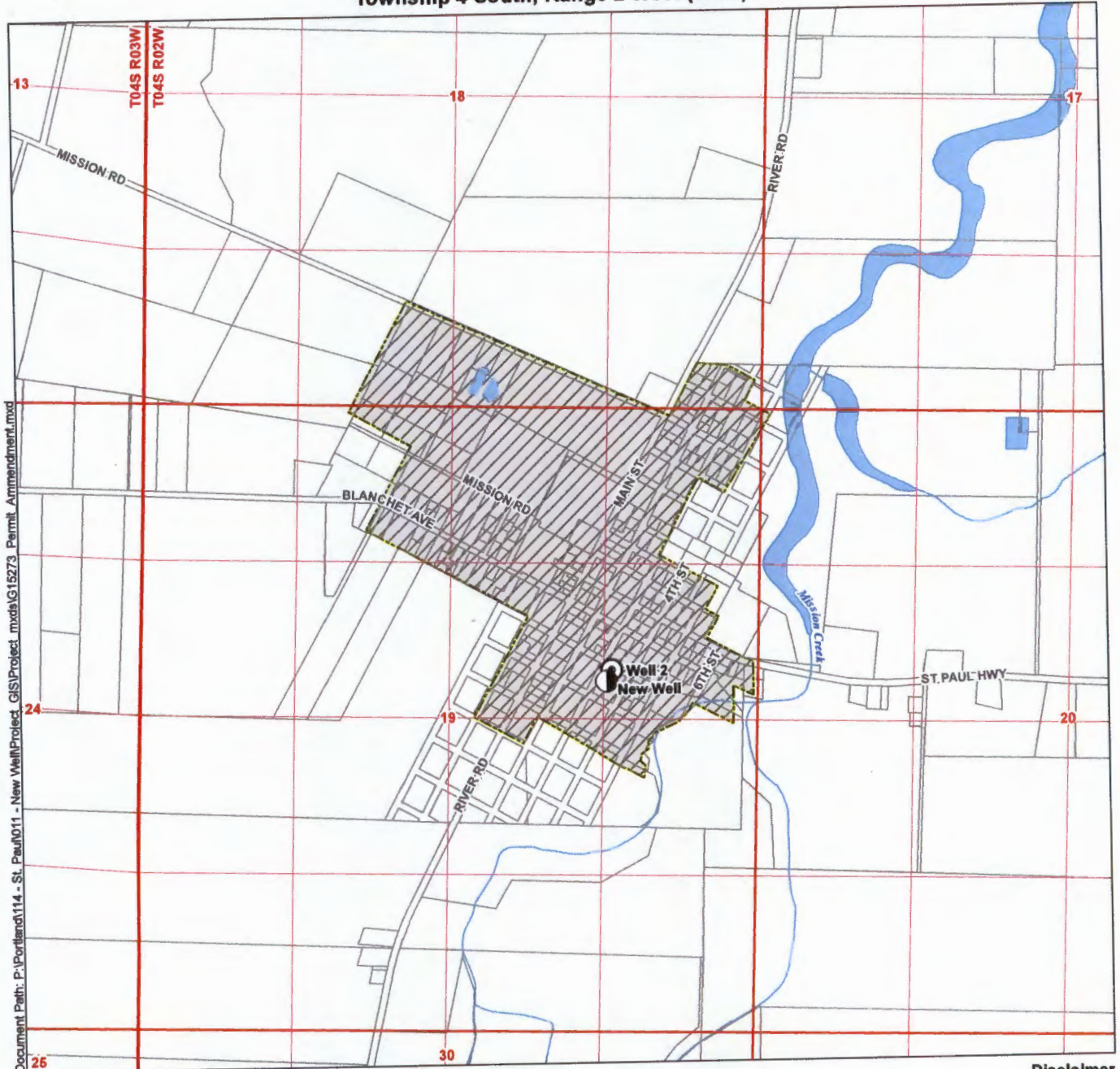

Document Path: P:\Portland\114 - St. Paul\011 - New Well\Project\_GIS\Project\_mxd\G15273 Permitt\_Amendment.mxd

### LEGEND

- Additional Point of Appropriation (APOA)
- Point of Appropriation (POA)
- Place of Use (POU)
- City Boundary
- Tax Lot
- Watercourse
- Waterbody

### POA Location Description

#### New Well

Located 2,415 feet South and 4,085 feet East from the NW corner of Section 19, Township 4 South, Range 2 West (W.M.)

#### Well 2

Located 2,314 Feet South and 4,150 Feet East from the NW Corner Section 19, Township 4 South, Range 2 West (W.M.)

### Disclaimer

This map was prepared for the purpose of identifying the location of a water right only and it is not intended to provide legal dimensions or location of property ownership lines.

### Map Notes

Date: August 23, 2016  
Date Sources: BLM, ESRI, USGS  
Prepared By: GSI Water Solutions, Inc.

RECEIVED BY OWRD

SEP 06 2016

SALEM, OR



T 12471