

DLC NO. 41

See Map 9.5.7

SEC.18 T9S R5W WM
POLK COUNTY

9.5.18

IMPORTANT
This Map for Assessment
and Taxation Purposes

Scale 1" = 400'

2-28

ONLY

200
157.94 AC

N.E. CORNER
JOHN LEWIS
DLC NO. 54

7 8

12 7

13 18

N.W. CORNER
JOHN LEWIS
DLC NO. 40

N.E. CORNER
DLC NO. 41

18 17

N.E. CORNER
DLC NO. 41

N.W. CORNER
JOHN LEWIS
DLC NO. 40

See Map 9.6.13

RECEIVED

DEC 12 2016

WATER RESOURCES DEPT
SALEM OREGON

Canceled No.

303
304

2-18

202
180.21 AC

101
6.58 AC

102
19.10 AC

100
31.81 AC

700
4.21 AC

201
40.29 AC

103
1.30 AC

See Map 9.5.17

1.00 AC

600
600M1
10 AC

401
5.16 AC

400
144.84 AC

300
80.59 AC

2-28

301
75.07 AC

302
4.87 AC

S.E. CORNER
DLC NO. 41

N.E. CORNER
DLC NO. 48

N.E. CORNER
DLC NO. 48

N.E. CORNER
DLC NO. 48

S.W. CORNER
JOHN LEWIS

12/12/14

S.W. CORNER
DLC NO. 40

S.W. CORNER
DAVID R. LEWIS
DLC NO. 55

S.W. CORNER
ROSE W. SIMPSON
DLC NO. 70

See Map 9.5.19

18 7

24 19

18 7

20 70

9.5.18

T 12531

T 12531

SUBJECT RESERVOIR
CERT. 23955 + 23954

SOURCE: GOOGLE EARTH
IMAGERY DATE: 7/23/2016

769 ft

© 2016 Google

Google Earth

T 12531

RECEIVED

DEC 12 2016

WATER RESOURCES DEPT
OUSTON



RECEIVED
FEB 17 1953
STATE ENGINEER
SALEM, OREGON

LEWIS FARM POND #1 STARKER FORESTS

T9S R5W S18

Mapped by

BRUCE & T. J. STARKER

Fall 1952

1" = 660'

RECEIVED
FEB 17 1953

RECEIVED
DEC 12 2016
WATER RESOURCES DEPT
SALEM, OREGON
1 12531

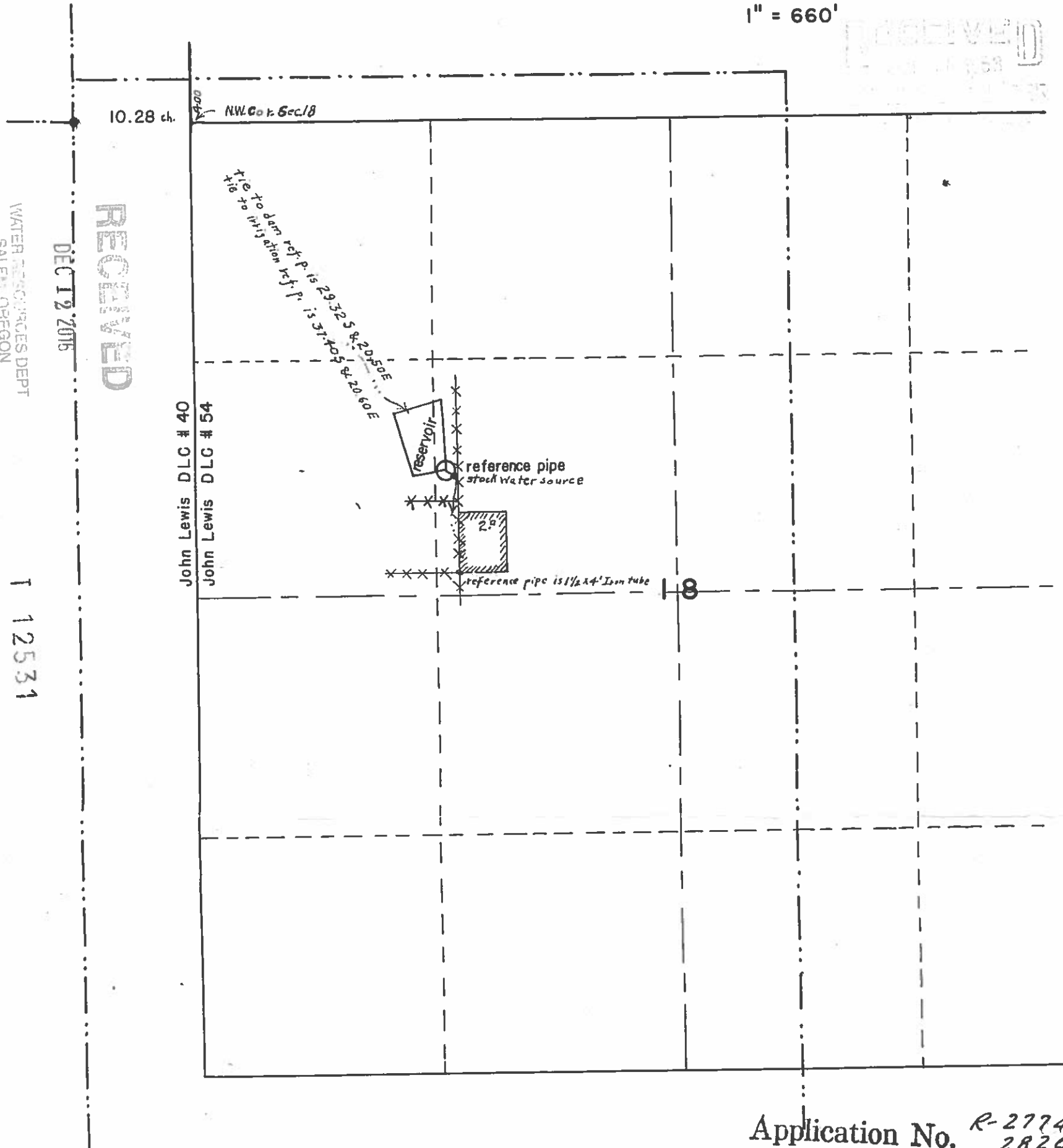

Application No. R-27745
28266
Permit No. R-1515
22447