



**Rural Zoning**

**Legend**

- Zoning:**
- Acresage Residential
  - Commercial
  - Commercial General
  - Commercial Retail
  - Exclusive Farm Use
  - Farm Timber
  - Industrial
  - Interchanges
  - Limited Multiple Family
  - Multiple Family
  - Public
  - Single Family
  - Special Agriculture
  - Timber Conservation
  - Urban Development
  - Urban Transition
  - Urban Growth Boundary
  - City Limits
  - Community Boundary
  - Railroads

**Not an Official Zoning Map**

**For Illustrative Purposes Only**



Date: 7/2/2012

**14**

**RECEIVED**

MAR 29 2017

**OWRD**

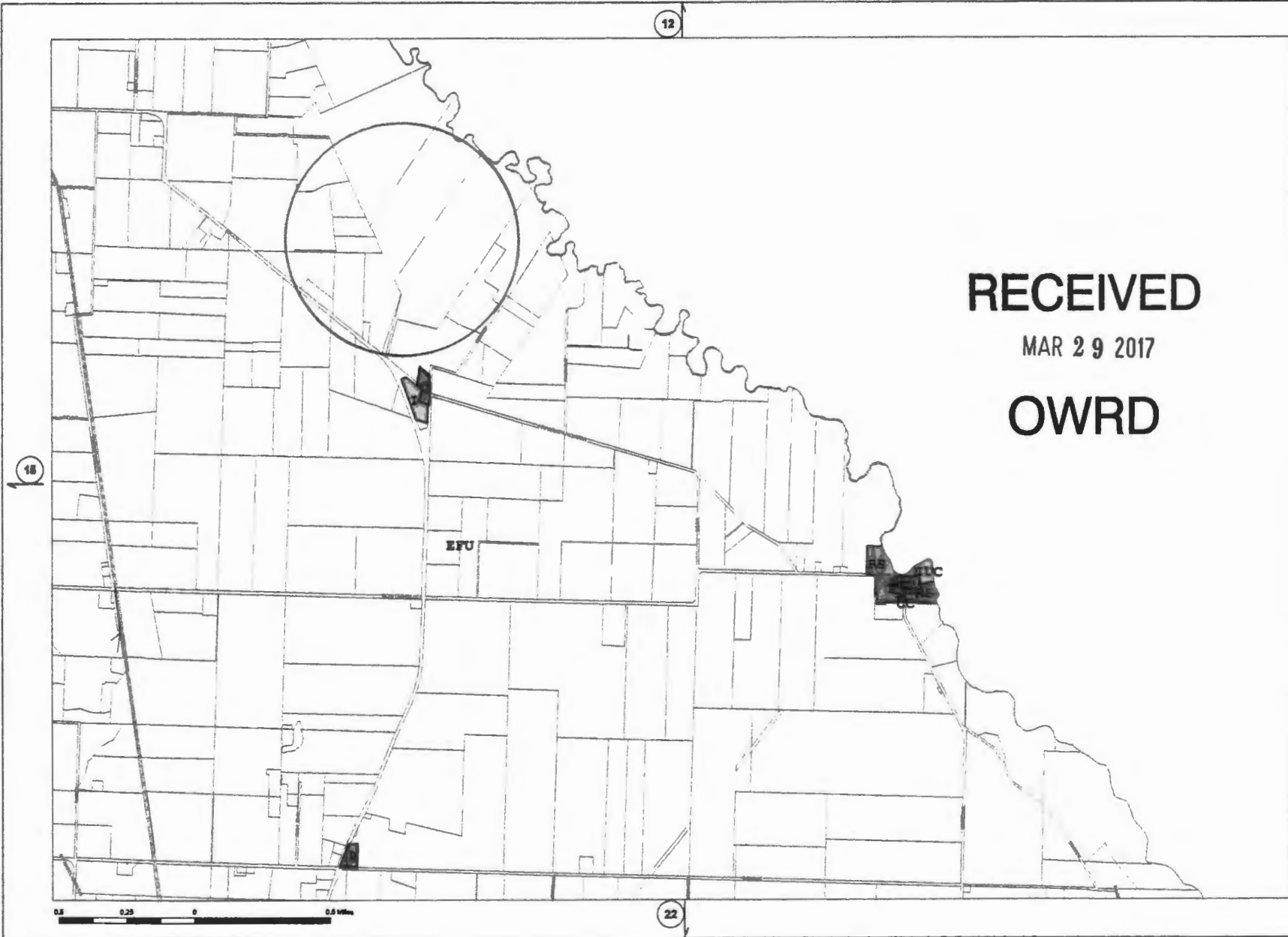

1 19692

Map Disclaimer: Maps made available to the public by Marion County are not legally recorded maps nor surveys and are not intended to be used as such. Nor should they be used for navigational, tracking or any other purposes requiring accurate measurement of distance or direction or precision in the depiction of geographic features. The data provided herein may be inaccurate or out of date and any person or entity who relies on said information for any purpose whatsoever does so solely at his or her own risk, in no way does Marion County warrant the accuracy, reliability or timeliness of any of the data provided on these maps. To report any errors or discrepancies or if additional information is needed please contact: GIS@co.marion.or.us

# T.5S., R.1W., W.M.

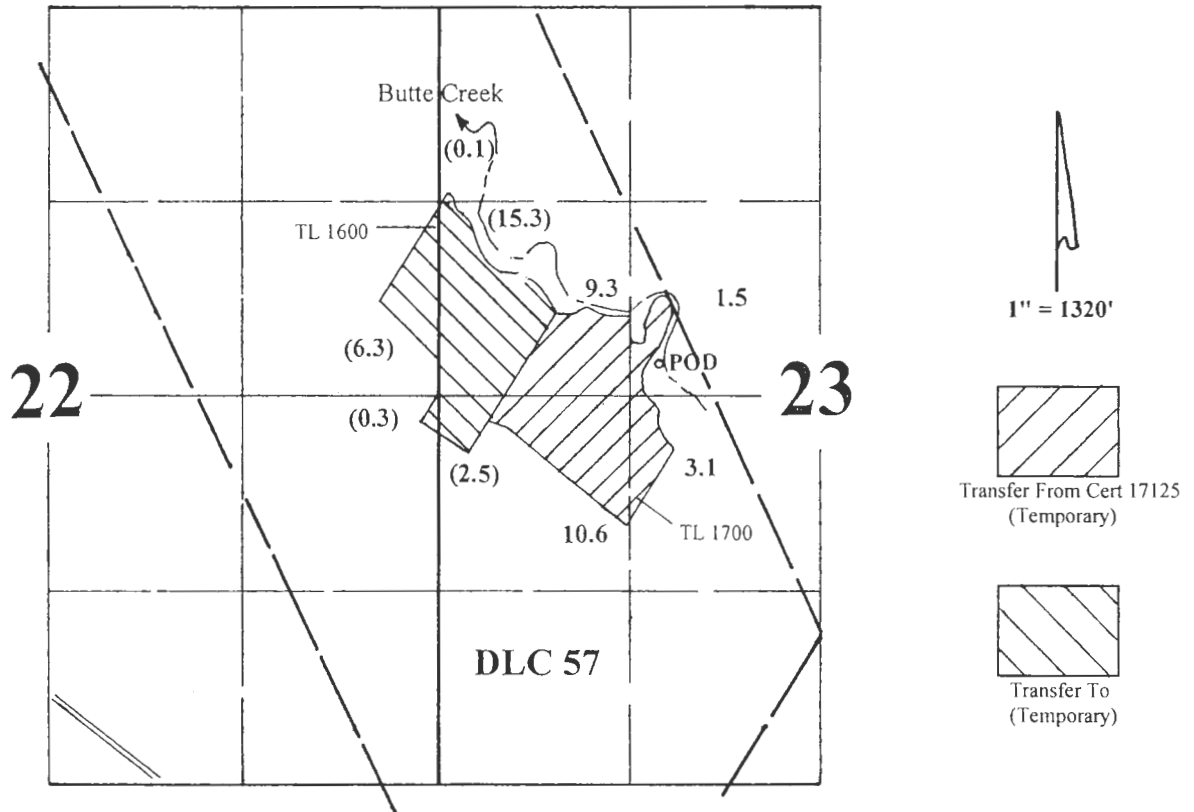

POD is located 200' N & 1150' W from the center of Section 23.

## Application Map

# Chuck Eder Farms Inc.

Transfer (Temporary) #:

This Map was Prepared for the Purpose of Identifying the Location of a Water Right Only and is Not Intended to Provide Legal Dimensions or Location of Property Ownership Lines

RECEIVED

MAR 29 2017

OWRD

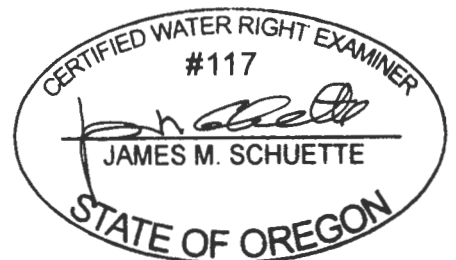

EXPIRES: 6.30.18

1 12526

# T.5S.R.1W.W.M.

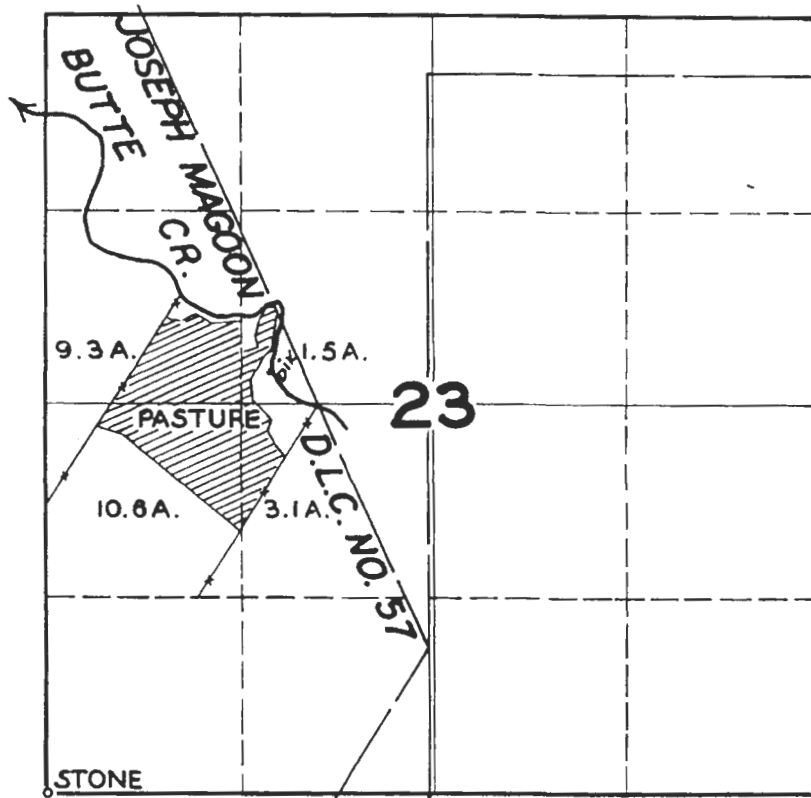

## FINAL PROOF SURVEY

UNDER

Application No. 21421 Permit No. 16804  
IN NAME OF

C. E. SKILLER

Surveyed APR. 29 1949, by JAS. E. BUNNELL

RECEIVED

MAR 29 2017

OWRD

T 12526