

Application for Water Right Transfer in the Name of Union Pacific Railroad Company

Application S-68979, Permit S-49914, Certificate 64084, FROM Lands

Wasco County, Oregon
Township 2 North, Range 13 East (W.M.)

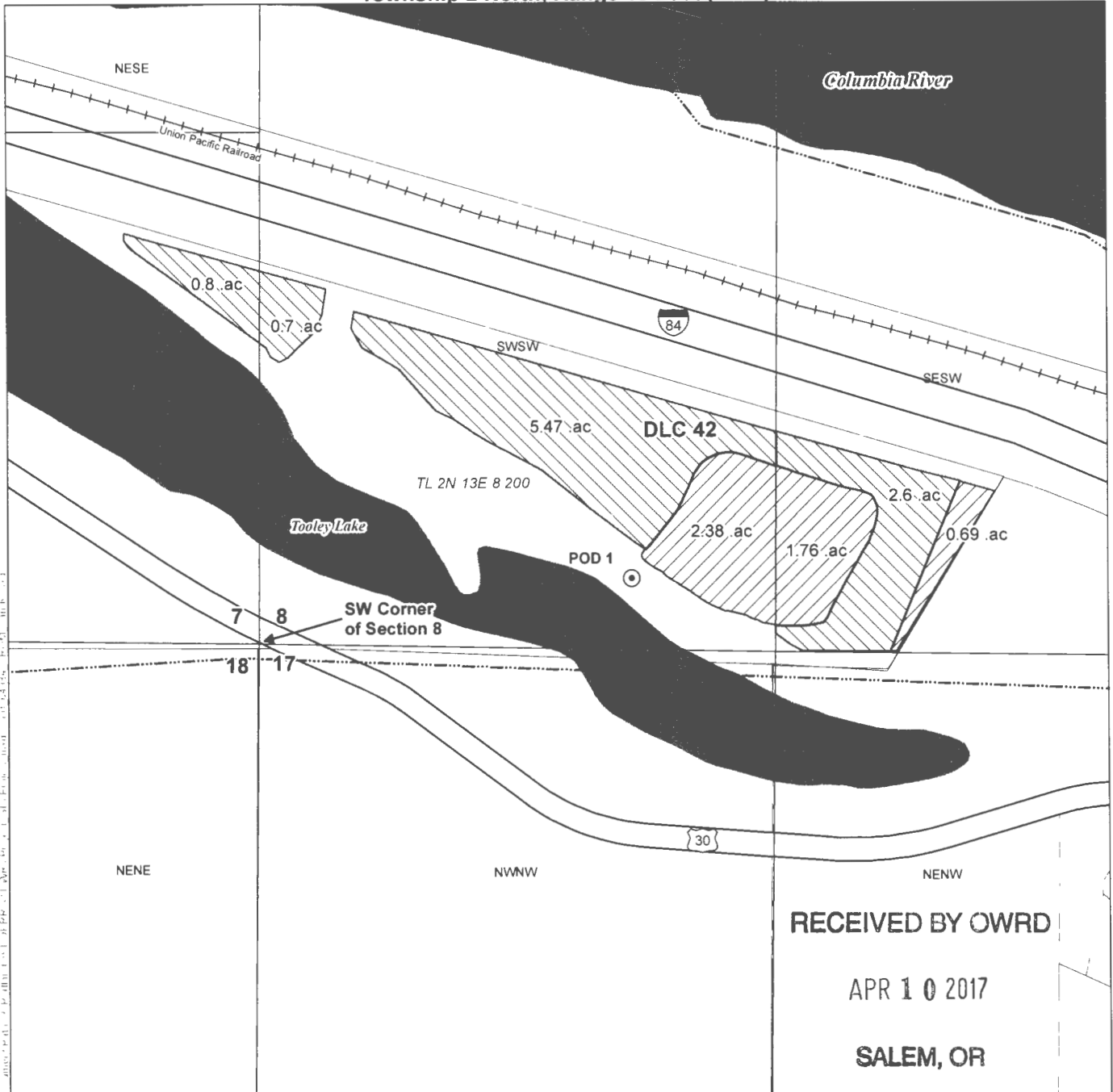

- Point of Diversion (POD)
- Remaining Lands
- From Lands
- Donation Land Claims (DLCs)
- Taxlots
- Waterbodies
- Railroad

POD Location Description
Authorized POD - POD 1
Located 180 feet North and 960 feet East from the SW corner of Section 8, Township 2 North, Range 13 East (W.M.)

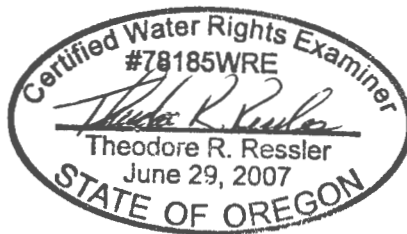

EXPIRES: 12-31-2018

Disclaimer
This map was prepared for the purpose of identifying the location of a water right only and it is not intended to provide legal dimensions or location of property ownership lines

Map Notes
Date: 11/17/2016
Data Sources: CH2M Hill, Wasco County, US BLM, USGS
Prepared By: GSI Water Solutions, Inc.

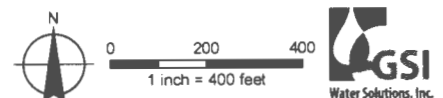

T 12639

Application for Water Right Transfer in the Name of Union Pacific Railroad Company

Application S-68979, Permit S-49414, Certificate 64084, TO Lands

Wasco County, Oregon
Township 2 North, Range 13 East (W.M.)

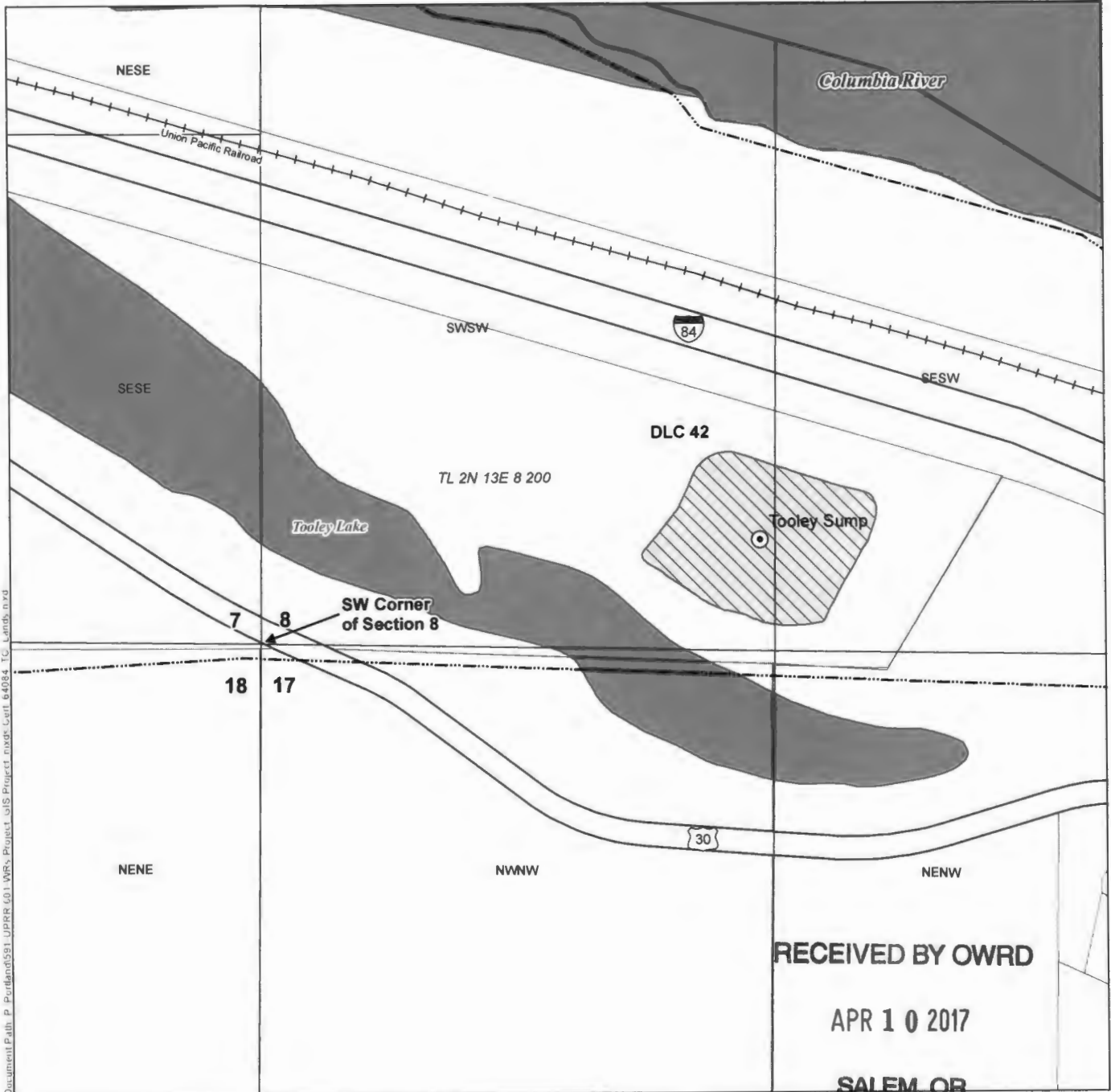

Document Path: P:\Portland\551_LUPRRR\GIS\Project_mxd\Cert_64084_TL_Lands.mxd

- Point of Appropriation
- Wetland (Proposed Place of Use)
- Donation Land Claims (DLCs)
- Tax Lots
- Waterbodies
- Railroad

POA Location Description

Proposed POA - Tooley Sump
Located 280 feet North and 1,295 feet East from the SW corner of Section 8, Township 2 North, Range 13 East (W.M.)

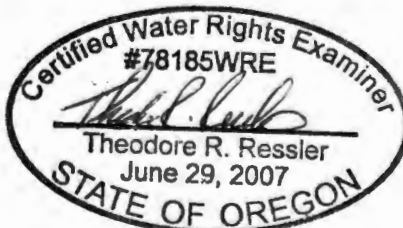

EXPIRES: 12-31-2018

Disclaimer
This map was prepared for the purpose of identifying the location of a water right only and it is not intended to provide legal dimensions or location of property ownership lines.

Map Notes
Date: 11/17/2016
Data Sources: CH2M Hill, Wasco County, US BLM, USGS
Prepared By: GSI Water Solutions, Inc.

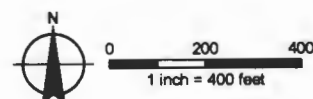

T 12639