

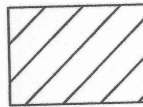

**TRANSFER APPLICATION MAP
FOR THE
U.S. FISH AND WILDLIFE SERVICE,
KLAMATH BASIN NATIONAL WILDLIFE REFUGE COMPLEX
IN T. 34 & 35 S., R. 7 1/2 E., W.M.**

-  A# S-488, P# S-309, C# 42581 AUTHORIZED PLACE OF USE
-  ACREAGE TO BE TRANSFERRED
-  UPPER KLAMATH LAKE NATIONAL WILDLIFE REFUGE BOUNDARY

AUTHORIZED POINT OF DIVERSION IS LOCATED 7325 FEET NORTH AND 940 FEET EAST FROM THE SW CORNER OF SECTION 3, BEING WITHIN LOT 3 OF SECTION 3, T 34 S, R 7.5 E, W.M.
MAP BASED ON FINAL PROOF SURVEY MAP PREPARED BY OWRD STAFF FROM SURVEYS CONDUCTED IN 1964 AND 1970

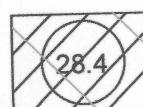

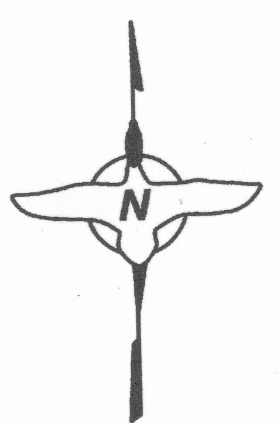
SCALE: 1 INCH = 1320 FEET

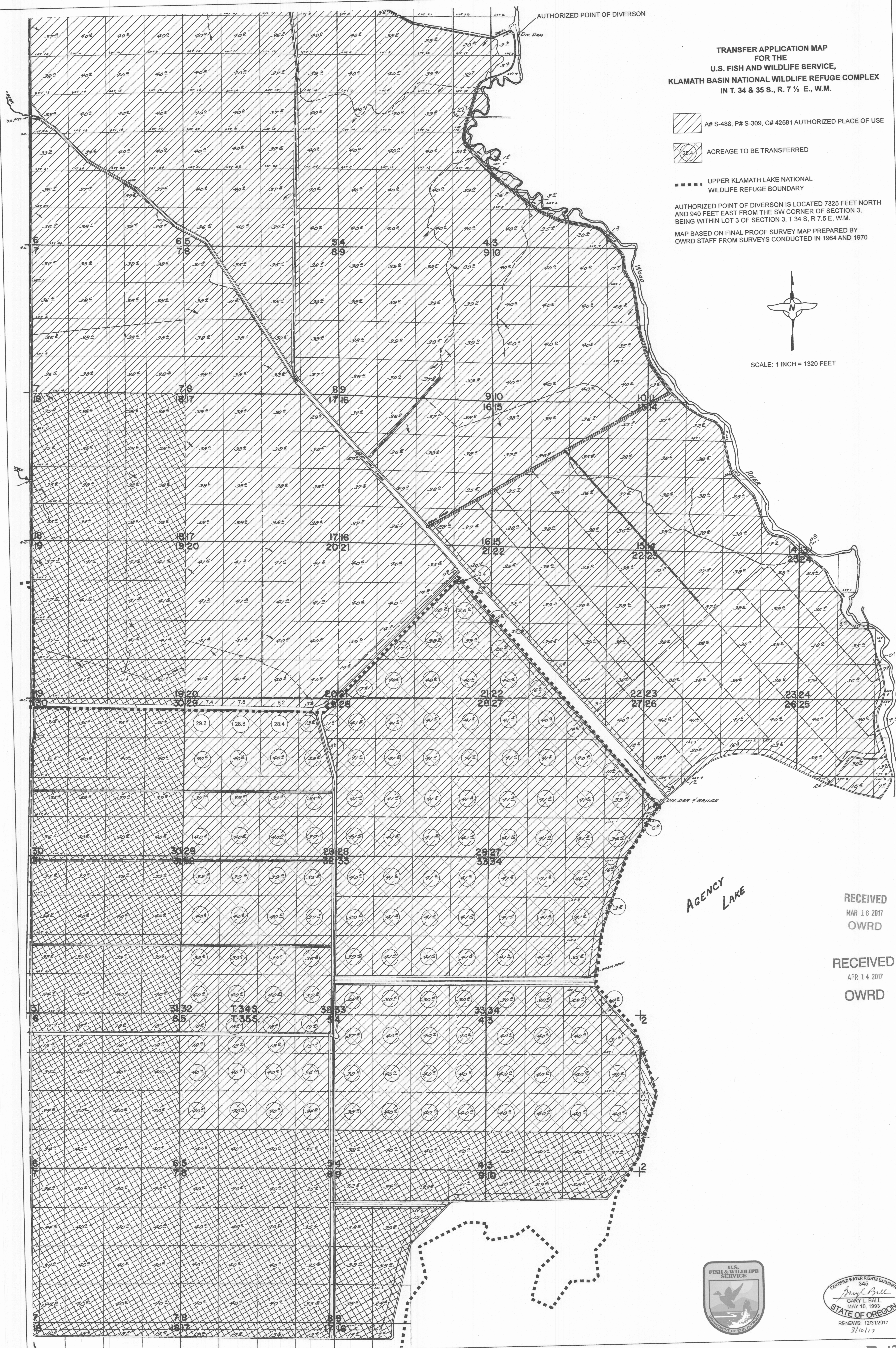

AGENCY LAKE

RECEIVED
MAR 16 2017
OWRD

RECEIVED
APR 14 2017
OWRD

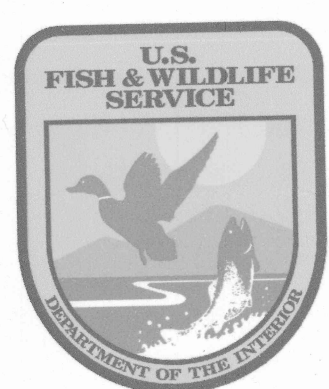

CERTIFIED WATER RIGHTS EXAMINER
345
Gary L. Ball
GARY L. BALL
MAY 18, 1993
STATE OF OREGON
RENEWS: 12/31/2017
3/10/17