

**LEGEND**

- Howard Prairie Reservoir Outlet
- Tax Lot
- Government Lot (GL)
- Watercourse
- Waterbody

**POD LOCATION DESCRIPTION**  
**HOWARD PRAIRIE RESERVOIR OUTLET**  
 Located 1230 feet North and 2285 feet East from the SW  
 Corner of Section 32, Township 38 South, Range 4 East (W.M.)

**DISCLAIMER**  
 This map was prepared for the purpose of identifying the location of a water right only  
 and it is not intended to provide legal dimensions or location of property ownership lines

Date: September 23, 2016  
 Data Sources: Jackson County GIS, OWRD

**Application for Water Right Transfer  
 in the name of the  
 United States Bureau of Reclamation**  
**Authorized Point of Diversion for Certificate 80462**

RECEIVED BY OWRD

JUN 12 2017

SALEM, OR

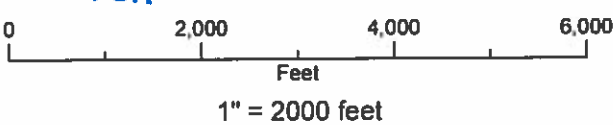

T 12685

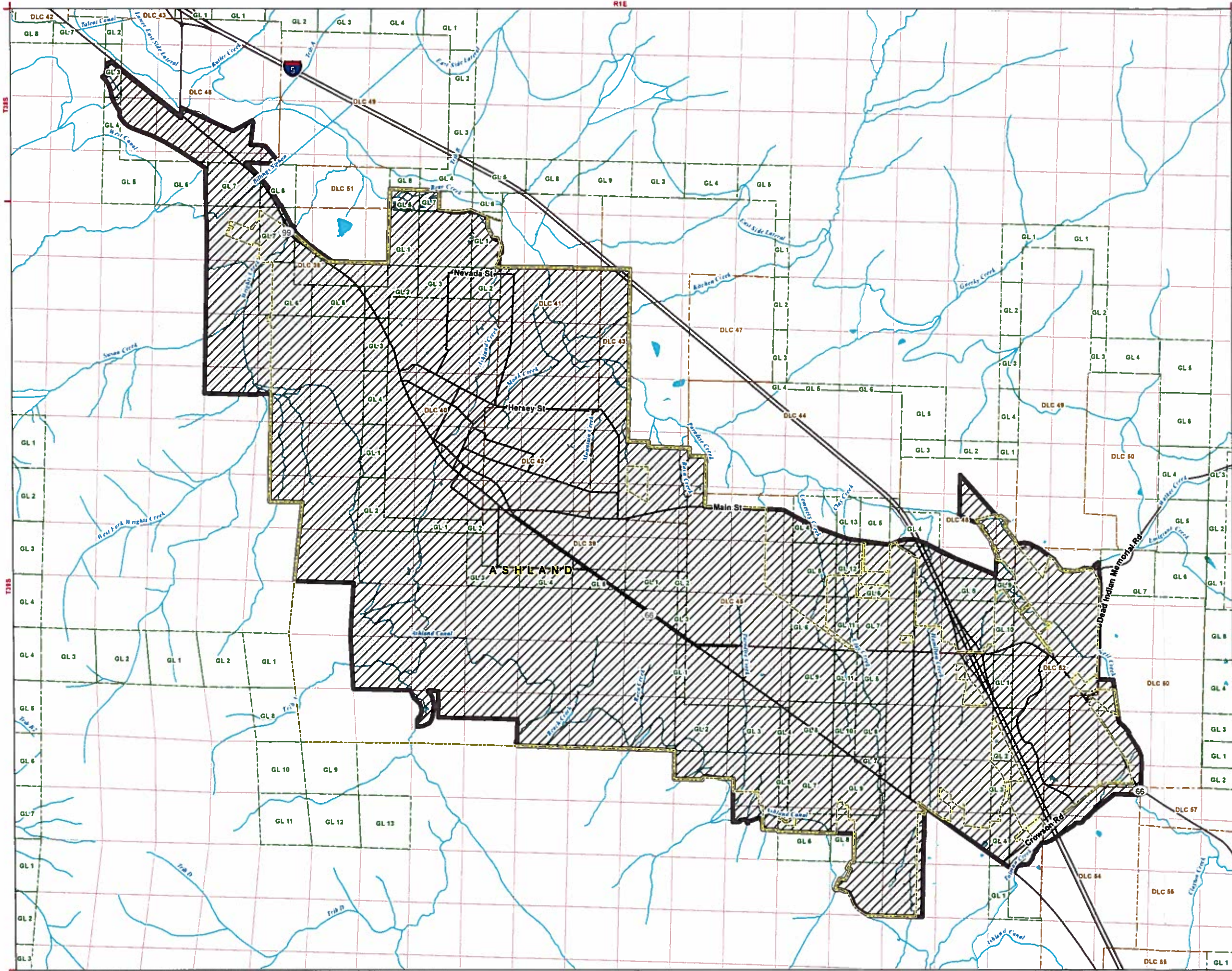

**Application for Water Right Transfer  
in the name of the  
United States Bureau of Reclamation**

**Proposed Place of Use  
Certificate 80462**

**Township 38 South, Range 1 West (W.M.)**

**LEGEND**

- Proposed Place of Use (POU)
- Government Lot (GL)
- Donation Land Claim (DLC)
- City Limit
- City Service Area
- Watercourse
- Waterbody

**Place of Use Description**  
"Within the service boundary of the City of Ashland"

**RECEIVED BY OWRD**

**JUN 12 2017**

**SALEM, OR**

Certified Water Rights Examiner Stamp

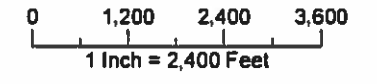
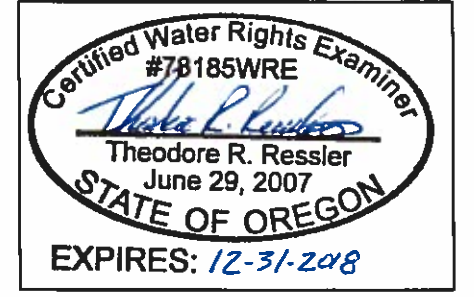

**DISCLAIMER**

This map was prepared for the purpose of identifying the location of a water right only and it is not intended to provide legal dimensions or location of property ownership lines.

Date: May 26, 2017  
Data Sources: Jackson County GIS, OWRD



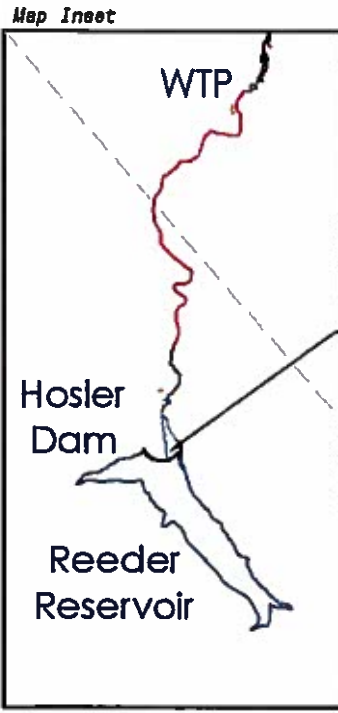
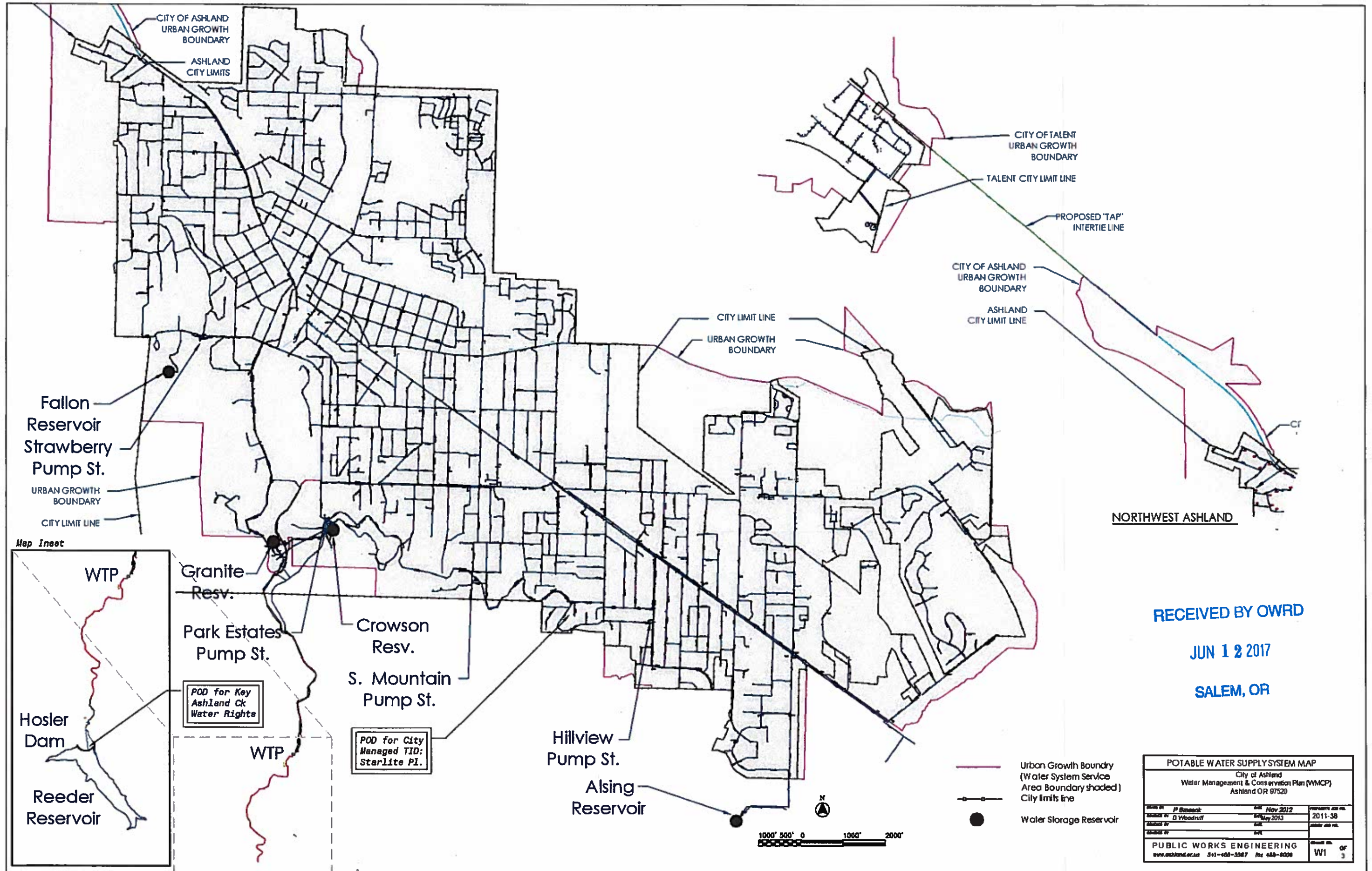

POD for Key Ashland Ck Water Rights

POD for City Managed TID: Starlite Pl.

RECEIVED BY OWRD  
JUN 12 2017  
SALEM, OR

POTABLE WATER SUPPLY SYSTEM MAP			
City of Ashland Water Management & Conservation Plan (WMCP) Ashland OR 97520			
Drawn by	P. Bismack	Date	Nov 2012
Checked by	D. Woodruff	Date	May 2013
Revised by		Date	
Revised by		Date	
PUBLIC WORKS ENGINEERING			Sheet No. of 3
www.ashland.or.us 541-468-3287 fax 468-8008			W1