

LFC Field Map - revised 2015

Proposed for ~~2015~~ Growing Season
(and Actual)

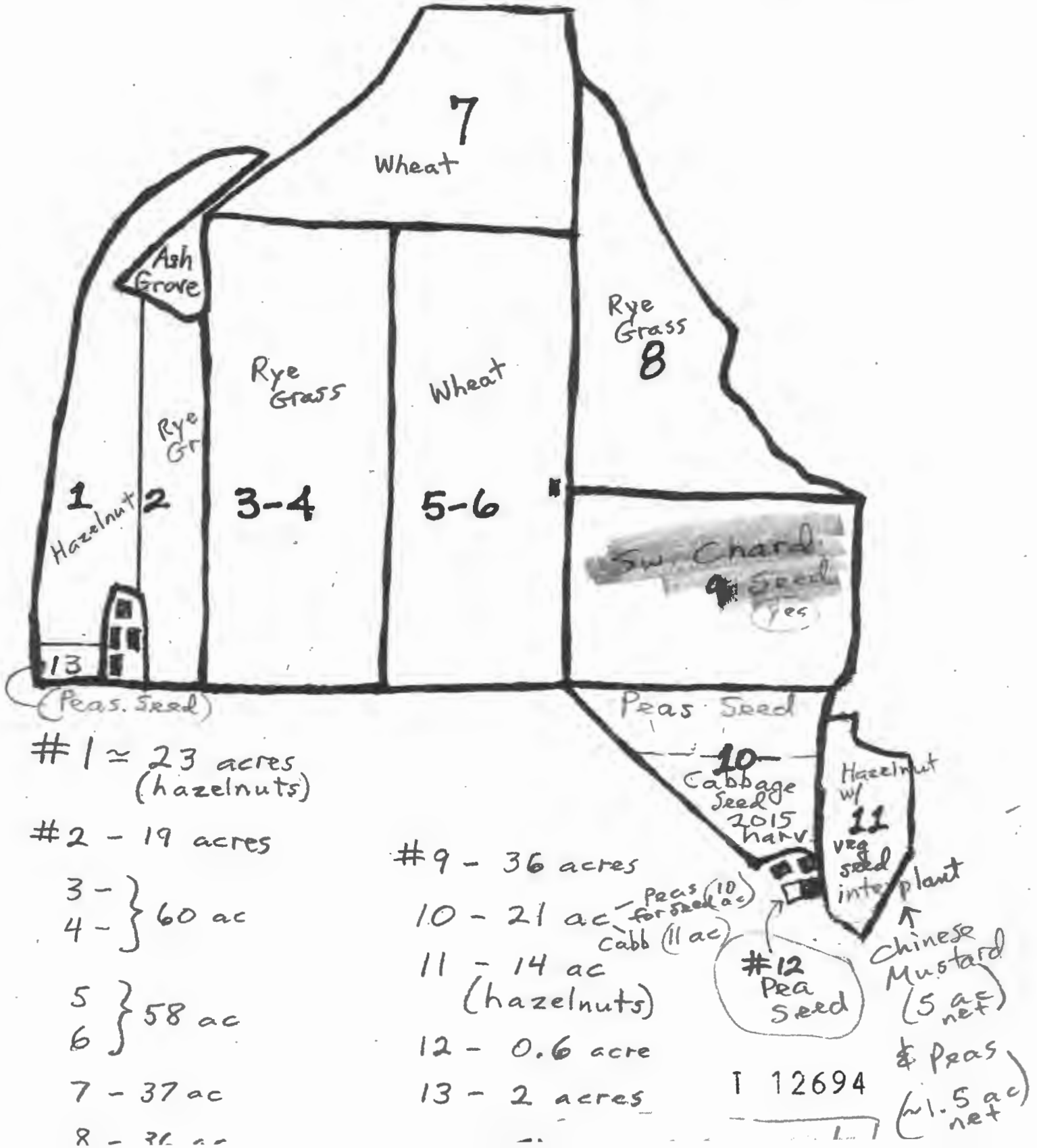

#1 ≈ 23 acres (hazelnuts)

#2 - 19 acres

3 - }
4 - } 60 ac

5 }
6 } 58 ac

7 - 37 ac

8 - 26 ac

#9 - 36 acres

10 - 21 ac - Peas (10) for seed (ac) Cabb (11 ac)

11 - 14 ac (hazelnuts)

12 - 0.6 acre

13 - 2 acres

#12 Pea Seed

T 12694

Hazelnut w/ veg seed into plant
↑ Chinese Mustard (5 ac net)
& Peas (~1.5 ac net)



United States Department of Agriculture
 Farm Service Agency Photo 2012
2013 Yamhill County, OR
 Farm: 6607
 Tract: 73

- Wetland Determination Identifiers**
- Restricted Use
 - ▽ Limited Restrictions
 - Exempt from Conservation Compliance Provisions
 - Section Boundary
 - CLU Boundary

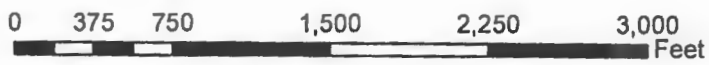

November 06, 2012

T 12694

SDA FSA maps are for FSA Program administration only. This map does not represent a legal survey or reflect actual ownership; rather it depicts the information provided directly from the producer and/or the 2012 ortho rectified imagery for Oregon. The producer accepts the data 'as is' and assumes all risks associated with its use. The USDA Farm Service Agency assumes no responsibility for actual or consequential damage incurred as a result of any user's reliance on this data outside FSA Programs. Wetland identifiers do not represent the size, shape, or specific determination of the area. Refer to your original determination (CPA-026 and attached maps) for exact boundaries and determinations, or contact NRCS.

This copy is a map from USDA / F.S.A. office in McMinnville; picked up Jan. 29, 2015 from Lorie Atkinson

T.5S. R.4.W. W.M.

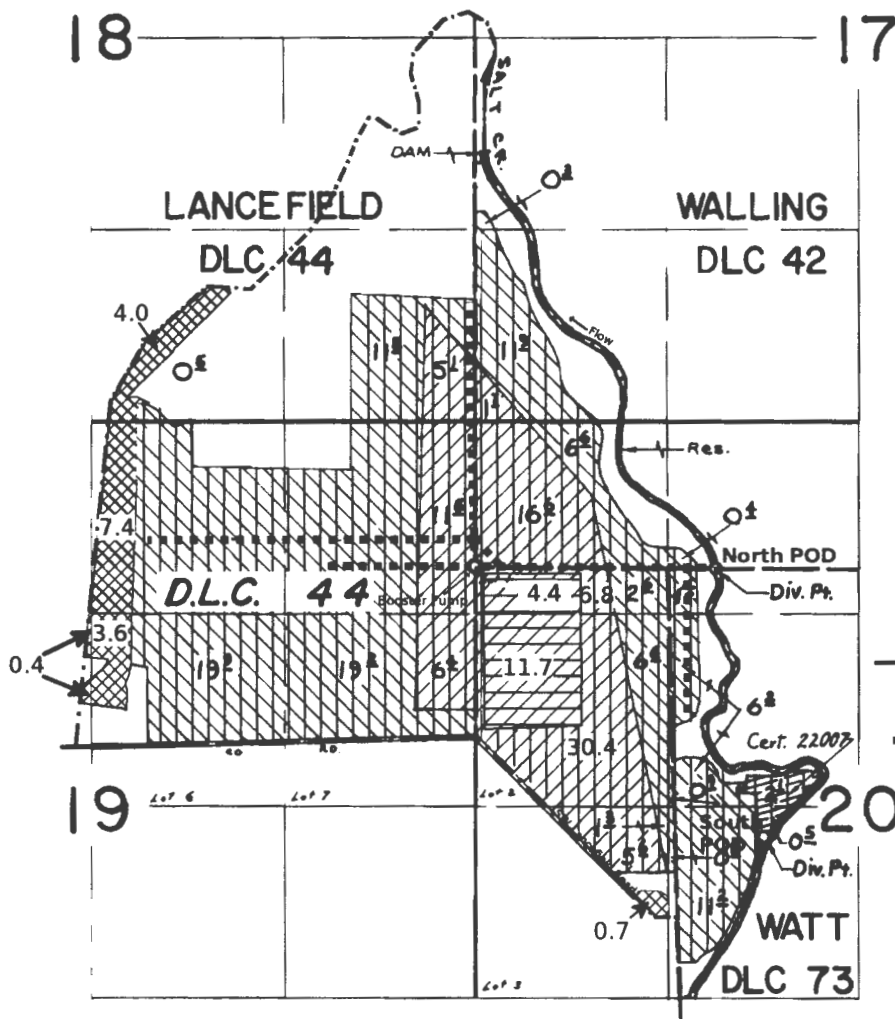

Scale: 1"=1320'

- Legend
- From Land
 - To Lands
 - Lands not affected by transfer
 - Property Boundary
 - Main lines

Div. Pts. Loc: 670'S. & 1980'E, 1180'N. & 1650'E., Dam - 4020'N. & 70'E.
all from SE corner Lancefield DLC 44

FINAL PROOF SURVEY UNDER

Application No. R-41605 41606 46494 Permit No. R-4713 31196 34745

Primary Supplemental

IN NAME OF

ROBERT & STUART LANCEFIELD

Surveyed MAY 29, 1973, by R. G. MUCKEN