

Rogue River Valley Irrigation District Water Rights Transfer Map

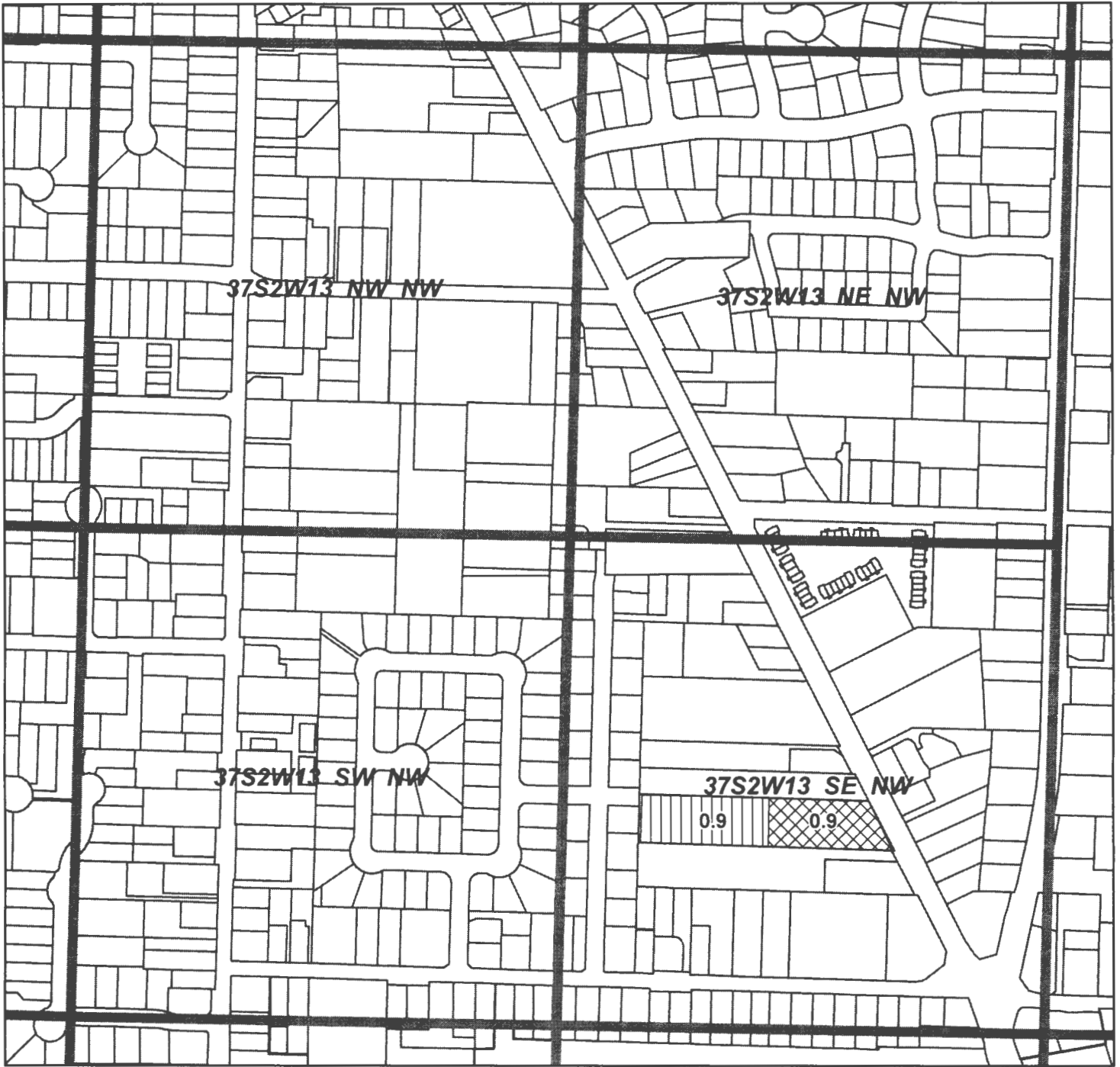

Located in SE 1/4 NW 1/4 SEC 13 T.37S. R.2 W.W.M
Tax Lot T37S R2W 13BD 3300 -0.9ac

RECEIVED BY OWRD

NOV 03 2017

From: RRVID 12769

SALEM, OR

- Certificates
 P85288
 S80575
 S80576
 S85876
 S85877

- Transfer Off
- Prior Transfer
- Qtr-Qtr
- Tax Lot Line

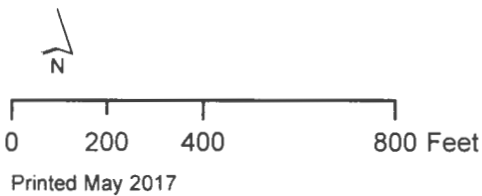

RRVID #17-01

Rogue River Valley Irrigation District Water Rights Transfer Map

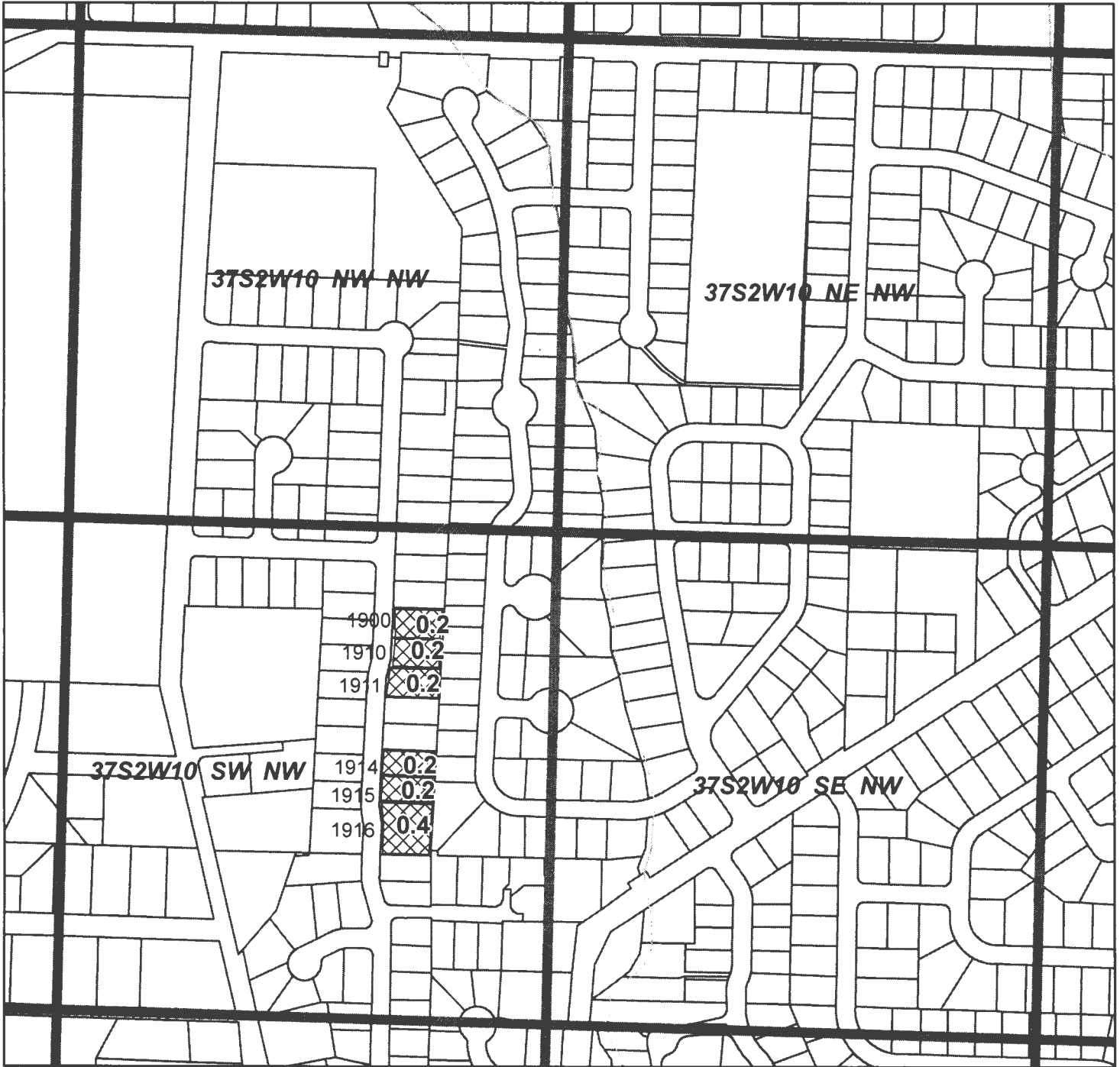

Located in SW 1/4 NW 1/4 SEC 10 T.37S. R.2 W.W.M.

From: RRVID

- Tax Lot T37S R2W 10BC 1900 -0.2ac
- Tax Lot T37S R2W 10BC 1910 -0.2ac
- Tax Lot T37S R2W 10BC 1911 -0.2ac
- Tax Lot T37S R2W 10BC 1914 -0.2ac
- Tax Lot T37S R2W 10BC 1915 -0.2ac
- Tax Lot T37S R2W 10BC 1916 -0.4ac

RECEIVED BY OWRD

NOV 03 2017

- Certificates
- P85288
 - S80575
 - S80576
 - S80577
 - S85876
 - S85877
 - S83729

SALEM, OR

T 12769

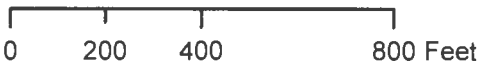

Printed May 2017

- Transfer Off
- Qtr-Qtr
- Tax Lot Line

RRVID #17-01

Rogue River Valley Irrigation District Water Rights Transfer Map

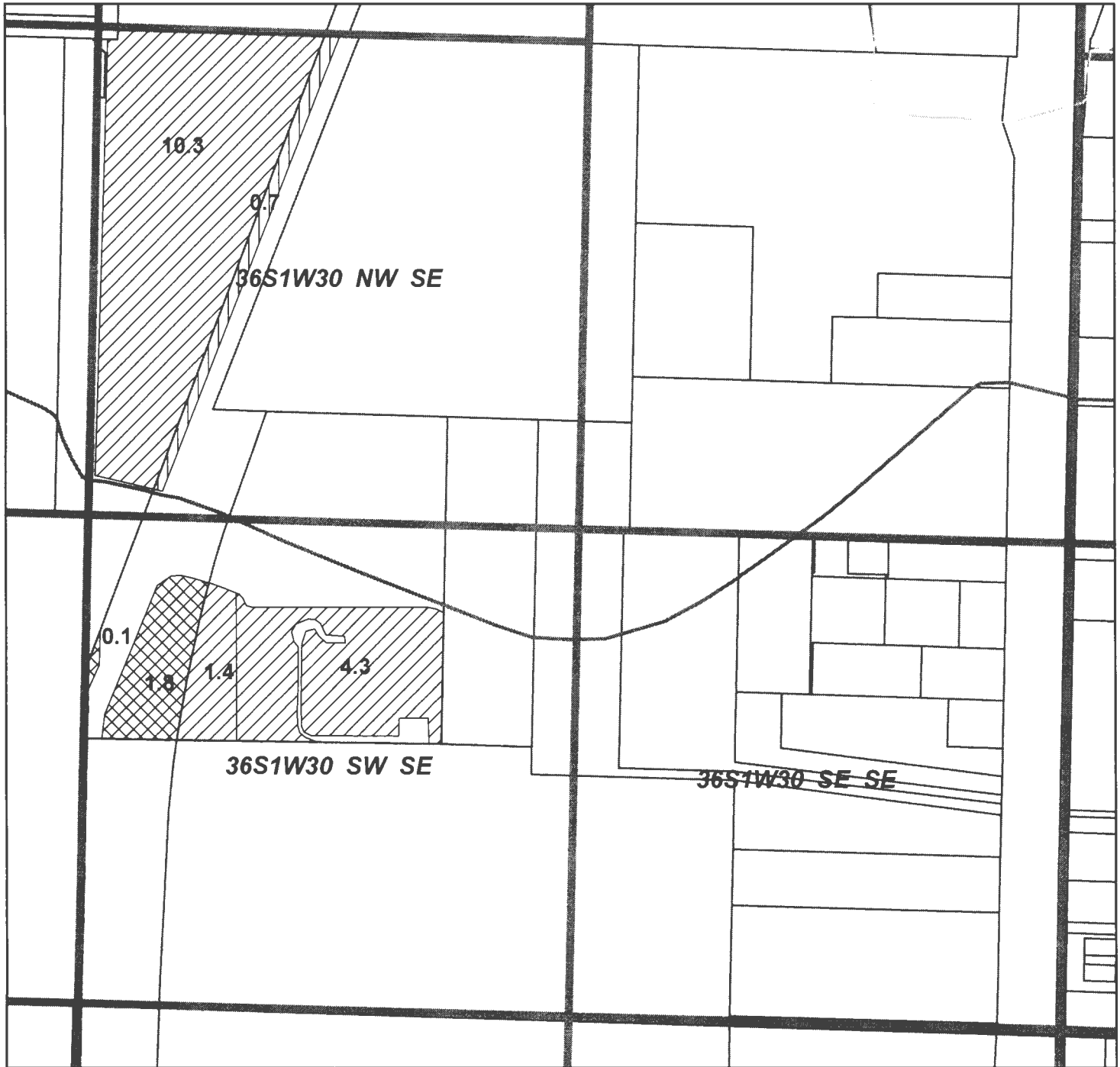

Located in W 1/2 SE 1/4 SEC 30D T.36S. R.1 W.W.M.
Tax Lot T36S R1W 30D 201 - 2.6 ac

From: RRVID

Certificates

- P85286
- P85288
- S85288
- S80576
- S85876
- S85877

RECEIVED BY OWRD

NOV 03 2017

SALEM, OR

- Transfer Off 85286
- Transfer Off 85288
- Current
- Tax Lot Line
- Qtr-Qtr

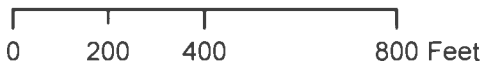

Rogue River Valley Irrigation District Water Rights Transfer Map

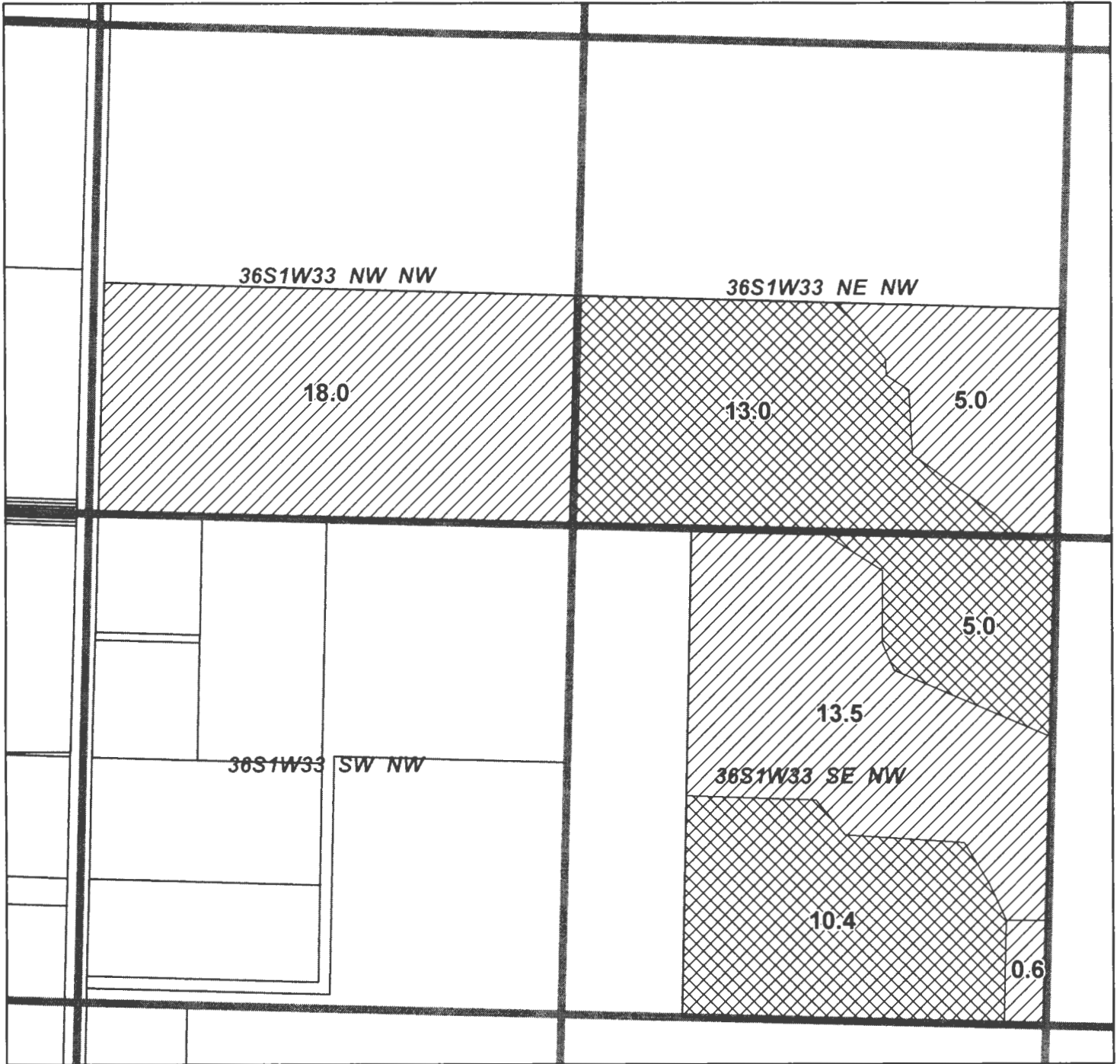

Located in East 1/2 NW 1/4 SEC 33 T.36S. R.1 W.W.M.

Tax Lot T36S R1W 33 300 - 28.4ac

From: RRVID

RECEIVED BY OWRD

Certificates





P85288
S80576
S85876
S85877

NOV 03 2017

SALEM, OR

RRVID #17-03

T 12769

-  Transfer Off
-  Remaining Water
-  Qtr-Qtr
-  Tax Lot Line

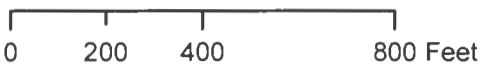

Printed Oct 2017

Rogue River Valley Irrigation District Water Rights Transfer Map



Located in SE 1/4 SW 1/4 SEC 31 T.36S. R.1 W.W.M.

Tax Lot T36S R1W 31 3300 - 2.0 ac

From: RRVID

Certificates **RECEIVED BY OWRD**

P85288
S80576
S85876
S85877

NOV 03 2017

SALEM, OR

RRVID #17-04

T 12769

- Transfer Off
- Remaining Water
- Qtr-Qtr
- Tax Lot Line

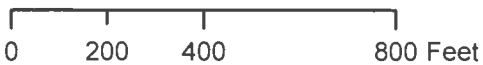

Printed Oct 2017

Rogue River Valley Irrigation District Water Rights Transfer Map

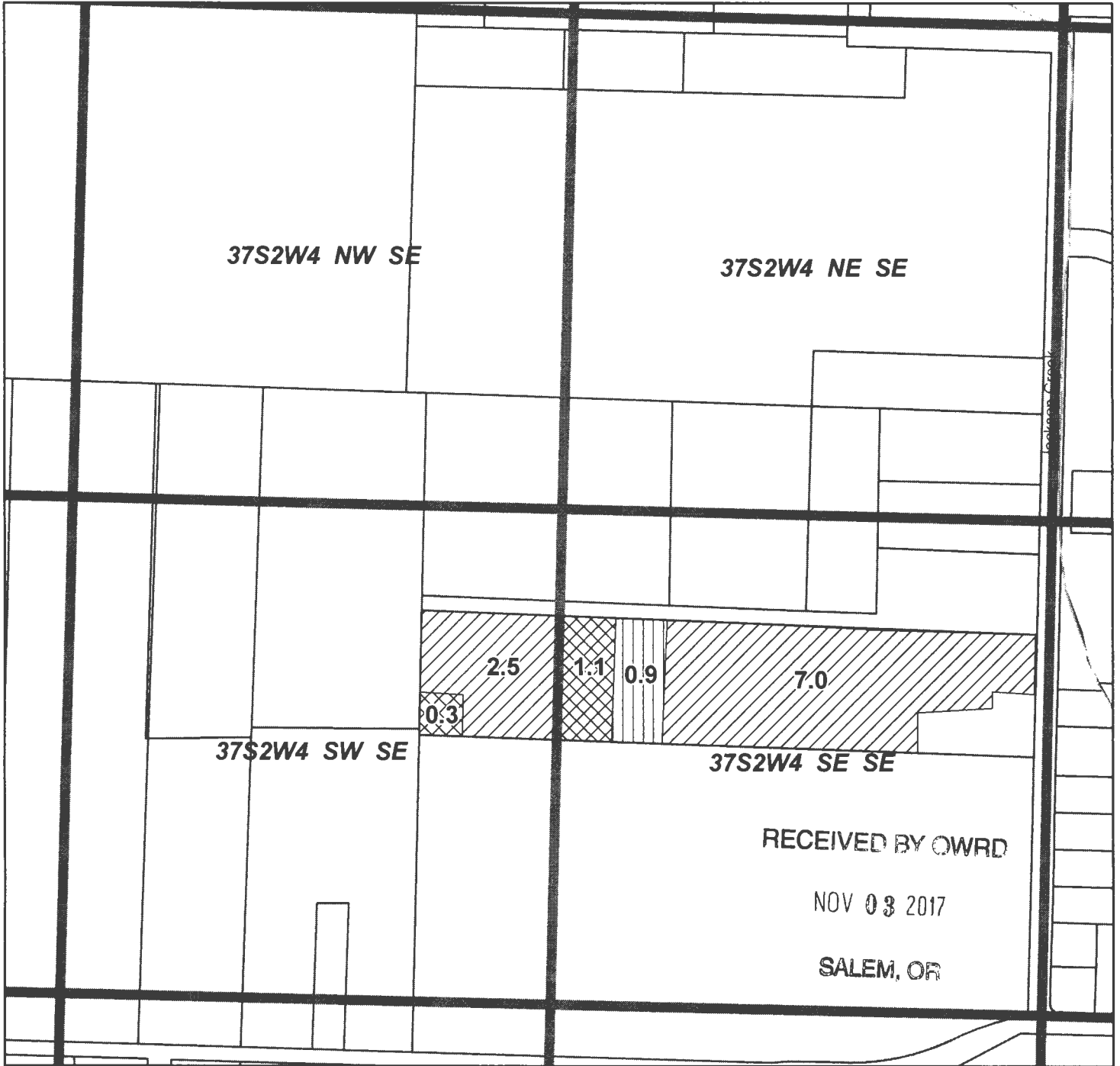





Located in SE 1/4 SE 1/4 SEC 04 T.37S. R.2 W.W.M.
Tax Lot T37S R2W 04 3200 -0.9ac

To: Kinderman

Certificates
P85288
S80575
S80576
S85876
S85877

RRVID #17-01

-  Transfer On
-  Prior Transfer
-  Current
-  Qtr-Qtr
-  Tax Lot Line

T 12769

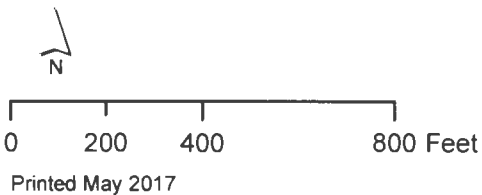

Rogue River Valley Irrigation District Water Rights Transfer Map

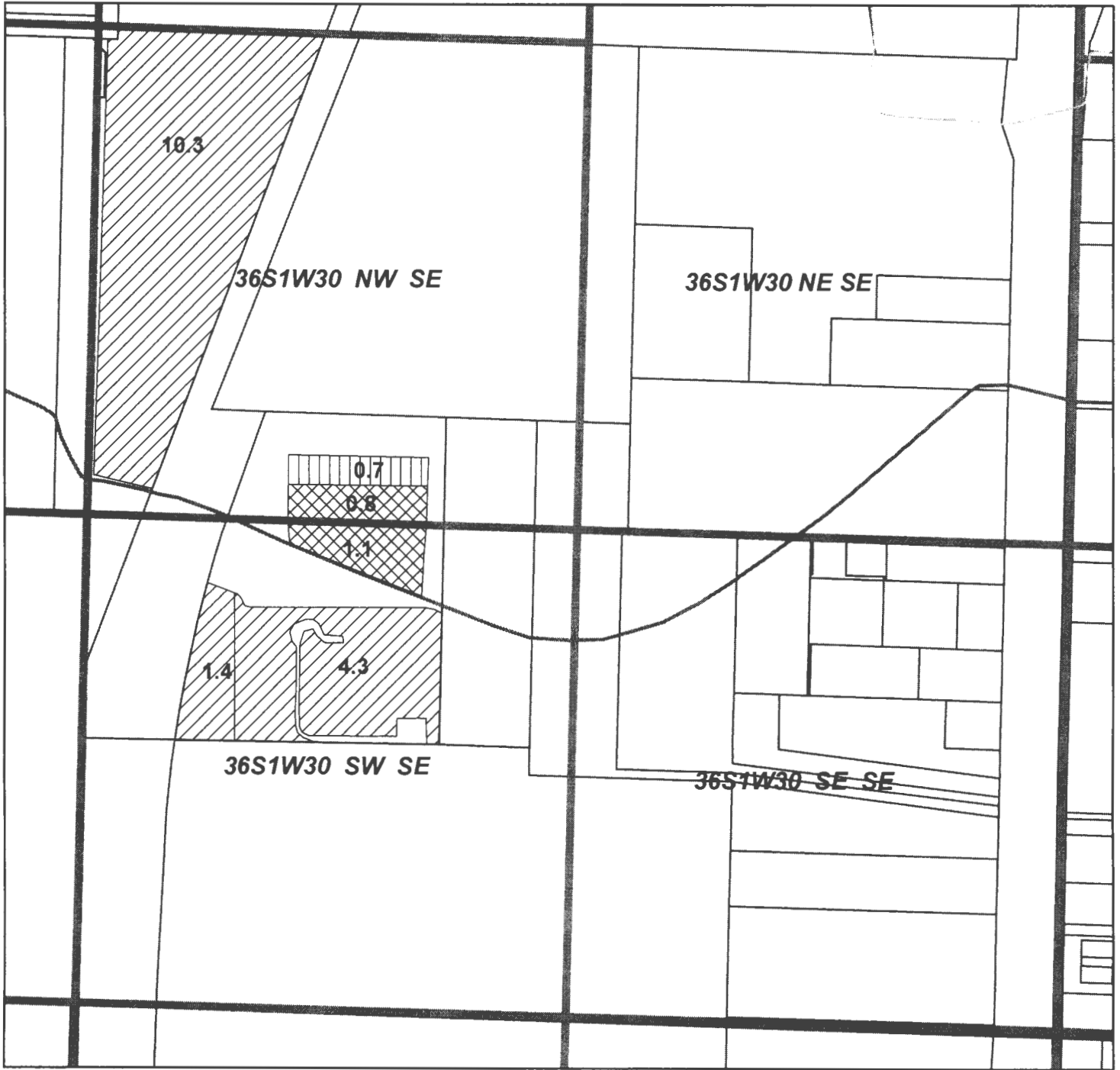

Located in W 1/2 SE 1/4 SEC 30D T.36S. R.1 W.W.M.
Tax Lot T36S R1W 30D 200 - 2.6 ac

To: Young

Certificates





- P85286
- P85288
- S85288
- S80576
- S85876
- S85877

RECEIVED BY OWRD

NOV 03 2017

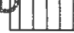
SALEM, OR

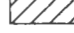
T 12769

-  Transfer On 85286
-  Transfer On 85288
-  Current
-  Tax Lot Line
-  Qtr-Qtr

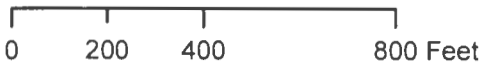

Rogue River Valley Irrigation District Water Rights Transfer Map

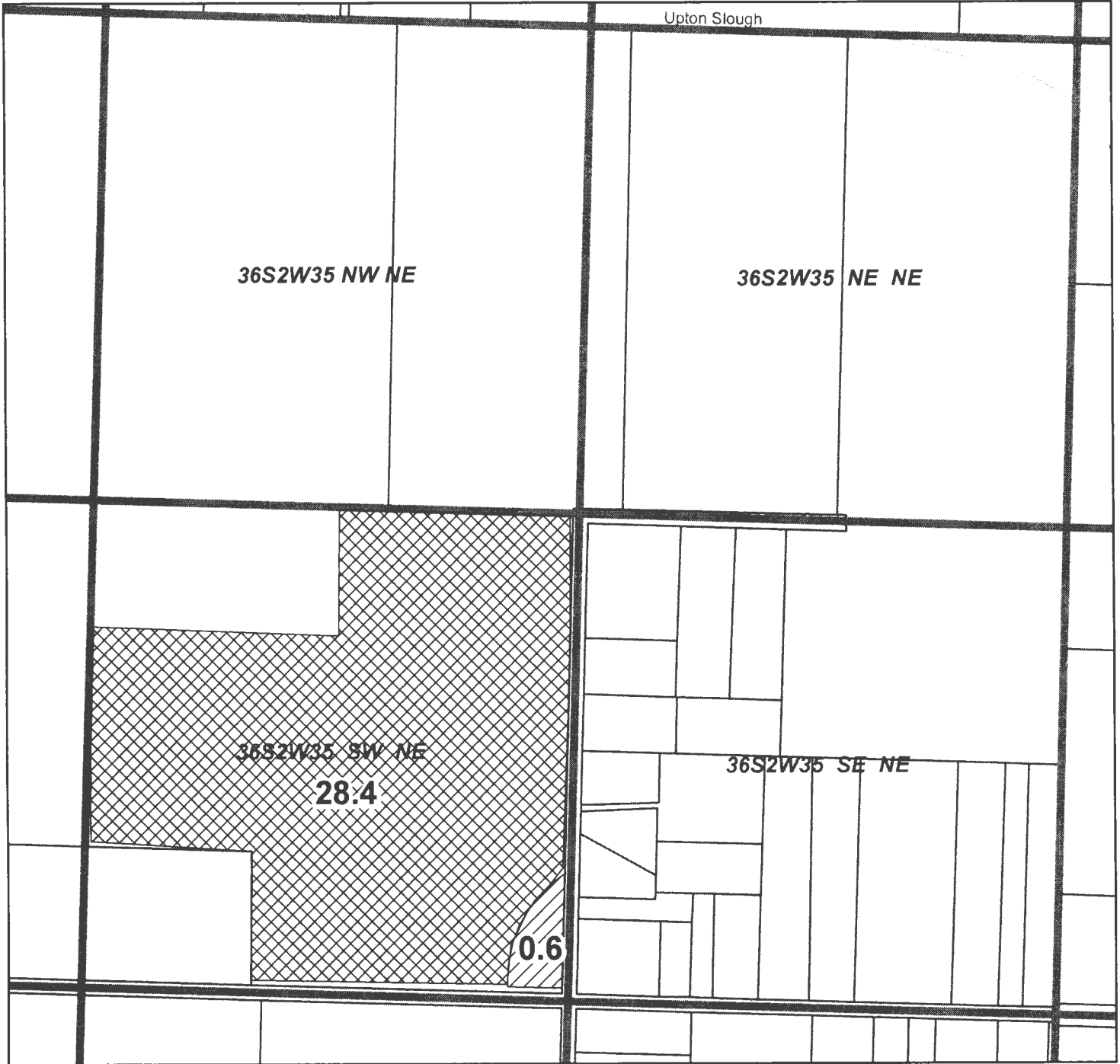

Located in SW 1/4 NE 1/4 SEC 35 T.36S. R.2 W.W.M.

Tax Lot T36S R2W 35 601 - 28.4ac

To: Straus





RECEIVED BY OWRD

Certificates

P85288
S80576
S85876
S85877

NOV 03 2017

SALEM, OR

-  Transfer On
-  Current Water
-  Qtr-Qtr
-  Tax Lot Line

RRVID #17-03

T 12769

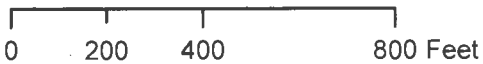

Printed Oct 2017

Rogue River Valley Irrigation District Water Rights Transfer Map

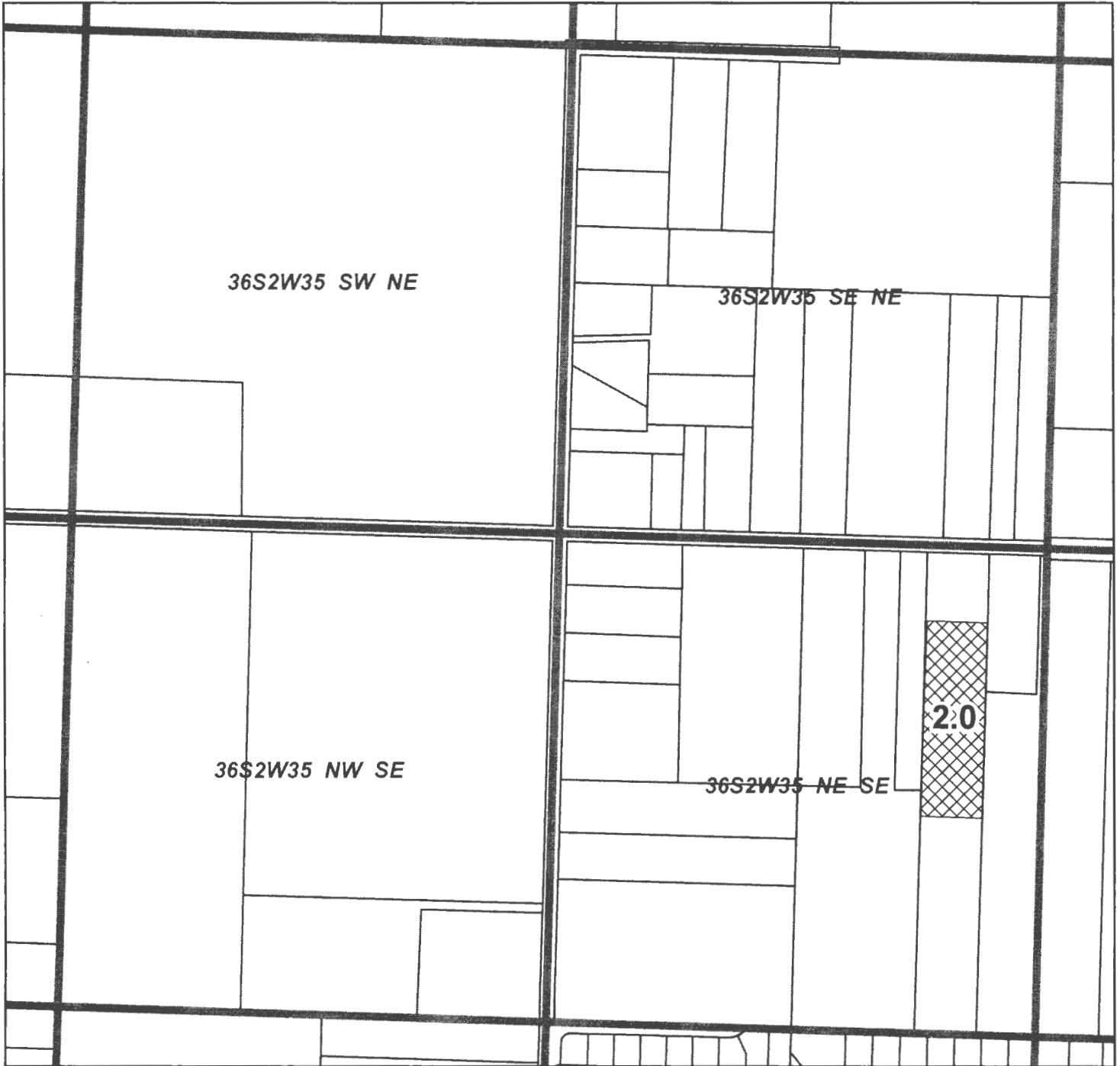

Located in NE 1/4 SE 1/4 SEC 35 T.36S. R.2 W.W.M.

Tax Lot T36S R2W 35D 200 - 2.0 ac

To: Lacey

Certificates **RECEIVED BY OWRD**

P85288
S80576
S85876
S85877

NOV 03 2017

SALEM, OR

T 12769

RRVID #17-04

- Transfer On
- Qtr-Qtr
- Tax Lot Line



Printed Oct 2017