

**T13S, R13E,
SECTION 34, WM**
JEFFERSON COUNTY, OREGON

27









0 1,320 Feet

1" = 1,320'

RECEIVED BY OWRD

DEC 22 2017

SALEM, OR

-  POU, Transfer ON
-  Township
-  Section
-  Quarter Quarter
-  Tax Lot
-  River
-  Point of Diversion

POD LOCATION:
1,180' N, 2,220' E OF SW COR SEC 34

RECEIVED BY OWRD

NOV 29 2017

SALEM, OR

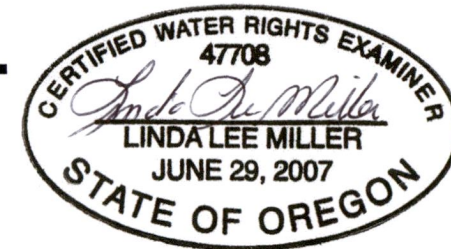

RENEWAL DATE 12/31/2018

TRANSFER "ON"
Knight Ranch

NOTE: THIS MAP IS NOT INTENDED TO
PROVIDE LEGAL DIMENSIONS OR LOCATIONS
OF PROPERTY OWNERSHIP LINES.

WATER RIGHT SERVICES, LLC
PO BOX 1830, BEND, OR 97709
CCB# 197121 www.oregonwater.us
541-389-2837 JOHNSHORT@USA.COM

OCTOBER 28, 2017

T. 12705

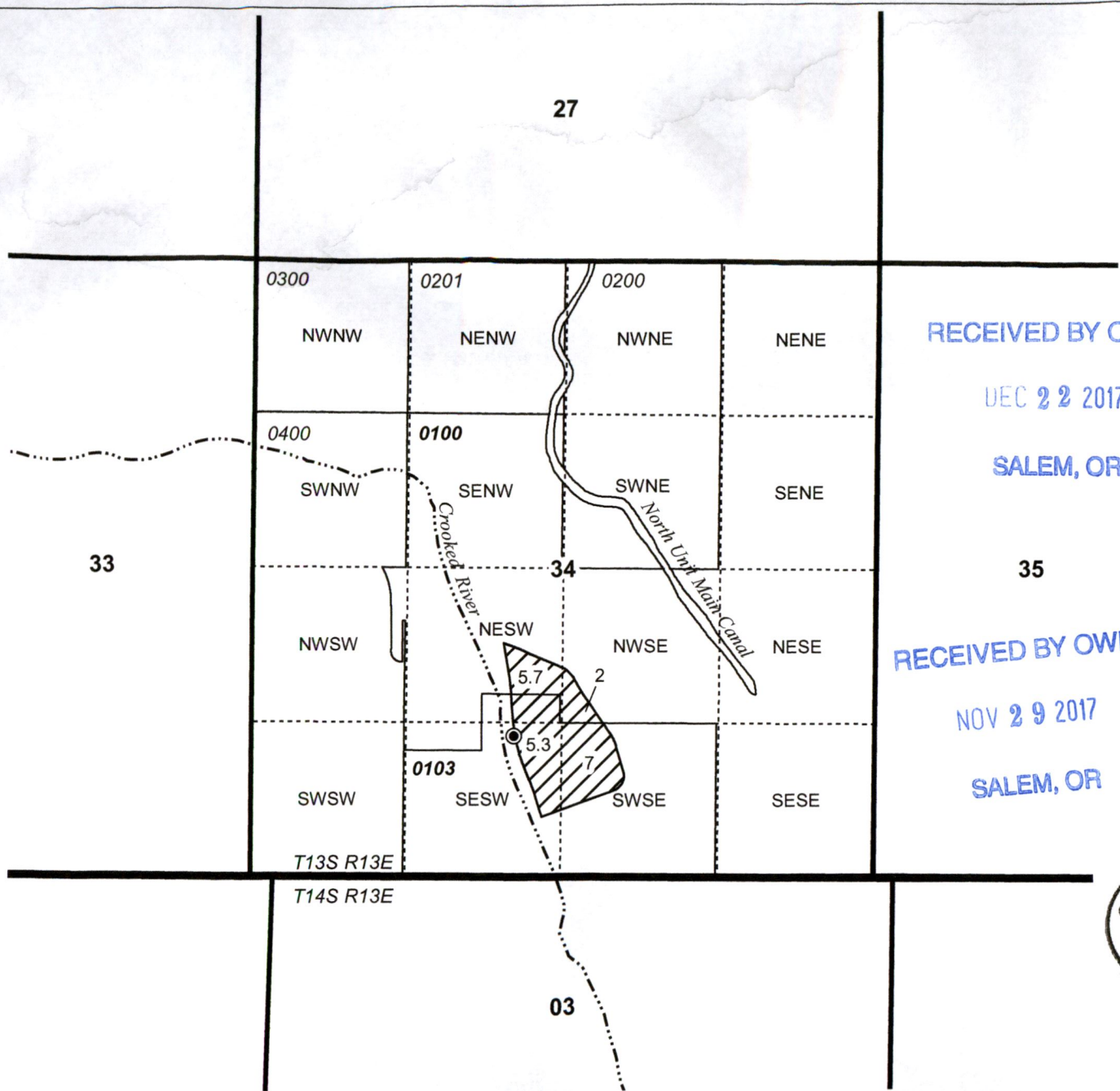

0 660 1,320 Feet
1" = 1320'



T 14 S, R 14 E, WM
SECTIONS 15 & 22
CROOK COUNTY, OREGON

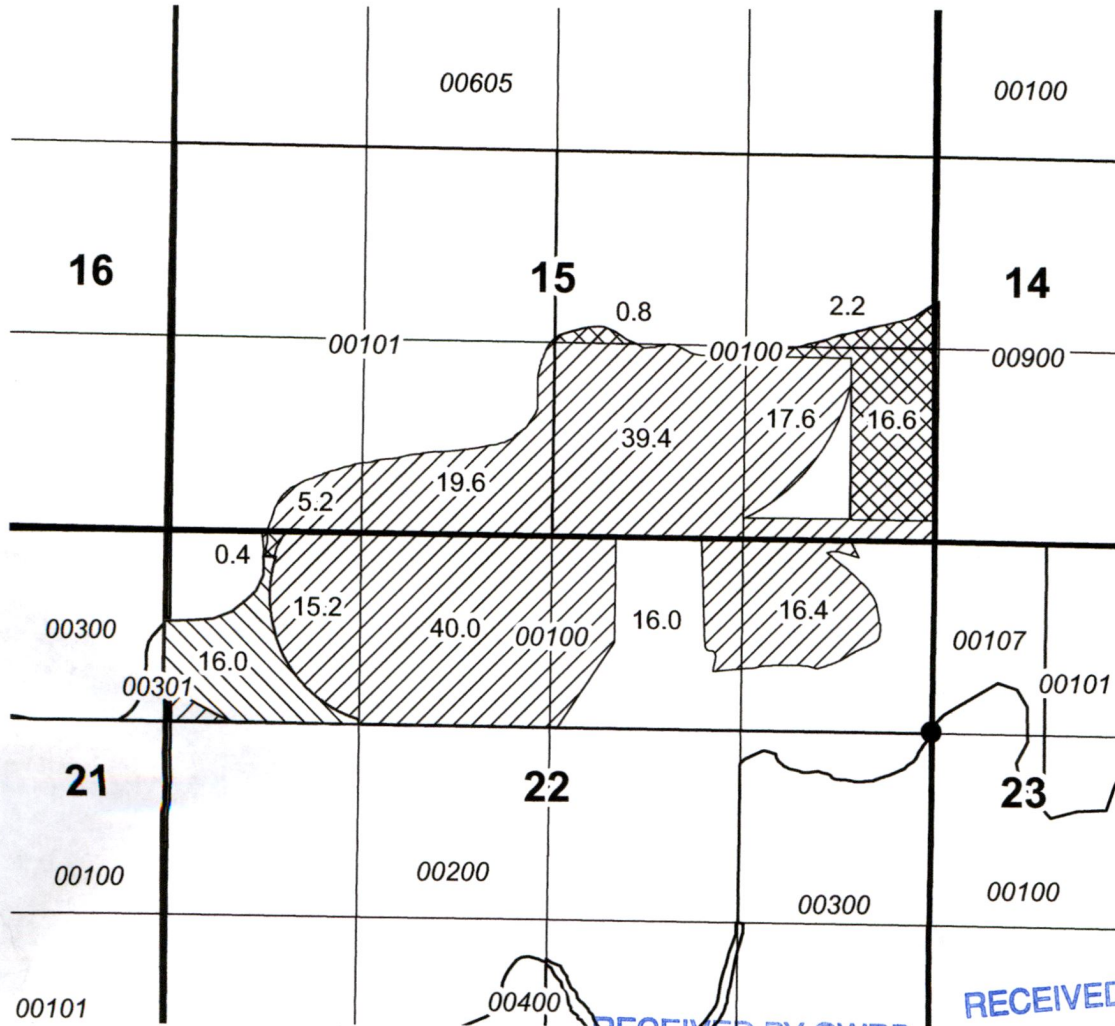

RECEIVED BY OWRD

RECEIVED BY OWRD

DEC 22 2017

NOV 29 2017

SALEM, OR

SALEM, OR

- POU IR OFF
- POU OFF in T-11347
- POU Remaining
- POD
- Sections
- QQ
- Tax Lots

POD - Direct Diversion No. 47A - 1300' S of NE Cor Sec 22.



Renwal Date 12-31-2018



| | | |
|--|---|--|
| <p>WATER RIGHT TRANSFER "OFF" MAP for BUTLER RANCH</p> <p>July 15, 2017 Cert 87331</p> | <p>This map is not intended to provide legal dimensions or locations of property ownership lines.</p> | <p>WATER RIGHT SERVICES, LLC PO BOX 1830, BEND, OR 97709 WWW.OREGONWATER.US 541-389-2837 johnshort@usa.com</p> |
|--|---|--|

T.12705