

RECEIVED

JAN 18 2018

OWRD

# T.5S. R.3W. Sec. 4, 5, and 8, W.M.

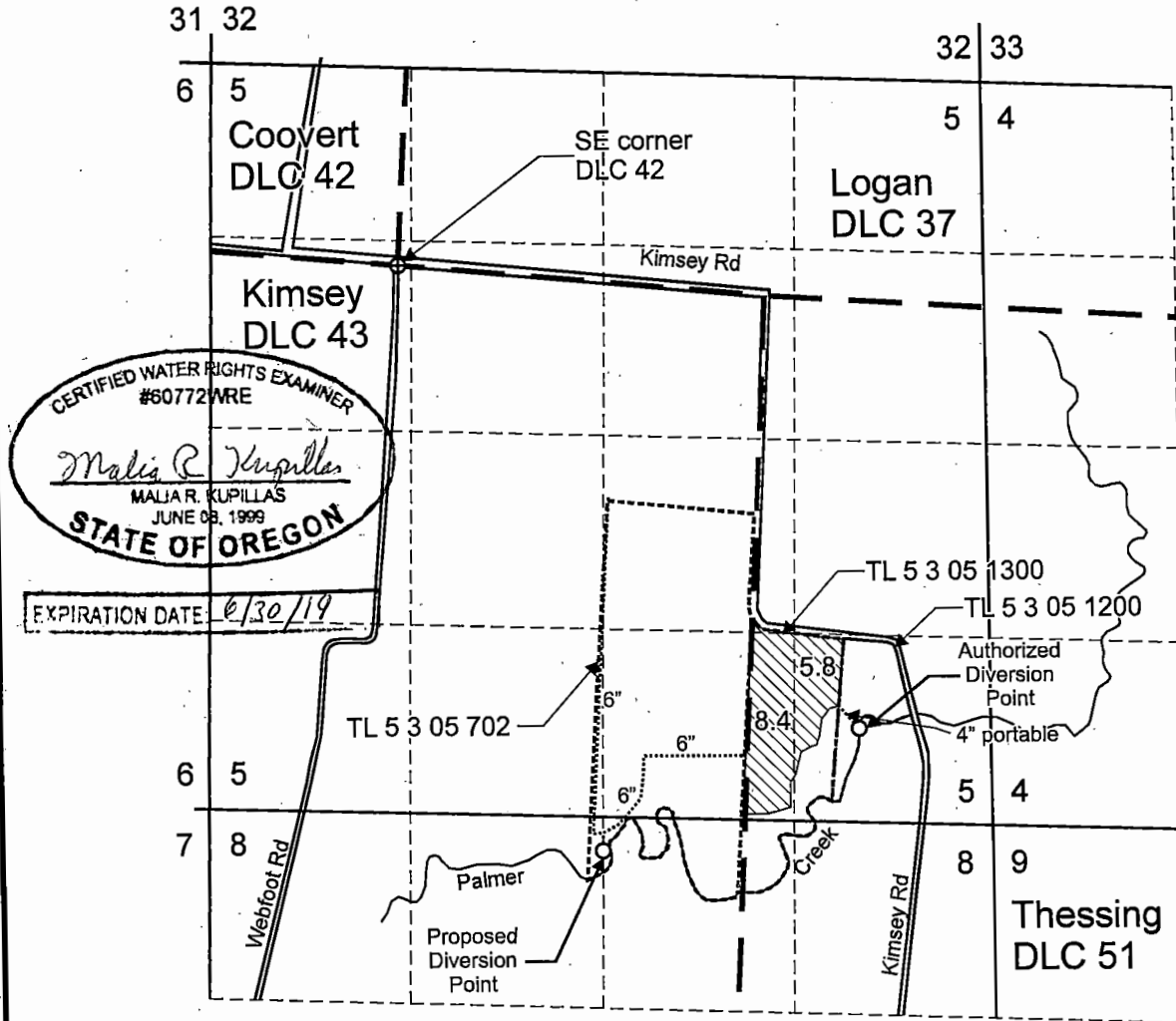

Authorized point of diversion is located in the SE 1/4, SE 1/4, Section 5, DLC 51.

Proposed point of diversion is located 4,020 feet south and 1,350 feet east from the SE corner, DLC 42.

Area (14.2 Acres) irrigated by Certificate 19850, priority date July 18, 1946.

- DLC boundary
- Tax lot boundary
- Mainline

Note: The quarter quarter lines have been projected using a tax map, government land survey maps, an aerial photograph, and best professional judgement.

This map was prepared for the purpose of identifying the location of a water right only and is not intended to provide legal dimensions or location of property ownership lines.

Scale: 1" = 1,320'

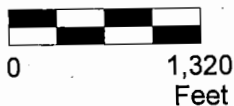

GordonTransferCert19850App.cdr

Pacific Hydro-Geology Inc.

12/2017

Transfer Application Map  
Certificate 19850

Carlton Nursery Co., LLC.  
Gordon/Ediger/Webfoot  
T.5S. R.3W. Sec. 4, 5, and 8, W.M.

12825