

POA Permit Application Application for G-15197

Jody Carpenter

Township 6 North, Ranges 34 & 35 East (W.M.) Umatilla County, Oregon

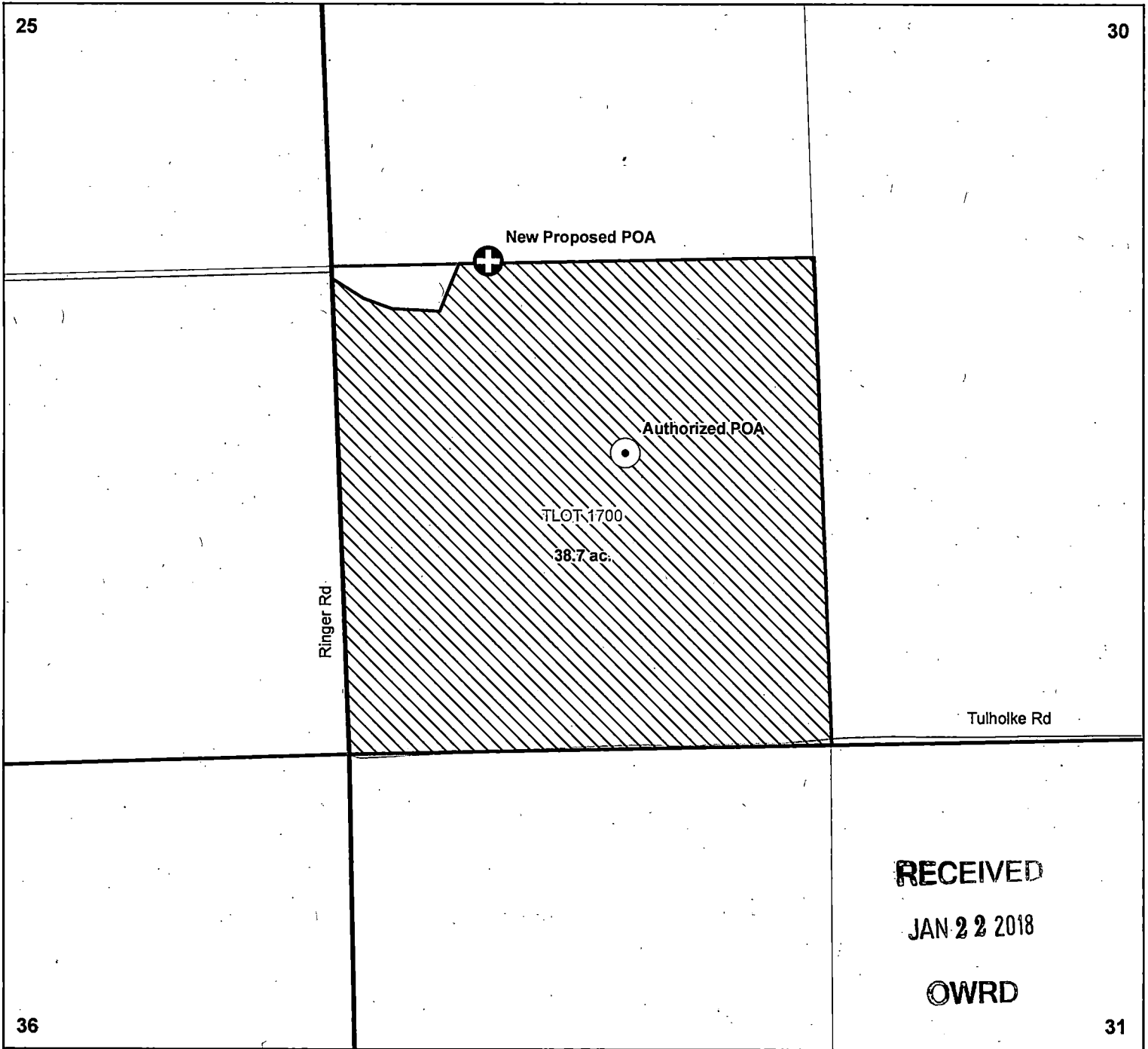





RECEIVED

JAN 22 2018

OWRD

LEGEND

-  Authorized POA
-  New Proposed POA
-  Place of Use
-  Tax Lots
-  Roads

POA Location Descriptions

Authorized POA

Located 794 feet North and 768 feet East from the SW corner, Section 30, Township 6 North, Range 35 East (W.M.)

New Proposed POA

Located 1,325 feet North and 426 feet East from the SW corner, Section 30, Township 6 North, Range 35 East (W.M.)

Disclaimer

This map was prepared for the purpose of identifying the location of a water right only and it is not intended to provide legal dimensions or location of property ownership lines.

Map Notes

Date: January 16, 2018
Data Sources: ESRI, BLM, USGS

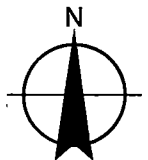
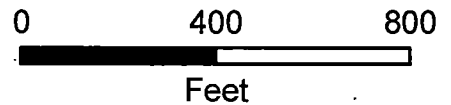

T 12828

TOWNSHIP 6 NORTH, RANGES 34 & 35 EAST, W.M.

NEW WELL PERMIT OCTOBER 9, 2000

WATER RESOURCES DEPT.
SALEM, OREGON

FEB 20 2001

RECEIVED

Application No. 915325
Permit No. 1

1" = 1320'

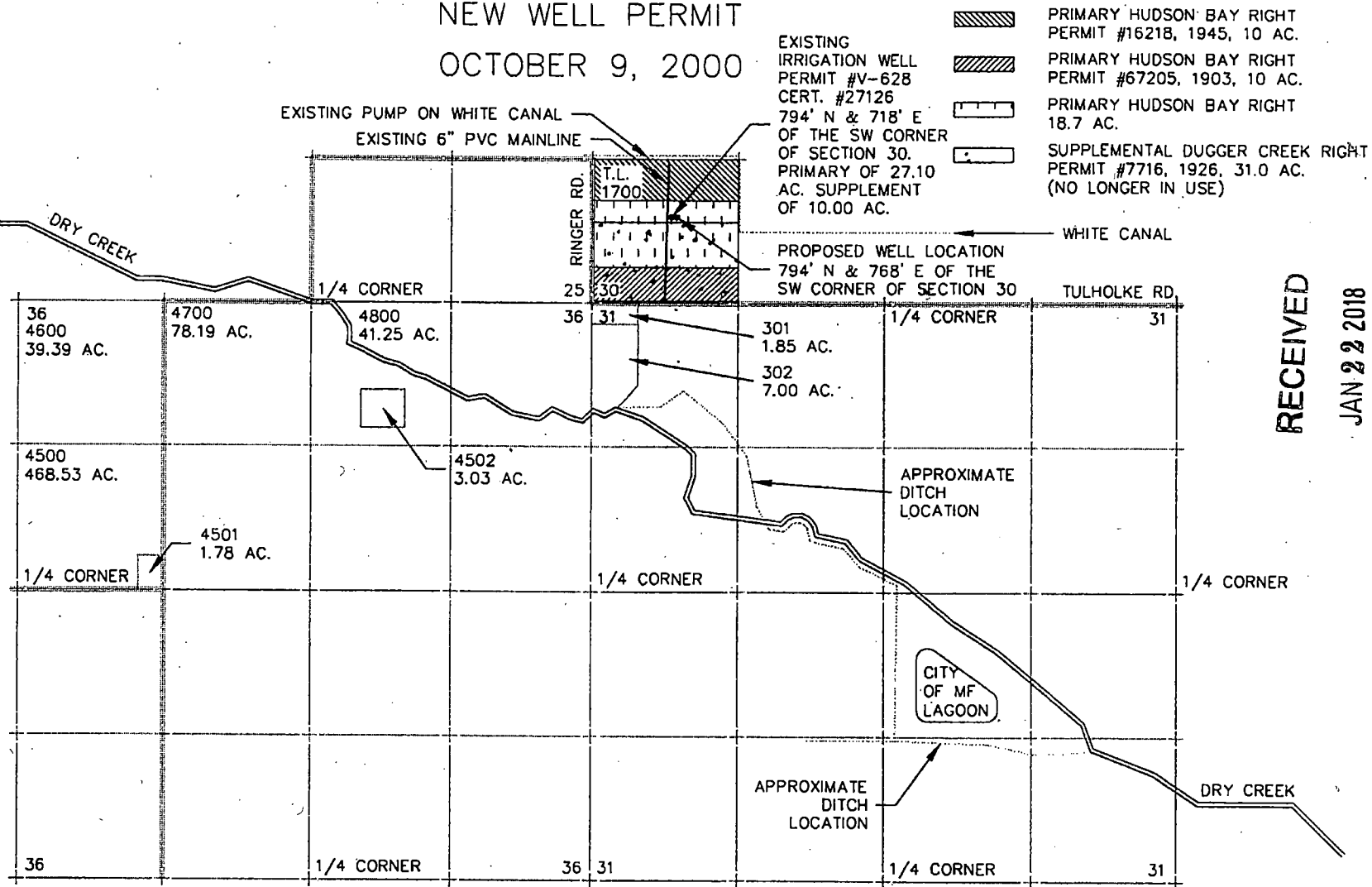

RECEIVED

JAN 22 2018

OWRD

1 12826

THIS MAP WAS PREPARED FOR THE PURPOSE OF IDENTIFYING THE LOCATION OF A WATER RIGHT ONLY AND IS NOT INTENDED TO PROVIDE LEGAL DIMENSIONS OR LOCATION OF PROPERTY OWNERSHIP LINES.

Certified Water Right Examiner
409WRE
David N. Randall
David N. Randall
May 18, 1995
STATE OF OREGON