

Section 4, T17S, R20E, W.M.,
Crook County, Oregon

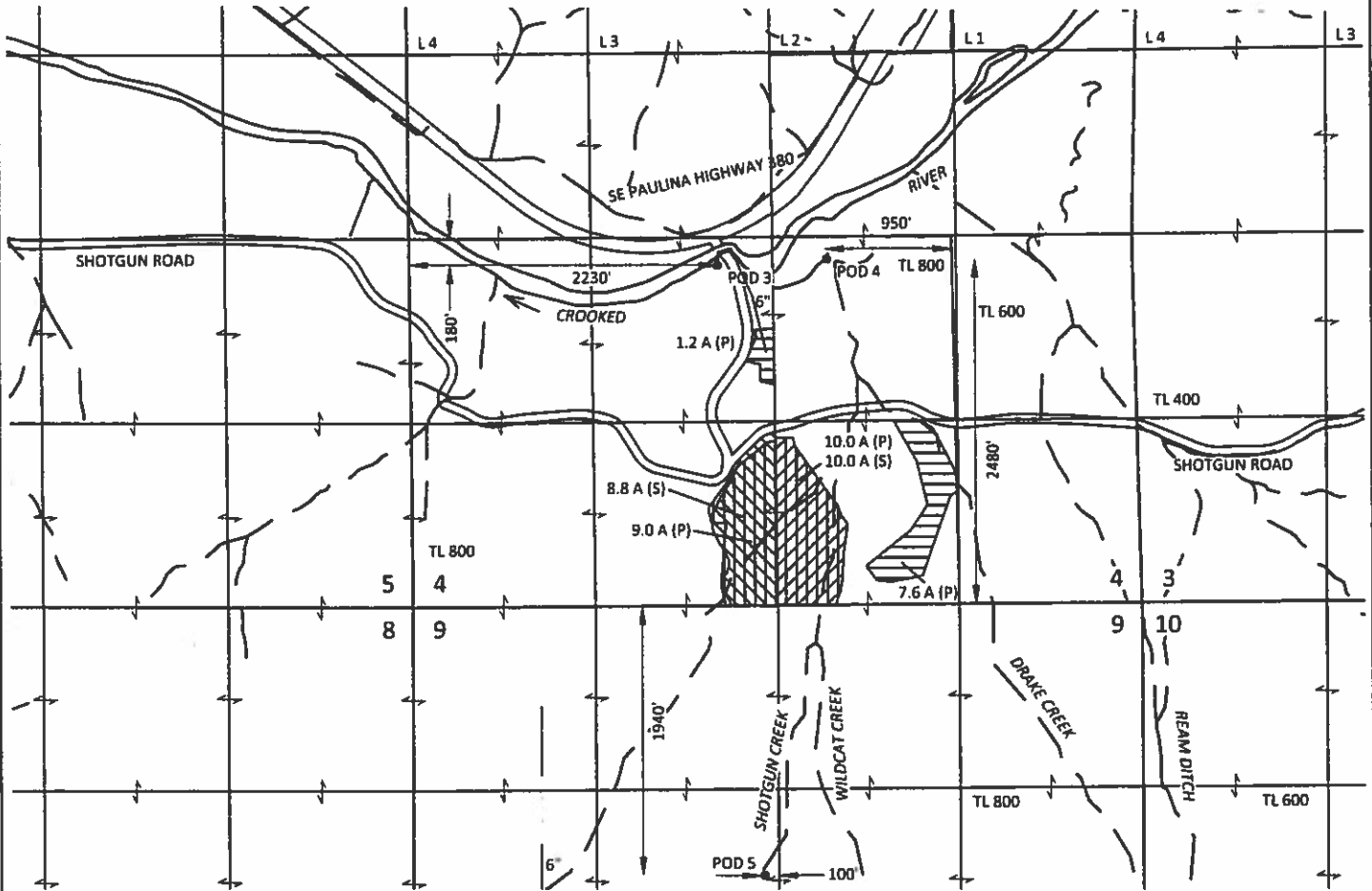



TRANSFER APPLICATION MAP
CROOKED RIVER EAST, LLC

ELK FIELD TRANSFER
FROM LANDS



EXPLANATION

FROM WATER RIGHTS

-  CERTIFICATE 89789
PRIORITY: APRIL 9, 1917
IRRIGATION - 9.0 ACRES (P)
-  CERTIFICATE 89790
PRIORITY: 1889
IRRIGATION - 10.0 ACRES (P)
-  CERTIFICATE 89791
PRIORITY: MAY 23, 1961
IRRIGATION - 8.8 ACRES (P)
-  CERTIFICATE 89791
PRIORITY: MAY 23, 1961
SUPPLEMENTAL IRRIGATION - 18.8 ACRES (S)

- POINT OF DIVERSION (POD)
- (P) PRIMARY ACRES
- (S) SUPPLEMENTAL ACRES

RECEIVED

JUL 26 2018

OWRD



SCALE



1 INCH = 1320 FEET

July 20, 2018

This map is not intended to provide legal
dimensions or locations of property
ownership lines

Figure 1

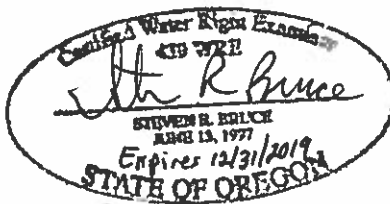

SKOOKUM
WATER ASSOCIATES INC

1626 VICTORIAN WAY
EUGENE, OR 97401
(503) 319-8926

T 12990





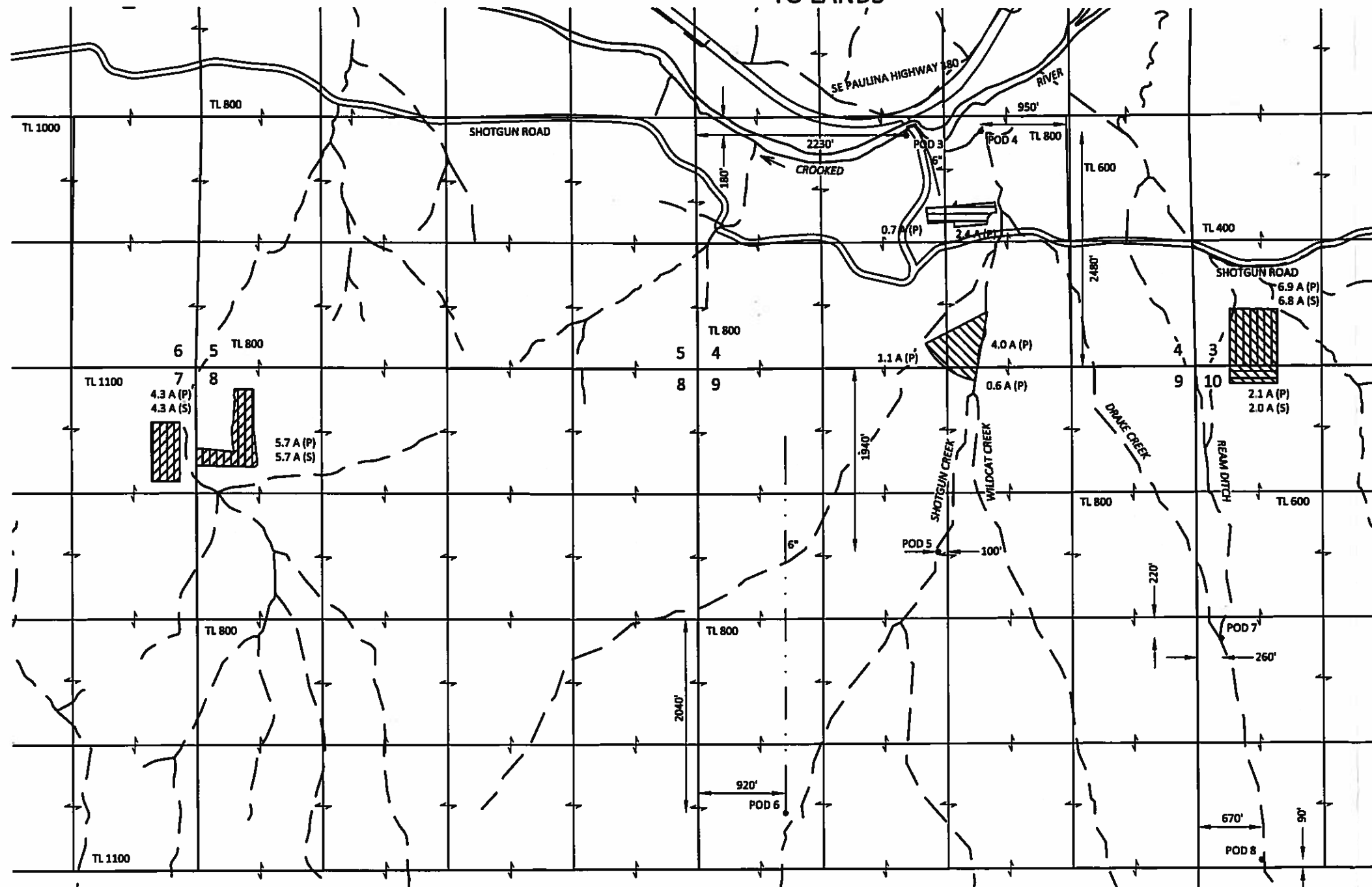

Sections 3, 4, 7, 8, 9, & 10, T17S, R20E, W.M.,
Crook County, Oregon

TRANSFER APPLICATION MAP
CROOKED RIVER EAST, LLC
ELK FIELD TRANSFER
TO LANDS

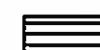

EXPLANATION

TO WATER RIGHTS

-  CERTIFICATE 89789
PRIORITY: APRIL 9, 1917
IRRIGATION - 9.0 ACRES (P)
-  CERTIFICATE 89790
PRIORITY: 1889
IRRIGATION - 10.0 ACRES (P)
-  CERTIFICATE 89791
PRIORITY: MAY 23, 1961
IRRIGATION - 8.8 ACRES (P)
-  CERTIFICATE 89791
PRIORITY: MAY 23, 1961
SUPPLEMENTAL IRRIGATION - 18.8 ACRES (S)
-  POINT OF DIVERSION (POD)
-  PRIMARY ACRES
-  SUPPLEMENTAL ACRES

RECEIVED

JUL 26 2018

OWRD

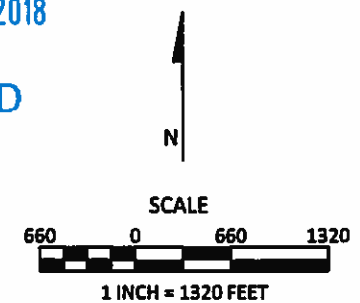

July 20, 2018

This map is not intended to provide legal
dimensions or locations of property
ownership lines

Figure 2
12990

SKOOKUM
WATER ASSOCIATES INC

1626 VICTORIAN WAY
EUGENE, OR 97401
(503) 319-8926

