

# TRANSFER APPLICATION MAP

Certificate 45304  
 Sections 19, 20, 26-36, T17S, R2W, W.M.  
 Sections 10, 14, 15, 21-28, 33-36, T17S, R3W, W.M.  
 Sections 1-12, 14, 15, T18S, R2W, W.M.  
 Sections 1-4, 10-12, T18S, R3W, W.M.  
 City of Springfield, Lane County

## RAINBOW WATER DISTRICT

### INSET MAP

1" = 400'

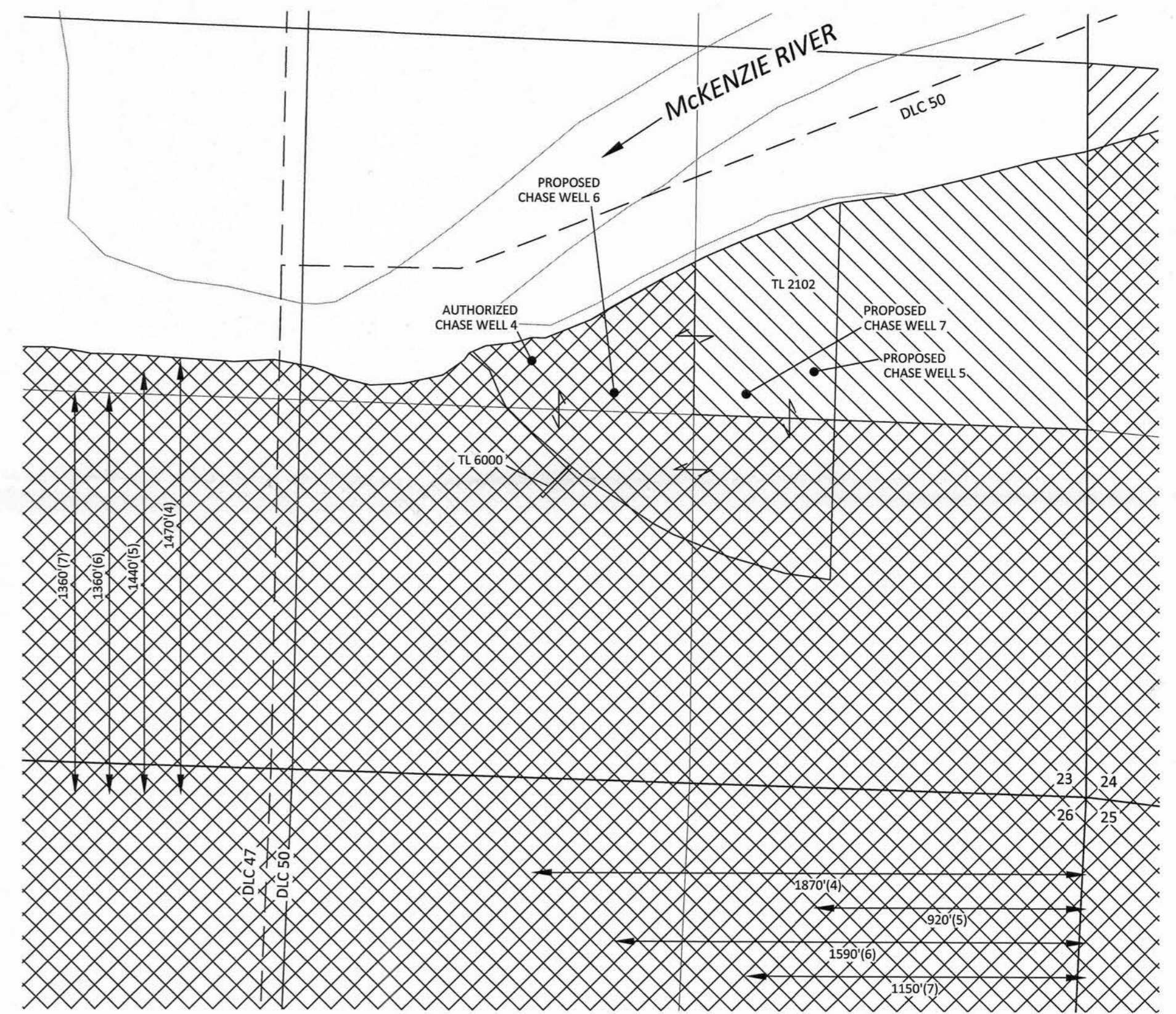
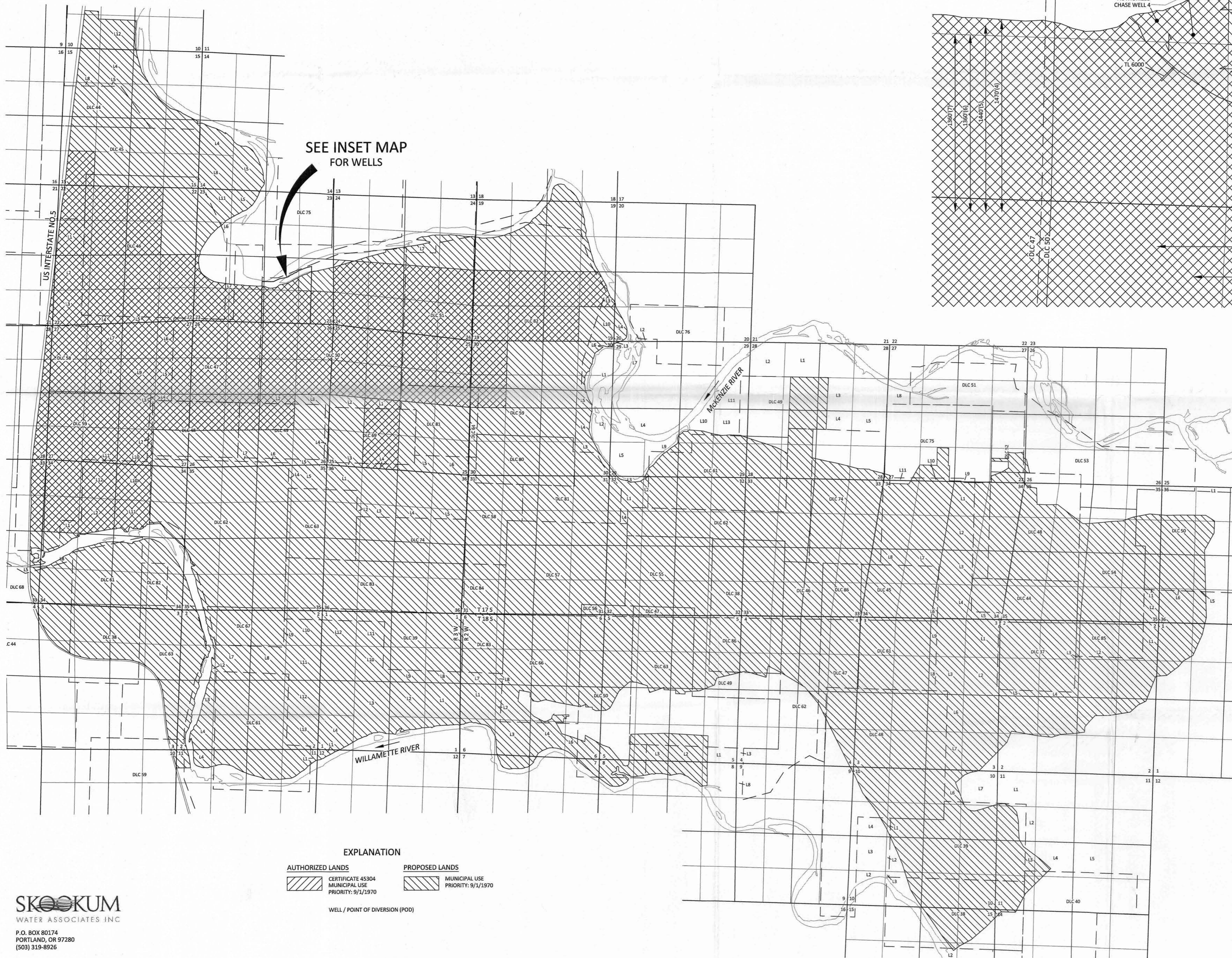

SEE INSET MAP  
FOR WELLS

**EXPLANATION**

AUTHORIZED LANDS		PROPOSED LANDS	
	CERTIFICATE 45304 MUNICIPAL USE PRIORITY: 9/1/1970		MUNICIPAL USE PRIORITY: 9/1/1970

WELL / POINT OF DIVERSION (POD)

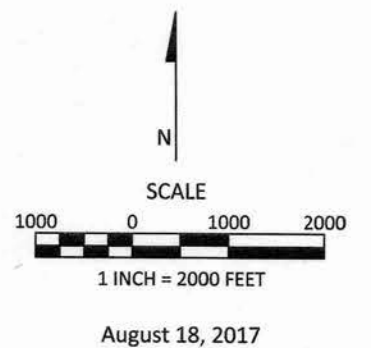

This map is not intended to provide legal dimensions or locations of property ownership lines

FIGURE 1

**SKOOKUM**  
 WATER ASSOCIATES INC  
 P.O. BOX 80174  
 PORTLAND, OR 97280  
 (503) 319-8926

RECEIVED  
 SEP 08 2017  
 T-12738  
 OWRD



# AMENDED TRANSFER APPLICATION MAP

Certificate 45304  
 Transfer T-12738  
 Sections 19, 20, 26-36, T17S, R2W, W.M.  
 Sections 10, 14, 15, 21-28, 33-36, T17S, R3W, W.M.  
 Sections 1-12, 14, 15, T18S, R2W, W.M.  
 Sections 1-4, 10-12, T18S, R3W, W.M.  
 City of Springfield, Lane County

## RAINBOW WATER DISTRICT

AMENDED  
 T-12738

INSET MAP  
 1" = 400'

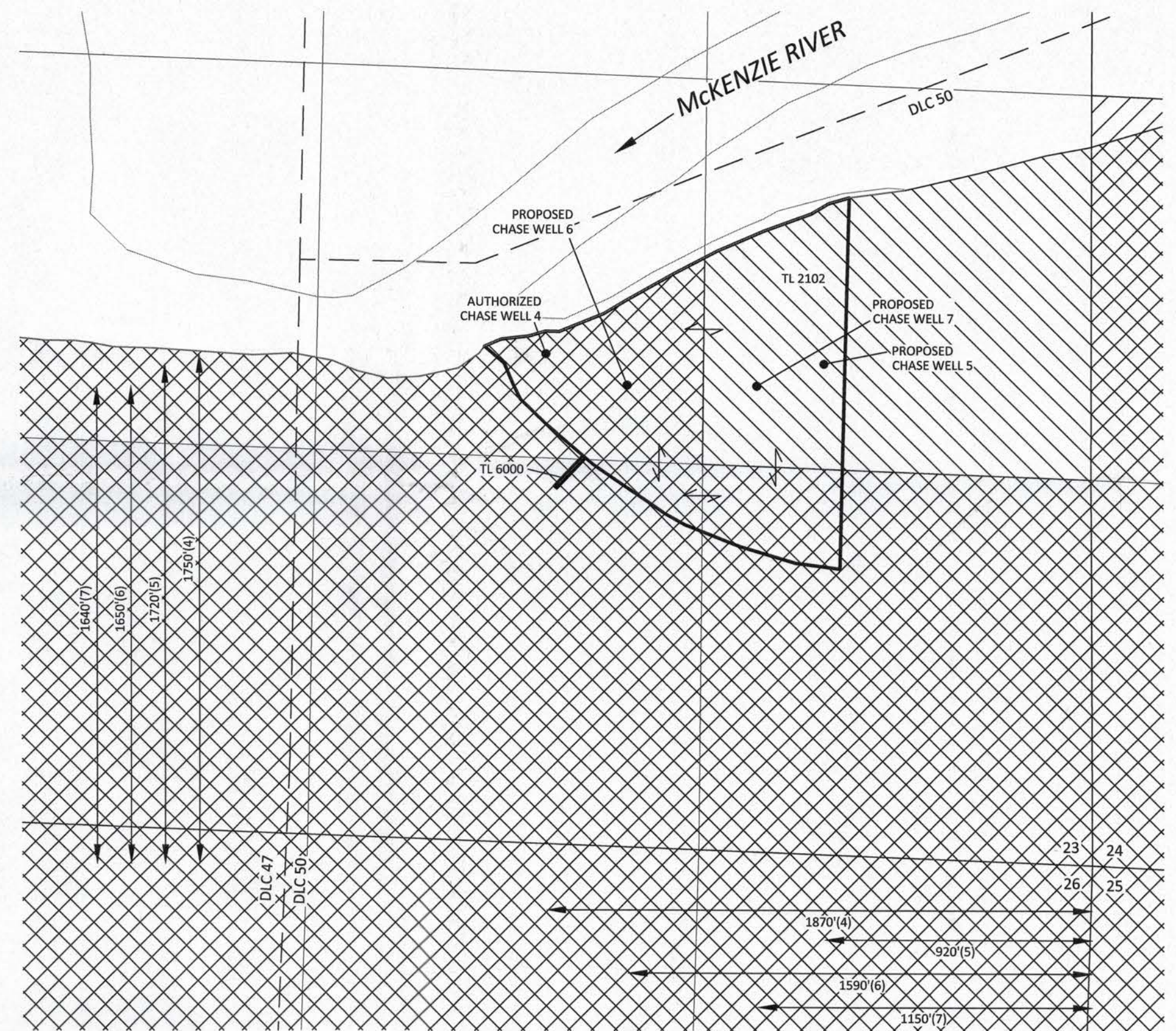
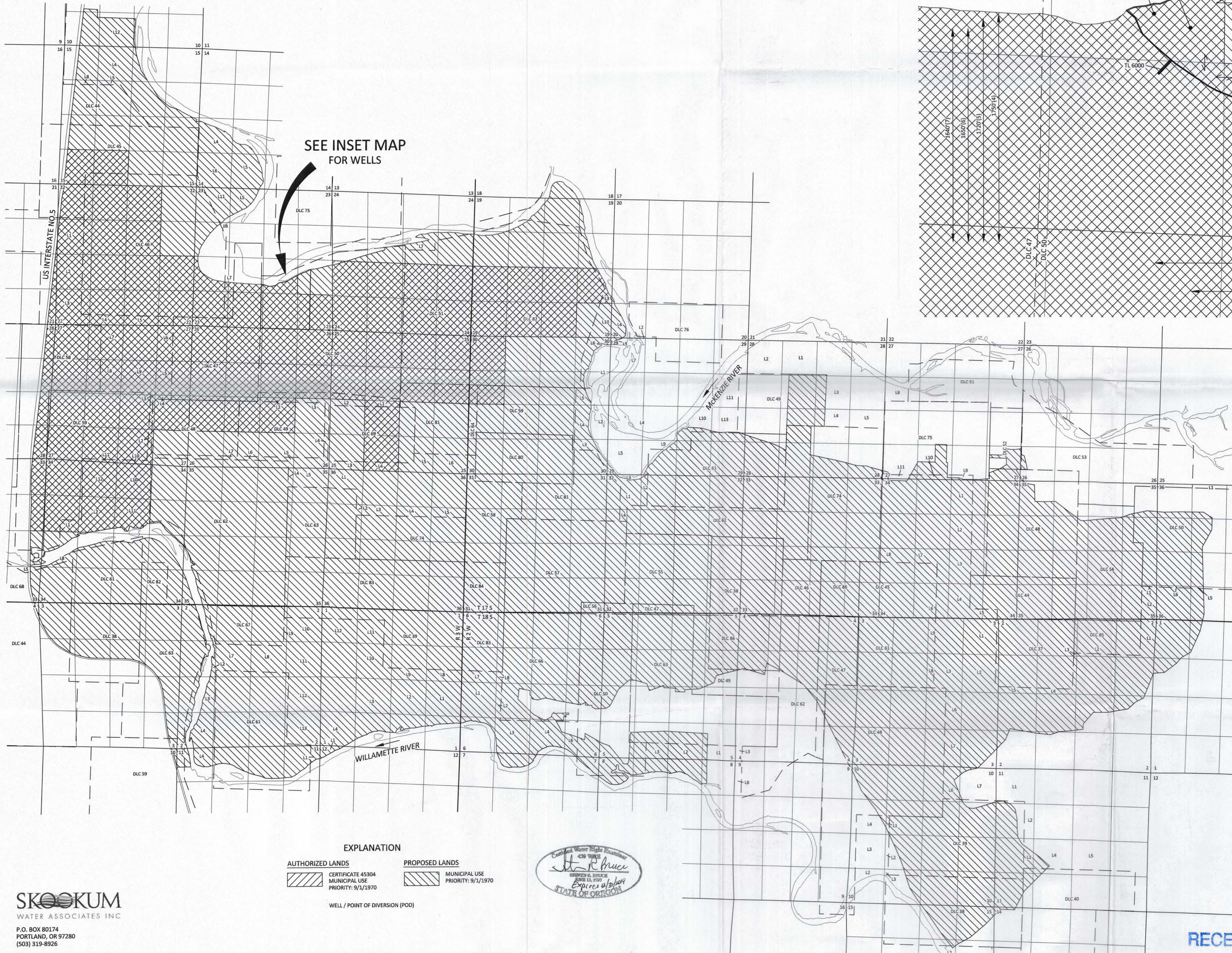

SEE INSET MAP  
 FOR WELLS

**EXPLANATION**

AUTHORIZED LANDS	PROPOSED LANDS
CERTIFICATE 45304 MUNICIPAL USE PRIORITY: 9/1/1970	MUNICIPAL USE PRIORITY: 9/1/1970

WELL / POINT OF DIVERSION (POD)

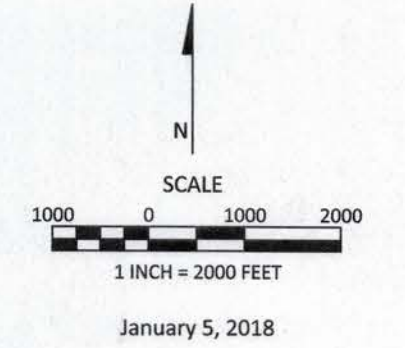

This map is not intended to provide legal dimensions or locations of property ownership lines

FIGURE 1

**SKOOKUM**  
 WATER ASSOCIATES INC.  
 P.O. BOX 80174  
 PORTLAND, OR 97280  
 (503) 519-8926

RECEIVED  
 JAN 11 2018  
 OWRD