

**Application for a
Water Right Transfer
in the Name of City of Amity
Existing Place of Use Map
Certificate 61988**

Township 5 South, Range 4 & 5 West (W.M.)

LEGEND

- Authorized POD
- Proposed APOD
- Pipeline
- Place of Use (POU)
- Donation Land Claim (DLC)
- Government Lot (GL)
- City of Amity
- City of Amity Service Area
- Major Road
- Watercourse
- Waterbody

**RECEIVED
FEB 11 2019
OWRD**

Certified Water Rights Examiner Stamp

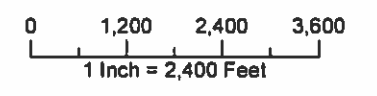
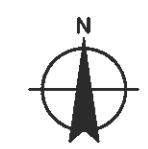
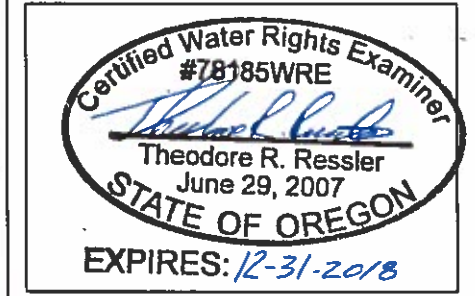

Date: December 8, 2017
Data Sources: Data Sources: BLM, OWRD, ESRI,
Yamhill CO, USGS



Application for a Water Right Transfer in the Name of City of Amity Proposed Additional Point of Diversion Map

Certificate 61988

Township 5 South, Range 5 West (W.M.)

RECEIVED

FEB 11 2019

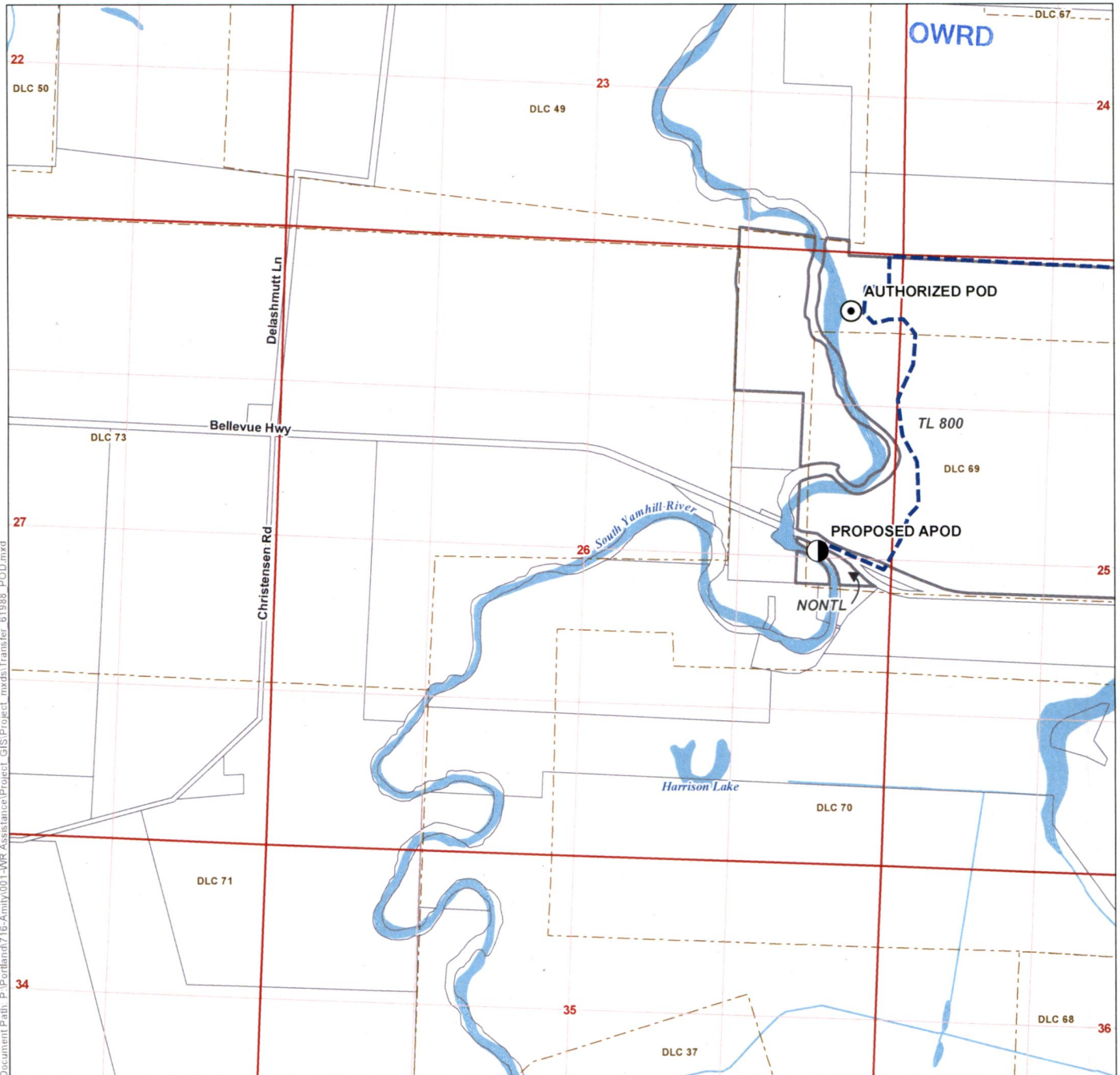

LEGEND

- Authorized POD
- Proposed APOD
- Pipeline
- Tax Lot
- Donation Land Claim (DLC)
- Watercourse
- Waterbody

POD LOCATION DESCRIPTION

Authorized Point of Diversion
Located 515 feet South and 425 feet West from the NE corner of Section 26, Township 5 South, Range 5 West (W.M.)

Proposed Point of Diversion
Located 2,560 feet South and 650 feet West from the NE corner of Section 26, Township 5 South, Range 5 West (W.M.)

Certified Water Rights Examiner Stamp

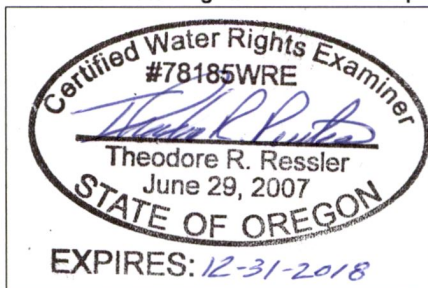

DISCLAIMER

This map was prepared for the purpose of identifying the location of a water right only and it is not intended to provide legal dimensions or location of property ownership lines.

MAP NOTES

Date: January 9, 2018
Data Sources: BLM, OWRD, ESRI, Yamhill CO., USGS

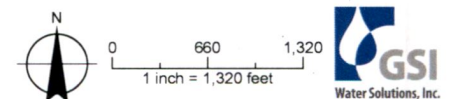

13121

Application for a Water Right Transfer in the Name of City of Amity Proposed Additional Point of Diversion Map

RECEIVED

Certificate 61988

FEB 11 2019

Township 5 South, Range 5 West (W.M.)

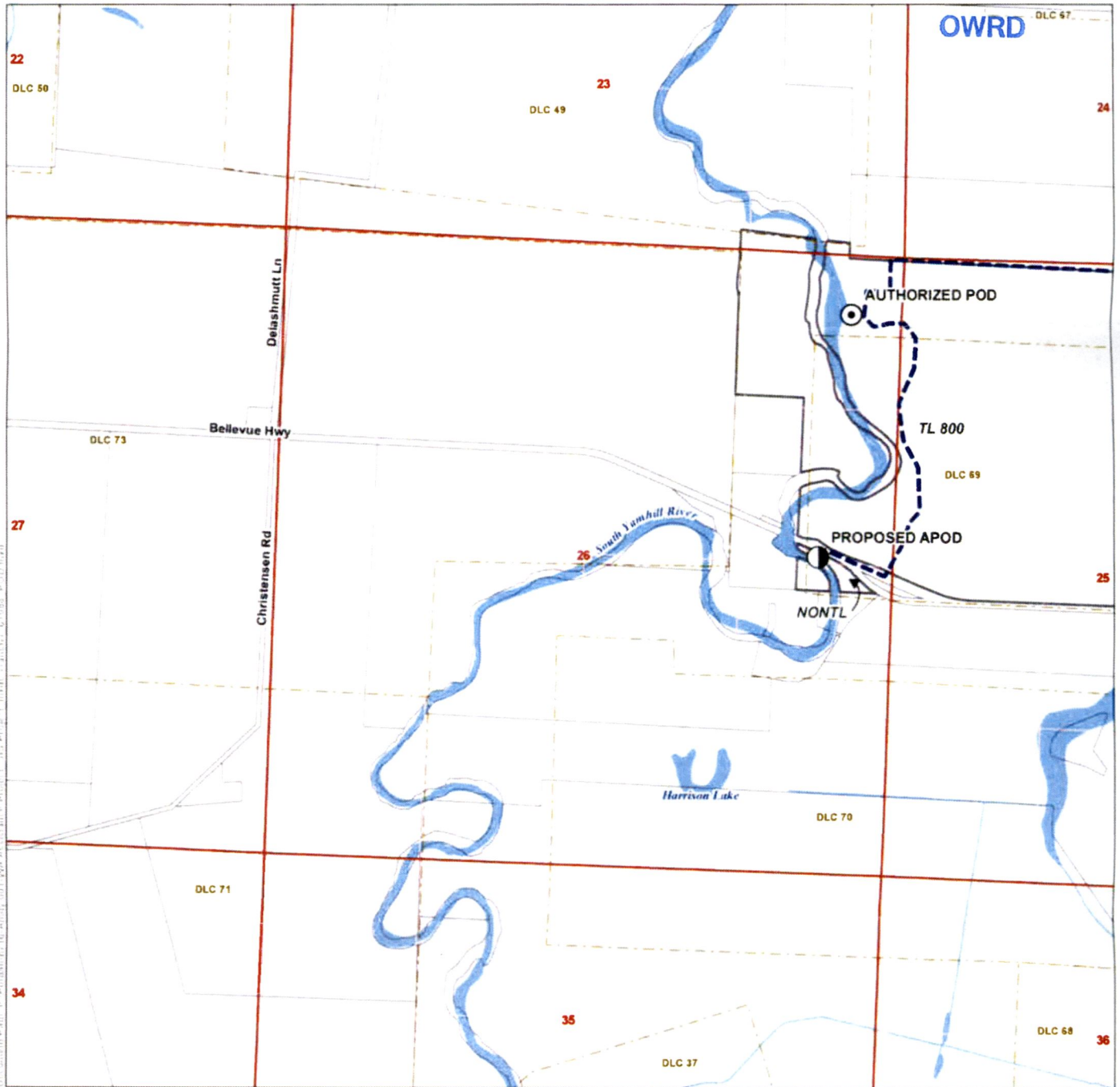

OWRD DLC 67

LEGEND

- Authorized POD
- Proposed APOD
- Pipeline
- Tax Lot
- Donation Land Claim (DLC)
- Watercourse
- Waterbody

Certified Water Rights Examiner Stamp

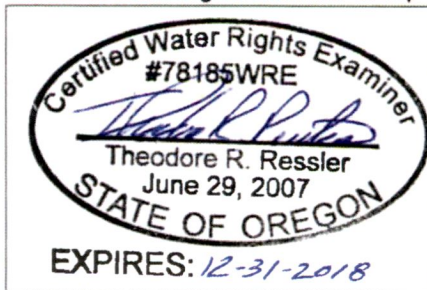

DISCLAIMER

This map was prepared for the purpose of identifying the location of a water right only and it is not intended to provide legal dimensions or location of property ownership lines

MAP NOTES

Date: January 9, 2018
Data Sources: BLM, OWRD, ESRI, Yamhill CO, USGS

POD LOCATION DESCRIPTION

Authorized Point of Diversion
Located 515 feet South and 425 feet West from the NE corner of Section 26, Township 5 South, Range 5 West (W.M.)

Proposed Point of Diversion
Located 2,560 feet South and 650 feet West from the NE corner of Section 26, Township 5 South, Range 5 West (W.M.)

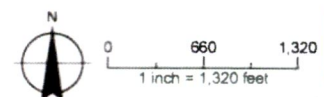

13121