

Application for a Groundwater Registration Modification in the Name of City of Milwaukie

Groundwater Registration 1478, Point of Appropriation Map Township 1 South, Range 1 East (W.M.)

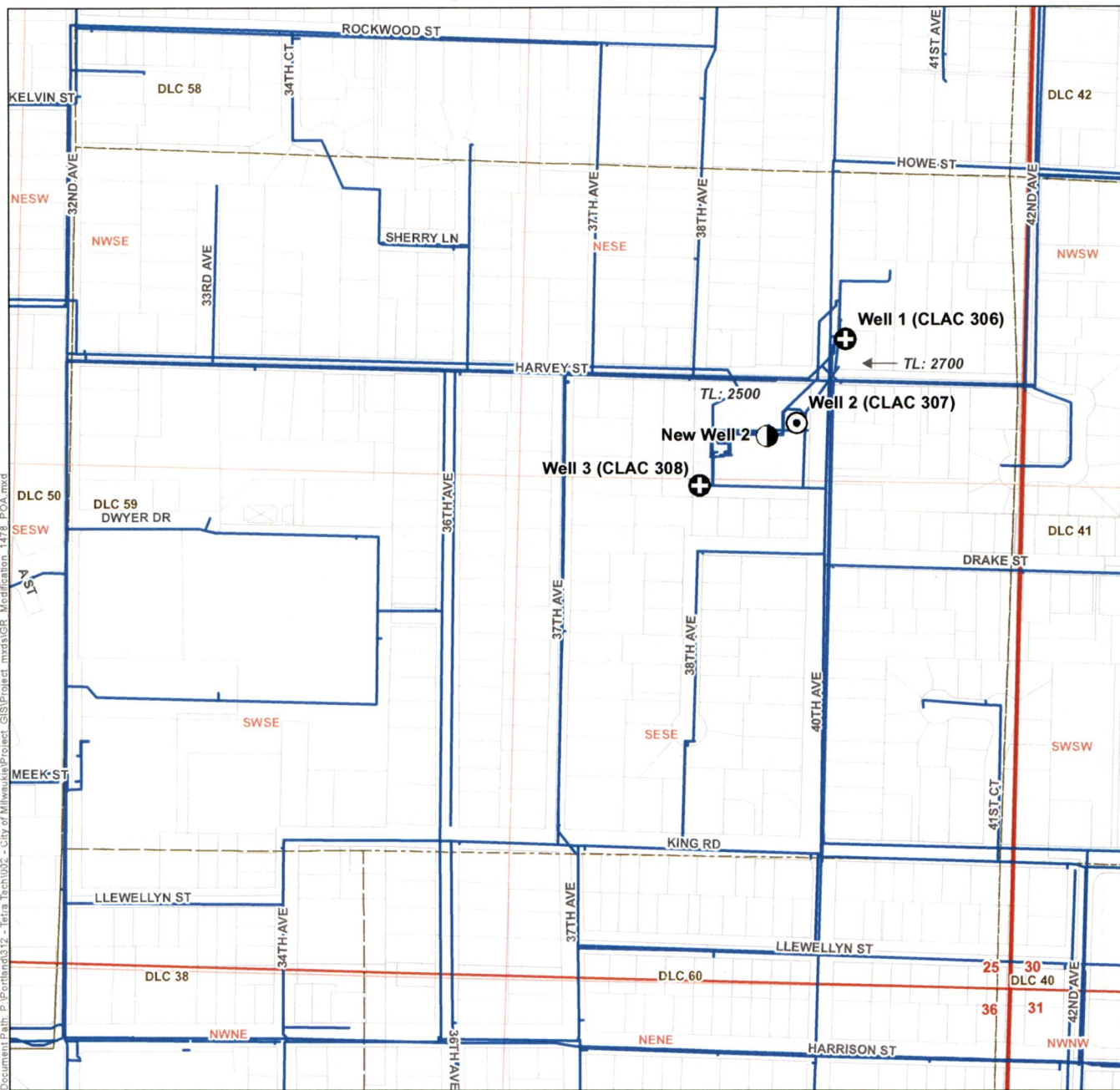

LEGEND

- Authorized Point of Appropriation (POA)
- Additional Point of Appropriation (POA)
- Proposed Point of Appropriation (POA)
- Major Water Delivery System

All Other Features

- Tax Lot
- Donation Land Claim (DLC)
- Government Lot (GL)

DISCLAIMER

This map was prepared for the purpose of identifying the location of a water right only and it is not intended to provide legal dimensions or location of property ownership lines.

The POA location description provided in GR-1478 is not consistent with the associated GR map. The applicant has provided a location description of the actual and historical location of the authorized POA for GR-1478.

LOCATION DESCRIPTION

Well 1
Located 1,670 feet North and 470 feet West from the SE corner of Section 25, Township 1 South, Range 1 East (W.M.)

Well 2
Located 1,445 feet North and 580 feet West from the SE corner of Section 25, Township 1 South, Range 1 East (W.M.)

Well 3
Located 1,280 feet North and 840 feet West from the SE corner of Section 25, Township 1 South, Range 1 East (W.M.)

New Well 2
Located 1,420 feet North and 665 feet West from the SE corner of Section 25, Township 1 South, Range 1 East (W.M.)

MAP NOTES

Date: June 4, 2018
Data Sources: BLM, ESRI, USGS, METRO

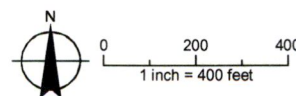

13143

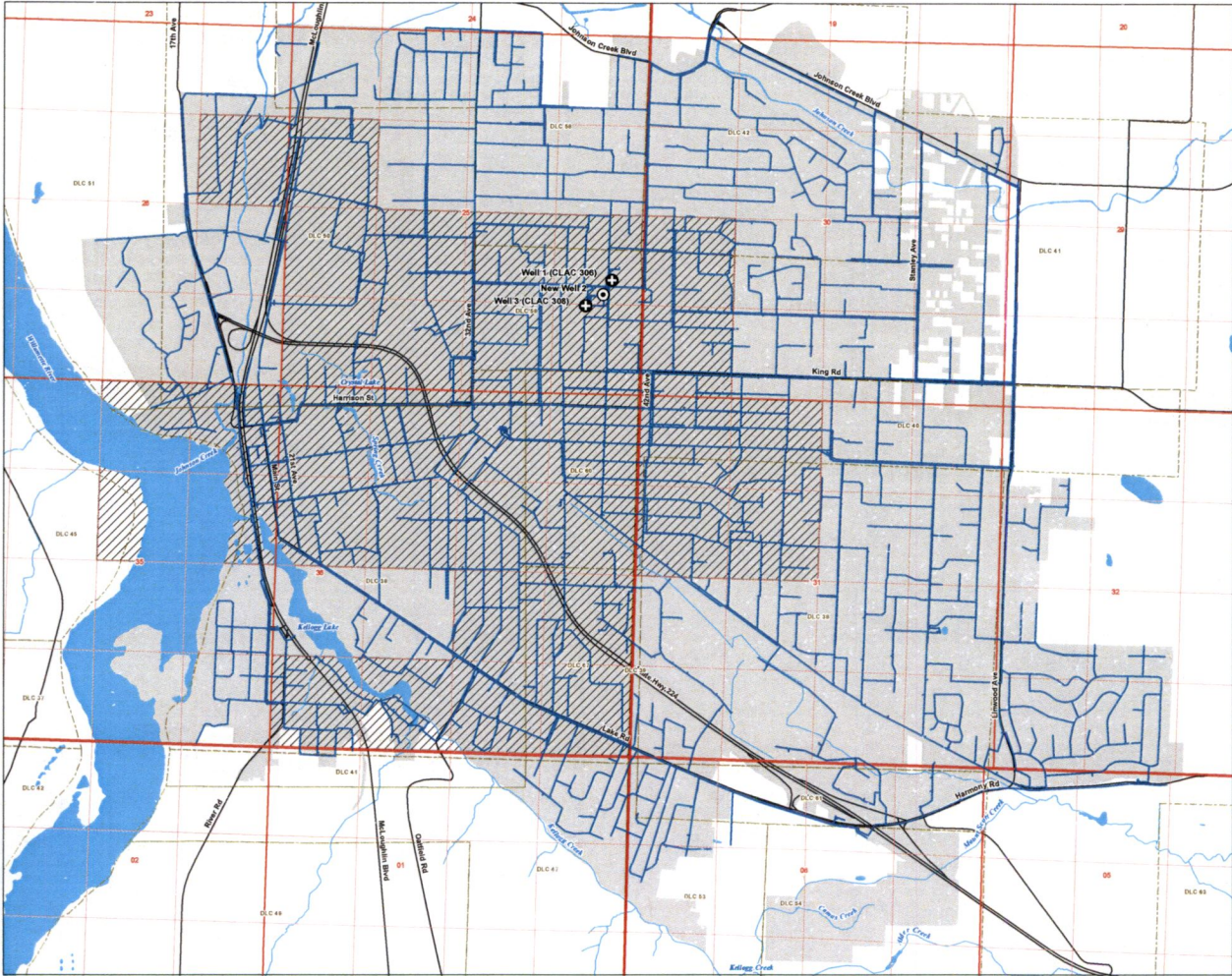

**Application for
Groundwater Registration
Modification
in the Name of City of Milwaukie
Groundwater Registration 1478
Place of Use Map**
Township 1 South, Range 1 East (W.M.)

- LEGEND**
- ⊙ Authorized Point of Appropriation (POA)
 - ⊕ Additional Point of Appropriation (POA)
 - ▨ Existing Place of Use (POU)
 - ▨ Proposed Place of Use, City Service Area
 - Major Water Delivery System
 - Donation Land Claim (DLC)
 - Government Lot (GL)
 - Major Road
 - ~ Watercourse
 - Waterbody

N
0 660 1,320 1,980
1 inch = 1,320 feet

Date: January 10, 2019
Data Sources: BLM, ESRI, USGS, METRO

RECEIVED
MAR 11 2019
OWRD

Application for a Groundwater Registration Modification in the Name of City of Milwaukie

Groundwater Registration 1478, Point of Appropriation Map

Township 1 South, Range 1 East (W.M.)

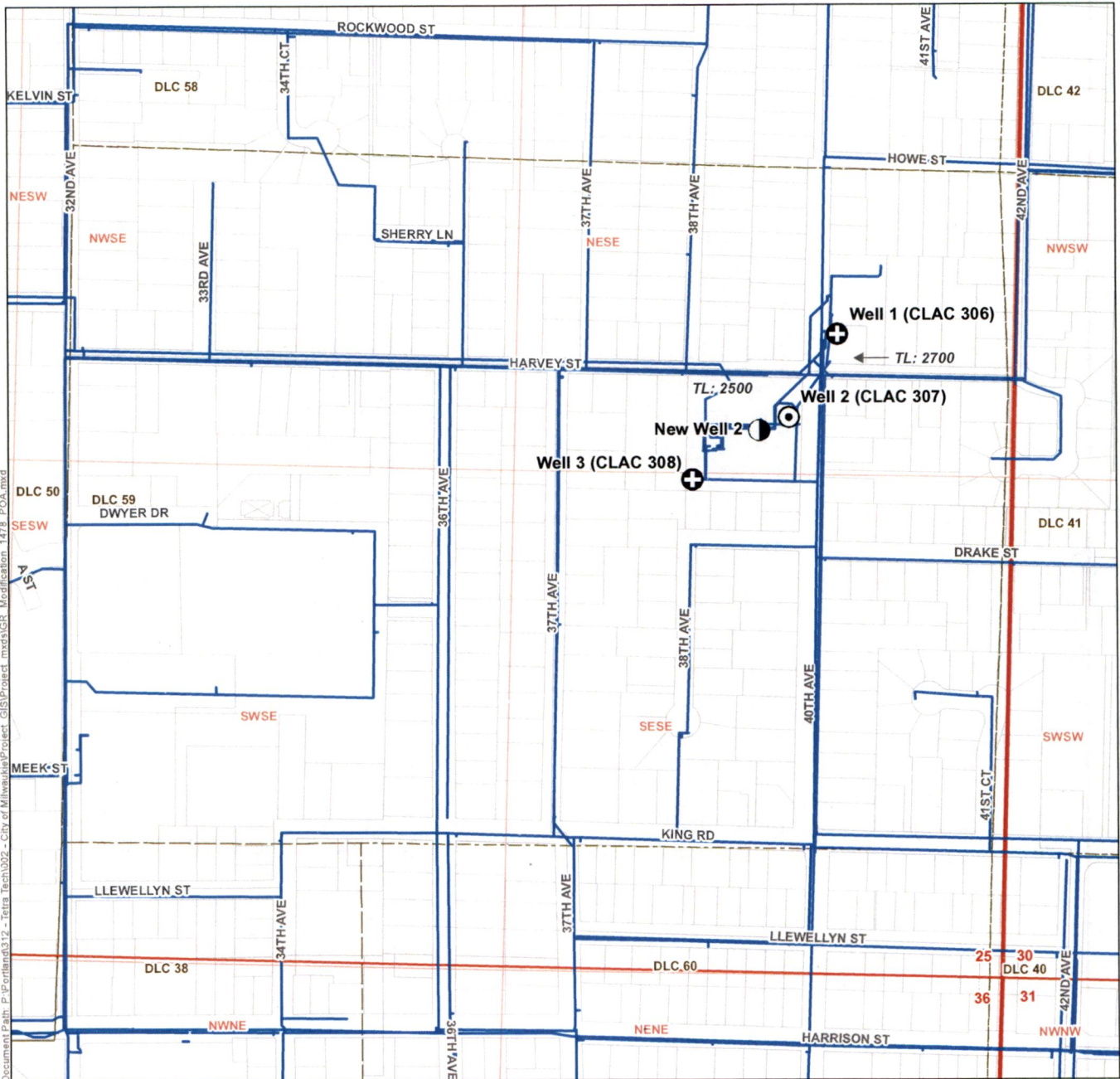

Document Path: P:\P\crd\and\312 - Tetra Tech\02 - City of Milwaukie\Project_GIS\Project_mxd\IGR_Modification_1478_POA.mxd

LEGEND

- Authorized Point of Appropriation (POA)
- Additional Point of Appropriation (POA)
- Proposed Point of Appropriation (POA)
- Major Water Delivery System

All Other Features

- Tax Lot
- Donation Land Claim (DLC)
- Government Lot (GL)

DISCLAIMER

This map was prepared for the purpose of identifying the location of a water right only and it is not intended to provide legal dimensions or location of property ownership lines.

The POA location description provided in GR-1478 is not consistent with the associated GR map. The applicant has provided a location description of the actual and historical location of the authorized POA for GR-1478.

LOCATION DESCRIPTION

Well 1
Located 1,670 feet North and 470 feet West from the SE corner of Section 25, Township 1 South, Range 1 East (W.M.)

Well 2
Located 1,445 feet North and 580 feet West from the SE corner of Section 25, Township 1 South, Range 1 East (W.M.)

Well 3
Located 1,280 feet North and 840 feet West from the SE corner of Section 25, Township 1 South, Range 1 East (W.M.)

New Well 2
Located 1,420 feet North and 665 feet West from the SE corner of Section 25, Township 1 South, Range 1 East (W.M.)

MAP NOTES

Date: June 4, 2018

Data Sources: BLM, ESRI, USGS, METRO

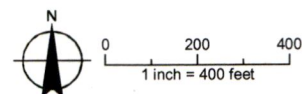

13143

**Application for
Groundwater Registration
Modification
in the Name of City of Milwaukee
Groundwater Registration 1478
Place of Use Map**
Township 1 South, Range 1 East (W.M.)

LEGEND

- ⊙ Authorized Point of Appropriation (POA)
- ⊕ Additional Point of Appropriation (POA)
- ▨ Existing Place of Use (POU)
- ▭ Proposed Place of Use, City Service Area
- Major Water Delivery System
- ▭ Donation Land Claim (DLC)
- ▭ Government Lot (GL)
- Major Road
- Watercourse
- Waterbody

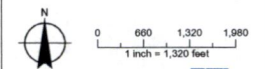

Date: January 10, 2019
Data Source: BLM, ESR, USGS, METRO

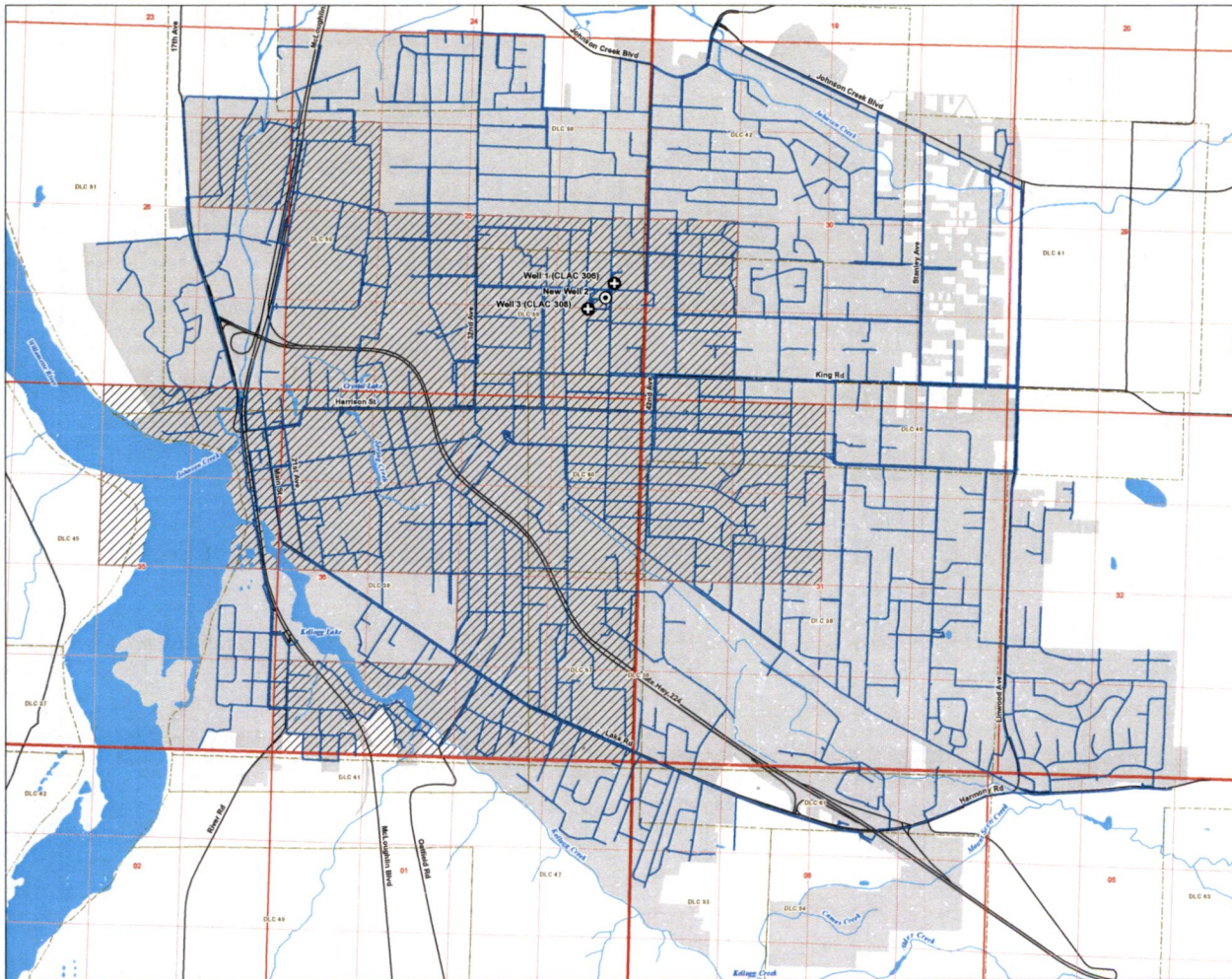

RECEIVED

MAR 11 2019

OWRD