

Section 19, T39S, R2E, W.M.,  
Jackson County, Oregon

TRANSFER APPLICATION MAP  
Certificates 54029 & 54030  
Tabula Rasa LLC

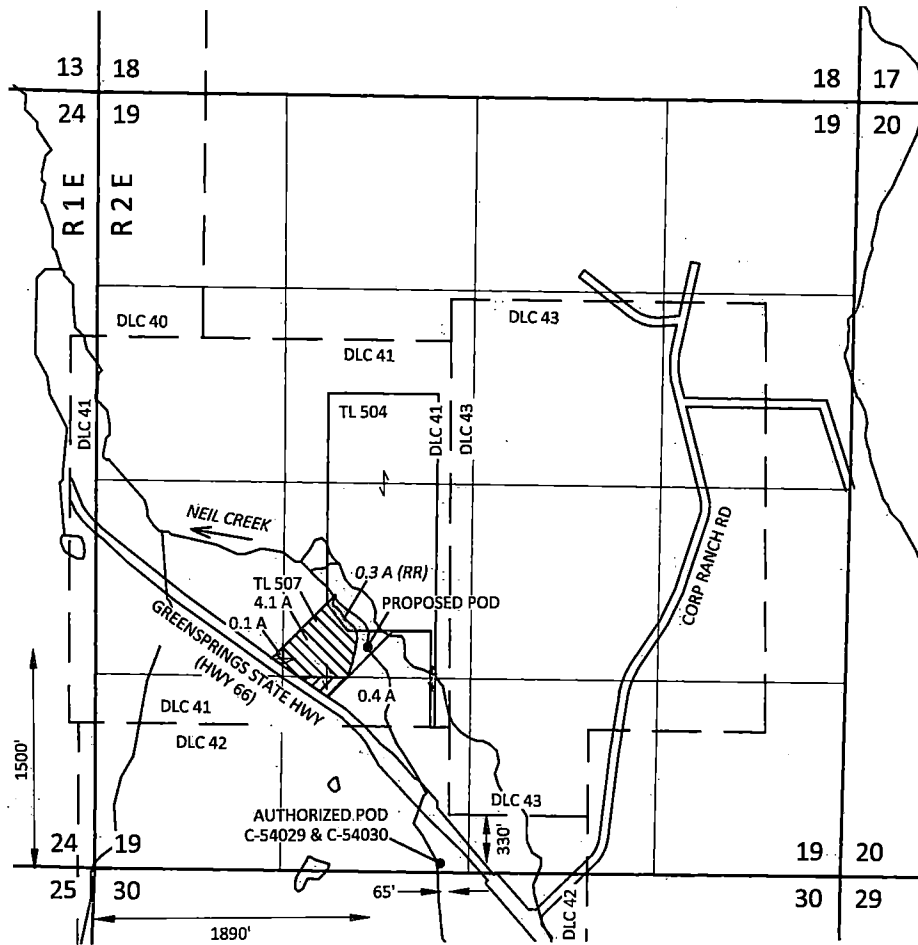

RECEIVED

JUN 11 2018

OWRD

EXPLANATION

**REMAINING RIGHT (RR)**  
 CERTIFICATE 54029  
 PRIORITY: 1854  
 0.3 ACRES

**ADDITIONAL POD**  
 CERTIFICATE 54029  
 PRIORITY: 1854  
 4.2 ACRES

 CERTIFICATE 54030  
 PRIORITY: 1854  
 0.4 ACRES

● POINT OF DIVERSION (POD)



SCALE



1 INCH = 1320 FEET

June 1, 2018

**SKOOKUM**  
WATER ASSOCIATES INC

1626 VICTORIAN WAY  
EUGENE, OR 97401  
(503) 319-8926

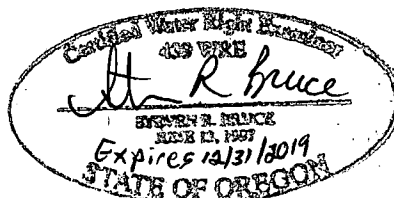

This map is not intended to provide legal dimensions or locations of property ownership lines

Figure 1