

T.10S. R.3W. Section 18 , W.M.

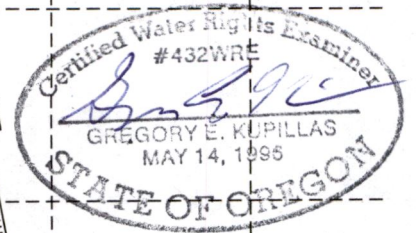

EXPIRATION DATE: 6/30/2019

RECEIVED
MAY 31 2019
OWRD

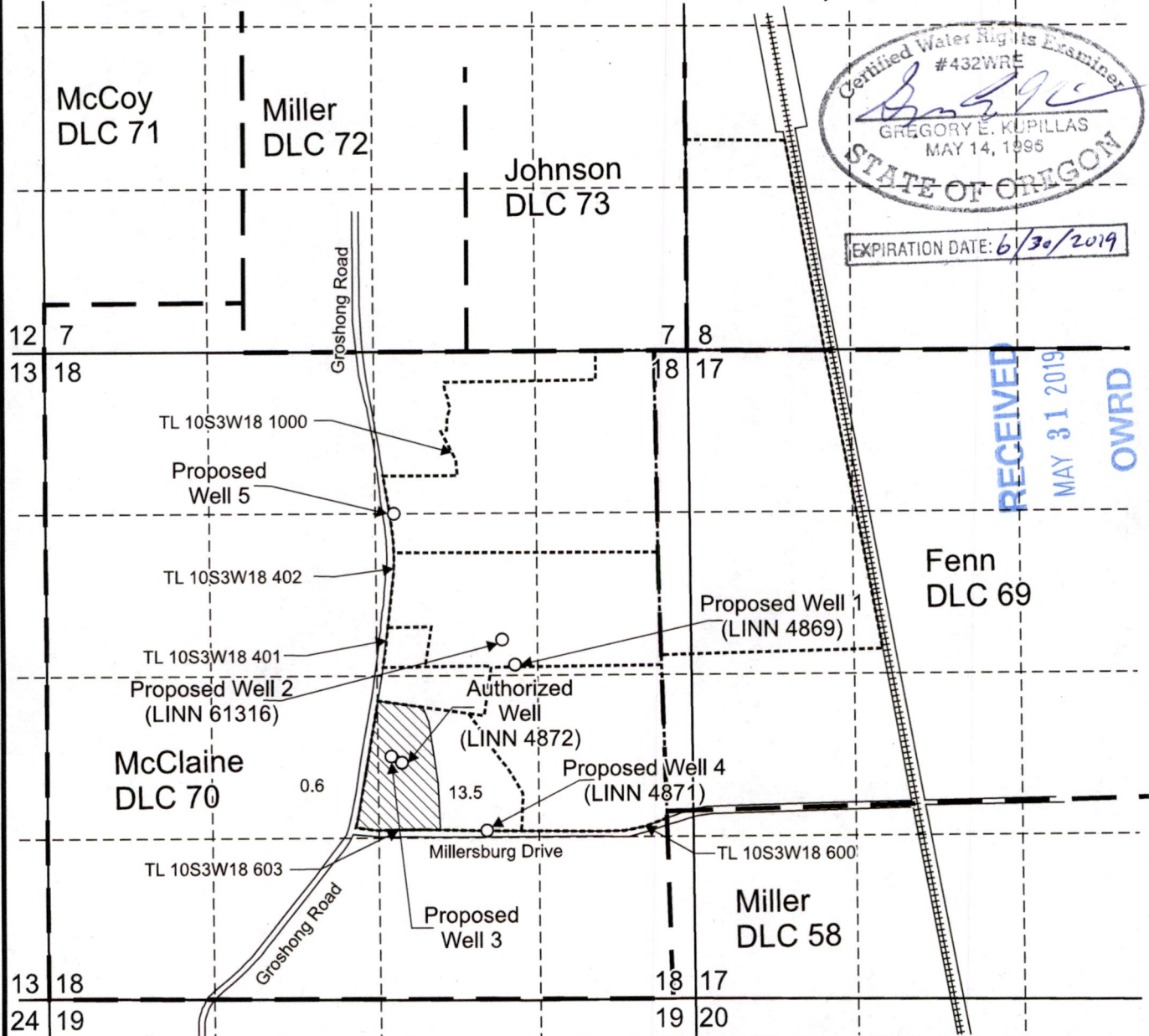

Authorized Well 1 (LINN 4872) is located 5° north 30' east, 29.5 chains from the SW corner of SE 1/4, Section 18.
 Proposed Well 1 (LINN 4869) is located 2,550 feet south and 1,440 feet west from the NE corner, Section 18.
 Proposed Well 2 (LINN 61316) is located 2,345 feet south and 1,530 feet west from the NE corner, Section 18.
 Proposed Well 3 is located 1,980 feet north and 2,485 feet west from the SE corner, Section 18.
 Proposed Well 4 (LINN 4871) is located 1,375 feet north and 1,700 feet west from the SE corner, Section 18.
 Proposed Well 5 is located 1,320 feet south and 2,420 feet west from the NE corner, Section 18.

Area (14.1 acres) irrigated under GR-1732 priority date 10-31-1954, affected by this modification.
 - - - Tax lot boundary — Donation Land Claim boundary Mainlines are portable

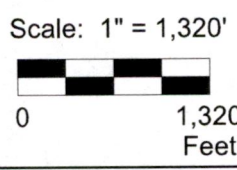

This map was prepared for the purpose of identifying the location of a water right only and is not intended to provide legal dimensions or location of property ownership lines.

Groundwater Registration Modification Map
GR-1732

Pacific Hydro-Geology Inc.

Mayfield Farms LLC c/o Chuck Eggert
T.10S. R.3W. Section 18, W.M.

12/2018

Pacific Foods/VFGR1732GRModMap.cdr