

T.3S. & 4S., R.2W., W.M.13201

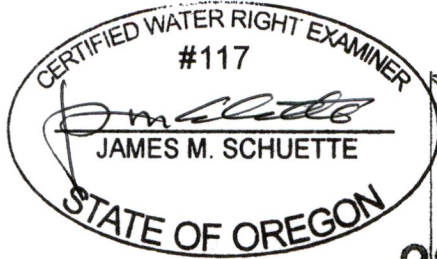

EXPIRES: 6/30/2020

1" = 1320'

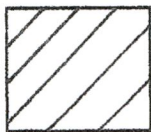

Primary



Supplemental

Acres Irrigated
(Cert. 89298)

RECEIVED

JUN 07 2019

OWRD

Application Map

Hazenberg Dairy

Transfer #:

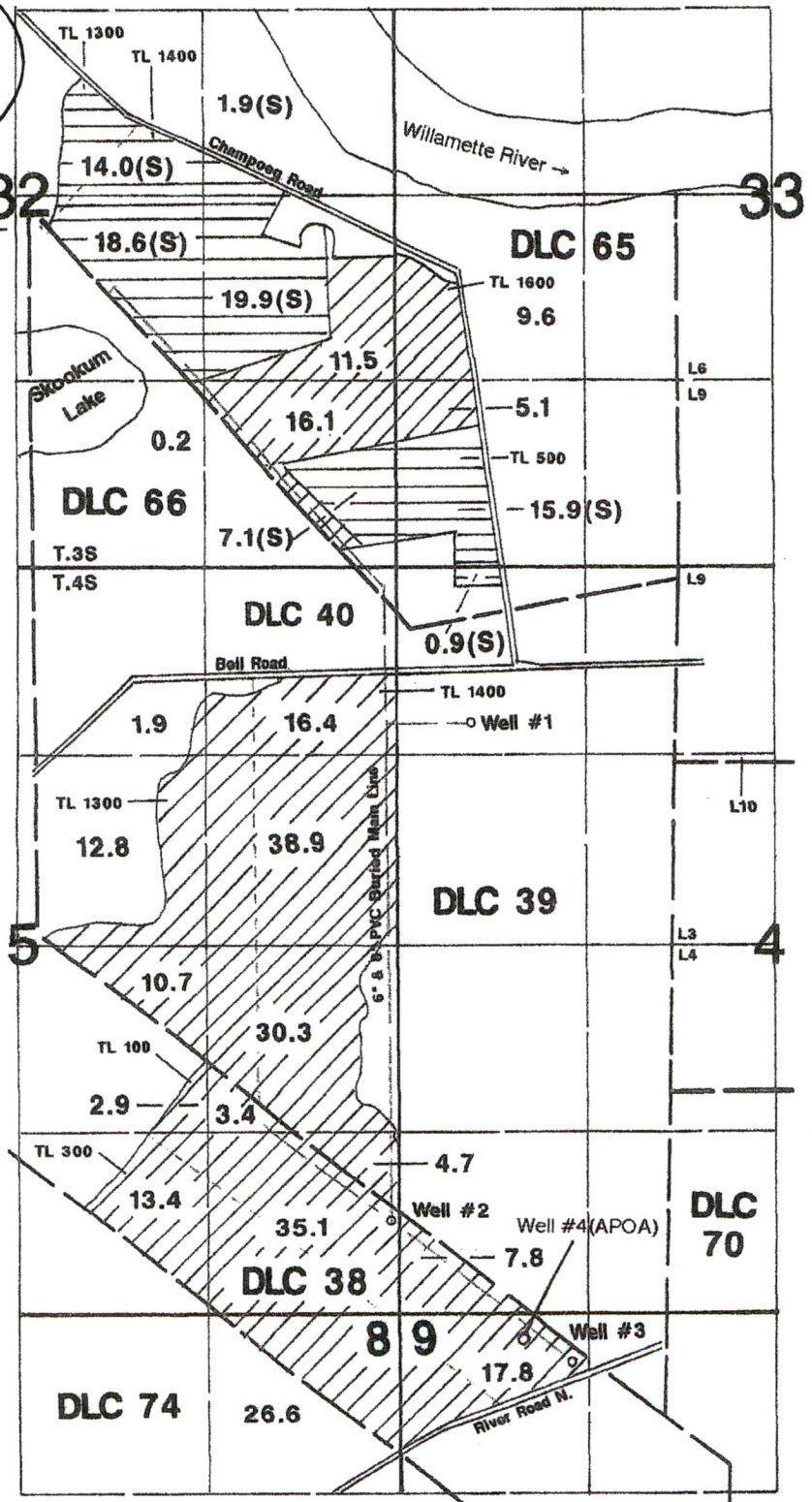

Well #1 is located 1070'S & 520'E from NW corner Section 4. Well #2 is located 660'N & 50'W from SE corner Section 5. Well #3 is located 330'S & 1220'E from NW corner Section 9. Well #4 (APOA) is located 170'S & 870'E from NW corner Section 9.

This Map was Prepared for the Purpose of Identifying the Location of a Water Right Only and is Not Intended to Provide Legal Dimensions or Location of Property Ownership Lines.