

T.8S., R.3W., W.M.

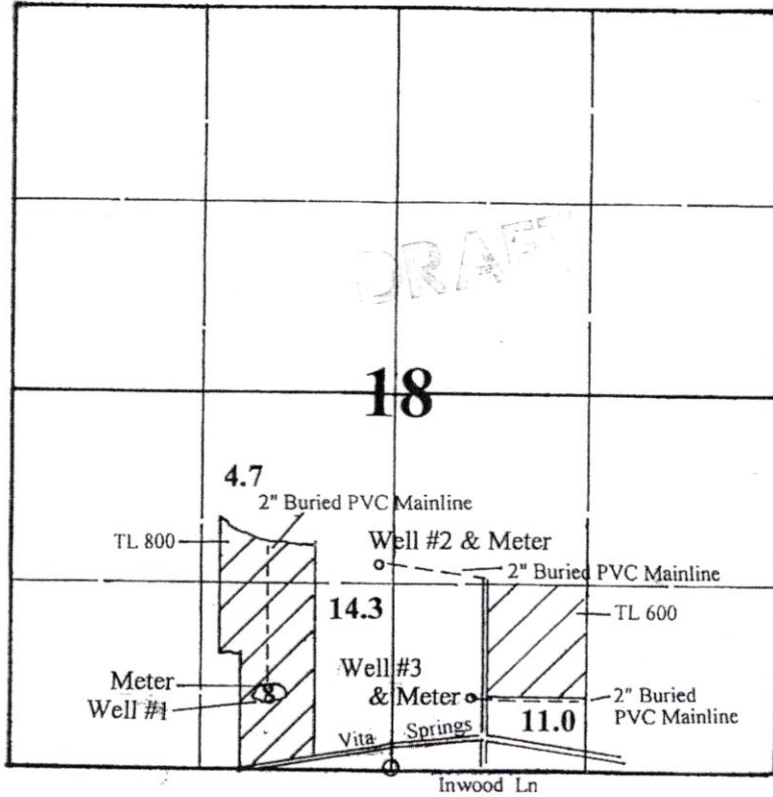

RECEIVED
SEP 12 2019
OWRD

Well #1 is located 525' N & 820' W;
Well #2 is located 1430' N & 75' W;
Well #3 is located 535' N & 550' E; all from the S 1/4 corner of Section 18.

Final Proof Survey

In the Name of

Earl J. Van Volkinburg

Application#: G-12961 Permit #: G-17487

Surveyed on November 2, 2015 by JM Schuette

This Map was Prepared for the Purpose of Identifying the Location of a Water Right Only and is Not Intended to Provide Legal Dimensions or Location of Property Ownership Lines.

- 13256

T8S, R3W, S18 SE & SW
Permit # G-17487
Earl Van Volkinburg

Wells from S 1/4 Corner of Section 18
Well 1 is located 525'N & 820'W
Well 2 is located 1450'N & 175'W

RECEIVED

SEP 12 2019

OWRD

1" = 1320'
N ↑

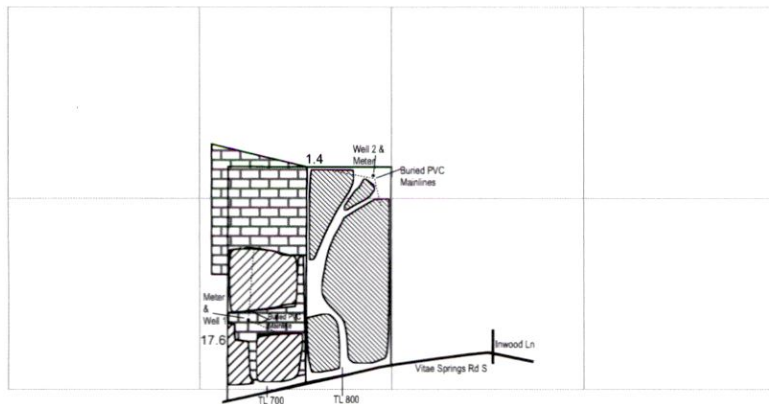
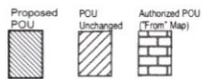

13256

RECEIVED
SEP 12 2019
OWRD

T8S, R3W, S18 SE & SW
Permit # G-17487
Earl Van Volkinburg

Wells from S 1/4 Corner of Section 18
Well 1 is located 525'N & 820'W
Well 2 is located 1450'N & 175'W

1" = 1320'
N ↑

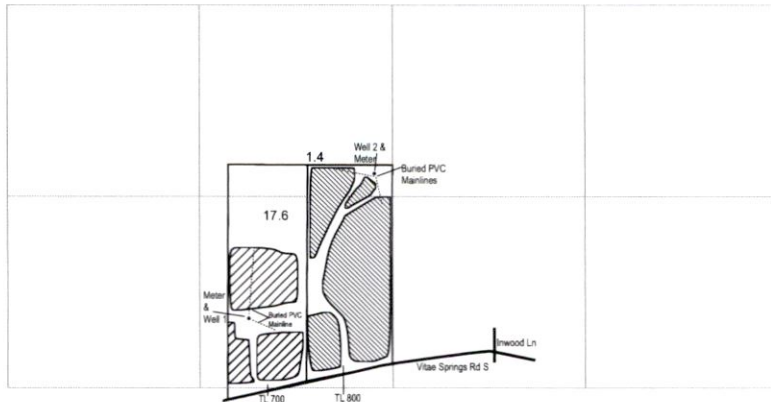
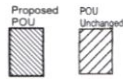

13256