

Transfer Map for A. Obrist

Proposed POD located at
45.47022, -122.49364

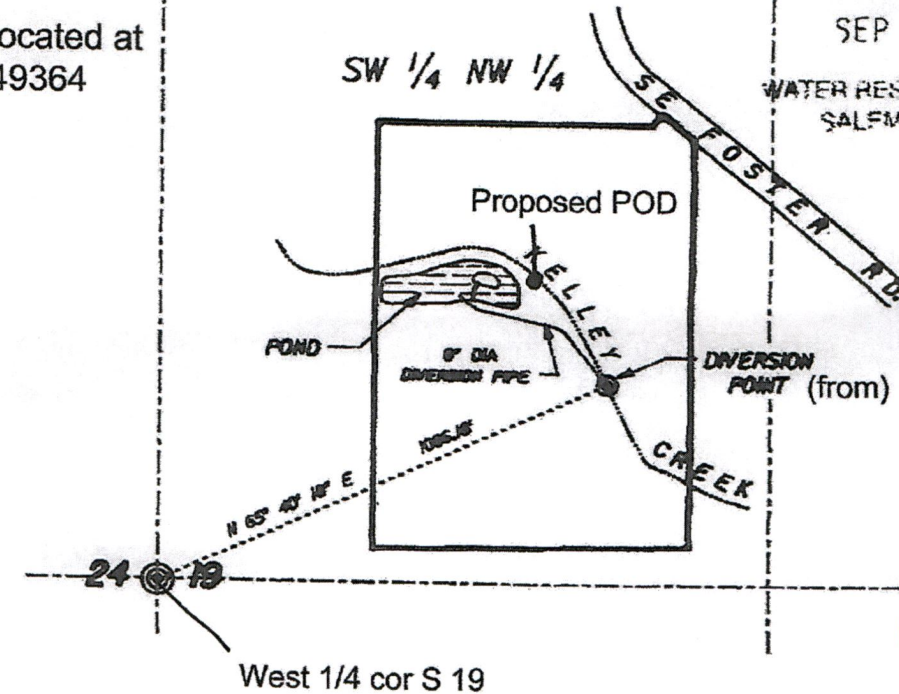

RECEIVED

SEP 23 1997

WATER RESOURCES DE
SALEM OREGON

RECEIVED

AUG 02 2019

OWRD

RECEIVED

OCT 17 2019

OWRD

This drawing is an exhibit for a Final Proof Survey. It is not a Land Survey. Property lines and/or other lines of occupation shown hereon are not represented by the undersigned to meet accuracy standards of Land Surveys.



SCALE: 1" = 400'

SECTION 19, T.1S., R.3E., W.M.
MULTNOMAH COUNTY, OREGON

13272

RECEIVED

OCT 17 2019

OWRD

Proposed POD located at
45.47022, -122.49364

360' S. & 465' W
from NE corner
of SW 1/4, NW 1/4

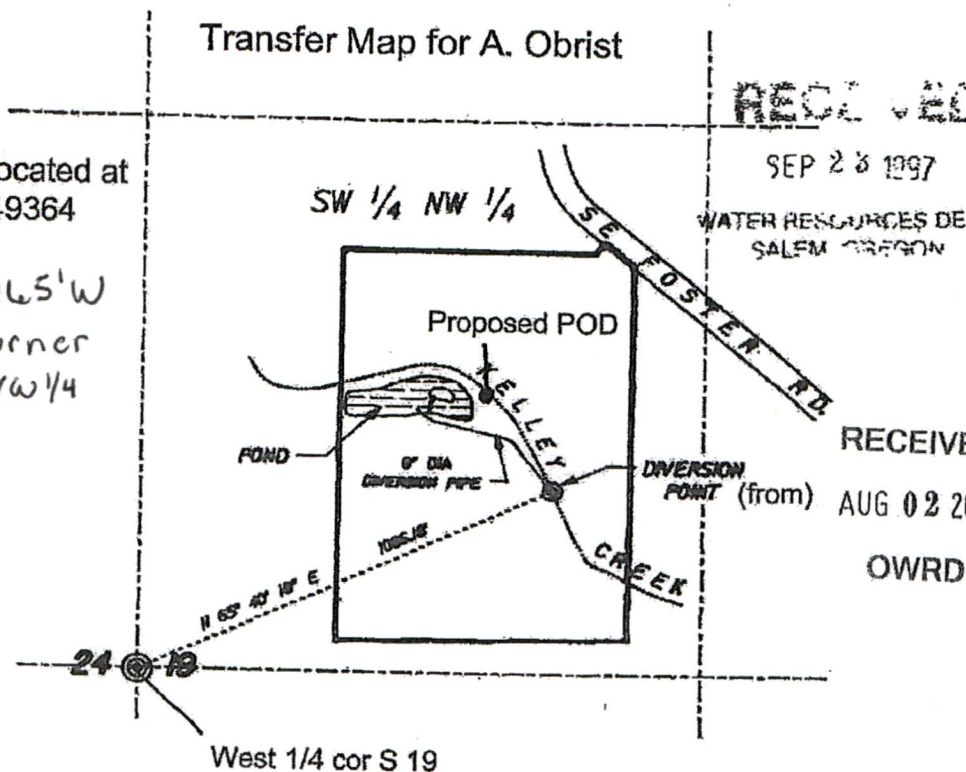

This drawing is an exhibit for a Final Proof Survey. It is not a Land Survey. Property lines and/or other lines of occupation shown hereon are not represented by the undersigned to meet accuracy standards of Land Surveys.



SCALE: 1" = 400' 425' min

SECTION 19, T.1S., R.3E., W.M.
MULTNOMAH COUNTY, OREGON

13272