

Revised

Received by OWRD

FEB 07 2020

Salem, OR

T23S R31E, WM,  
HARNEY COUNTY, OR

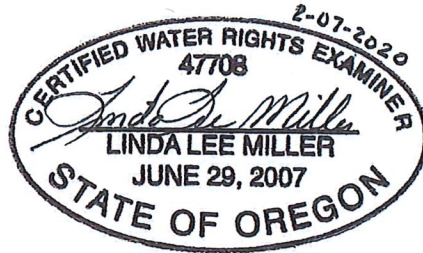
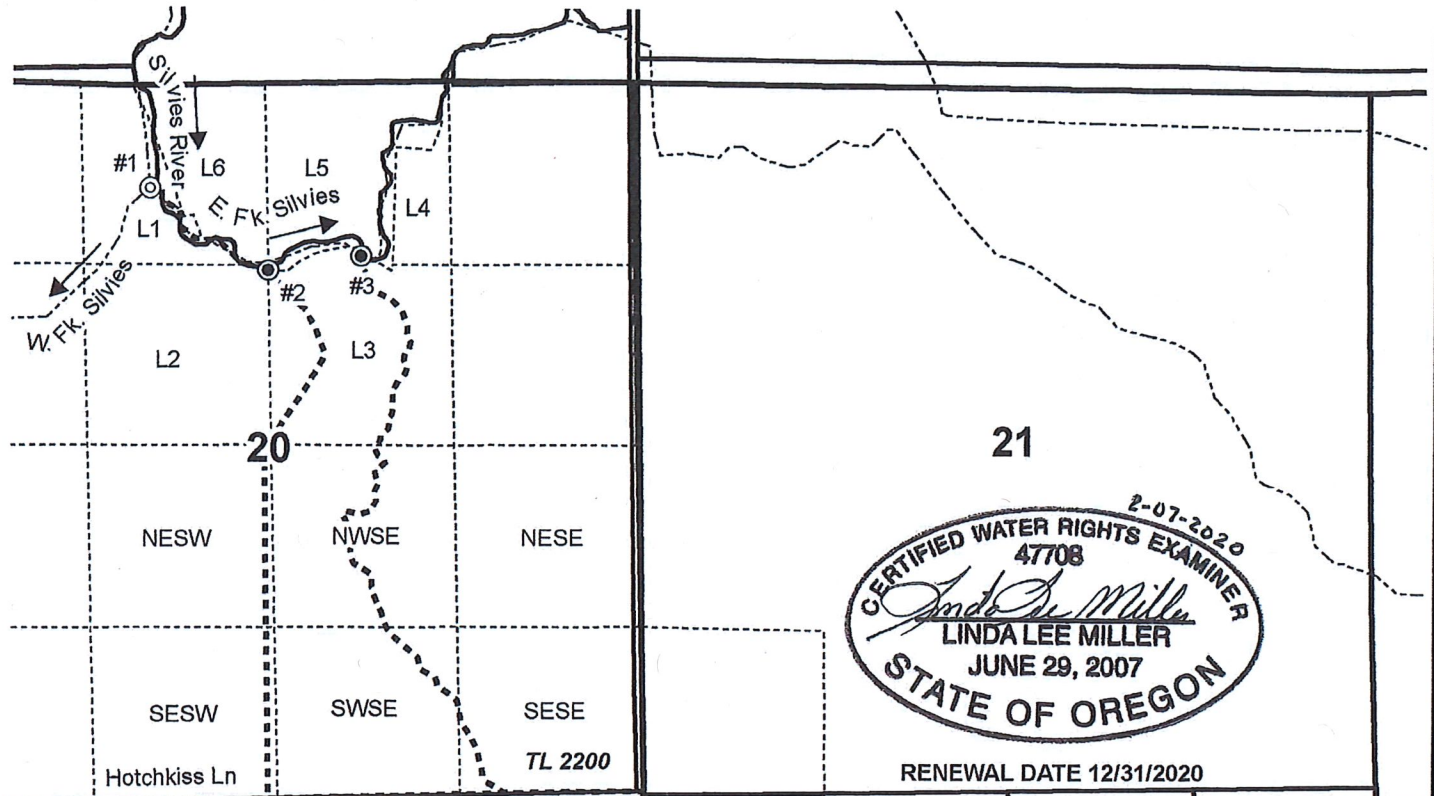
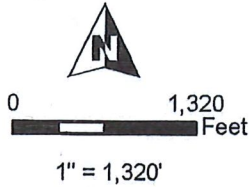

RENEWAL DATE 12/31/2020

- ⊙ Authorized POD
- ⊙ Proposed APOD
- Ditch
- ▨ POU IR (1886)
- ▭ Section
- Quarter Quarter
- ▭ Taxlot

POD Locations:

29

- Authorized POD #1: 750' S, 1840' E of NW Cor Sec 20
- Proposed APOD #2: 1290' S of N 1/4 Cor Sec 20
- Proposed APOD #3: 1220' S, 700' E of N 1/4 Cor Sec 20



**APOD TRANSFER MAP**  
**Mark Doverspike**

Decree: Silvies River, 1926

Date: 2/6/2020

This map is not intended to provide legal dimensions or locations of property ownership lines.

**WATER RIGHT SERVICES, LLC**  
PO BOX 1830, BEND, OR 97709  
[WWW.OREGONWATER.US](http://WWW.OREGONWATER.US) CCB # 197121  
johnshort@usa.com 541-389-2837

T23S R31E, WM,  
HARNEY COUNTY, OR

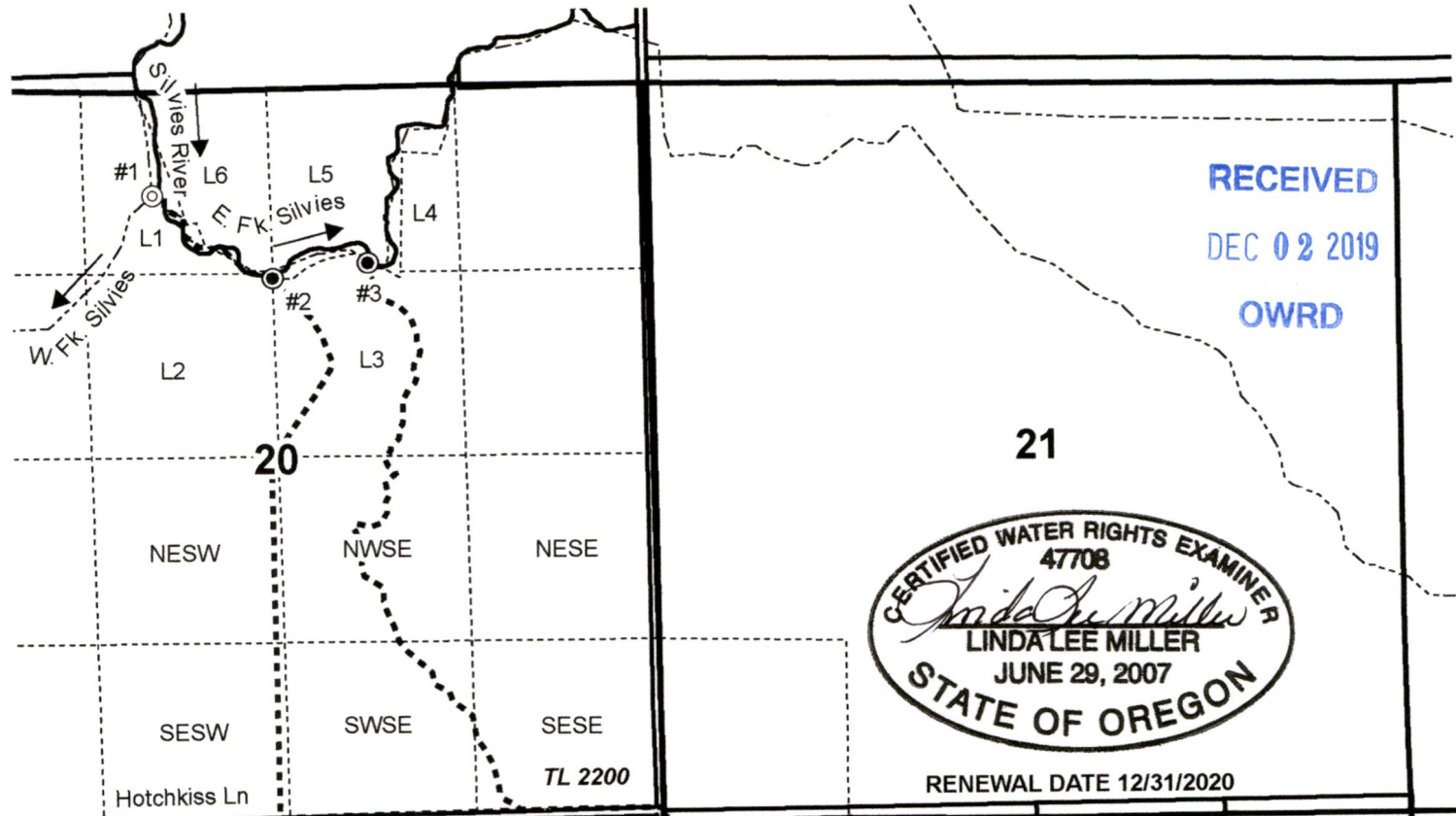
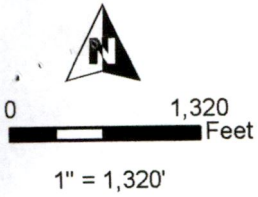

RECEIVED  
DEC 02 2019  
OWRD

CERTIFIED WATER RIGHTS EXAMINER  
47708  
*Linda Lee Miller*  
LINDA LEE MILLER  
JUNE 29, 2007  
STATE OF OREGON

RENEWAL DATE 12/31/2020

- ⊙ Authorized POD
- Proposed APOD
- Ditch
- ▨ POU IR (1886)
- ▭ Section
- Quarter Quarter
- ▭ Taxlot

POD Locations:  
 Authorized POD #1: 750' S, 1840' E of NW Cor Sec 20  
 Proposed APOD #2: 1290' S of N 1/4 Cor Sec 20  
 Proposed APOD #3: 1220' S, 700' E of N 1/4 Cor Sec 20

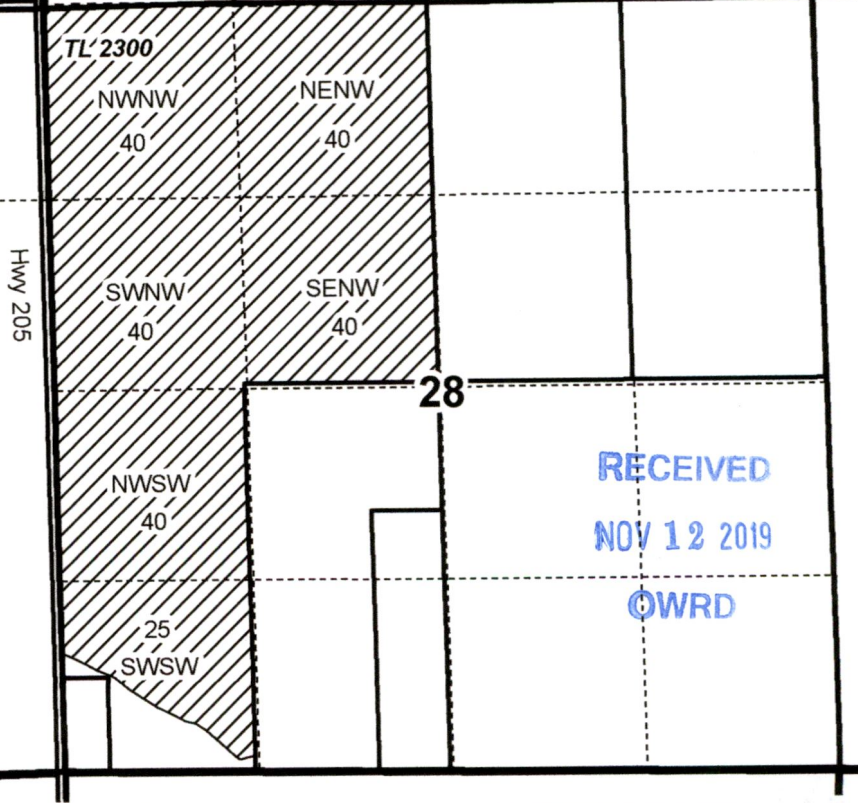

RECEIVED  
NOV 12 2019  
OWRD

**APOD TRANSFER MAP**  
**Mark Doverspike**

Decree: Silvies River, 1926

Date: 10/17/2019

This map is not intended to provide legal dimensions or locations of property ownership lines.

**WATER RIGHT SERVICES, LLC**  
 PO BOX 1830, BEND, OR 97709  
**WWW.OREGONWATER.US** CCB # 197121  
 johnshort@usa.com 541-389-2837

**JUNE 2016 IMAGERY**

RECEIVED  
NOV 12 2019

OWRD

Legend

19

20

21

22

T23S R31E

RECEIVED

DEC 02 2019

OWRD

30

29

28

27

Survey  
Google Earth



1 mi