

# Application for a Groundwater Registration Modification in the Name of Oregon Department of Corrections (GR-692)

Marion County, Oregon  
Township 8 South, Range 2 West (W.M.)

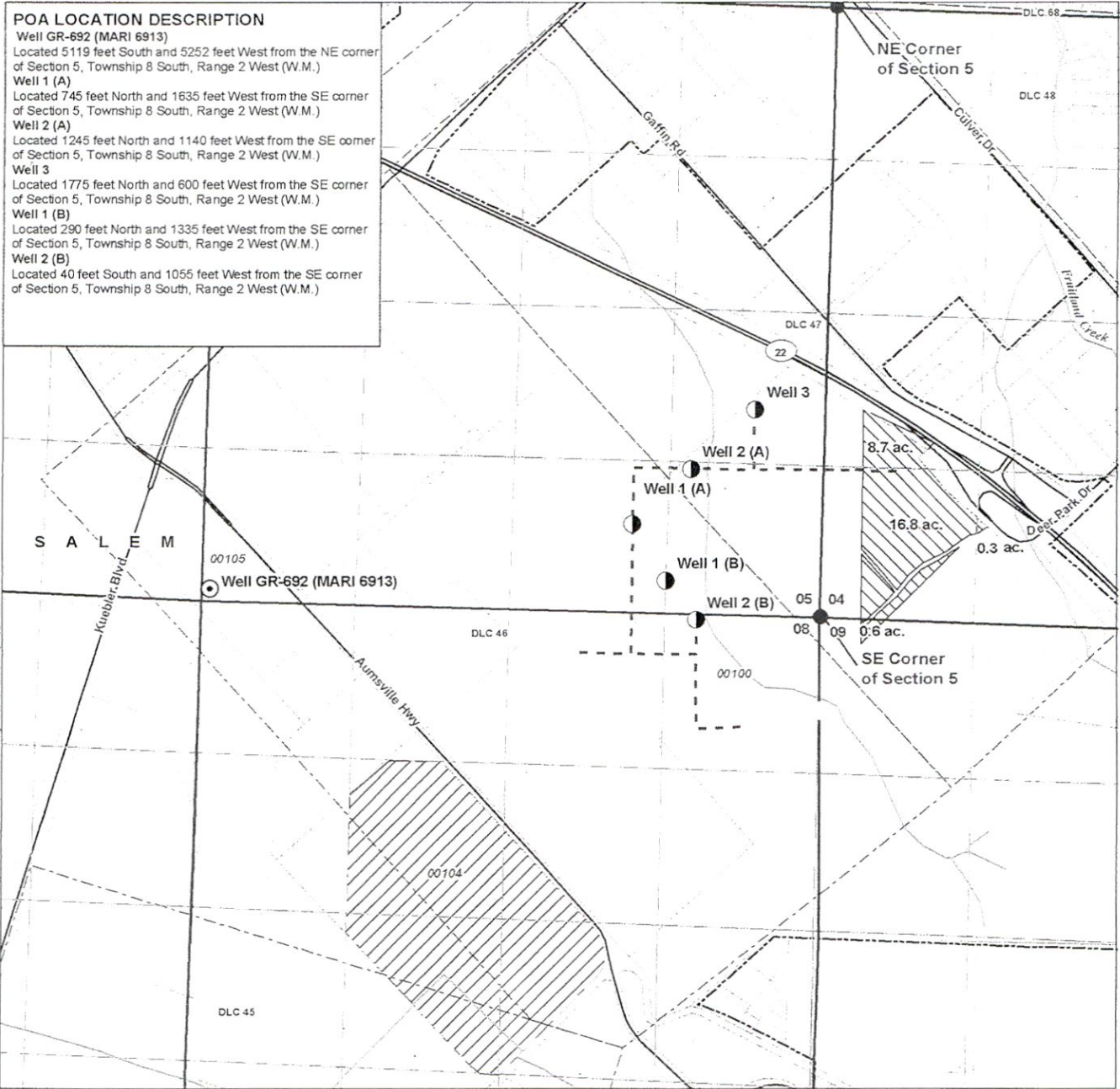

**POA LOCATION DESCRIPTION**  
**Well GR-692 (MARI 6913)**  
 Located 5119 feet South and 5252 feet West from the NE corner of Section 5, Township 8 South, Range 2 West (W.M.)  
**Well 1 (A)**  
 Located 745 feet North and 1635 feet West from the SE corner of Section 5, Township 8 South, Range 2 West (W.M.)  
**Well 2 (A)**  
 Located 1245 feet North and 1140 feet West from the SE corner of Section 5, Township 8 South, Range 2 West (W.M.)  
**Well 3**  
 Located 1775 feet North and 600 feet West from the SE corner of Section 5, Township 8 South, Range 2 West (W.M.)  
**Well 1 (B)**  
 Located 290 feet North and 1335 feet West from the SE corner of Section 5, Township 8 South, Range 2 West (W.M.)  
**Well 2 (B)**  
 Located 40 feet South and 1055 feet West from the SE corner of Section 5, Township 8 South, Range 2 West (W.M.)

Document Path: X:\0756 - ODD\Source Figures\032 - effs - Analytical Registration - Mod Cit032.mxd

- LEGEND**
- Authorized Point of Appropriation (POA)
  - Proposed Point of Appropriation (POA)
  - - - Pipeline
  - Place of Use (POU)  
 Authorized  
 Proposed, 26.4 ac.
  - All Other Features  
 Donation Land Claim (DLC)  
 City Boundary  
 Tax Lot  
 Major Road  
 Watercourse  
 Waterbody

RECEIVED  
DEC 04 2019  
OWRD

**DISCLAIMER**  
 This map was prepared for the purpose of identifying the location of a water right only and it is not intended to provide legal dimensions or location of property ownership lines.

**MAP NOTES**  
 Date: November 6, 2019  
 Data Sources: USGS, BLM, OGIC, Marion County

**NOTE:**  
 \*The place of use for GR-692 was not mapped.  
 The place of use was identified as domestic use at the State Hospital within the marked quarter quarters.

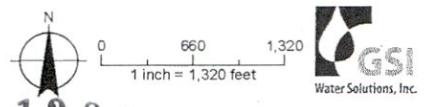

13295 -

# Application for a Groundwater Registraion Modification in the Name of Oregon Department of Corrections (GR-692)

Marion County, Oregon  
Township 8 South, Range 2 West (W.M.)

## POA LOCATION DESCRIPTION

**Well GR-692 (MARI 6913)**  
Located 5119 feet South and 5252 feet West from the NE corner of Section 5, Township 8 South, Range 2 West (W.M.)

**Well 1 (A)**  
Located 745 feet North and 1635 feet West from the SE corner of Section 5, Township 8 South, Range 2 West (W.M.)

**Well 2 (A)**  
Located 1245 feet North and 1140 feet West from the SE corner of Section 5, Township 8 South, Range 2 West (W.M.)

**Well 3**  
Located 1775 feet North and 600 feet West from the SE corner of Section 5, Township 8 South, Range 2 West (W.M.)

**Well 1 (B)**  
Located 290 feet North and 1335 feet West from the SE corner of Section 5, Township 8 South, Range 2 West (W.M.)

**Well 2 (B)**  
Located 40 feet South and 1055 feet West from the SE corner of Section 5, Township 8 South, Range 2 West (W.M.)

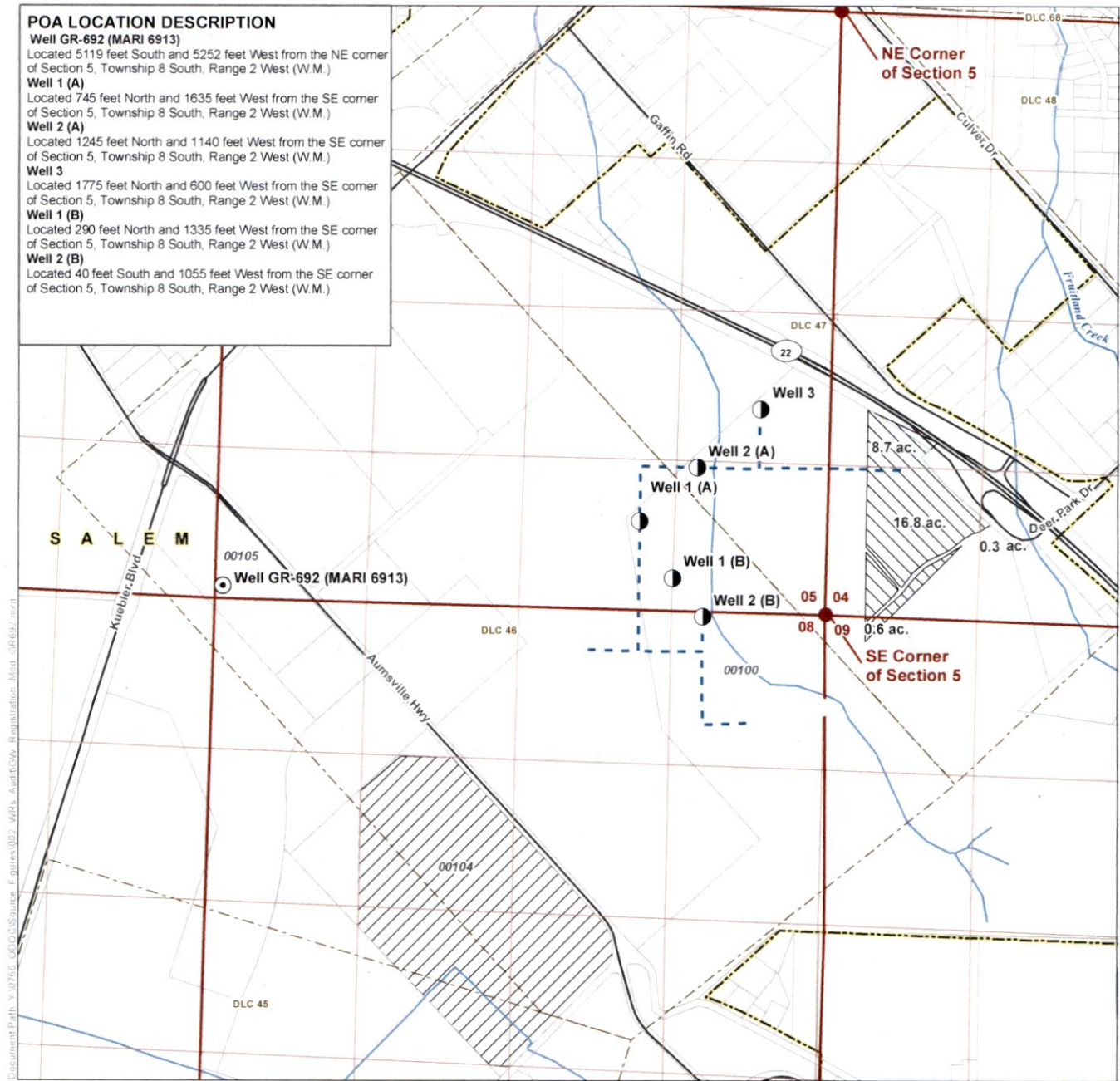

Document Path: X:\0756\GIS\Source\_Figures\022\_MRI\_Avaf\034\_Registraion\_Mari\_GR692.mxd

### LEGEND

- |       |   |                           |
|-------|---|---------------------------|
| ●     | Authorized Point of Appropriation (POA) | <b>All Other Features</b> |
| ●     | Proposed Point of Appropriation (POA)   | Donation Land Claim (DLC) |
| - - - | Pipeline                                | City Boundary             |
|       | Place of Use (POU)                      | Tax Lot                   |
|       | Authorized                              | Major Road                |
|       | Proposed, 26.4 ac.                      | Watercourse               |
|       |   | Waterbody                 |

### NOTE:

\*The place of use for GR-692 was not mapped.  
The place of use was identified as domestic use at the State Hospital within the marked quarter quarters.

### DISCLAIMER

This map was prepared for the purpose of identifying the location of a water right only and it is not intended to provide legal dimensions or location of property ownership lines.

### MAP NOTES

Date: November 6, 2019  
Data Sources: USGS, BLM, OGIC,  
Marion County

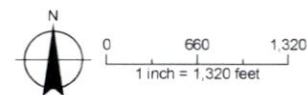

Attachment B  
Application Map

Application for a Groundwater Registration Modification – Oregon Dept. of Corrections