

Application for Change in Point of Diversion & Place of Use

Elmwood Ranch, Inc - Russell Ricco / Roger & Janna Lee

Water Rights "From" Lands to be Transferred

Township 13 South, Range 33 East, Sections 17 & 18 W.M.

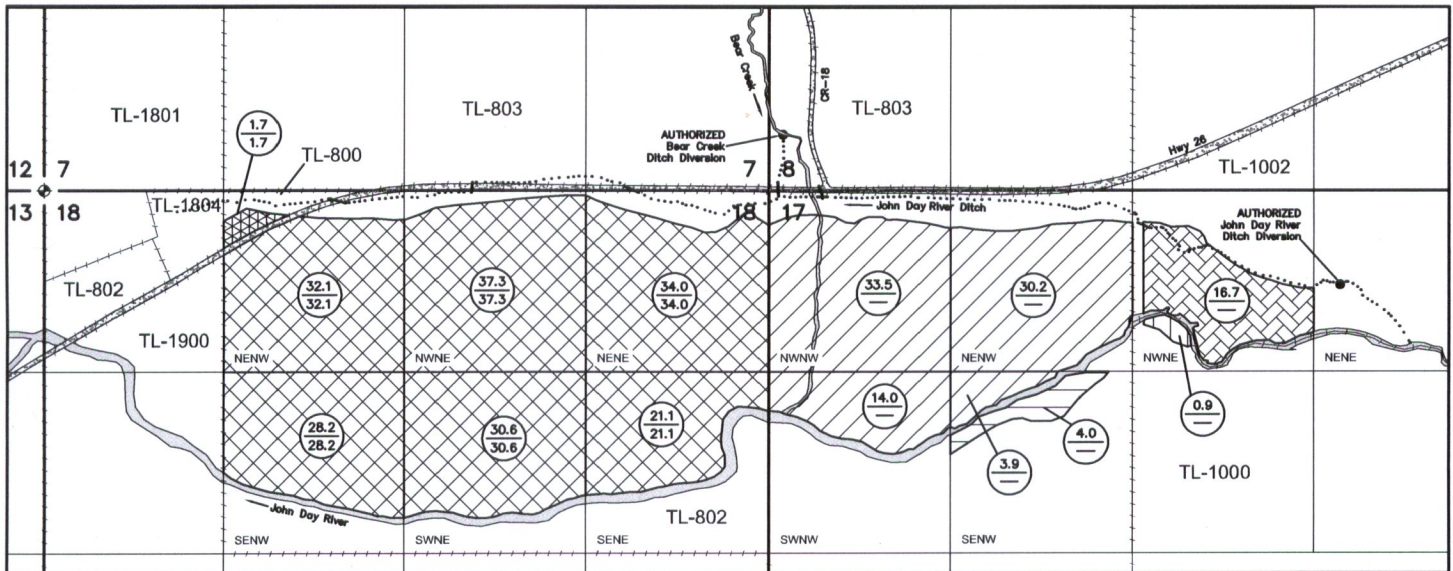

Scale: 1" = 1,320'

This map is not intended to provide legal dimensions or location of property ownership lines.

AUTHORIZED John Day River Ditch Diversion:
Township 13 South, Range 30 East
Section 17 W.M. NE $\frac{1}{4}$ NE $\frac{1}{4}$

RECEIVED

APR 19 2018

OWRD

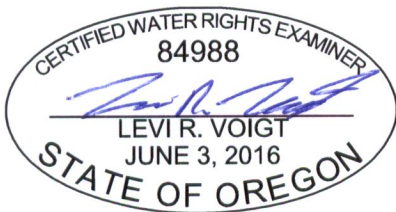

RENEWS:

LEGEND	
Located Section Corner	Property Boundary
Irrigation Pipeline	Irrigation Ditch
Certificate No. 25272 (Xxxx)	Primary Acres Supplemental Acres
Certificate No. 25273 (Xxxx)	Certificate No. 25272 (not included in this transfer)
Certificate Nos. 25272 & 25273 (Yyyy)	Certificate No. 32398 (not included in this transfer)
Certificate No. 32398	

Application for Change in Point of Diversion & Place of Use

Elmwood Ranch, Inc - Russell Ricco / Roger & Janna Lee

Water Rights "To" Lands to be Transferred

Township 13 South, Range 33 East, Sections 17 & 18 W.M.

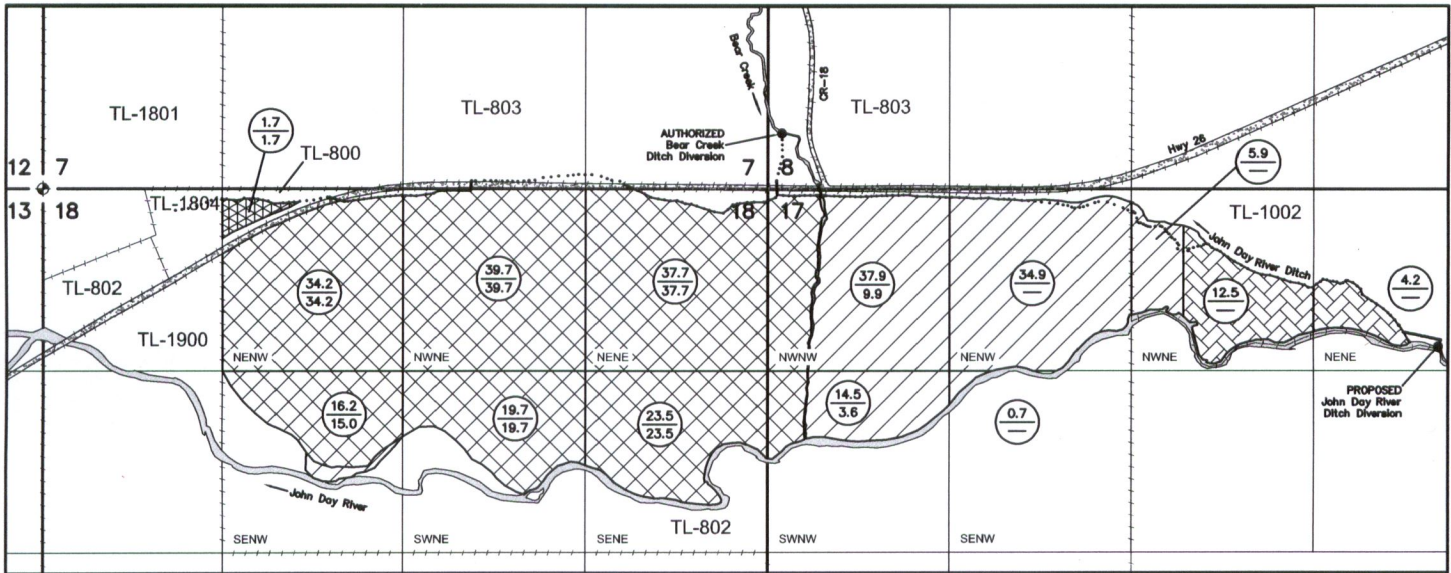

Scale: 1" = 1,320'

This map is not intended to provide legal dimensions or location of property ownership lines.

PROPOSED John Day River Ditch Diversion:
 Township 13 South, Range 30 East
 Section 17 W.M. NE $\frac{1}{4}$ NE $\frac{1}{4}$
 N44.44274°, W118.75946°

RECEIVED

APR 19 2018

OWRD

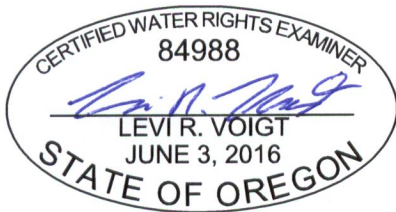

RENEWS:

LEGEND	
	Located Section Corner
	Property Boundary
	Irrigation Pipeline
	Irrigation Ditch
	Former Certificate No. 25272 (Xxxx)
	Former Certificate No. 25273 (Xxxx)
	Former Certificate Nos. 25272 & 25273 (Yyyy)
	Former Certificate No. 32398
	Primary Acres Supplemental Acres