

- County Boundary
- City Boundary
- Major Road
- Watercourse
- Waterbody

RECEIVED
 FEB 23 2020
 OWRD

Certified Water Rights Examiner
 #78465WRE
Theodore R. Ressler
 Theodore R. Ressler
 June 29, 2007
 STATE OF OREGON
 EXPIRES: 12-31-2020

DISCLAIMER
 This map was prepared for the purpose of identifying the location of a water right only and it is not intended to provide legal dimensions or location of property ownership lines.

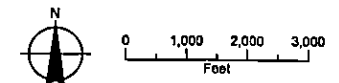

Date: February 28, 2020
 Data Sources: USGS, BLM, OGC, ESRI

**Exhibit 2-1
Water System
Newberg, Oregon**

LEGEND

- Spring
- Well
- Reservoir
- ▲ Pump Station
- Water Treatment Plant and Pumps
- Water Main
- Raw Water Transmission
- ▨ Existing Service Area
- ▨ Urban Reserve Area (URA)
- ⊕ Urban Growth Boundary
- Water Service Areas**
- ▨ Chehalam Terrace Water Co.
- ▨ Chehalam Valley Water Association
- ▨ Dayton Avenue Water Line
- ▨ Foothills Water Co.
- ▨ N.W. Newberg Water District
- ▨ Ramsay Terrace Water District
- ▨ Sam Whitney Water District
- ▨ Sunny Acres Water District
- ▨ W. Sheridan Water Assoc.
- All Other Features**
- City Boundary
- County Boundary
- Major Road
- Railroad
- Watercourse
- Waterbody

RECEIVED
FEB 23 2020
OWRD

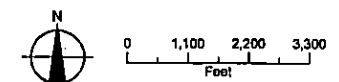

Date: January 29, 2019
Data Source: City of Newberg, OGC, ESRI

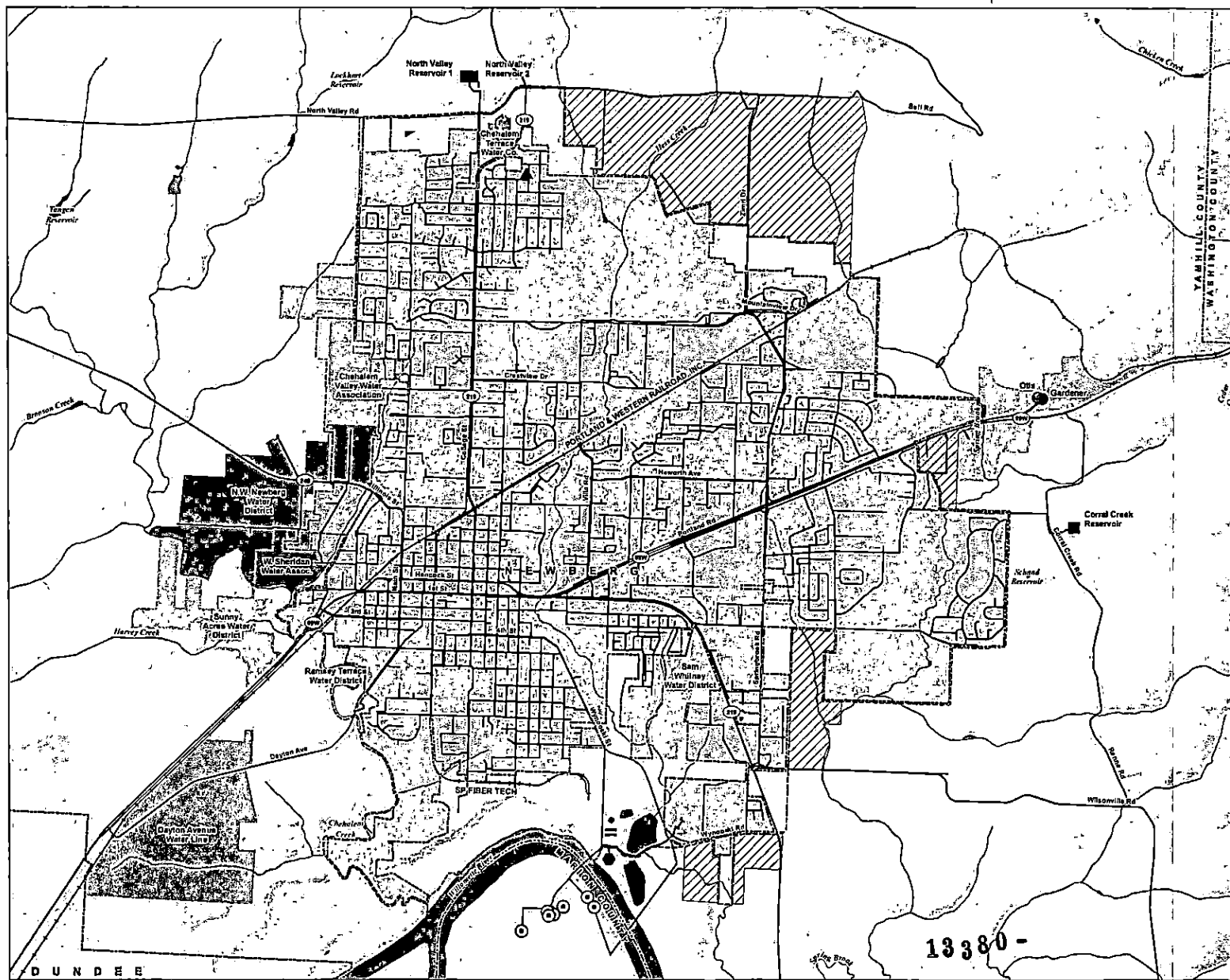

13380-

Application for a Groundwater Registration Modification (GR-63) for the City of Newberg Authorized and Proposed Points of Appropriation

Marion and Yamhill Counties
Township 3 South, Range 2 West (W.M.)

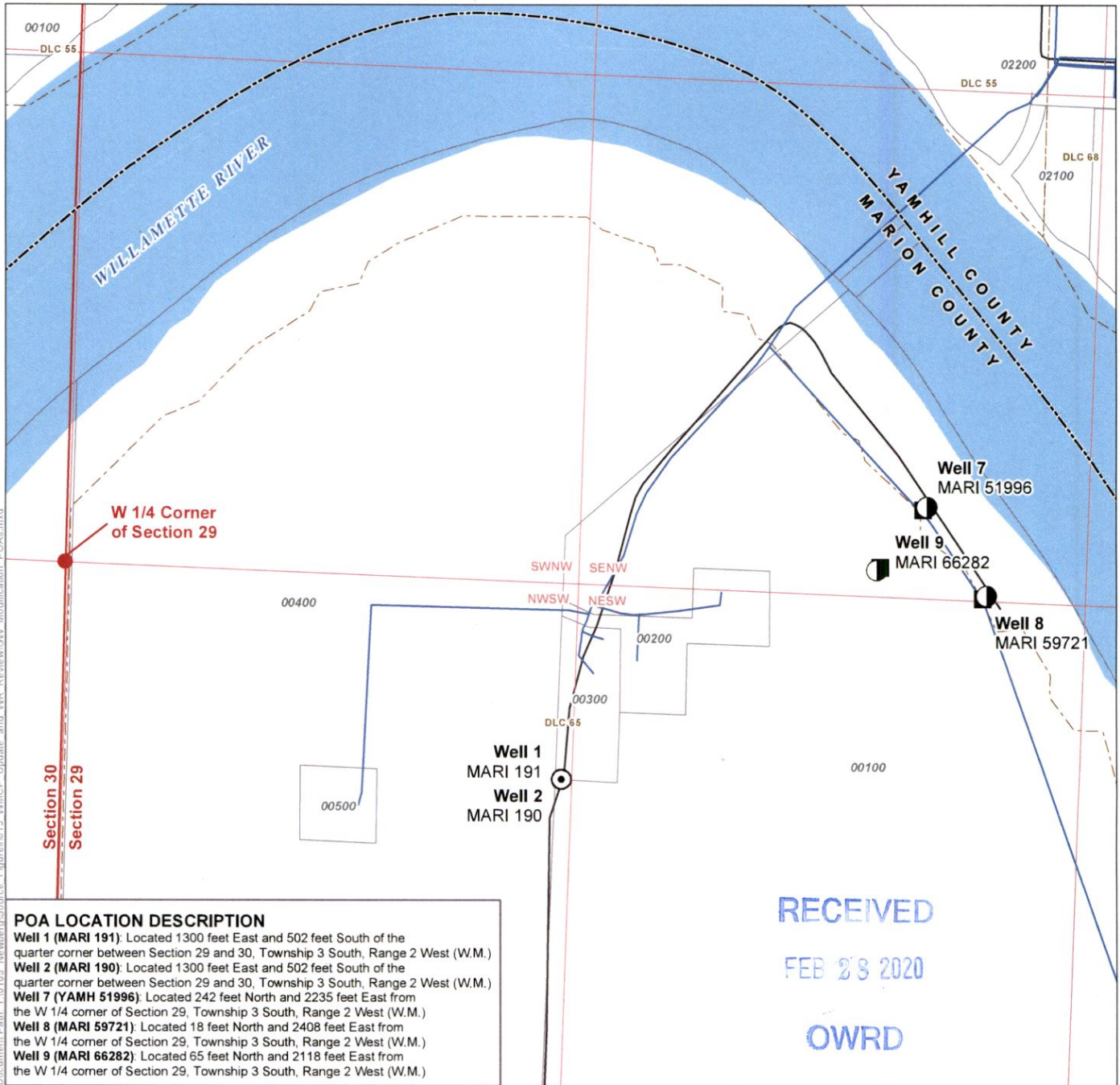

POA LOCATION DESCRIPTION

Well 1 (MARI 191): Located 1300 feet East and 502 feet South of the quarter corner between Section 29 and 30, Township 3 South, Range 2 West (W.M.)

Well 2 (MARI 190): Located 1300 feet East and 502 feet South of the quarter corner between Section 29 and 30, Township 3 South, Range 2 West (W.M.)

Well 7 (YAMH 51996): Located 242 feet North and 2235 feet East from the W 1/4 corner of Section 29, Township 3 South, Range 2 West (W.M.)

Well 8 (MARI 59721): Located 18 feet North and 2408 feet East from the W 1/4 corner of Section 29, Township 3 South, Range 2 West (W.M.)

Well 9 (MARI 66282): Located 65 feet North and 2118 feet East from the W 1/4 corner of Section 29, Township 3 South, Range 2 West (W.M.)

LEGEND

- ⊙ Authorized Point of Appropriation (POA)
- ◐ Proposed Point of Appropriation (POA)
- Flow Meter
- Water Main
- - - Donation Land Claim (DLC)
- All Other Features**
- Tax Lot
- ▭ County Boundary
- Major Road
- ~ Watercourse
- Waterbody

Certified Water Rights Examiner Stamp

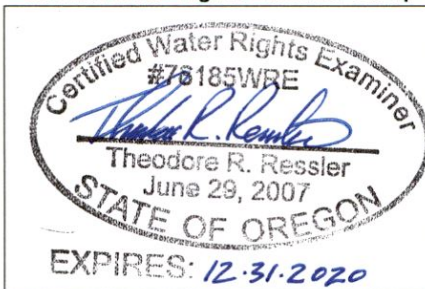

RECEIVED
FEB 28 2020
OWRD

DISCLAIMER

This map was prepared for the purpose of identifying the location of a water right only and it is not intended to provide legal dimensions or location of property ownership lines.

MAP NOTES

Date: July 15, 2019
Data Sources: OGIC, OWRD, USGS, Yamhill and Marion Co., ESRI

