

18409

MAP TO ACCOMPANY APPLICATION
TO ADD POINTS OF APPROPRIATION
TO APPLICATION G-14135
CHARLES & LOUANNA EGGERT

SECTIONS 9, 10, 15, & 16, TOWNSHIP 26 SOUTH, RANGE 30 EAST, W.M.
TAX LOTS: 1200, 2300, 2900, 4900, & 5000

RECEIVED

APR 06 2020

OWRD

Received by OWRD

NOV 26 2019

Salem, OR

- **POA 1 (HARN 1336)**
AUTHORIZED WELL IN THE NW 1/4 OF THE SW 1/4 OF SECTION 16 LOCATED 2464 FEET NORTH AND 286 FEET EAST FROM THE SW CORNER.
- **POA 2 (MALH 2323)**
AUTHORIZED WELL IN THE SE 1/4 OF THE NE 1/4 OF SECTION 15 LOCATED 2621 FEET NORTH AND 9878 FEET EAST FROM THE SW CORNER SECTION 16.
- **POA 3 (HARN 1332)**
AUTHORIZED WELL IN THE SW 1/4 OF THE SW 1/4 OF SECTION 10 LOCATED 6500 FEET NORTH AND 5850 FEET EAST FROM THE SW CORNER SECTION 16.
- **POA 4 (HARN 1337)**
AUTHORIZED WELL IN THE SE 1/4 OF THE SE 1/4 OF SECTION 16 LOCATED 610 FEET NORTH AND 5130 FEET EAST FROM THE SW CORNER SECTION 16.
- **POA 7 (HARN 51973)**
PROPOSED WELL IN THE NE 1/4 OF THE NE 1/4 OF SECTION 16, LOCATED 25 FEET SOUTH AND 320 FEET WEST FROM THE NE CORNER SECTION 16.
- **POA 8 (HARN 50946)**
AUTHORIZED WELL IN THE SE 1/4 OF THE SE 1/4 OF SECTION 16 LOCATED 600 FEET NORTH AND 185 FEET WEST FROM THE SE CORNER SECTION 16.
- **POA 9 (HARN 50472)**
AUTHORIZED WELL IN THE SE 1/4 OF THE SW 1/4 OF SECTION 10 LOCATED 5316 FEET NORTH AND 6728 FEET EAST FROM THE SW CORNER SECTION 16.
- **POA 10 (HARN 52639)**
PROPOSED WELL IN THE SW 1/4 OF THE SW 1/4 OF SECTION 10, LOCATED 65 FEET NORTH AND 1255 FEET EAST FROM THE SW CORNER OF SECTION 10.
- **POA 11 (HARN 52774)**
PROPOSED WELL IN THE SW 1/4 OF THE NE 1/4 OF SECTION 9, LOCATED 43°19'52.0" NORTH AND 119°07'27.6" WEST.
- **POA 12 (HARN 52513)**
PROPOSED WELL IN THE SE 1/4 OF THE SE 1/4 OF SECTION 16, LOCATED 43°18'33.1" NORTH AND 119°07'19.5" WEST.

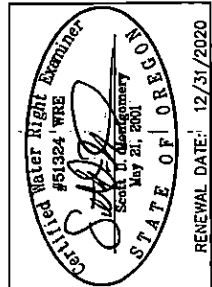

ALL POINTS ENGINEERING
& SURVEYING, INC.

P.O. BOX 767
TERREBONNE, OREGON 97760
(541) 548-5833 PH
Scott@APEandS.com
www.APEandS.com

PROJECT No. 18-075

PREPARED AT THE REQUEST OF:
CHARLES EGGERT
9955 SW POTANO ST.
TUALITIN, OR 97062

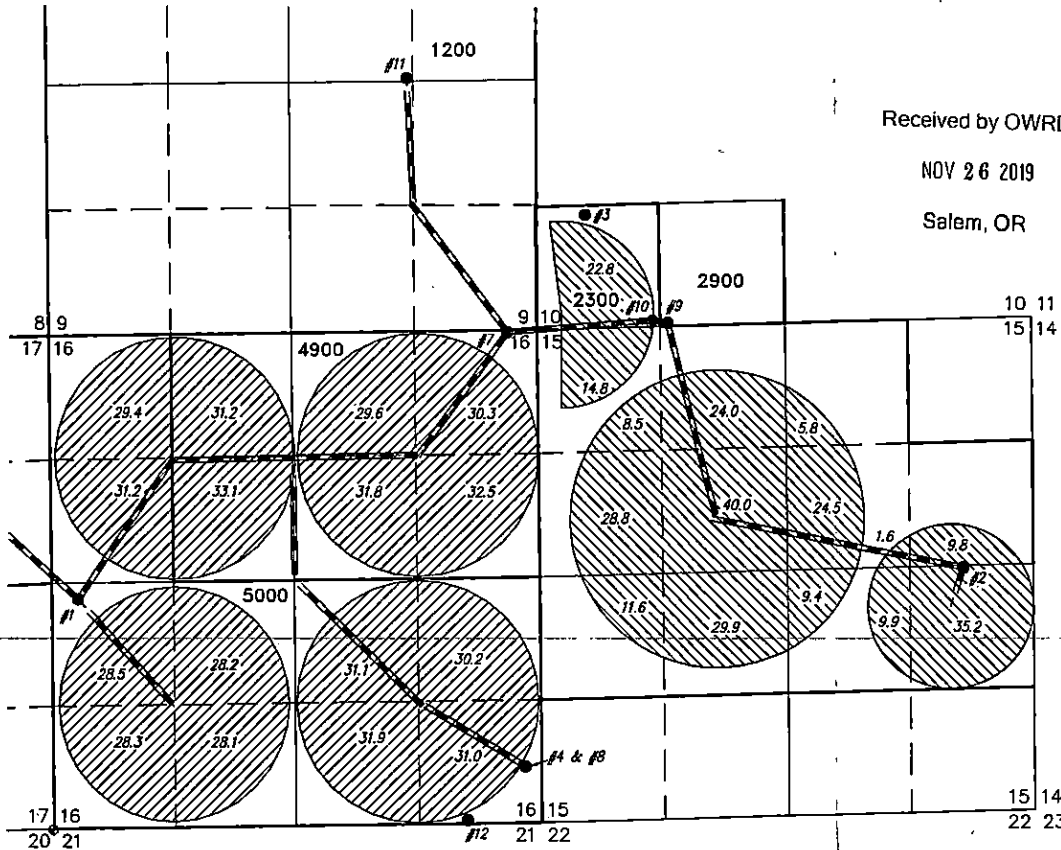

486.4 ACRES PRIMARY IRRIGATION ALL FROM
POAS 1, 2, 7, 8, 9, 10, 11, & 12, AS SHOWN.

— BURIED PIPE

276.6 ACRES PRIMARY IRRIGATION ALL FROM
POAS 1, 2, 7, 8, 9, 10, 11, & 12, AS SHOWN

THIS MAP IS FOR THE PURPOSE OF DESIGNING AN
IRRIGATION SYSTEM PLAN AND HAS NO INTENT TO PROVIDE
LEGAL DIMENSIONS OR THE LOCATION OF PROPERTY LINES

RENEWAL DATE: 12/31/2020

13409

MAP TO ACCOMPANY APPLICATION
TO ADD POINTS OF APPROPRIATION
TO APPLICATION G-14135
CHARLES & LOUANNA EGGERT

SECTIONS 9, 10, 15, & 16, TOWNSHIP 26 SOUTH, RANGE 30 EAST, W.M.
TAX LOTS: 1200, 2300, 2900, 4900, & 5000

RECEIVED
APR 06 2020
OWRD

RECEIVED
NOV 25 2019
OWRD

- **POA 1 (HARN 1336)**
AUTHORIZED WELL IN THE NW 1/4 OF THE SW 1/4 OF SECTION 16 LOCATED 2464 FEET NORTH AND 286 FEET EAST FROM THE SW CORNER.
- **POA 2 (MALH 2323)**
AUTHORIZED WELL IN THE SE 1/4 OF THE NE 1/4 OF SECTION 15 LOCATED 2621 FEET NORTH AND 9878 FEET EAST FROM THE SW CORNER SECTION 16.
- **POA 3 (HARN 1332)**
AUTHORIZED WELL IN THE SW 1/4 OF THE SW 1/4 OF SECTION 10 LOCATED 6500 FEET NORTH AND 5850 FEET EAST FROM THE SW CORNER SECTION 16.
- **POA 4 (HARN 50946)**
AUTHORIZED WELL IN THE SE 1/4 OF THE SE 1/4 OF SECTION 16 LOCATED 610 FEET NORTH AND 5130 FEET EAST FROM THE SW CORNER SECTION 16.
- **POA 7 (HARN 51973)**
PROPOSED WELL IN THE NE 1/4 OF THE NE 1/4 OF SECTION 16, LOCATED 25 FEET SOUTH AND 320 FEET WEST FROM THE NE CORNER SECTION 16.
- **POA 8 (HARN 52513)**
AUTHORIZED WELL IN THE SE 1/4 OF THE SE 1/4 OF SECTION 16 LOCATED 600 FEET NORTH AND 185 FEET WEST FROM THE SE CORNER SECTION 16.
- **POA 9 (HARN 50472)**
AUTHORIZED WELL IN THE SE 1/4 OF THE SW 1/4 OF SECTION 10 LOCATED 5316 FEET NORTH AND 6728 FEET EAST FROM THE SW CORNER SECTION 16.
- **POA 10 (HARN 52639)**
PROPOSED WELL IN THE SW 1/4 OF THE SW 1/4 OF SECTION 10, LOCATED 65 FEET NORTH AND 1255 FEET EAST FROM THE SW CORNER OF SECTION 10.
- **POA 11 (HARN 52774)**
PROPOSED WELL IN THE SW 1/4 OF THE NE 1/4 OF SECTION 9, LOCATED 43°19'52.0" NORTH AND 119°07'27.6" WEST.
- **POA 12 (HARN 52513)**
PROPOSED WELL IN THE SE 1/4 OF THE SE 1/4 OF SECTION 16, LOCATED 43°18'33.1" NORTH AND 119°07'19.5" WEST.

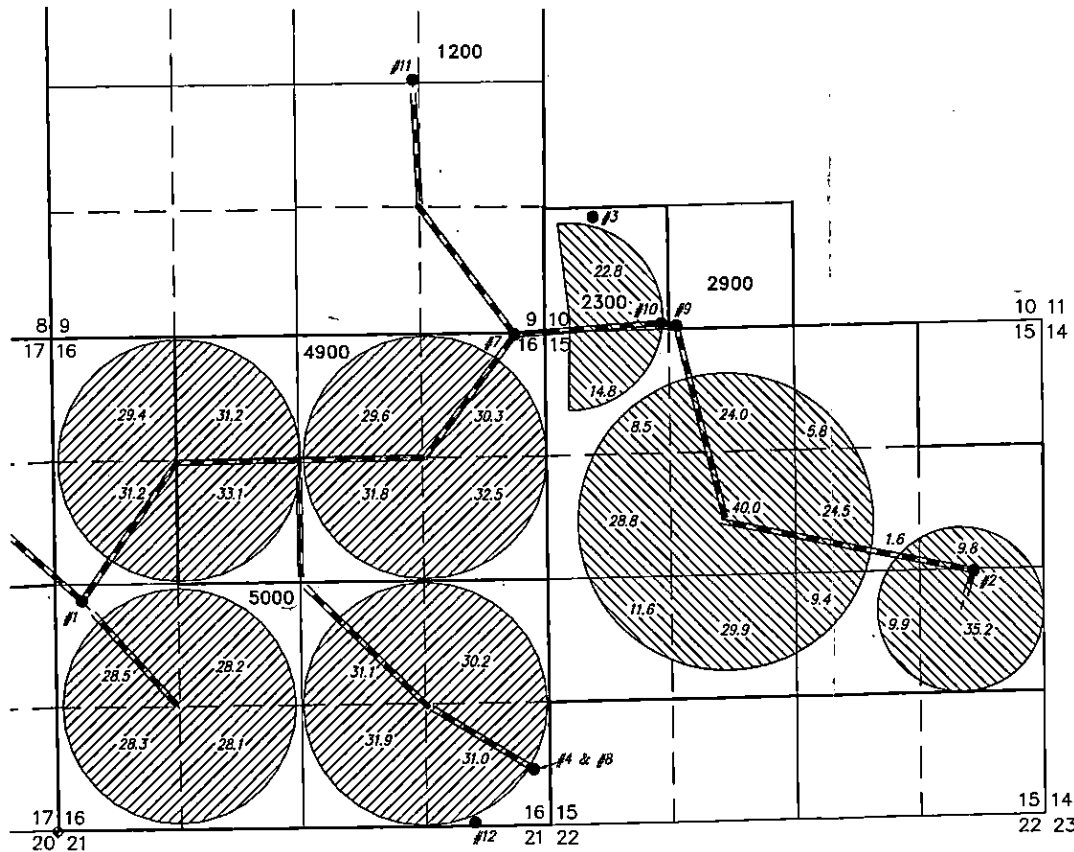

486.4 ACRES PRIMARY IRRIGATION ALL FROM
POAS 1, 2, 7, 8, 9, 10, 11, & 12, AS SHOWN.

--- BURIED PIPE

276.6 ACRES PRIMARY IRRIGATION ALL FROM
POAS 1, 2, 7, 8, 9, 10, 11, & 12, AS SHOWN.

THIS MAP IS FOR THE PURPOSE OF DESIGNING AN
IRRIGATION SYSTEM PLAN AND HAS NO INTENT TO PROVIDE
LEGAL DIMENSIONS OR THE LOCATION OF PROPERTY LINES

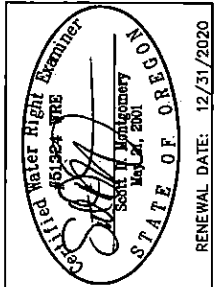

ALL POINTS ENGINEERING
& SURVEYING, INC.

P.O. BOX 767
TERREBONNE, OREGON 97760
(541) 548-5833 PH
Scott@APEandS.com
www.APEandS.com

PROJECT No. 18-075

PREPARED AT THE REQUEST OF:

CHARLES EGGERT
9955 SW POTANO ST.
TUALATIN, OR 97062

RENEWAL DATE: 12/31/2020

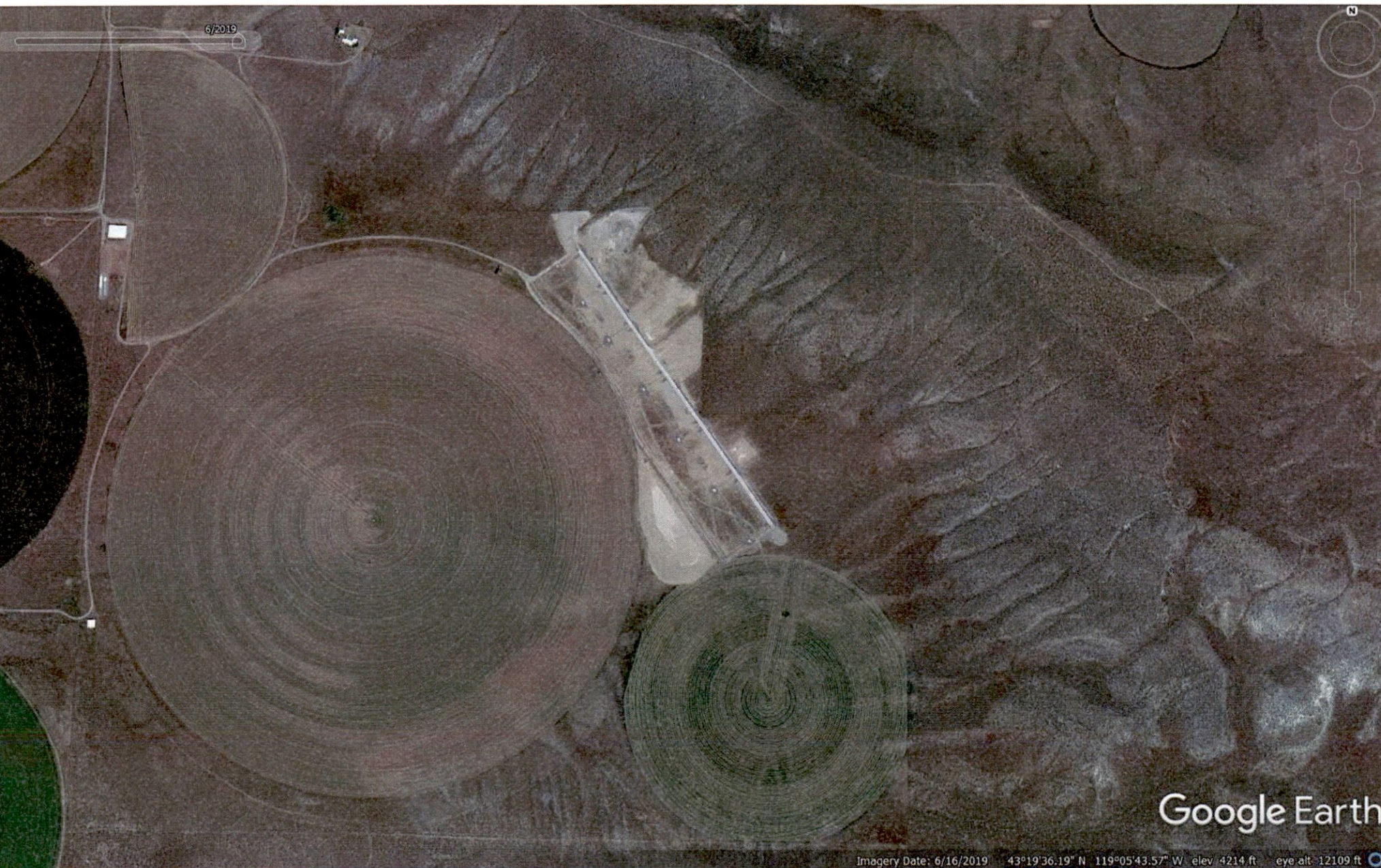

Imagery Date: 6/16/2019 43°19'36.19" N 119°05'43.57" W elev 4214 ft eye alt 12109 ft

RECEIVED

APR 10 2020

OWRD

13409