

**PERMIT AMENDMENT**

Located in Sections 4 & 5, T3S R7E W.M.

Clackamas County, Oregon

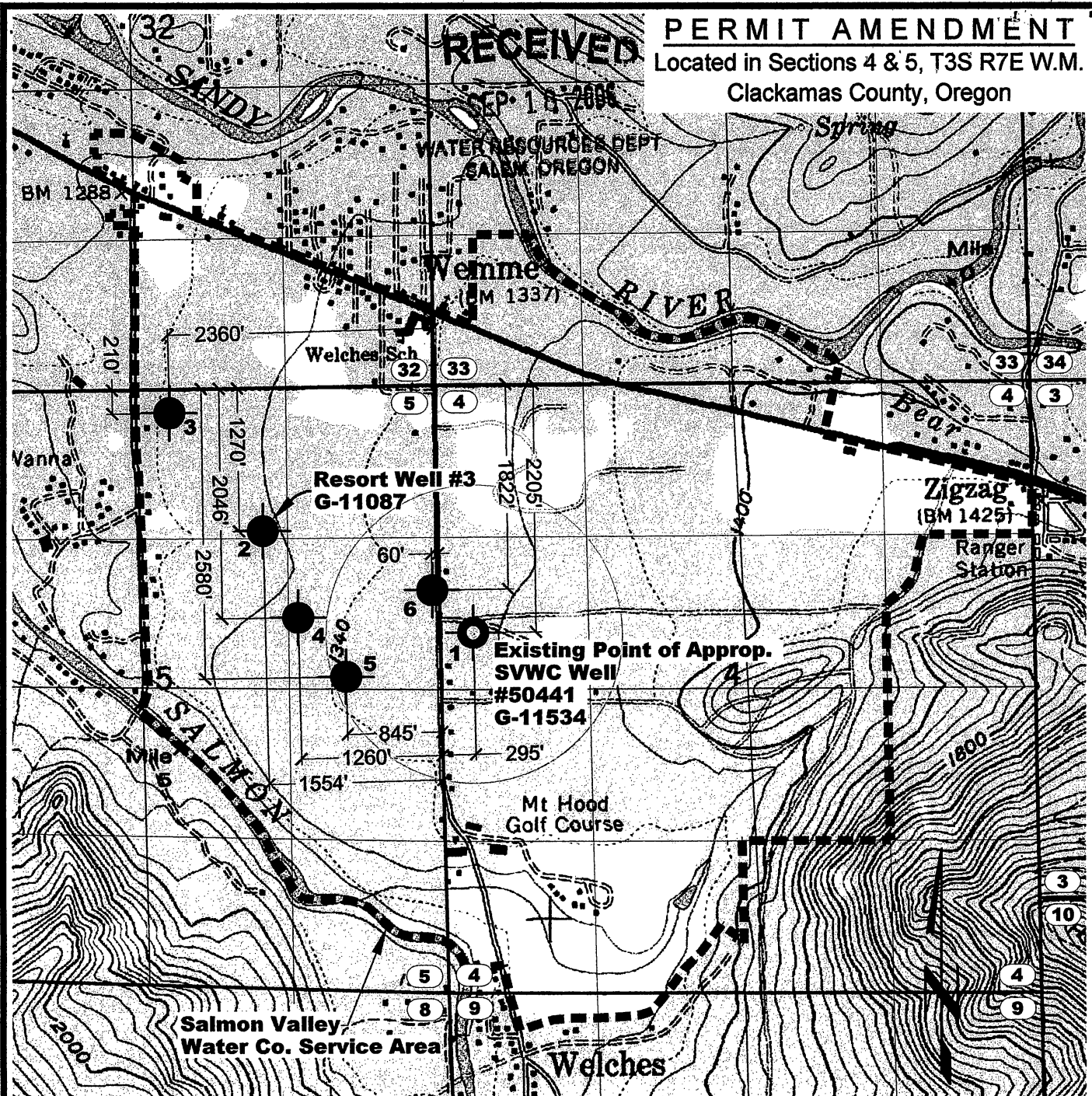

**RECEIVED**  
SEP. 14 2006  
WATER RESOURCES DEPT  
SALEM, OREGON

**NOTES**

1. This map was prepared for the purpose of identifying the location of water rights only and is not intended to provide legal dimensions or locations of property ownership lines.

**LEGEND**

- 1 ● Existing Point of Appropriation.
  - 2-6 ● Additional Proposed Point of Appropriation.
- Point of Appropriation Coordinates are Referenced to NE Corner of Section 5.

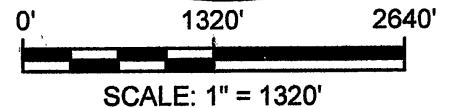
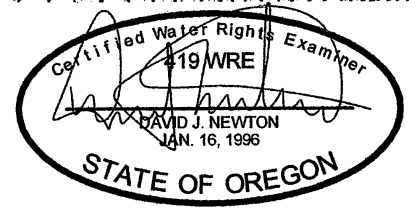

**NEWTON**  
CONSULTANTS INC.  
Earth, Water and Rock Specialists  
Ph: 541 504-9960 Fax: 541 504-9961



Permit Amendment Map  
Salmon Valley Water Company - Permit G-11534  
Clackamas County, Oregon

DESIGNED BY:  
D. Newton

DRAWN BY:  
S. Schenck

DATE:  
Sept 2006

PROJECT NO.  
1036-101

FIGURE 1

G:\1000\1036\101\Cad\Water\W1036101\_F1\_PermAmdMp 09:41 09/15/2006 SS