

# T.9S. R.4W, W.M.

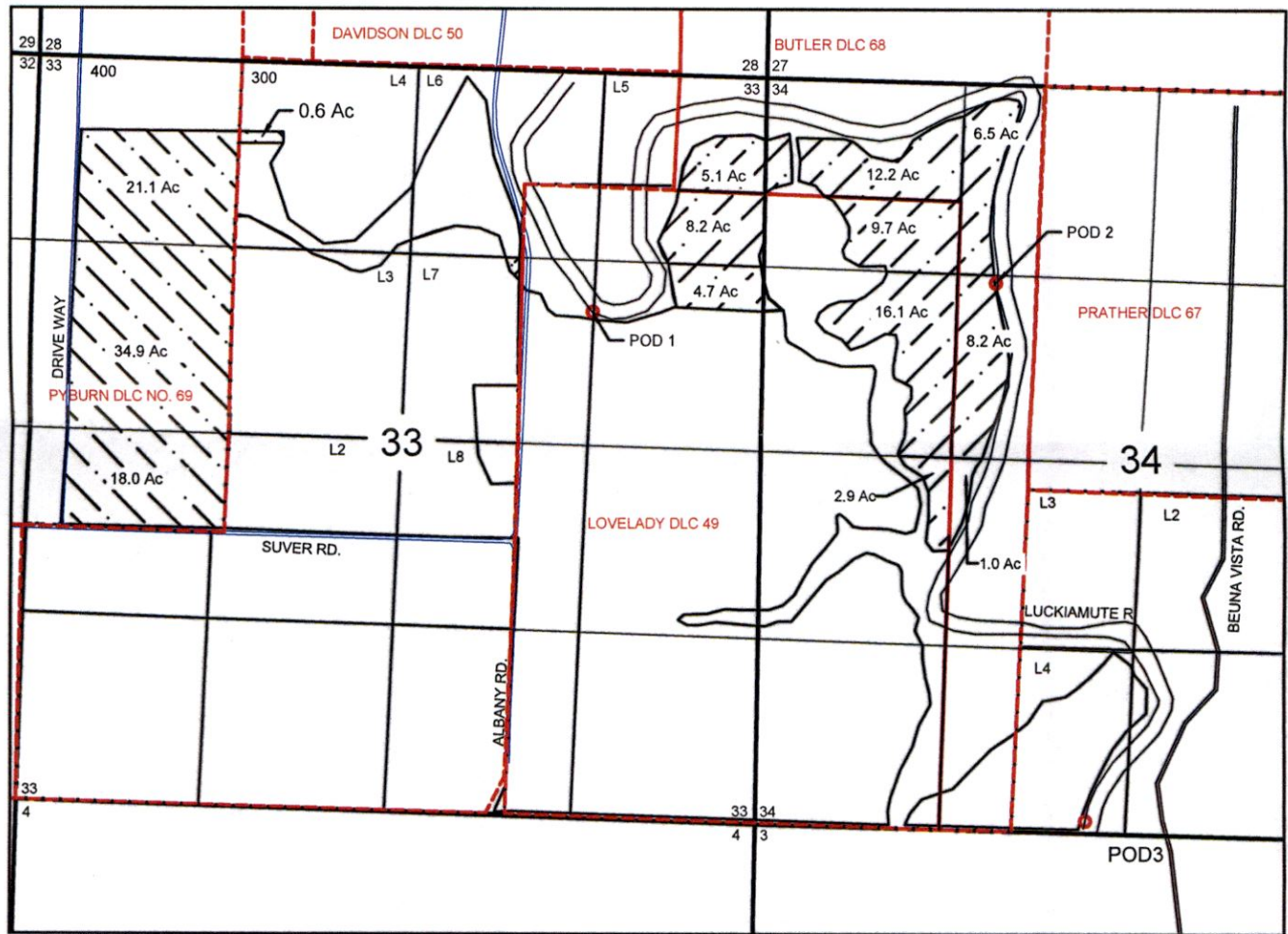

## DITCHEN LAND COMPANY, LLC TEMPORARY TRANSFER



1" = 1,320'

### LEGEND



TRANSFER FROM - 74.6 Ac.

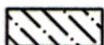

TRANSFER TO - 74.6 Ac.

APPLICATION: 42040

PERMIT: 31469

CERTIFICATE: 41962



DLC BOUNDARY



ROADS



SECTION LINES

RECEIVED

MAY 12 2020

OWRD

Sheet Name:  
**TEMPORARY  
TRANSFER MAP**

DRAWING FOR INFORMATION ON  
WATER RIGHTS ONLY NOT  
LEGAL BOUNDS

NO.	REVISION DESCRIPTION	DATE
4		
3		
2		
1		

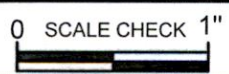

**IRZ ENGINEERING™**  
CONSULTANTS  
A LINDSAY COMPANY

500 N 1ST, HERMISTON, OREGON 97838  
OFFICE (541) 567-0252 FAX (541) 567-4239

DESIGNED	
DRAWN	SUVA SHAKYA
DATE	04-22/2020
SCALE	1:1320
PROJECT	517-19-001

DITCHEN LAND COMPANY, LLC

WATER RIGHTS PROJECT

13435