

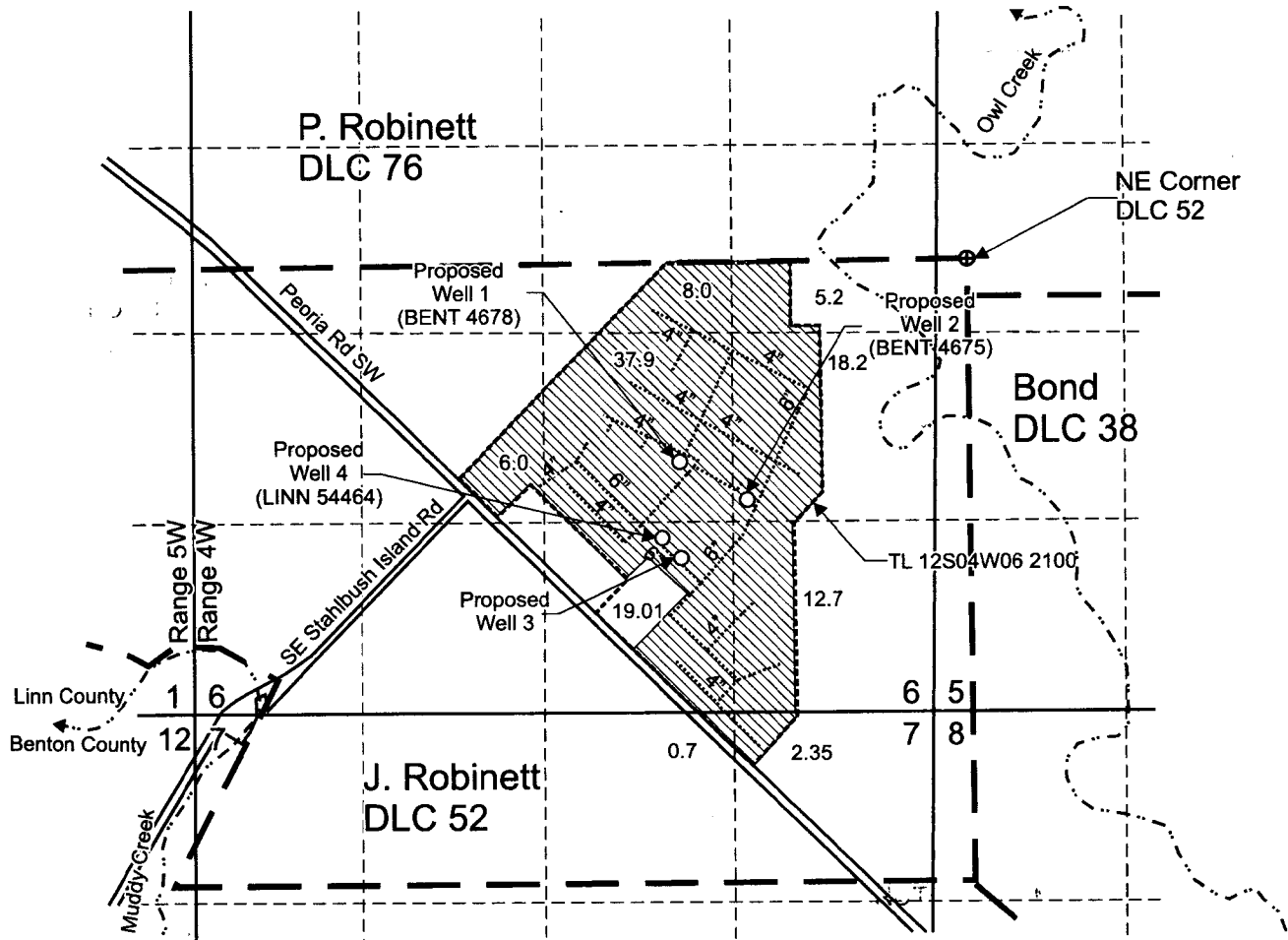

# T.12S. R.4W. Sec. 6 & 7, W.M.



Proposed Well 1 (BENT 4678) is located 1,395 feet south and 1,990 feet west from the NE corner, DLC 52.  
 Proposed Well 2 (BENT 4675) is located 1,655 feet south and 1,535 feet west from the NE corner, DLC 52.  
 Proposed Well 3 is located 1,075 feet north and 1,735 feet west from the SE corner, Section 6.  
 Proposed Well 4 (LINN 54464) is located 1,215 feet north and 1,870 feet west from the SE corner, Section 6.

 Area (110.06 Acres) of supplemental irrigation under Certificate 60433, priority date May 16, 1979,

----- Tax lot boundary

— • — Donation Land Claim boundary

..... Water main line

Scale: 1" = 1,320'

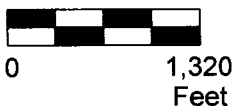

*June 2020*

This map was prepared for the purpose of identifying the location of a water right only and is not intended to provide legal dimensions or location of property ownership lines.



Pacific Hydro-Geology Inc.

09/2019  
Rev.06/2020

Transfer Application "To" Map  
 Certificate 60433  
 Oregon State University  
 College of Agricultural Sciences  
 T.12S. R.4W. Sec. 6 & 7, W.M.