

Sections 12 & 13, T2S, R2E, W.M.,  
Clackamas County, Oregon

RECEIVED

JUN 16 2020

TEMPORARY TRANSFER APPLICATION MAP  
Certificate 23668  
Cal Farms Inc.

OWRD

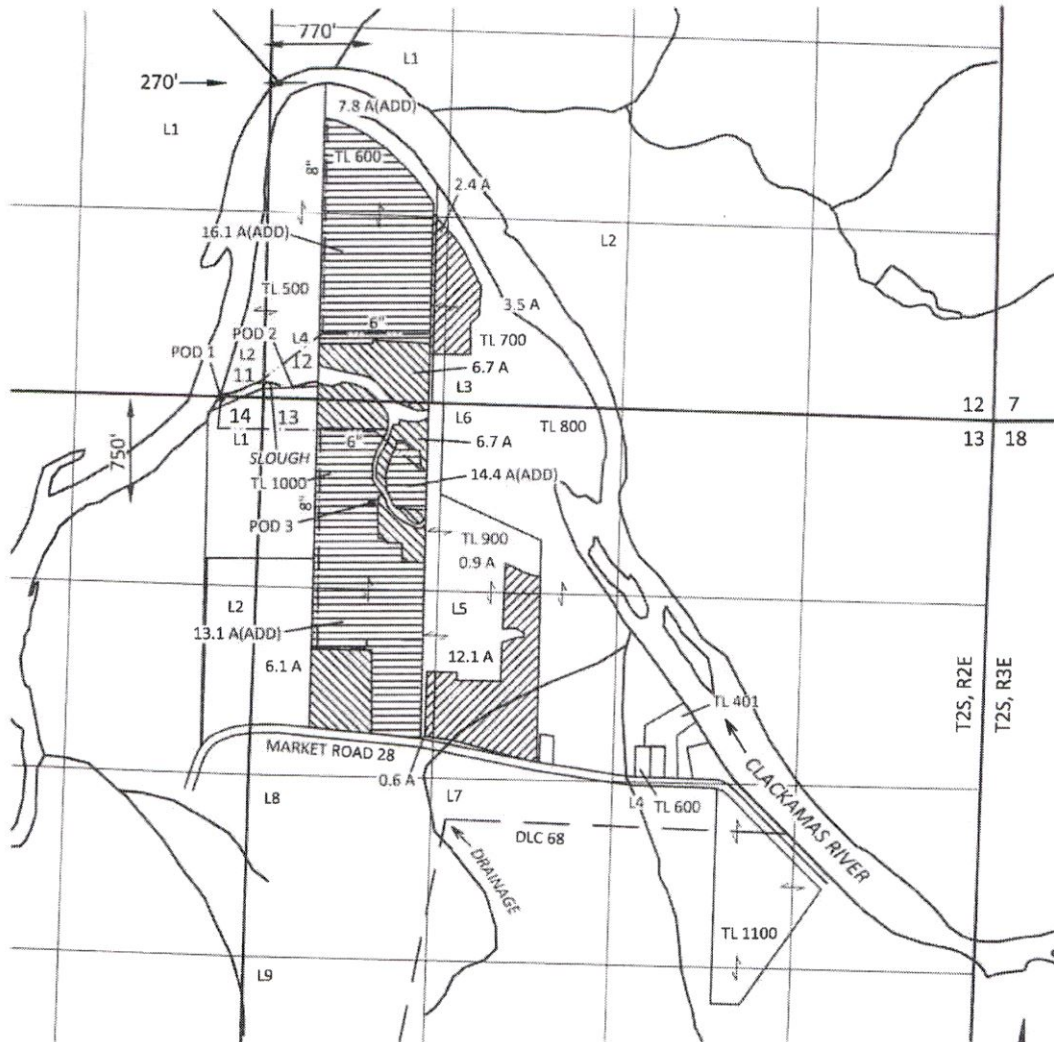

EXPLANATION

**FROM LANDS**  
 CERTIFICATE 23668  
 PRIORITY: 2/18/1953  
 19.5 ACRES

**TO LANDS**  
 CERTIFICATE 23668  
 PRIORITY: 2/18/1953  
 19.5 ACRES

**ADDING A POD (ADD)**  
 CERTIFICATE 23668  
 PRIORITY: 2/18/1953  
 51.4 ACRES

• POINT OF DIVERSION (POD)  
 --- PIPELINE (APPROX.)

POD 2 is a portable pumping authorization  
for the reach in the QQ section  
- see application map  
No final proof survey map is available

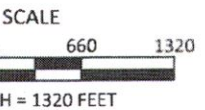

April 13, 2020

This map is not intended to provide legal  
dimensions or locations of property  
ownership lines

Figure 1

**SKOOKUM**  
WATER ASSOCIATES INC

1626 VICTORIAN WAY  
EUGENE, OR 97401  
(503) 319-8926





Sections 12 & 13, T2S, R2E, W.M.,  
Clackamas County, Oregon

RECEIVED

JUN 16 2020

TEMPORARY TRANSFER APPLICATION MAP  
Certificate 23668  
Cal Farms Inc.

OWRD

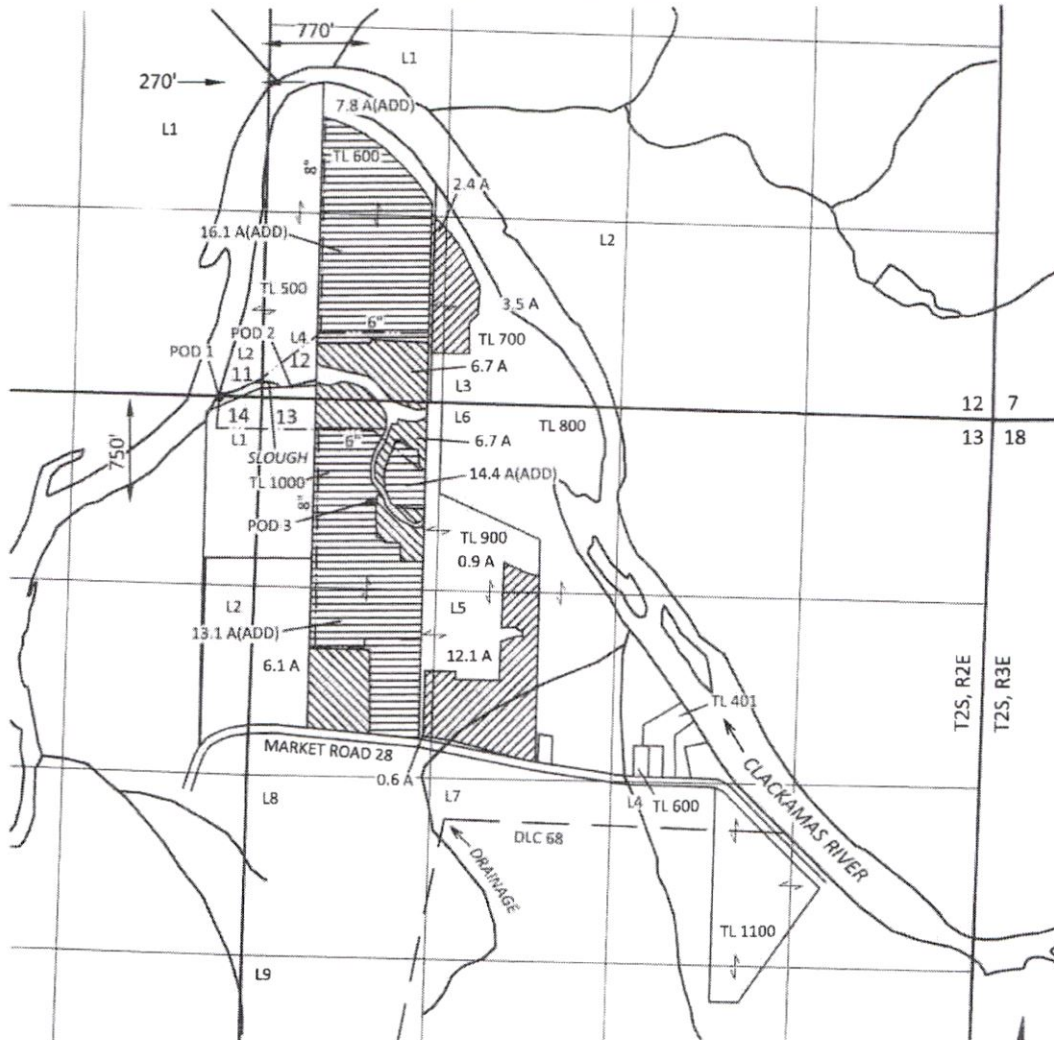

EXPLANATION

FROM LANDS

 CERTIFICATE 23668  
PRIORITY: 2/18/1953  
19.5 ACRES

TO LANDS

 CERTIFICATE 23668  
PRIORITY: 2/18/1953  
19.5 ACRES

ADDING A POD (ADD)

 CERTIFICATE 23668  
PRIORITY: 2/18/1953  
51.4 ACRES

• POINT OF DIVERSION (POD)

- - - PIPELINE (APPROX.)

POD 2 is a portable pumping authorization  
for the reach in the QQ section  
- see application map  
No final proof survey map is available

SCALE

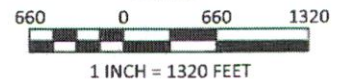

April 13, 2020

This map is not intended to provide legal  
dimensions or locations of property  
ownership lines

Figure 1

**SKOOKUM**  
WATER ASSOCIATES INC

1626 VICTORIAN WAY  
EUGENE, OR 97401  
(503) 319-8926

Sections 12 & 13, T2S, R2E, W.M.,  
Clackamas County, Oregon

RECEIVED  
JUN 16 2020  
OWRD

TEMPORARY TRANSFER APPLICATION MAP  
Certificate 23668  
Cal Farms Inc.

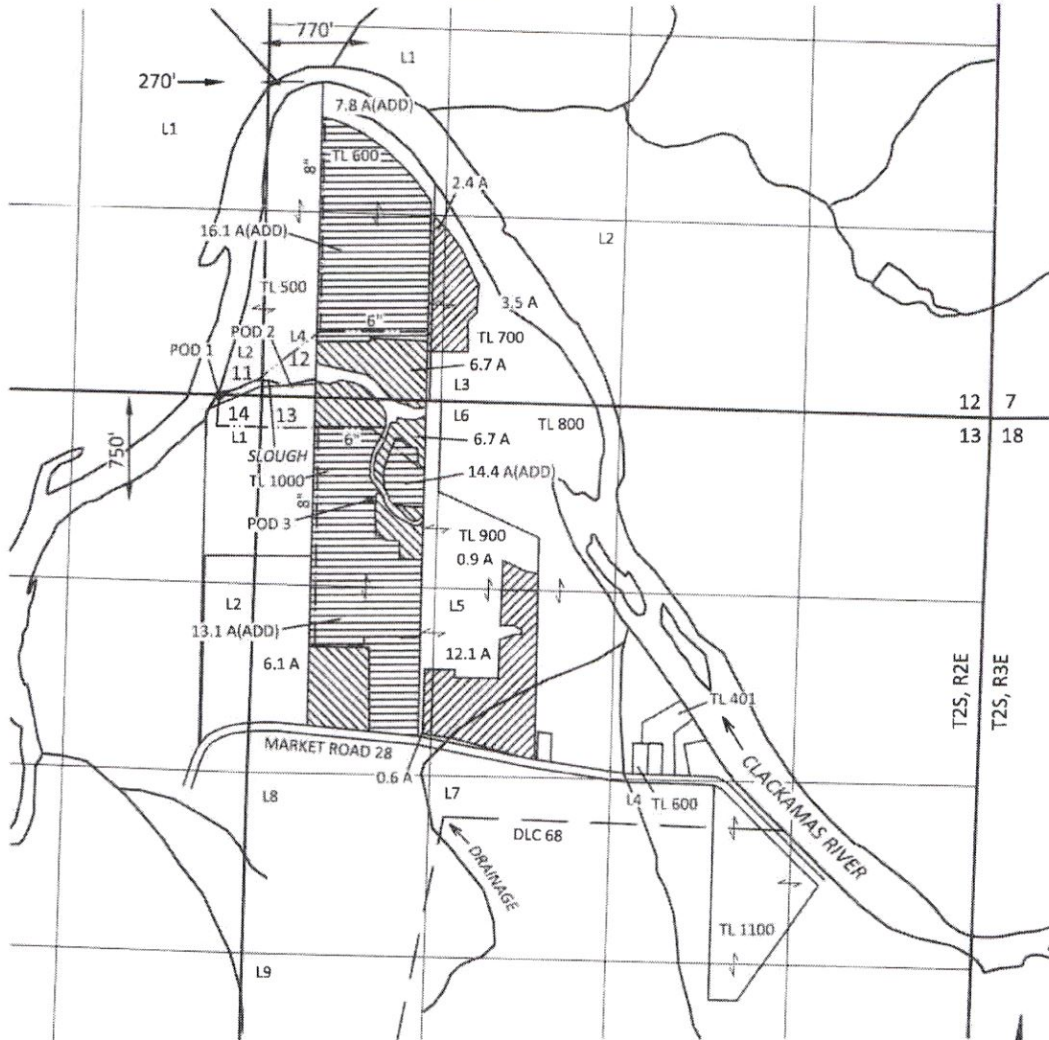

EXPLANATION

- FROM LANDS**
-  CERTIFICATE 23668  
PRIORITY: 2/18/1953  
19.5 ACRES
- TO LANDS**
-  CERTIFICATE 23668  
PRIORITY: 2/18/1953  
19.5 ACRES
- ADDING A POD (ADD)**
-  CERTIFICATE 23668  
PRIORITY: 2/18/1953  
51.4 ACRES
  -  POINT OF DIVERSION (POD)
  -  PIPELINE (APPROX.)

POD 2 is a portable pumping authorization  
for the reach in the QQ section  
- see application map  
No final proof survey map is available

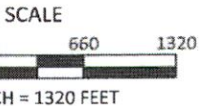

April 13, 2020

This map is not intended to provide legal  
dimensions or locations of property  
ownership lines

Figure 1

**SKOOKUM**  
WATER ASSOCIATES INC

1626 VICTORIAN WAY  
EUGENE, OR 97401  
(503) 319-8926