

ACMPC Oregon 2, LLC  
 Halls Ferry Farms  
 Groundwater Registration Modification - GR 683

Township 7S, Range 4W

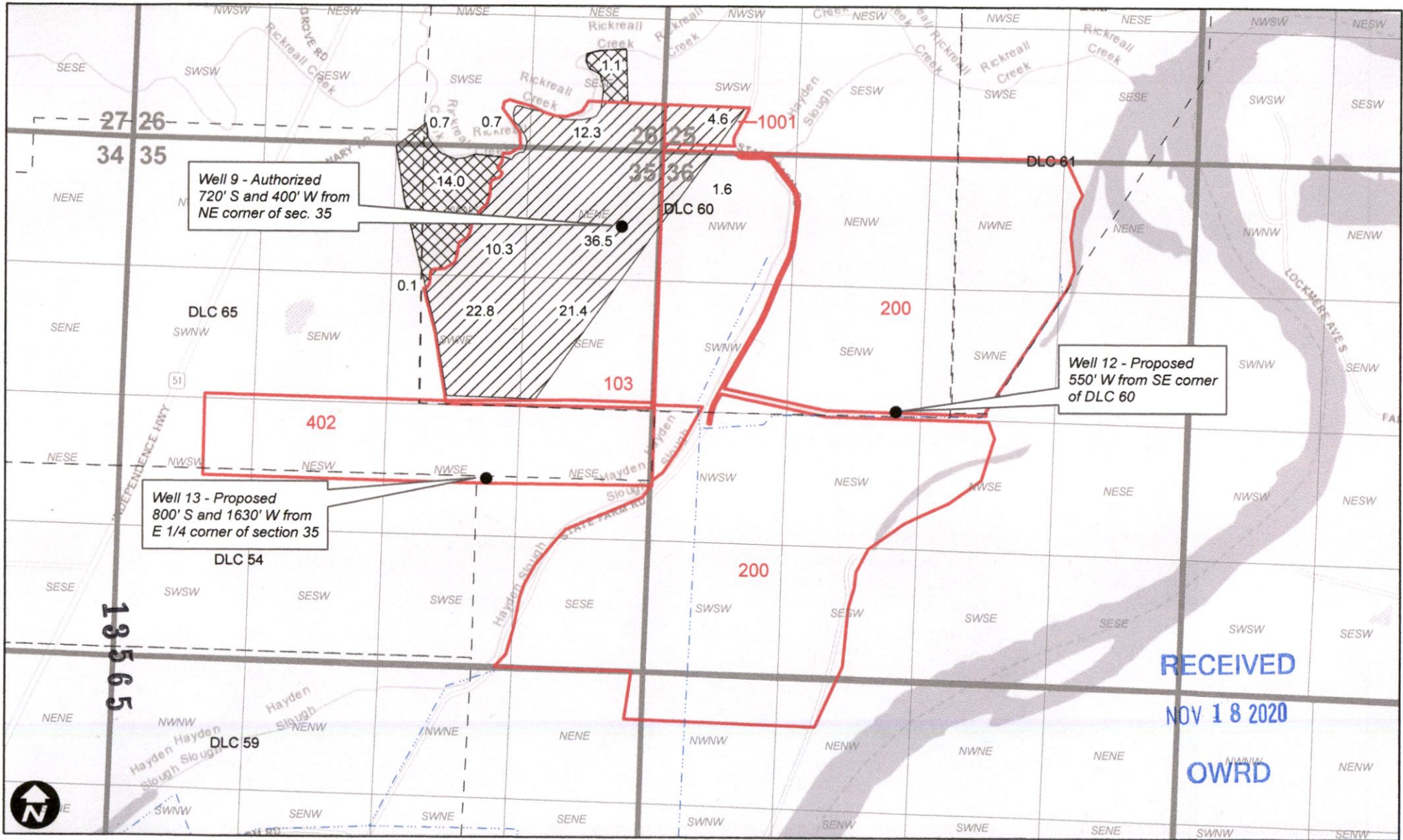

Well 9 - Authorized  
 720' S and 400' W from  
 NE corner of sec. 35

Well 12 - Proposed  
 550' W from SE corner  
 of DLC 60

Well 13 - Proposed  
 800' S and 1630' W from  
 E 1/4 corner of section 35

RECEIVED  
 NOV 18 2020  
 OWRD

Legend

- GR 683 APOA
- GR 683 No Change
- Irrigation Mainline
- Tax Lot
- DLC