

# Permit Amendment Application Authorized Place of Use and Authorized and Proposed Points of Appropriation

Unit Two (Map 2 of 2)

Township 20 South, Range 10, 11 East (W.M.)

RECEIVED

MAR 01 2021

OWRD

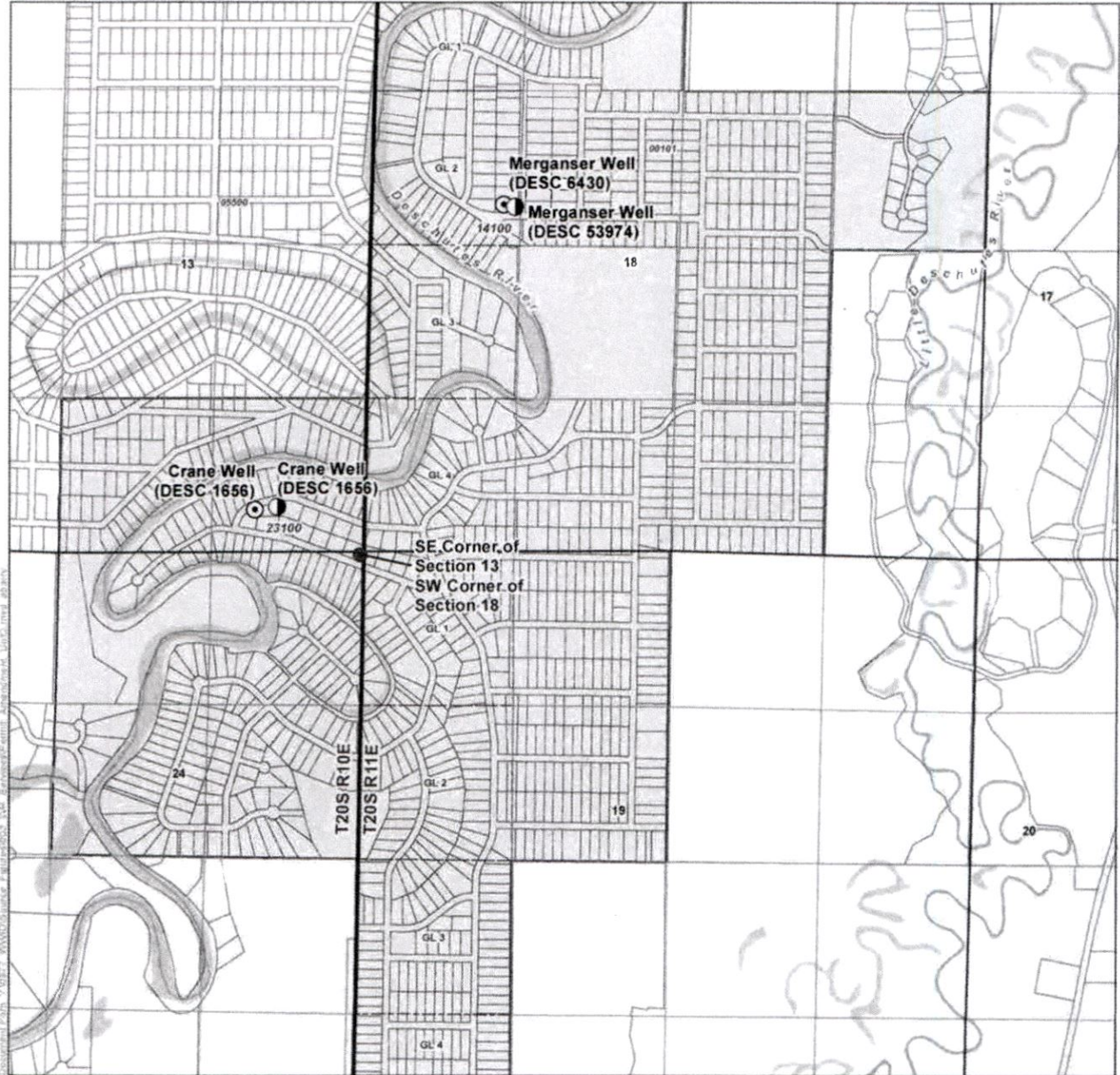

**LEGEND**

- |                                     |                               |                           |
|-------------------------------------|-------------------------------|---------------------------|
| <b>Point of Appropriation (POA)</b> | Authorized Place of Use (POU) | <b>All Other Features</b> |
| Authorized                          | Government Lot (GL)           | Tax Lot                   |
| Proposed                            |                               | Watercourse               |
|                                     |                               | Waterbody                 |

**DISCLAIMER**  
This map was prepared for the purpose of identifying the location of a water right only and it is not intended to provide legal dimensions or location of property ownership lines.

**MAP NOTES**

Date: February 3, 2021  
Data Sources: USGS, BLM, ESRI, Deschutes Co.

**POA LOCATION DESCRIPTION**

**PROPOSED POA**  
**Crane Well (DESC 1656)** Located 360 feet North and 755 feet West from the SE corner of Section 13, Township 20 South, Range 10 East (W.M.)  
**Merganser Well (DESC 53974)** Located 2970 feet North and 1240 feet East from the SW corner of Section 18, Township 20 South, Range 11 East (W.M.)

**AUTHORIZED POA**  
**Crane Well (DESC 1656)** Located 380 feet North and 990 feet West from the SW corner of Section 18, Township 20 South, Range 10 East (W.M.)  
**Merganser Well (DESC 6430)** Located 3070 feet North and 1080 feet East from the SW corner of Section 18, Township 20 South, Range 11 East (W.M.)

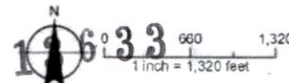

# Permit Amendment Application Authorized Place of Use and Authorized and Proposed Points of Appropriation

**RECEIVED**

MAR 01 2021

Unit One (Map 1 of 2)

Township 20 South, Range 10 East (W.M.)

**OWRD**

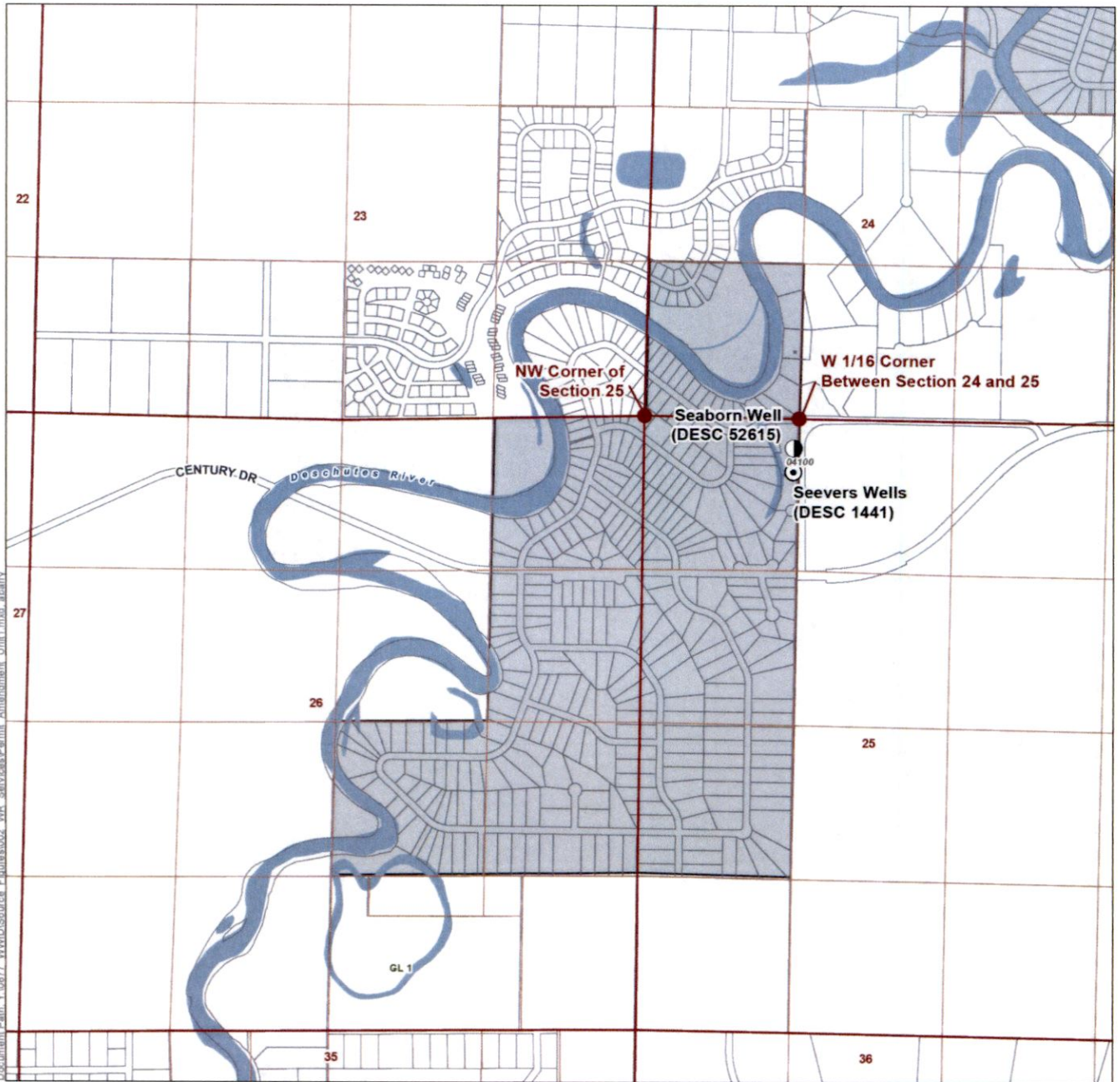

**LEGEND**

**Point of Appropriation (POA)**

- Authorized
- Proposed

■ Authorized Place of Use (POU)

□ Government Lot (GL)

**All Other Features**

- ⊕ Tax Lot
- ~ Watercourse
- Waterbody

**DISCLAIMER**

This map was prepared for the purpose of identifying the location of a water right only and it is not intended to provide legal dimensions or location of property ownership lines.

**MAP NOTES**

Date: February 3, 2021  
Data Sources: USGS, BLM, ESRI, Deschutes Co.

**POA LOCATION DESCRIPTION**

**PROPOSED POA**

**Seaborn Well (DESC 52615)** Located 255 feet South and 1285 feet East from the NW corner of Section 25, Township 20 South, Range 10 East (W.M.)

**AUTHORIZED POA**

**Seever's Well (DESC 1441)** Located 460 feet South and 30 feet West from the W 1/16 corner Between Section 24 and 25, Township 20 South, Range 10 East (W.M.)

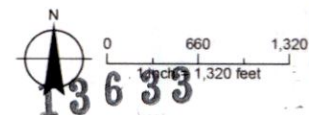

# Permit Amendment Application Authorized Place of Use and Authorized and Proposed Points of Appropriation

**RECEIVED**

MAR 01 2021

Unit Two (Map 2 of 2)

**OWRD**

Township 20 South, Range 10, 11 East (W.M.)

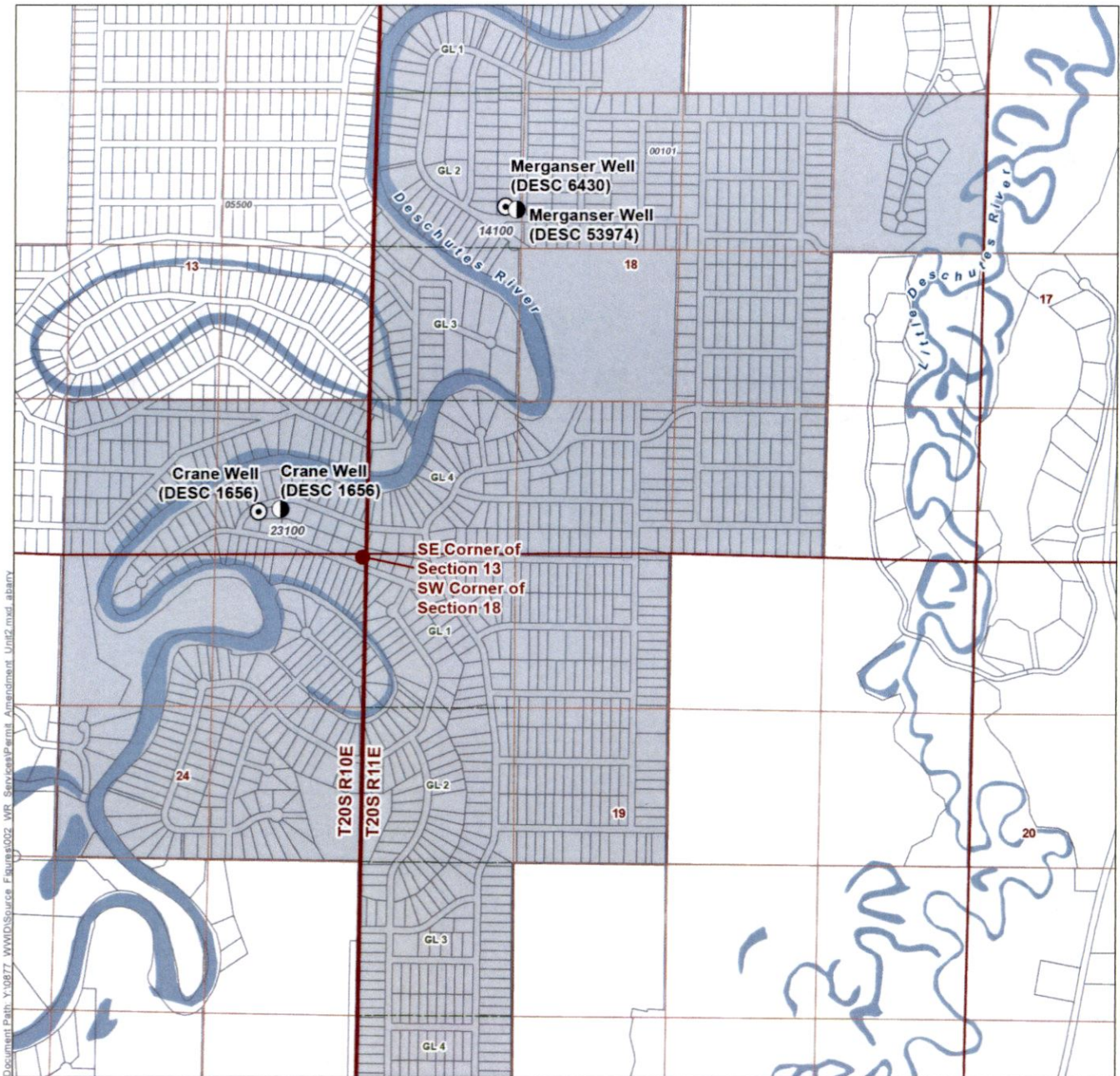

Document Path: Y:\027\W\H\Source\_Fractions\02\_WP\_Services\Permit\_Amendment\_Unit2.mxd, alabary

**LEGEND**

- |                              |                               |                           |
|------------------------------|-------------------------------|---------------------------|
| Point of Appropriation (POA) | Authorized Place of Use (POU) | <b>All Other Features</b> |
| Authorized                   | Government Lot (GL)           | Tax Lot                   |
| Proposed                     |                               | Watercourse               |
|                              |                               | Waterbody                 |

**DISCLAIMER**

This map was prepared for the purpose of identifying the location of a water right only and it is not intended to provide legal dimensions or location of property ownership lines.

**MAP NOTES**

Date: February 3, 2021  
Data Sources: USGS, BLM, ESRI, Deschutes Co.

**POA LOCATION DESCRIPTION**

**PROPOSED POA**

**Crane Well (DESC 1656)** Located 360 feet North and 755 feet West from the SE corner of Section 13, Township 20 South, Range 10 East (W.M.)

**Merganser Well (DESC 53974)** Located 2970 feet North and 1240 feet East from the SW corner of Section 18, Township 20 South, Range 11 East (W.M.)

**AUTHORIZED POA**

**Crane Well (DESC 1656)** Located 380 feet North and 990 feet West from the SW corner of Section 18, Township 20 South, Range 10 East (W.M.)

**Merganser Well (DESC 6430)** Located 3070 feet North and 1080 feet East from the SW corner of Section 18, Township 20 South, Range 11 East (W.M.)

