

**POD LOCATION DESCRIPTION**  
**North POD:** Located 2,360 feet South and 2,950 feet West from the NE corner of Section 35, Township 5 South, Range 5 West (W.M.)  
**Middle POD:** Located 1,050 feet North and 300 feet East from the SW corner of Section 35, Township 5 South, Range 5 West (W.M.)

**DISCLAIMER**  
 This map was prepared for the purpose of identifying the location of a water right only and it is not intended to provide legal dimensions or location of property ownership lines.

<p><b>LEGEND</b></p> <ul style="list-style-type: none"> <li>⊙ Authorized Point of Diversion (POD)</li> <li>--- Conveyance Line</li> <li><b>Place of Use (POU)</b></li> <li> From Lands, 43.1 acres - Certificate 53093</li> <li> From Lands, 32.9 acres - Certificate 66607</li> <li> Remaining Lands, 269.1 acres - Certificate 66607</li> </ul>		<p><b>All Other Features</b></p> <ul style="list-style-type: none"> <li> Tax Lot</li> <li> Donation Land Claim (DLC)</li> <li> Government Lot (GL)</li> <li> County Line</li> <li> Watercourse</li> <li> Waterbody</li> </ul>	<p style="text-align: center;"><b>Application for a Water Right Temporary Transfer</b>  <b>in the Name of Sarbanand Enterprises;</b>  <b>From Lands, Remaining Lands, and Authorized Points of Diversion Map</b>  <b>Township 5 &amp; 6 South, Range 5 West (W.M.)</b></p> <p style="text-align: center;">RECEIVED      APR 05 2021      OWRD</p>	<p><b>MAP NOTES</b>      Date: February 11, 2021      Data Sources: BLM, ESRI, Yamhill Co., Polk Co., USGS</p> <p style="text-align: center;">1      13660      -</p>
---	--	---	---	---

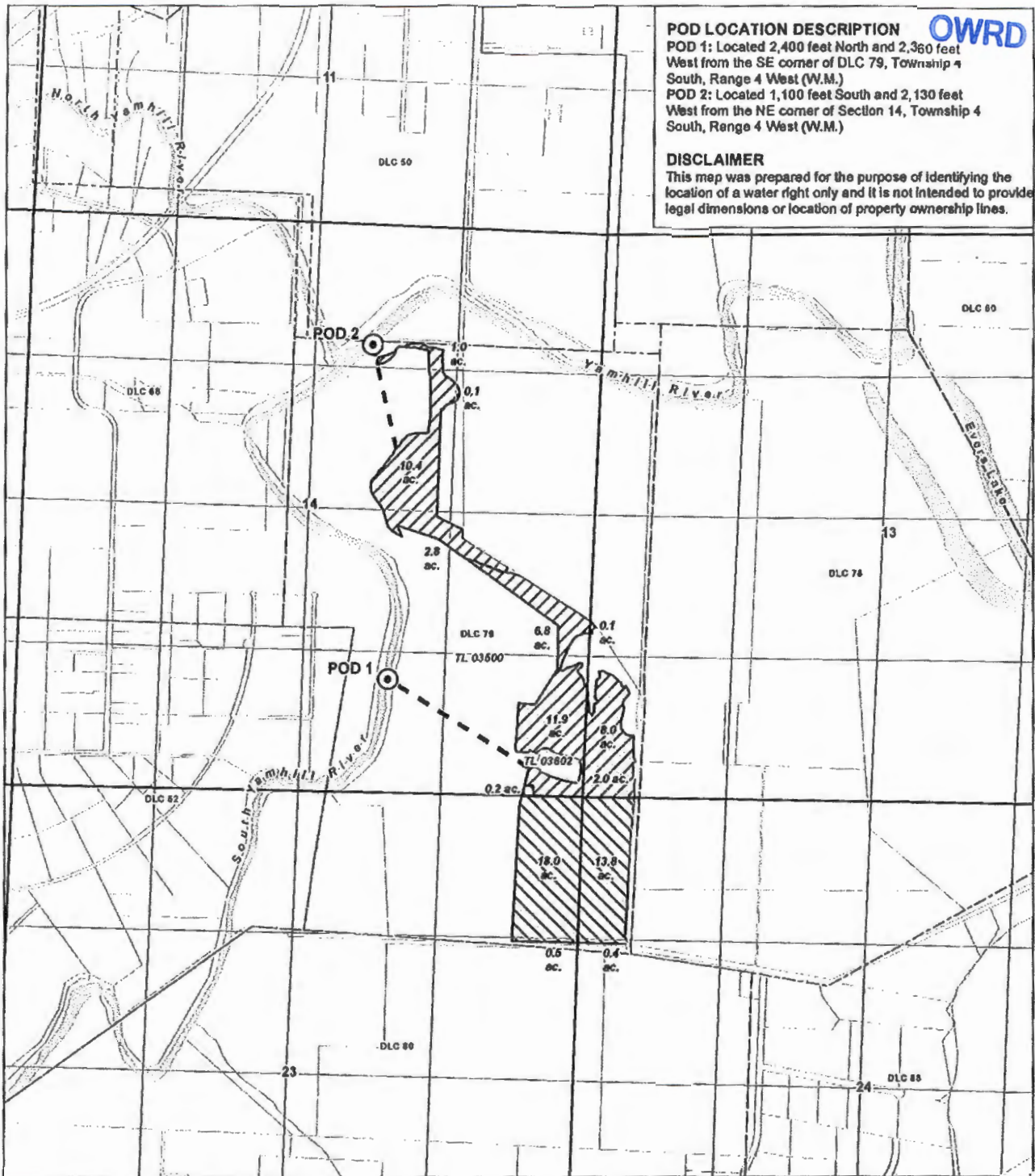



**OWRD**

**POD LOCATION DESCRIPTION**  
 POD 1: Located 2,400 feet North and 2,360 feet West from the SE corner of DLC 79, Township 4 South, Range 4 West (W.M.)  
 POD 2: Located 1,100 feet South and 2,130 feet West from the NE corner of Section 14, Township 4 South, Range 4 West (W.M.)

**DISCLAIMER**  
 This map was prepared for the purpose of identifying the location of a water right only and it is not intended to provide legal dimensions or location of property ownership lines.

- LEGEND**
- ⊙ Proposed Point of Diversion (POD)
  - - Conveyance Line
  - ▨ Place of Use (POU)
    - To Lands, 43.1 acres - Certificate 53093
    - To Lands, 32.9 acres - Certificate 68607
  - All Other Features
    - Tax Lot
    - ▭ Donation Land Claim (DLC)
    - ~ Watercourse
    - ⊞ Waterbody

**Application for a Water Right Temporary Transfer**  
**In the Name of Sarbanand Enterprises;**  
**To Lands and Proposed Points of Diversion Map**  
**13660 - Township 4 South, Range 4 West (W.M.)**

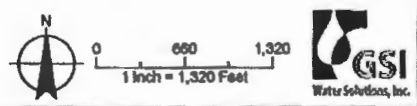

Date: February 8, 2021  
 Data Source: BLM, BLM, W-04 Co., Park Co., USGS  
 Document Path: Y:\562\_Hunger\_Farm\Source\_Figures\01\_Amty\_Farm\WR\_Temp\_Transfer\_TO.mxd wk.mason

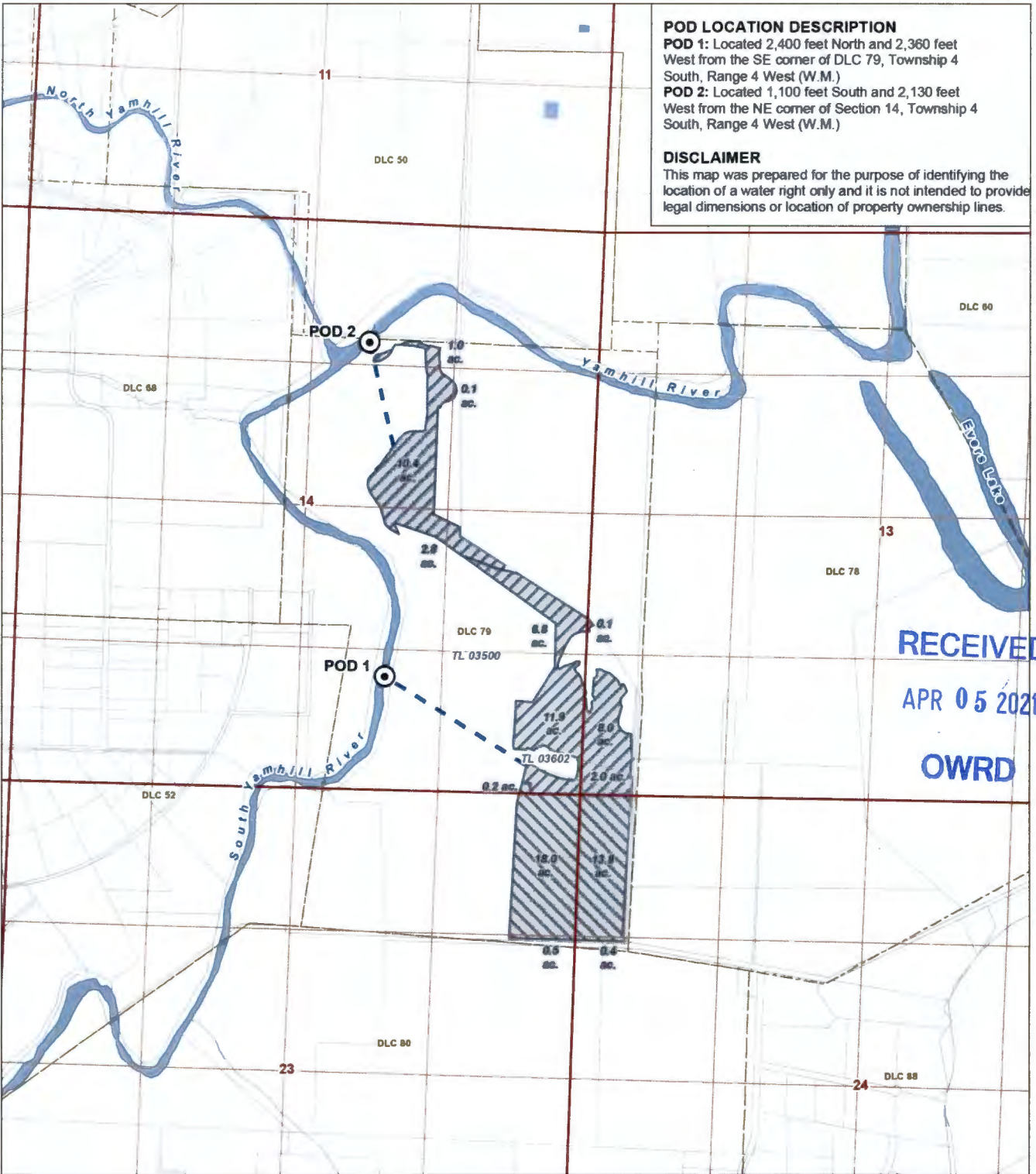

**POD LOCATION DESCRIPTION**

**POD 1:** Located 2,400 feet North and 2,360 feet West from the SE corner of DLC 79, Township 4 South, Range 4 West (W.M.)

**POD 2:** Located 1,100 feet South and 2,130 feet West from the NE corner of Section 14, Township 4 South, Range 4 West (W.M.)

**DISCLAIMER**

This map was prepared for the purpose of identifying the location of a water right only and it is not intended to provide legal dimensions or location of property ownership lines.

RECEIVED  
APR 05 2021  
OWRD

**LEGEND**

⊙ Proposed Point of Diversion (POD)

--- Conveyance Line

**Place of Use (POU)**

▨ To Lands, 43.1 acres  
- Certificate 53093

▨ To Lands, 32.9 acres  
- Certificate 66607

**All Other Features**

□ Tax Lot

□ Donation Land Claim (DLC)

~ Watercourse

■ Waterbody

**Application for a Water Right Temporary Transfer  
in the Name of Sarbanand Enterprises;  
To Lands and Proposed Points of Diversion Map  
Township 4 South, Range 4 West (W.M.)**

Date: February 8, 2021  
Data Sources: BLM, ESRI, Yamhill Co., Polk Co., USGS

Document Path: Y:\0562\_Munger\_Farms\Source\_Figures\001\_Amitz\_Farm\WR\_Temp\_Transfer\_TO.mxd wkimmon



13660-