

# LFC Field Map - revised 2015

2017 Crop Map (projected, as of Jan. 21, 2017)

RECEIVED

APR 02 2021

OWRD

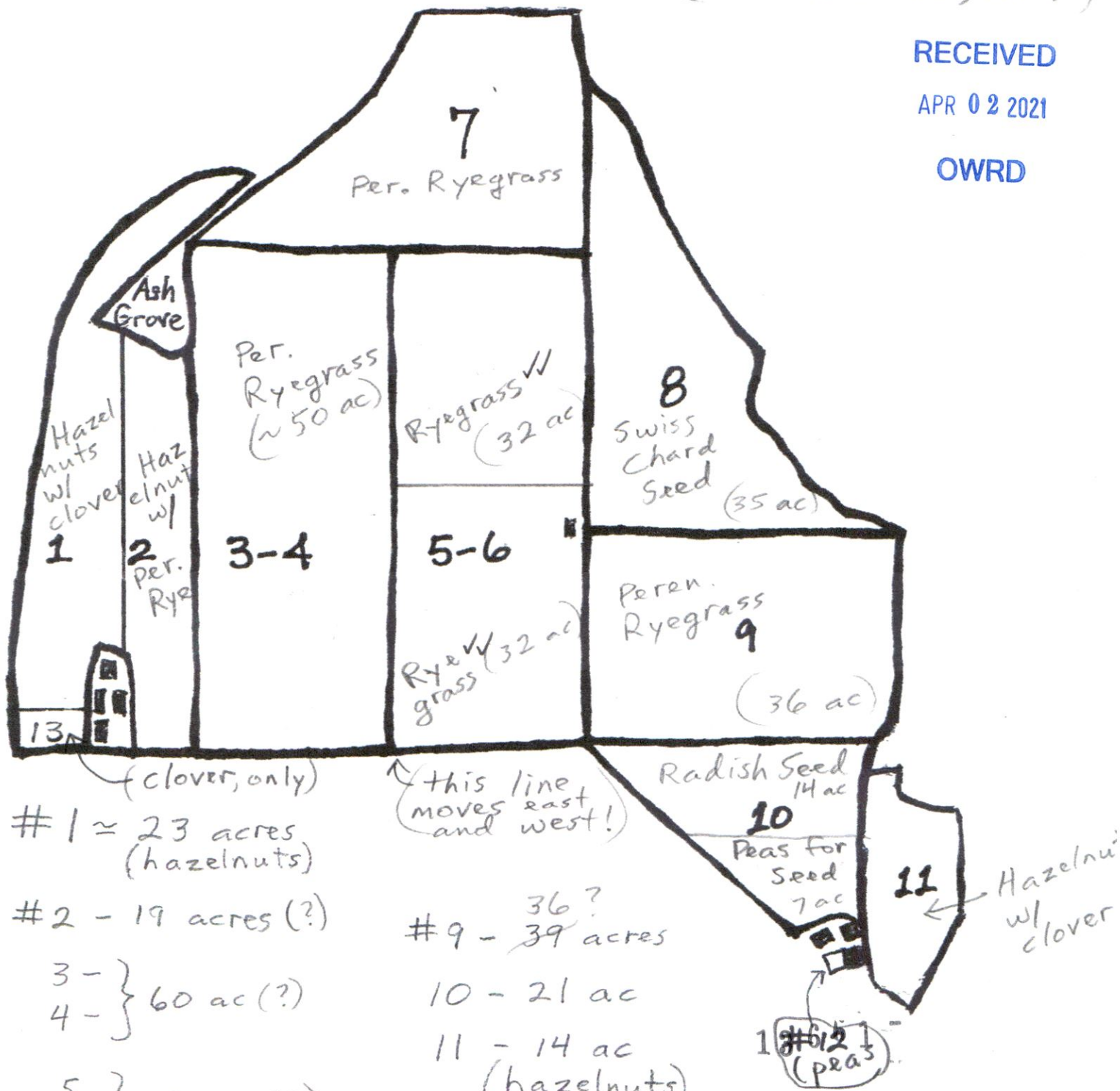

(clover, only)  
 #1 ≈ 23 acres (hazelnuts)

#2 - 19 acres (?)

3 - }  
 4 - } 60 ac (?)

5 }  
 6 } 58 ac (?)

7 - 37 ac

8 - 36 ac

↑ this line moves east and west!

#9 - 36?  
 39 acres

10 - 21 ac

11 - 14 ac (hazelnuts)

12 - 0.8 acre

13 - 2 acres

ΣX = 309.8 acres

(3.28 acres, per USDA/FSA aerial photo)

RECEIVED

APR 02 2021

OWRD

T.5S. R.4.W. W.M.

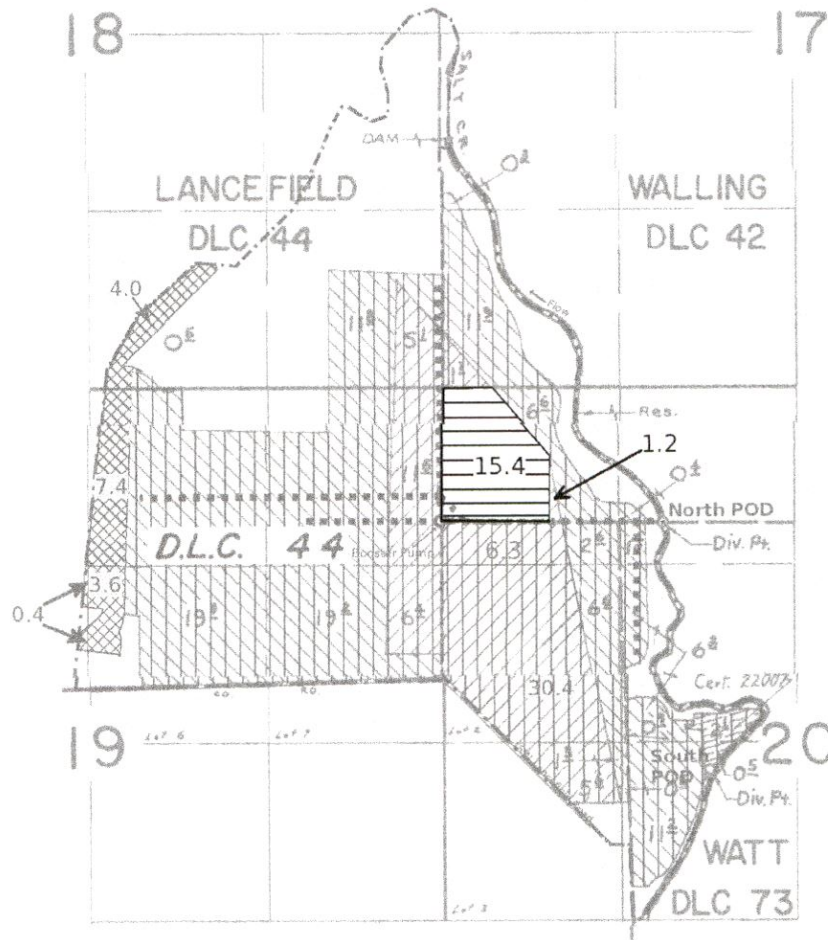

Scale: 1"=1320'

- Legend
-  From Land
  -  To Lands
  -  Lands not affected by transfer
  -  Property Boundary
  -  Main lines

Div. Pts Loc: 670'S. & 1980'E, 1180'N & 1650'E, Dam - 4020'N. & 70'E.  
all from SE corner Lancefield DLC 44

**FINAL PROOF SURVEY**  
UNDER

R-41605                      R-4713  
 41606                          31196  
 Application No 46494      Permit No. 34745

 Primary       Supplemental

IN NAME OF

ROBERT & STUART LANCEFIELD

Surveyed MAY 29, 1973, by R. G. MUCKEN

13661