

NOTES:

1. THIS MAP WAS PREPARED FROM FIELD MEASUREMENTS, 2021 NAIP AERIAL IMAGERY, AND KLAMATH COUNTY TAX MAPS T40S, R10E, SEC. 7 AND T40S, R10E, SEC. 29.
2. THIS MAP IS FOR THE PURPOSE OF IDENTIFYING THE LOCATION OF THE WATER RIGHT ONLY AND HAS NO INTENT TO PROVIDE DIMENSIONS OR LOCATION OF PROPERTY LINES.
3. DATE OF PRIORITY FOR THIS PERMIT IS MARCH 1, 2005.

WELL LOCATIONS:

WELL 1 (KLAM 53043): 1360' SOUTH & 1860' WEST FROM THE NORTHEAST CORNER OF SECTION 7.

WELL 2 (KLAM 10518): 1420' SOUTH & 20' EAST FROM THE NORTHWEST CORNER OF SECTION 29.

WELL 3 (PROPOSED POA-KLAM 57387): 1240' NORTH & 30' WEST FROM THE SOUTHEAST CORNER OF SECTION 16.

LEGEND

---	TOWNSHIP LINE	TL 0000	TAX LOT NUMBER
---	SECTION LINE	LOT 1	GOVERNMENT LOT NUMBER
---	1/4 1/4 LINE	⊙	POA (WELL)
---	TAX LOT LINE	⊙	LANDS TO BE TRANSFERRED TO PROPOSED POA
---	ABOVE GROUND PIPE	10.3 NWNW	IRRIGATED ACRES
---	☉ STREAM	→	1/4 1/4 SECTION
---	☉ ROAD		FLOW DIRECTION
---	☉ CANAL		
---	16 15		
---	17 16		

AL ADKINS ENGINEERING & SURVEYING
 o / 541.884.4666
 w / AdkinsEngineering.com

1435 ESPLANADE AVENUE, KLAMATH FALLS, OR 97601

SERVING S. OREGON & N. CALIFORNIA

ENGINEERING • SURVEYING • PLANNING • TESTING

RECEIVED
 APR 22 2021
 OWRD

DROUGHT TEMPORARY TRANSFER
 FOR
 MLM PROPERTY LLC
 T41S, R11E, SEC. 16, W.M.
 KLAMATH COUNTY, OREGON
 APPLICATION G-16400
 PERMIT G-18390



Google Earth

Date: May 27, 2017

© 2021 Google

1000 ft

RECEIVED
MAY 22 2017
OWPRD

SITE PLAN

KAM 57307

156

TAX Lot 1500-1501



RECEIVED

APR 23 2021

OWRD

118' From S.E. CORNER of BUILDING

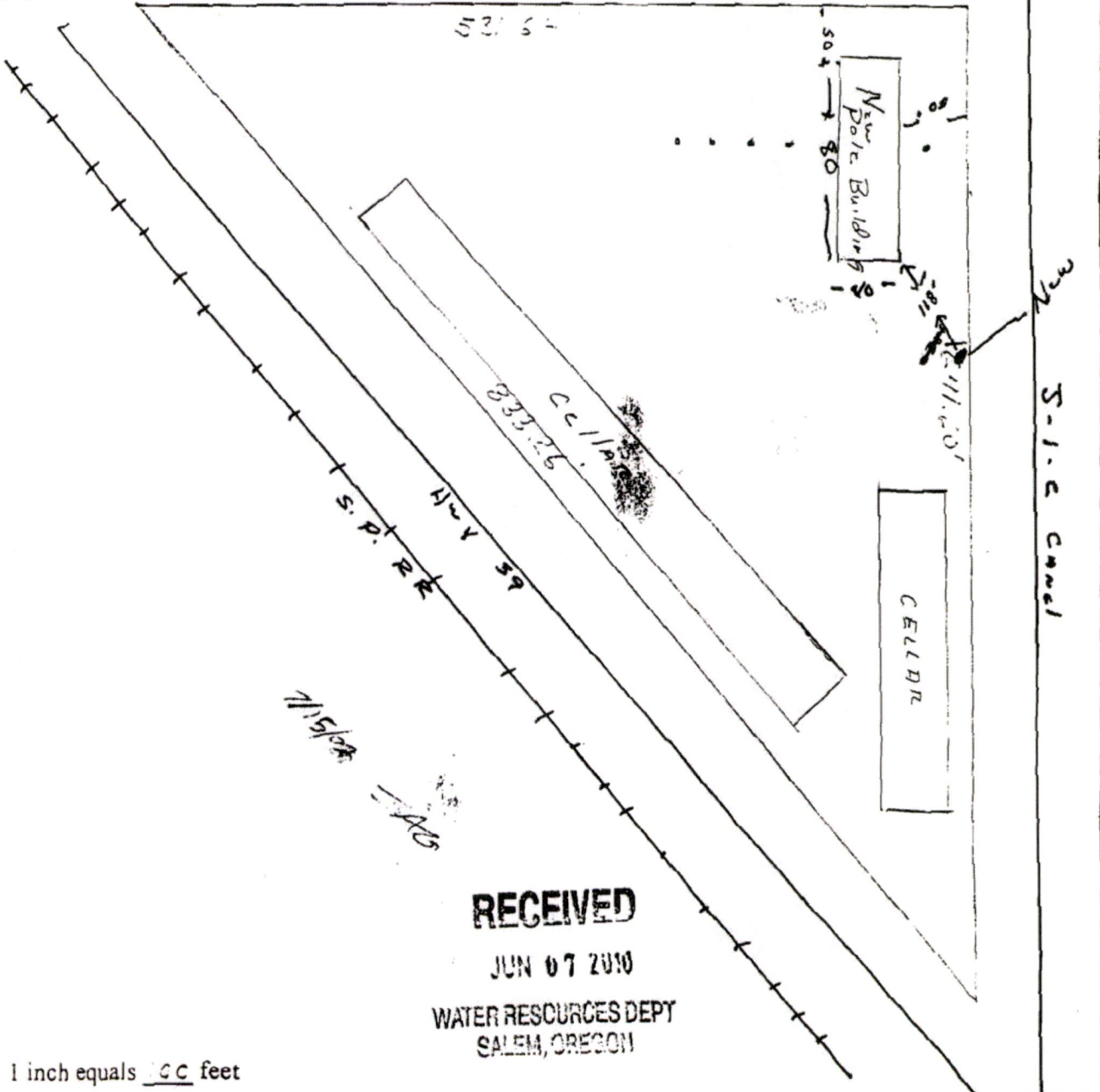

will locate

RECEIVED

JUN 07 2010

WATER RESOURCES DEPT
SALEM, OREGON

1 inch equals 100 feet

Tax Acct. No.:
Proposed Use:

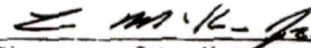
Signature of Applicant

TAX Lot 1500-1501

LAND OWNER SUBMITTED MAP